

SECTION A  
1:20

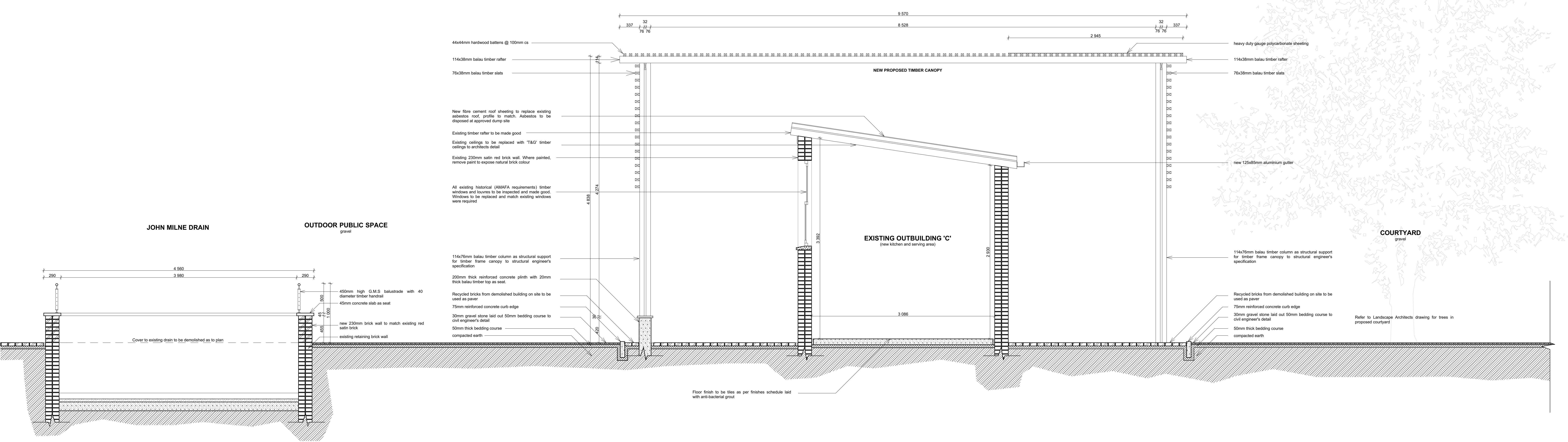

SECTION B  
1:20

REVISIONS		
NUMBER	DATE	DETAILS
4	2014.01.31	<ul style="list-style-type: none"> <li>Canopy over Buildings on North East boundary changed in terms of size and shape.</li> <li>Supports to Canopy placed on new grid system.</li> <li>Double supports done away with under canopies.</li> <li>Canopy on Beer hall changed</li> <li>Internal vehicular entrance to courtyard changed to 4m sliding gate.</li> <li>Timber deck added to Beer Hall area of courtyard</li> <li>Channel opening in center island of John Milner Road added</li> <li>Center island lighting amended.</li> <li>Surfacing of courtyard and John Milner Road amended</li> </ul>

CLIENT  
**ETHEKWINI CITY COUNCIL**

CLIENT SIGNATURE  
DATE  
AUTHOR'S SIGNATURE

DATE  
PROJECT

**PROPOSED CANOPY AND ALTERATIONS AND ADDITIONS TO EXISTING BUILDING AT 102 FLORENCE NZAMA ROAD: ERF 11338 DURBAN**

CONTRACT No

DRAWING  
**SECTIONS**

DESIGNED	SCALE
R.C.	1:25
DRAWN	DATE
E.M.	2013.12.04
APPROVED	COPYRIGHT
D.R.	RESERVED

PROJECT	STAGE	DRAWING	NUMBER	REV	REVISION DATE
BH	S	PL	2000	4	2014.01.31