

### FOR TENDER PURPOSES ONLY

ACCESS ROADS (M 200-250 LHS)		N131-13		N131-13	
NAME	CH	Y	X	NAME	CH
MOUNT	6500	1110	2000	MOUNT	6500
TRNSMT	1110	2000	2000	TRNSMT	1110
CAL COORDINATES (WGS 84 (LO 20))					
N	E	Y	X	N	E
2000	40000	2000	2000	2000	40000
N131-13		N131-13		N131-13	
NAME	CH	Y	X	NAME	CH
MOUNT	6500	1110	2000	MOUNT	6500
TRNSMT	1110	2000	2000	TRNSMT	1110

ACCESS ROADS (M 200-250 LHS)		N131-13	
NAME	CH	Y	X
MOUNT	6500	1110	2000
TRNSMT	1110	2000	2000
CAL COORDINATES (WGS 84 (LO 20))			
N	E	Y	X
2000	40000	2000	2000
N131-13			
NAME	CH	Y	X
MOUNT	6500	1110	2000
TRNSMT	1110	2000	2000

PROJECT DESCRIPTION	
REHABILITATION OF NATIONAL ROUTE M1 SECTION 13 FROM MOKOPANE (Km 1310) TO 95th INTERSECTION (Km 8340)	
LAYOUT PLAN N13-1:1	
1m 2000 - Km 3,000	
SCALE: 1:1 2000	

PROJECT NUMBER	
NRA N-011-00-001	
START	
END	
SECTION	
LAYOUT TYPE	
DRAWING TYPE	
DRAWING DISTANCE	
CONSULTANT DRAWING NO.	
PROJECT DOCUMENT F	
SHEET 2 OF 24	

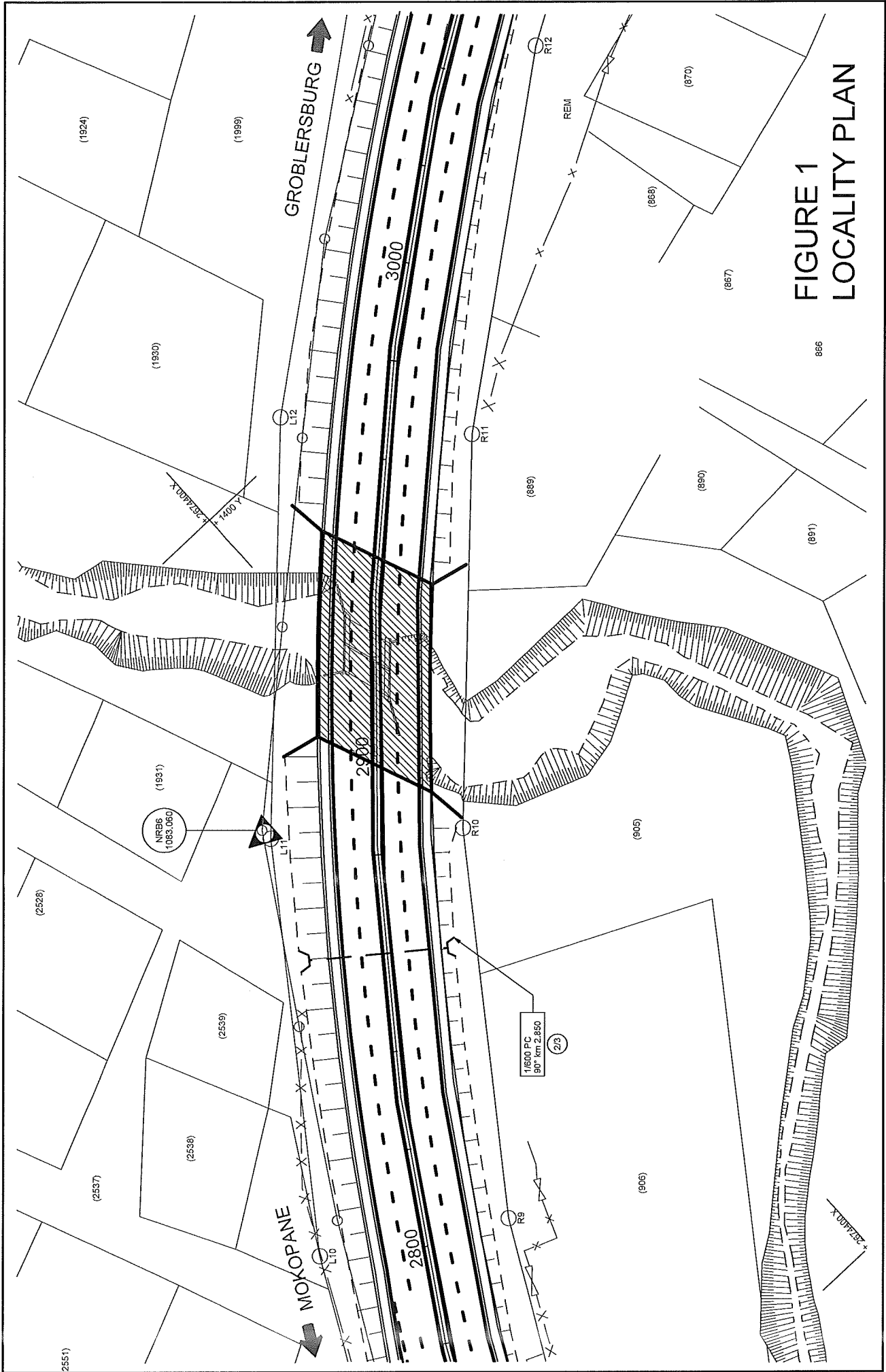
HEAD OFFICE	
SAFRICA	Private Bag 477 Uphington 2006
TEL: (012) 438 8000	FAX: (012) 438 8000

REVISIONS		
NO.	DATE	REVISION

ITEM SERVICE	
DESCRIPTION	ITEM SERVICE
RELOCATION OF TELEPHONE TO 10M MAIN HIGHWAY ROAD	
RELOCATE OPT TELEPHONE TO 10M MAIN HIGHWAY ROAD	
RELOCATE OPT TELEPHONE TO 10M MAIN HIGHWAY ROAD	
RELOCATE OPT TELEPHONE TO 10M MAIN HIGHWAY ROAD	
RELOCATE OPT TELEPHONE TO 10M MAIN HIGHWAY ROAD	
RELOCATE OPT TELEPHONE TO 10M MAIN HIGHWAY ROAD	
RELOCATE OPT TELEPHONE TO 10M MAIN HIGHWAY ROAD	
RELOCATE OPT TELEPHONE TO 10M MAIN HIGHWAY ROAD	
RELOCATE OPT TELEPHONE TO 10M MAIN HIGHWAY ROAD	
RELOCATE OPT TELEPHONE TO 10M MAIN HIGHWAY ROAD	

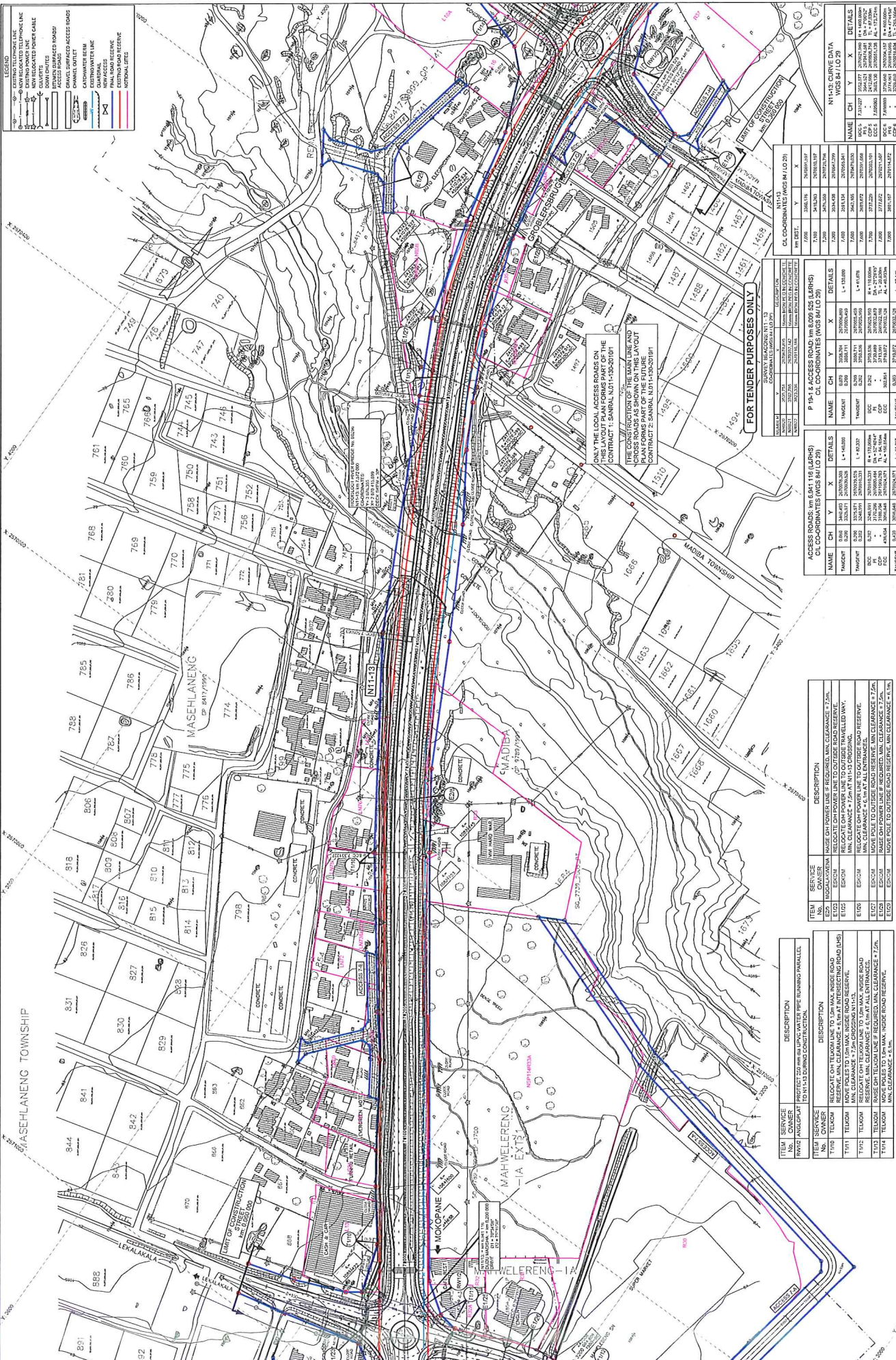
WorleyParsons





**FIGURE 1  
LOCALITY PLAN**

- LEGEND**
- 100- EXTENDING TELEPHONE LINE
  - 101- NEW 10KV RELAYED TELEPHONE LINE
  - 102- EXISTING 10KV TELEPHONE LINE
  - 103- NEW 10KV POWER CABLE
  - 104- EXISTING 10KV POWER CABLE
  - 105- DOWN SPIRES
  - 106- 10KV MOUNTING BRACKETS
  - 107- 10KV SURFACE ACCESS ROADS
  - 108- CHANNEL DRAINAGE
  - 109- GROUNDWATER
  - 110- EXISTING TELEPHONE LINE
  - 111- EXISTING POWER LINE
  - 112- EXISTING ROAD RESERVE
  - 113- EXISTING ROAD
  - 114- EXISTING TELEPHONE LINE
  - 115- EXISTING POWER LINE
  - 116- EXISTING ROAD RESERVE
  - 117- EXISTING ROAD



**WY14-3 CURVE DATA (WSS B/L 2.0)**

NAME	CH	Y	X	DETAILS
WY14-3	CH	Y	X	DETAILS

**CL COORDINATES (WSS M/L 2.0)**

STATION	CL COORDINATE
1	7390.00
2	7400.00
3	7410.00
4	7420.00
5	7430.00
6	7440.00
7	7450.00
8	7460.00
9	7470.00
10	7480.00

**P 19.3 X ACCESS ROAD, IN/300 (L/R) (B) (S)**

NAME	CH	Y	X	DETAILS
P 19.3 X	CH	Y	X	DETAILS

**ACCESS ROAD, IN/300 (L/R) (B) (S)**

NAME	CH	Y	X	DETAILS
ACCESS ROAD	CH	Y	X	DETAILS

**ITEM SERVICE DESCRIPTION**

ITEM	SERVICE	DESCRIPTION
E100	ESD/CM	BASE ON POWER LINE IF REQUIRED, MIN CLEARANCE 7.0M.
E101	ESD/CM	RELOCATE ON POWER LINE TO OUTSIDE ROAD RESERVE.
E102	ESD/CM	RELOCATE ON TELEPHONE LINE TO OUTSIDE ROAD RESERVE. MIN CLEARANCE 4.5M AT ALL CROSSINGS.
E103	ESD/CM	RELOCATE ON TELEPHONE LINE TO INSIDE ROAD RESERVE.
E104	ESD/CM	RELOCATE ON TELEPHONE LINE TO 10M MAX INSIDE ROAD RESERVE. MIN CLEARANCE 4.5M AT ALL ENTRANCES.
E105	ESD/CM	RELOCATE ON TELEPHONE LINE TO 10M MAX INSIDE ROAD RESERVE. MIN CLEARANCE 7.0M.
E106	ESD/CM	MOVE POLES TO 10M MAX INSIDE ROAD RESERVE. MIN CLEARANCE 4.5M.

**ONLY THE LOCAL ACCESS ROADS ON CONTRACT 1: SANRAL N011-18-2010/011**

**THE CONSTRUCTION OF THE MAIN LINE AND PLAN FORMS PART OF THE FUTURE CONTRACT 2: SANRAL N011-18-2010/011**

**FOR TENDER PURPOSES ONLY**

NAME	CH	Y	X	DETAILS
ITEM 1	CH	Y	X	DETAILS

**ITEM SERVICE DESCRIPTION**

ITEM	SERVICE	DESCRIPTION
N1	CONCRETE	CONCRETE

**PROJECT DESCRIPTION**

REHABILITATION OF NATIONAL ROUTE M1 SECTION 13 FROM MOKOPANE (km 13+10) TO R519 INTERSECTION (km 18+40)

**LAYOUT PLAN M1+142**  
km 7,000 - km 8,000

**SCALE: 1:1,000**

**PROJECT NUMBER** NRA N011-18-2010/011  
**DRAWING LOCATION** START 13 END 13  
**DRAWING TYPE** LAYOUT PLAN  
**DRAWING DATE** 2010/07/27  
**CONSULTANT DRAWING #** 2310000040241

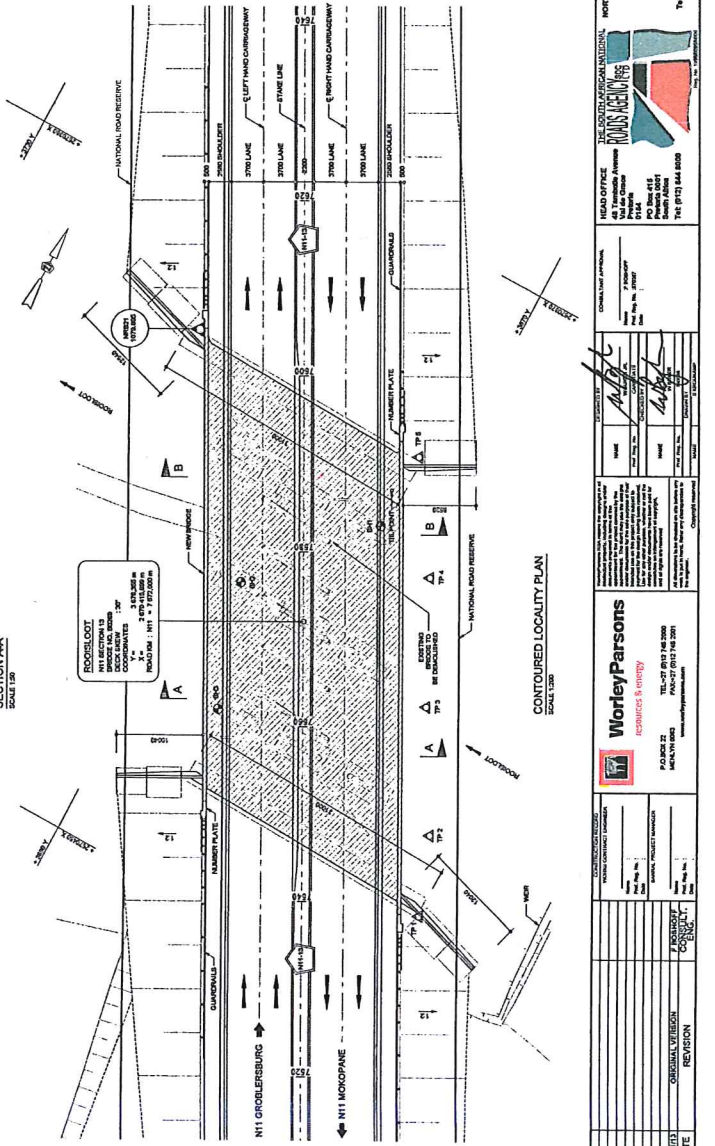
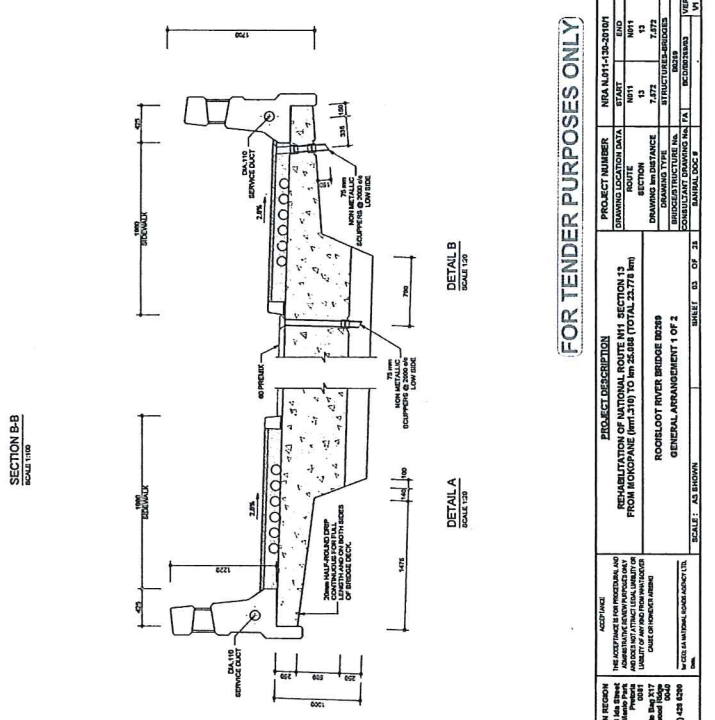
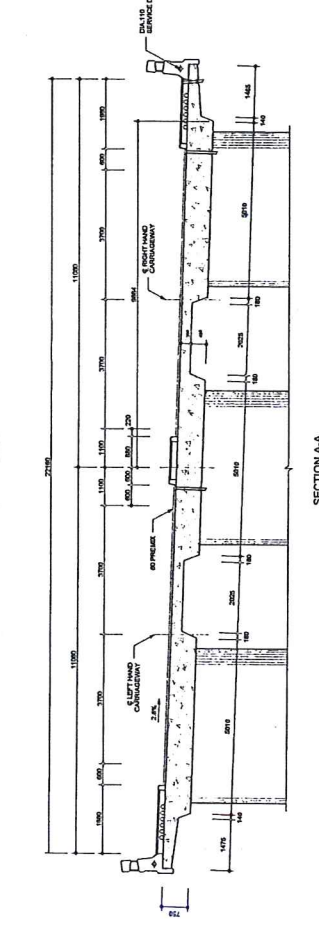
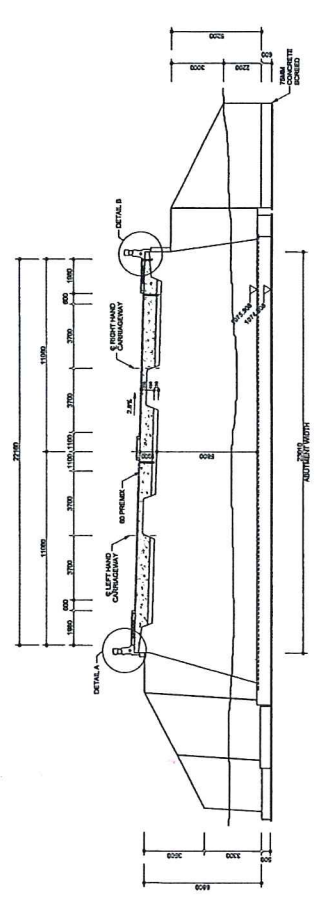
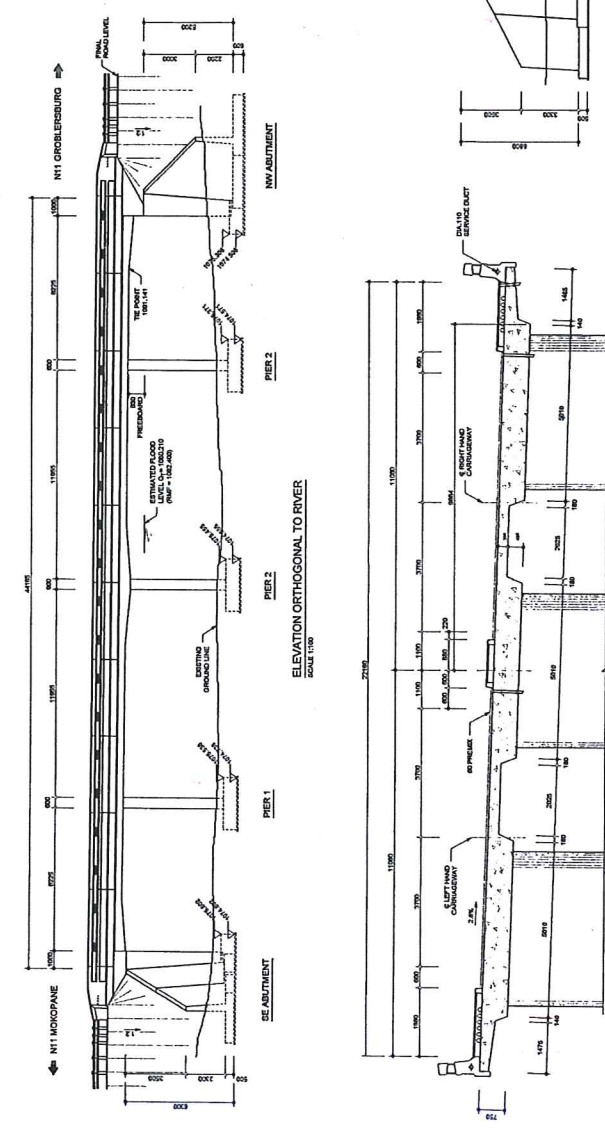
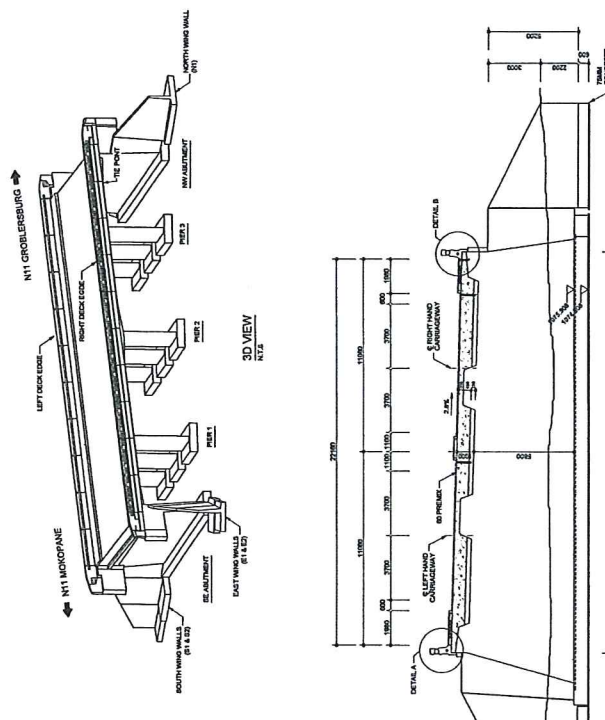
**HEAD OFFICE**  
SANRAL  
PO Box 115  
SARIS AFRICA  
TEL: (012) 844 8000

**PROJECT OFFICE**  
SANRAL  
PO Box 115  
SARIS AFRICA  
TEL: (012) 844 8000

**WorleyParsons**  
PROJECT & DESIGN  
P.O. BOX 22  
MONTELEONE  
TEL: (012) 844 8000  
FAX: (012) 844 8001  
www.worleyparsons.com

**REVISION**

NO.	DATE	DESCRIPTION
1		ISSUED FOR CONSTRUCTION

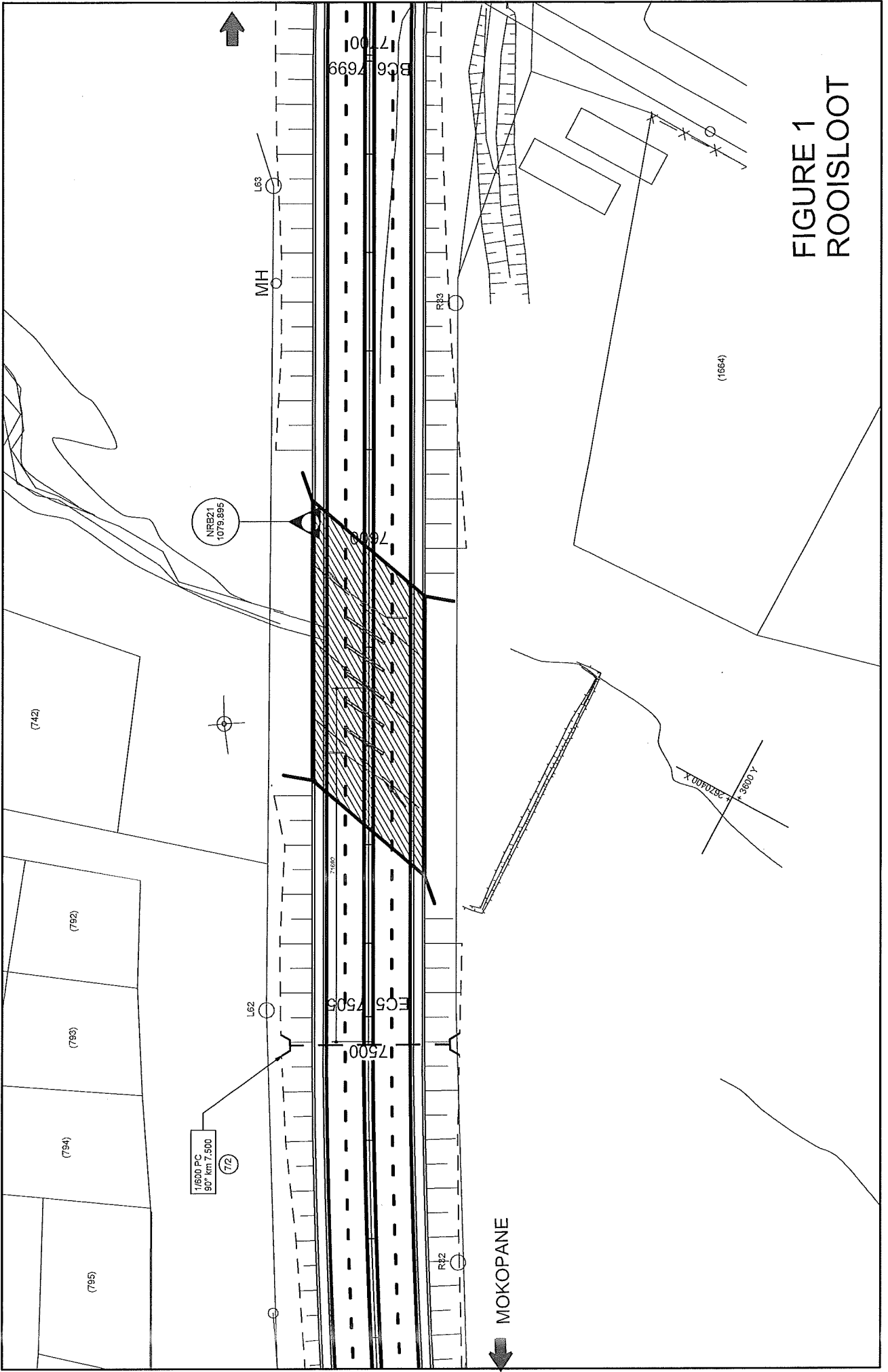


**FOR TENDER PURPOSES ONLY**

<b>PROJECT NUMBER</b> MWA 141-135-2014		<b>PROJECT DESCRIPTION</b> REHABILITATION OF N11 SECTION 14 FROM MOKOPANE (BP1-210) TO N2-258 (TOTAL 23.778 km)	
<b>DESIGNED BY</b> WSP   PARSONS		<b>SECTION</b> SECTION 14	
<b>DATE</b> 13 MAR 2014		<b>SCALE</b> AS SHOWN	
<b>PROJECT LOCATION</b> ROBELOOT RIVER BRIDGE 0209		<b>GENERAL ARRANGEMENT 1 OF 2</b>	
<b>APPROVED FOR TENDER</b> THE OFFICE OF THE DIRECTOR GENERAL OF ROADS AND TRANSPORT 100 WATERLOO STREET, WINDYBUSH, KZN 3600 TEL: 033 312 423 0200 FAX: 033 312 423 0200		<b>SCALE</b> AS SHOWN	
<b>DESIGNED BY</b> WSP   PARSONS		<b>SECTION</b> SECTION 14	
<b>DATE</b> 13 MAR 2014		<b>SCALE</b> AS SHOWN	
<b>PROJECT LOCATION</b> ROBELOOT RIVER BRIDGE 0209		<b>GENERAL ARRANGEMENT 1 OF 2</b>	
<b>APPROVED FOR TENDER</b> THE OFFICE OF THE DIRECTOR GENERAL OF ROADS AND TRANSPORT 100 WATERLOO STREET, WINDYBUSH, KZN 3600 TEL: 033 312 423 0200 FAX: 033 312 423 0200		<b>SCALE</b> AS SHOWN	

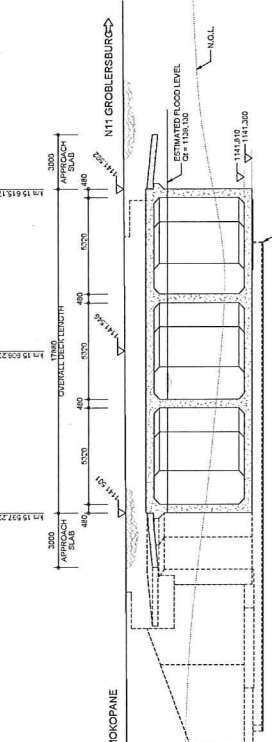


NO.	DATE	REVISION	BY	FOR

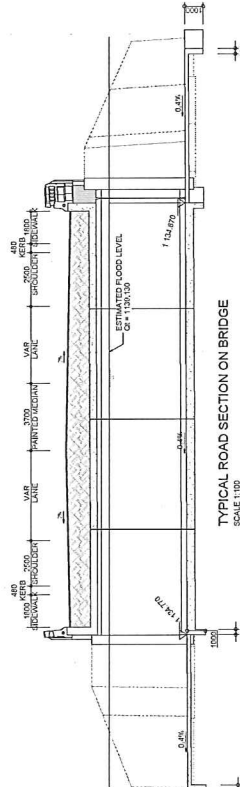


**FIGURE 1**  
**ROOISLOOT**

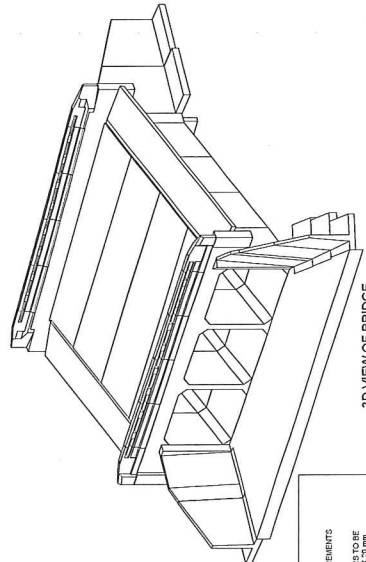




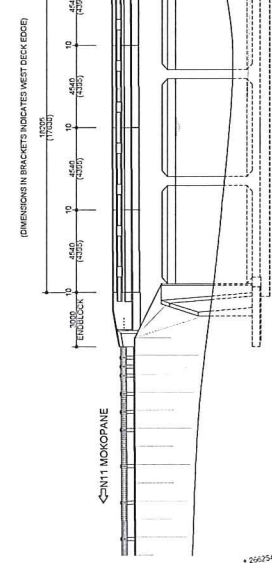
LONGITUDINAL SECTION ALONG Q



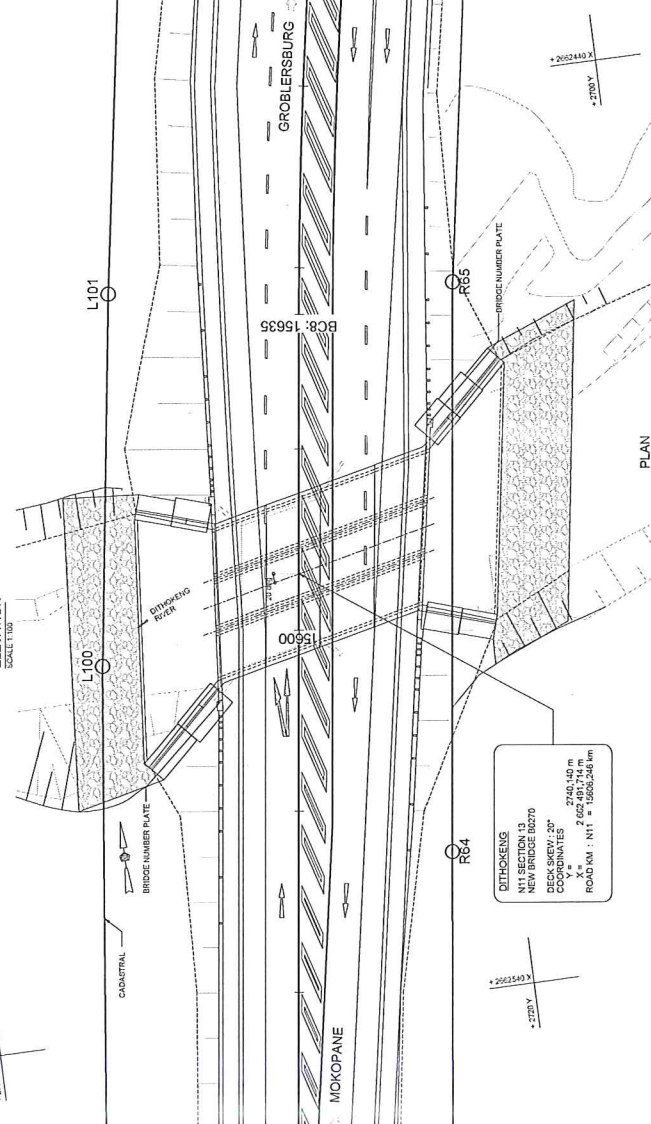
TYPICAL ROAD SECTION ON BRIDGE



3D VIEW OF BRIDGE



ELEVATION



PLAN

GENERAL ARRANGEMENT NOTES

- 1. CONSTRUCTION AND DESIGN CRITERIA
2. DESIGN CRITERIA
3. STRUCTURAL ANALYSIS AND PARAMETERS
4. MATERIALS
5. CONSTRUCTION REQUIREMENTS

FOR TENDER PURPOSES ONLY

Table with project information including Project Number (NRA N01-1300-01), Drawing Location Data, and Project Name.

Table with drawing details including Drawing No. (R510), Drawing Title (REINFORCED CONCRETE BRIDGE DECK), and Client (SANRAL).

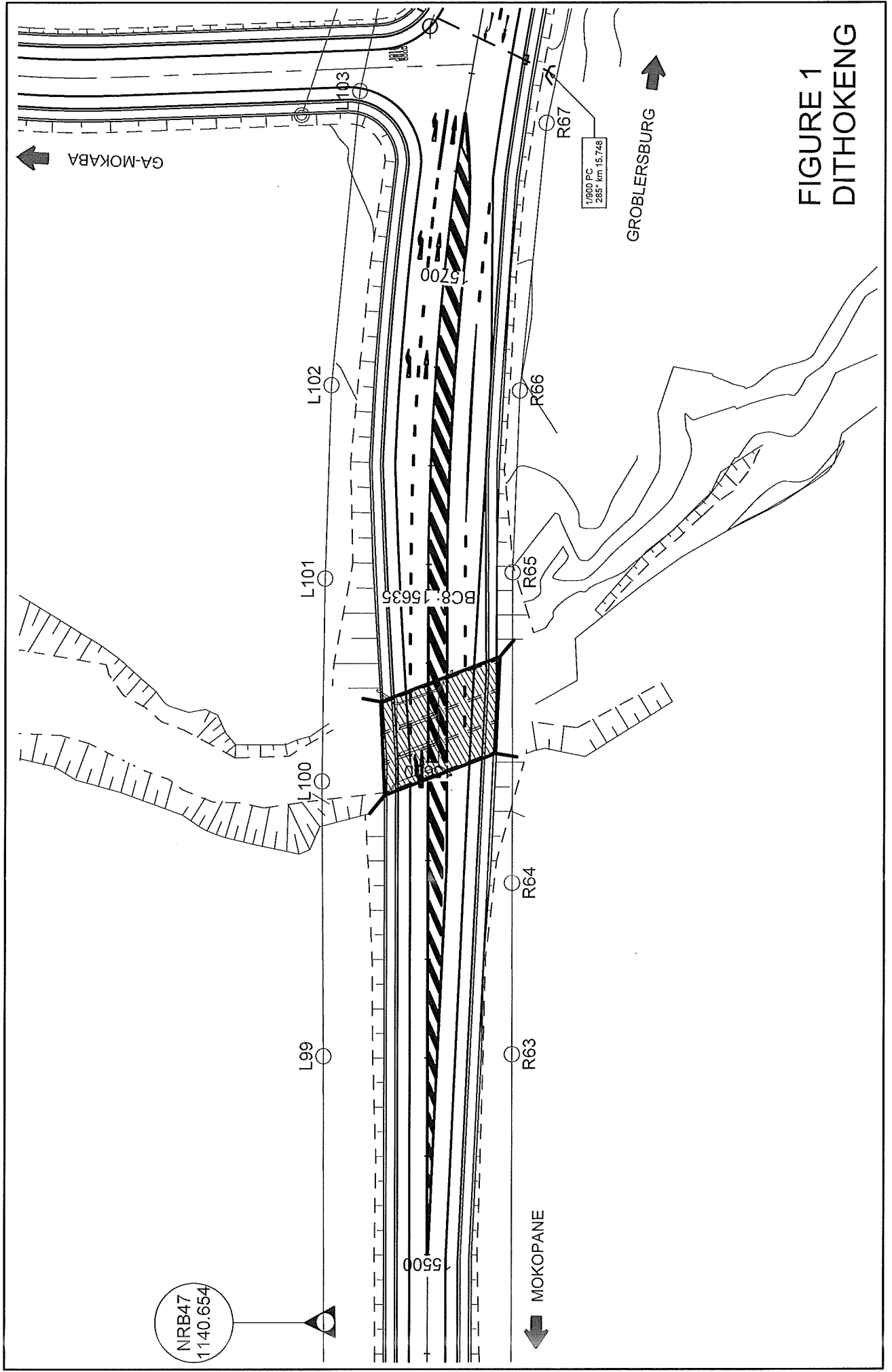
Table with project location information including Eastern Region, Road No. (R510), and Project Name (DITHOKENS RIVER BRIDGE).

Table with design and construction details including Date (2013/07/29), Designer (M. S. DUBE), and Checker (G. S. DUBE).

Table with revision history including No., Date, Description, and Revisions.

Table with project information including Project Name (REHABILITATION OF NATIONAL ROUTE N11 SECTION 13 FROM R510 INTERSECTION TO B340 TO GROETANSLOOT RIVER), Project No. (R510), and Client (SANRAL).





**FIGURE 1**  
**DITHOKENG**