

APPLICATION TO AMAFA HERITAGE AKWAZULU
NATALI
FOR
DEVIATIONS TO APPROVED
PLAN
NO. 217 03 12
OF
ERF 678, Portion 2 & 17 of
348 Florida Road, Morning side, Durban

Amafa Application –Deviations
To Approved Plan No. 217 03 12
ERF 678, Portion 2 & 17 of
348 Florida Road, Morning side,
Durban



250 Umhlang Roacks Drive
P.O Box 4096
The Square
4021

Tel: 031 566 4424
Email: info@hardblack-architects.co.za

Contents

- Amafa Application
- Motivation
- Locality Plan 1
- Locality Plan 2
- Site Location Plan
- Street Photographs With Adjacent Buildings
- Site Photographs
- Proof Of Professional Accreditation
- Proof Of Payment
- Attached New plan
- Attached Existing Plan

Amafa Application –Deviations
To Approved Plan No. 217 03 12
ERF 678, Portion 2 & 17 of
348 Florida Road, Morning side,
Durban

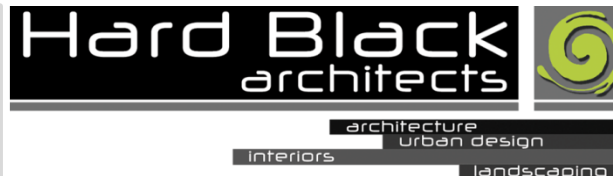

250 Umhlanga Rocks Drive
P.O Box 4096
The Square
4021

Tel: 031 566 4424
Email: info@hardblack-architects.co.za

RE: MOTIVATION FOR PORTION 2 & 17 OF ERF 678, 348 FLORIDA ROAD, MORNINING SIDE, DURBAN

As the official Architectural applicant appointed for deviations to the above-mentioned project, my client would like to do require permit for the deviations complete

Mr K Chinniah, my client, has recently completed the renovations as per the approved plan No 217 03 12 attached. He has devated from the plan and requires Amafa KZN Hertiage approval to proced further.

He has been givin a permit from the prevoius drawings. The changes are minor and only affects the south east elevation.

The changes are listed as follows:

- 1 – Existing door removed from south east façade & bricked up.
- 2 - Door moved into internal laundry room wall.
- 3 - Hand wash basin moved to external side

In conclusion, we are very eager to continue to get all documentation in order for personal & council usage. We are adamant that with the support of the Amafa Heritage and local authority we will be able to achieve our goal.

I trust that this application will be viewed favourably by the committee.

Thank you,
Regards,
HB Architects

Motivation

Amafa Application –Deviations
To Approved Plan No. 217 03 12
ERF 678, Portion 2 & 17 of
348 Florida Road, Morning side,
Durban





Site Locality Plan 1

Amafa Application –Deviations
To Approved Plan No. 217 03 12
ERF 678, Portion 2 & 17 of
348 Florida Road, Morning side,
Durban

Hard Black
architects



architecture
interiors urban design
 landscaping

mm — designs
architecture

M. Moodley
13 Earl Hall Road
Morningside
Tel. 031 2071943 / 0837880890
S.A.C.A.P. Reg no. S.T. 1022
mmoodley@abemmail.co.za

250 Umhlanga Rocks Drive
P.O Box 4096
The Square
4021

Tel: 031 566 4424
Email: info@hardblack-architects.co.za

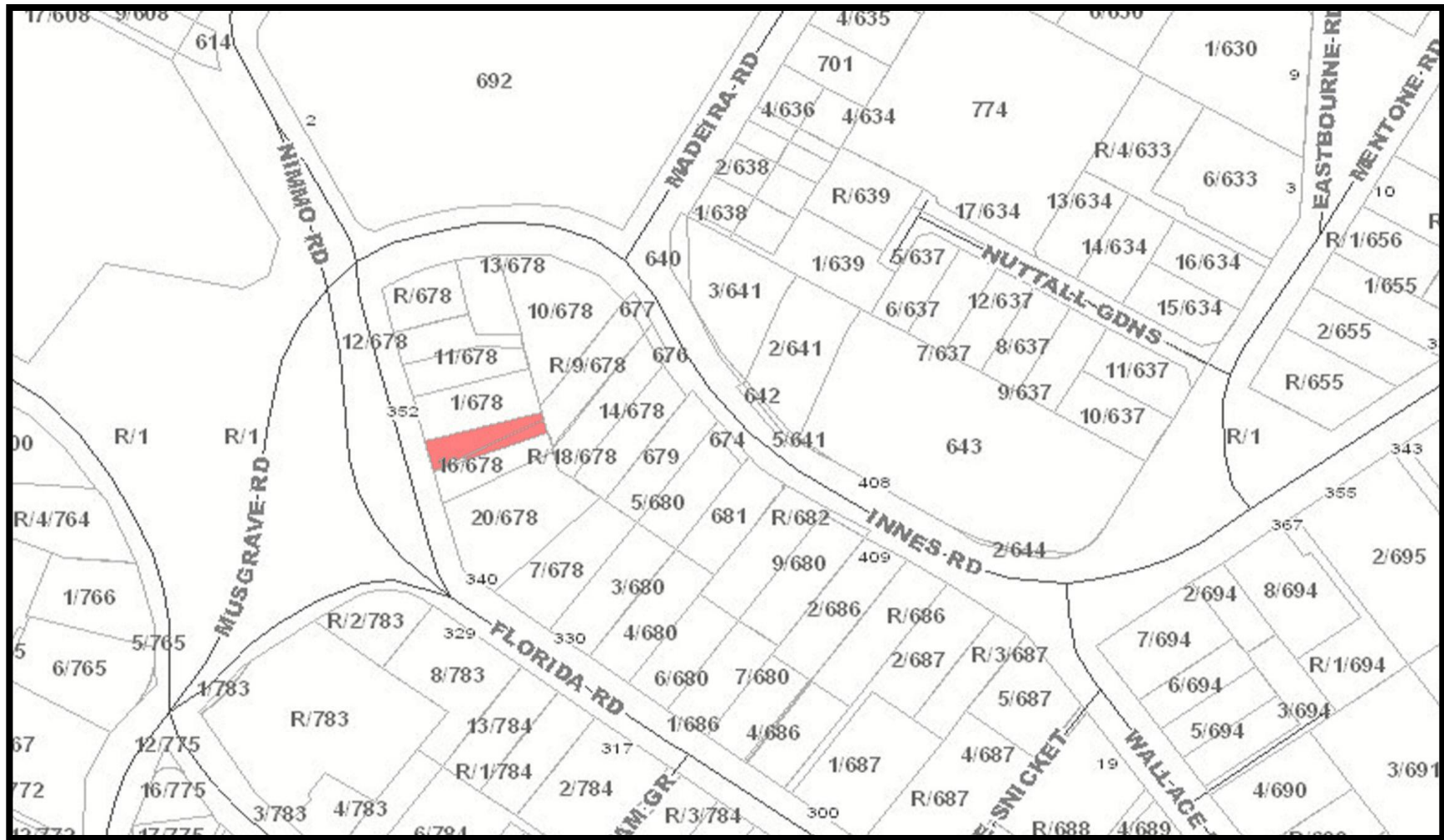

Site Locality Plan 2

Amafa Application –Deviations
To Approved Plan No. 217 03 12
ERF 678, Portion 2 & 17 of
348 Florida Road, Morning side,
Durban



architecture
interiors urban design
landscaping

mm — designs
architecture

M.Moodley
13 Earl Holz Road
Morningside
Tel. 031 2071943 / 0837880890
S.A.C.A.P. Reg no. S.T. 1022
mmoodley@abesmail.co.za

250 Umhlanga Rocks Drive
P.O Box 4096
The Square
4021

Tel: 031 566 4424
Email: info@hardblack-architects.co.za



Site Location Plan

Amafa Application –Deviations
To Approved Plan No. 217 03 12
ERF 678, Portion 2 & 17 of
348 Florida Road, Morning side,
Durban



250 Umhlanga Rocks Drive
P.O Box 4096
The Square
4021

Tel: 031 566 4424
Email: info@hardblack-architects.co.za



348 Florida Road

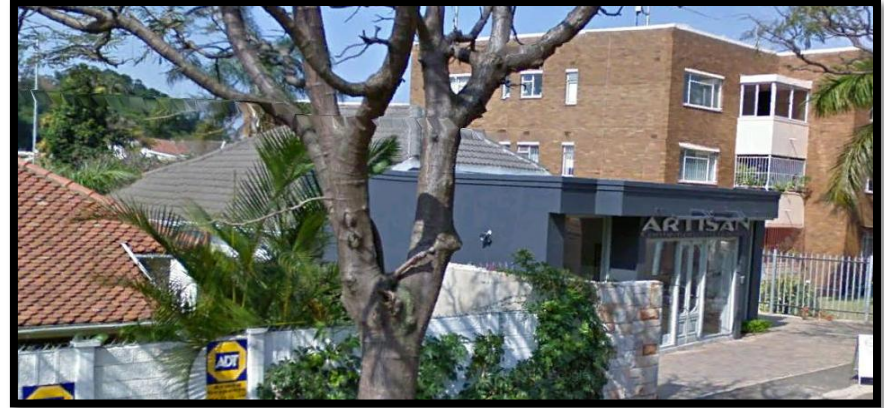

345 Florida Road

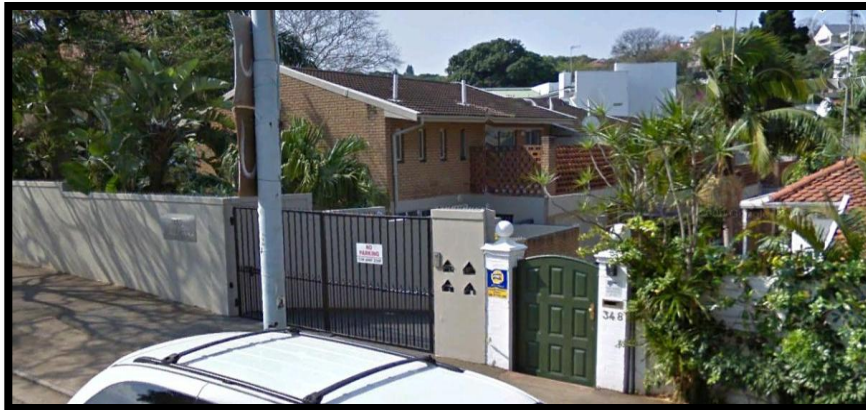

352 Florida Road



Driveway Access for Neighboring Sites From Innes Road

Street Photographs

Amafa Application –Deviations
To Approved Plan No. 217 03 12
ERF 678, Portion 2 & 17 of
348 Florida Road, Morning side,
Durban



250 Umhlanga Rocks Drive
P.O Box 4096
The Square
4021

Tel: 031 566 4424
Email: info@hardblack-architects.co.za



1 – Existing Door removed from south east façade & bricked up, door moved into internal laundry room wall.

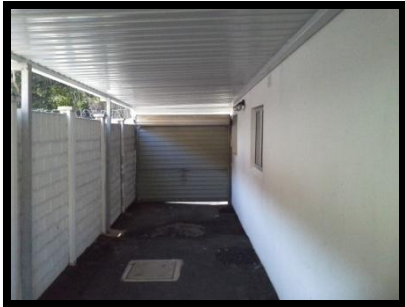

2 – Hand wash basin moved to external side.

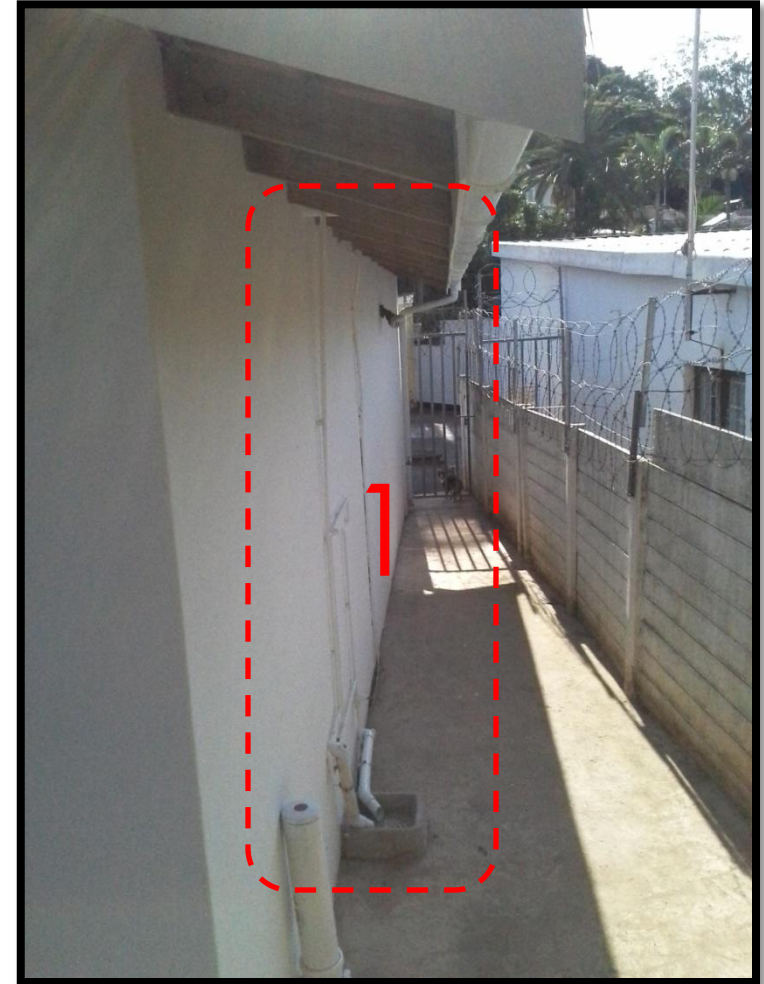

Street Photographs

Amafa Application –Deviations
To Approved Plan No. 217 03 12
ERF 678, Portion 2 & 17 of
348 Florida Road, Morning side,
Durban

Hard Black
architects

architecture
urban design
interiors
landscaping

mm — designs
architecture

M.Moodley
13 Earl Hall Road
Morningside
Tel. 031 2071943 / 0837880890
S.A.C.A.P. Reg no. S.T. 1022
mmoodley@abemmail.co.za

250 Umhlanga Rocks Drive
P.O Box 4096
The Square
4021

Tel: 031 566 4424
Email: info@hardblack-architects.co.za