

Goodman Mahlangu

From: Goodman Mahlangu
Sent: Thursday, 03 August 2023 09:54
To: 'lance.denc@gmail.com'
Subject: Proposed Construction of the New SKA1 Mid EOC at SARAQ Karoo Support Base on the Klerefontein Farm
Attachments: P22159 SARAQ SKA_BACKGROUND INFORMATION DOCUMENT_REV 00.pdf

Good day,

Delta Built Environment Consultants (Delta BEC) has been appointed by South African Radio Astronomy Observatory (SARAQ), which is a National Facility of the and National Research Foundation (NRF), to conduct the Environmental Authorisation process (via a Basic Assessment) for the proposed construction of the New SKA1 Mid Engineering Operations Centre Building (EOC) at SARAQ Karoo Support Base on the Klerefontein farm near Carnarvon, Northern Cape.

The SKA1-MID Engineering Operations Centre (EOC) will be an expansion of the current infrastructure on site where the current workshops will be expanded as a singular building to incorporate:

1. New office space
2. Additional workshops
3. Expansion of generator facilities and diesel storage

There is also a second building on site which is the old farmhouse which will remain unaltered as it is more than 60 years old and is therefore protected by the National Heritage Resources Act (Act 25 of 1995).



As part of the Environmental Authorisation application process, Provincial and Local Authorities are invited to review and comment on the attached Background Information Document as part of the Public Participation Phase for this project. The Draft Basic Assessment Report (EA) can be found in the Dropbox link below.

Link: <https://www.dropbox.com/scl/fo/vb8nv2icazp35v5sxep2s/h?rlkey=n9tkv6verj4l7qeoxec19xgz3&dl=0>

All comments received will be addressed and included in the Draft Basic Assessment Report before its final submission to the Department of Forestry, Fisheries, and the Environment (DFFE).

If you require any further information, feel free to notify us of the same.

Kind Regards,



Goodman Mahlangu
Environmental Scientist



(e) goodman.mahlangu@deltabec.com (w) www.deltabec.com

(c) 081 754 9586 (f) 012 368 1850 (f) 012 348 4738 (a) Rynlal Centre, Lynnwood, 0180

Delta Built Environment Consultants is a B-BBEE Level 1 Contributor



Delta BEC is ISO **9001**, **45001**, **14001** certified.

Goodman Mahlangu

From: Goodman Mahlangu
Sent: Thursday, 03 August 2023 09:52
To: 'snkondeshe@pksdm.gov.za'
Subject: Proposed Construction of the New SKA1 Mid EOC at SARAO Karoo Support Base on the Klerefontein Farm
Attachments: P22159 SARAO SKA_BACKGROUND INFORMATION DOCUMENT_REV 00.pdf

Good day,

Delta Built Environment Consultants (Delta BEC) has been appointed by South African Radio Astronomy Observatory (SARAO), which is a National Facility of the and National Research Foundation (NRF), to conduct the Environmental Authorisation process (via a Basic Assessment) for the proposed construction of the New SKA1 Mid Engineering Operations Centre Building (EOC) at SARAO Karoo Support Base on the Klerefontein farm near Carnarvon, Northern Cape.

The SKA1-MID Engineering Operations Centre (EOC) will be an expansion of the current infrastructure on site where the current workshops will be expanded as a singular building to incorporate:

1. New office space
2. Additional workshops
3. Expansion of generator facilities and diesel storage

There is also a second building on site which is the old farmhouse which will remain unaltered as it is more than 60 years old and is therefore protected by the National Heritage Resources Act (Act 25 of 1995).

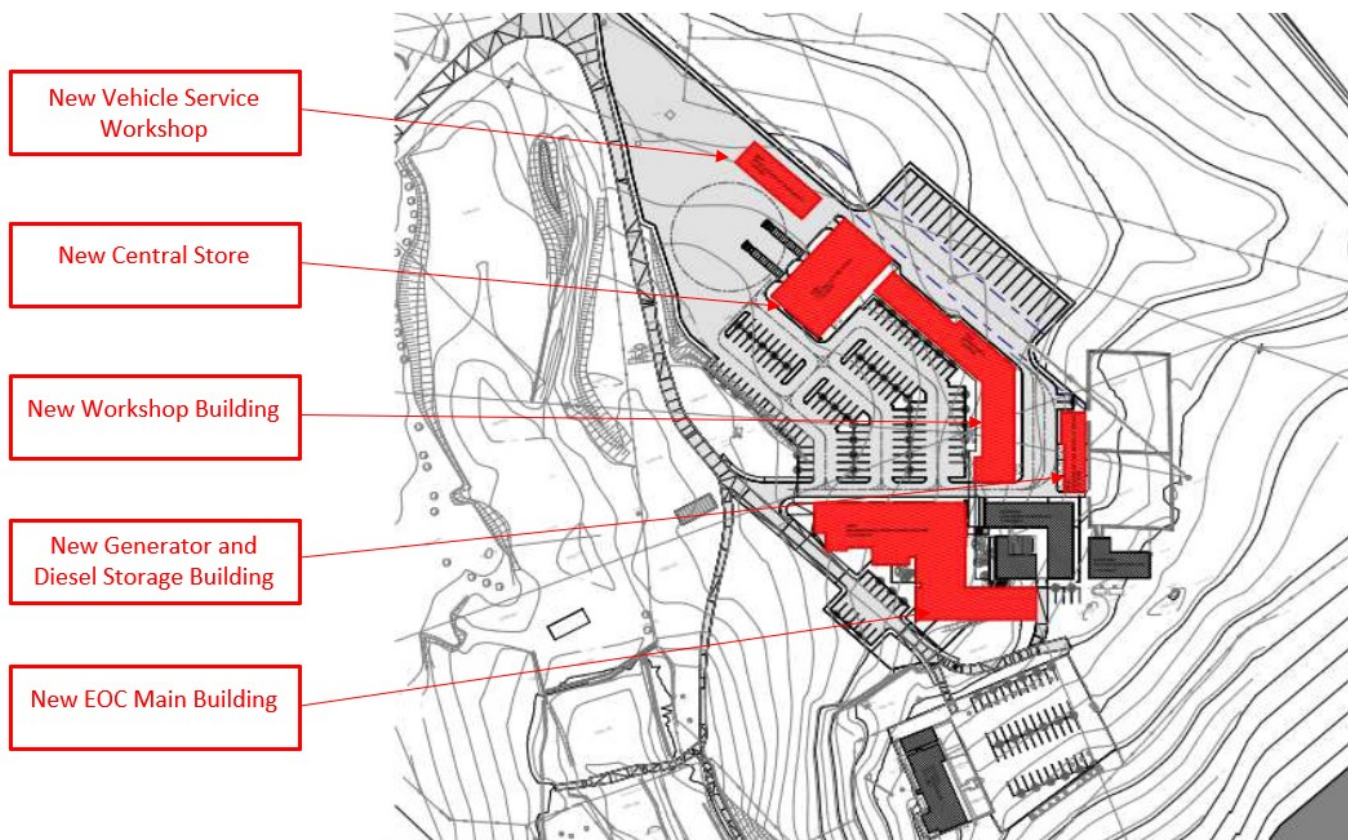

As part of the Environmental Authorisation application process, Provincial and Local Authorities are invited to review and comment on the attached Background Information Document as part of the Public Participation Phase for this project. The Draft Basic Assessment Report (EA) can be found in the Dropbox link below.

Link: <https://www.dropbox.com/scl/fo/vb8nv2icazp35v5sxep2s/h?rlkey=n9tkv6verj4l7qeoxec19xgz3&dl=0>

All comments received will be addressed and included in the Draft Basic Assessment Report before its final submission to the Department of Forestry, Fisheries, and the Environment (DFFE).

If you require any further information, feel free to notify us of the same.

Kind Regards,



Goodman Mahlangu
Environmental Scientist



(e) goodman.mahlangu@deltabec.com (w) www.deltabec.com

(c) 081 754 9586 (f) 012 368 1850 (f) 012 348 4738 (a) Rynlal Centre, Lynnwood, 0180

Delta Built Environment Consultants is a B-BBEE Level 1 Contributor



Delta BEC is ISO **9001**, **45001**, **14001** certified.

Goodman Mahlangu

From: Goodman Mahlangu
Sent: Wednesday, 02 August 2023 15:53
To: 'rtimothy@ngkb.org.za'
Subject: Proposed Construction of the New SKA1 Mid EOC at SARAO Karoo Support Base on the Klerefontein Farm
Attachments: P22159 SARAO SKA_BACKGROUND INFORMATION DOCUMENT_REV 00.pdf

Good day,

Delta Built Environment Consultants (Delta BEC) has been appointed by South African Radio Astronomy Observatory (SARAO), which is a National Facility of the and National Research Foundation (NRF), to conduct the Environmental Authorisation process (via a Basic Assessment) for the proposed construction of the New SKA1 Mid Engineering Operations Centre Building (EOC) at SARAO Karoo Support Base on the Klerefontein farm near Carnarvon, Northern Cape.

The SKA1-MID Engineering Operations Centre (EOC) will be an expansion of the current infrastructure on site where the current workshops will be expanded as a singular building to incorporate:

1. New office space
2. Additional workshops
3. Expansion of generator facilities and diesel storage

There is also a second building on site which is the old farmhouse which will remain unaltered as it is more than 60 years old and is therefore protected by the National Heritage Resources Act (Act 25 of 1995).



As part of the Environmental Authorisation application process, Provincial and Local Authorities are invited to review and comment on the attached Background Information Document as part of the Public Participation Phase for this project. The Draft Basic Assessment Report (EA) can be found in the Dropbox link below.

Link: <https://www.dropbox.com/scl/fo/vb8nv2icazp35v5sxep2s/h?rlkey=n9tkv6verj4l7qeoxec19xgz3&dl=0>

All comments received will be addressed and included in the Draft Basic Assessment Report before its final submission to the Department of Forestry, Fisheries, and the Environment (DFFE).

If you require any further information, feel free to notify us of the same.

Kind Regards,



Goodman Mahlangu

Environmental Scientist

(e) goodman.mahlangu@deltabec.com (w) www.deltabec.com

(c) 081 754 9586 (t) 012 368 1850 (f) 012 348 4738 (a) Rynlal Centre, Lynnwood, 0180



Delta Built Environment Consultants is a B-BBEE Level 1 Contributor

 Delta BEC is ISO **9001**, **45001**, **14001** certified.

Goodman Mahlangu

From: Goodman Mahlangu
Sent: Friday, 04 August 2023 14:27
To: 'BCAdmin@dffe.gov.za'
Subject: Proposed Construction of the New SKA1 Mid EOC at SARAO Karoo Support Base on the Klerefontein Farm
Attachments: P22159 SARAO SKA_BACKGROUND INFORMATION DOCUMENT_REV 00.pdf

Good day,

Delta Built Environment Consultants (Delta BEC) has been appointed by South African Radio Astronomy Observatory (SARAO), which is a National Facility of the and National Research Foundation (NRF), to conduct the Environmental Authorisation process (via a Basic Assessment) for the proposed construction of the New SKA1 Mid Engineering Operations Centre Building (EOC) at SARAO Karoo Support Base on the Klerefontein farm near Carnarvon, Northern Cape.

The SKA1-MID Engineering Operations Centre (EOC) will be an expansion of the current infrastructure on site where the current workshops will be expanded as a singular building to incorporate:

1. New office space
2. Additional workshops
3. Expansion of generator facilities and diesel storage

There is also a second building on site which is the old farmhouse which will remain unaltered as it is more than 60 years old and is therefore protected by the National Heritage Resources Act (Act 25 of 1995).



As part of the Environmental Authorisation application process, Provincial and Local Authorities are invited to review and comment on the attached Background Information Document as part of the Public Participation Phase for this project. The Draft Basic Assessment Report (EA) can be found in the Dropbox link below.

Link: <https://www.dropbox.com/scl/fo/vb8nv2icazp35v5sxep2s/h?rlkey=n9tkv6verj4l7qeoxec19xgz3&dl=0>

All comments received will be addressed and included in the Draft Basic Assessment Report before its final submission to the Department of Forestry, Fisheries, and the Environment (DFFE).

If you require any further information, feel free to notify us of the same.

Kind Regards,



Goodman Mahlangu
Environmental Scientist



(e) goodman.mahlangu@deltabec.com (w) www.deltabec.com

(c) 081 754 9586 (f) 012 368 1850 (f) 012 348 4738 (a) Rynlal Centre, Lynnwood, 0180

Delta Built Environment Consultants is a B-BBEE Level 1 Contributor

Delta BEC is ISO **9001**, **45001**, **14001** certified.