

SKETCH PLAN

for Mining Permit in terms of Section 27 (2) of the Mineral and Petroleum Resources Development Act, 2002 (Act No. 28/2002) for a proposed mining area situated on a Portion of the REMAINDER of the farm SYDENHAM 445

ADMINISTRATIVE DISTRICT: BLOEMFONTEIN
MANGAUNG METRO MUNICIPALITY
PROVINCE: FREE STATE

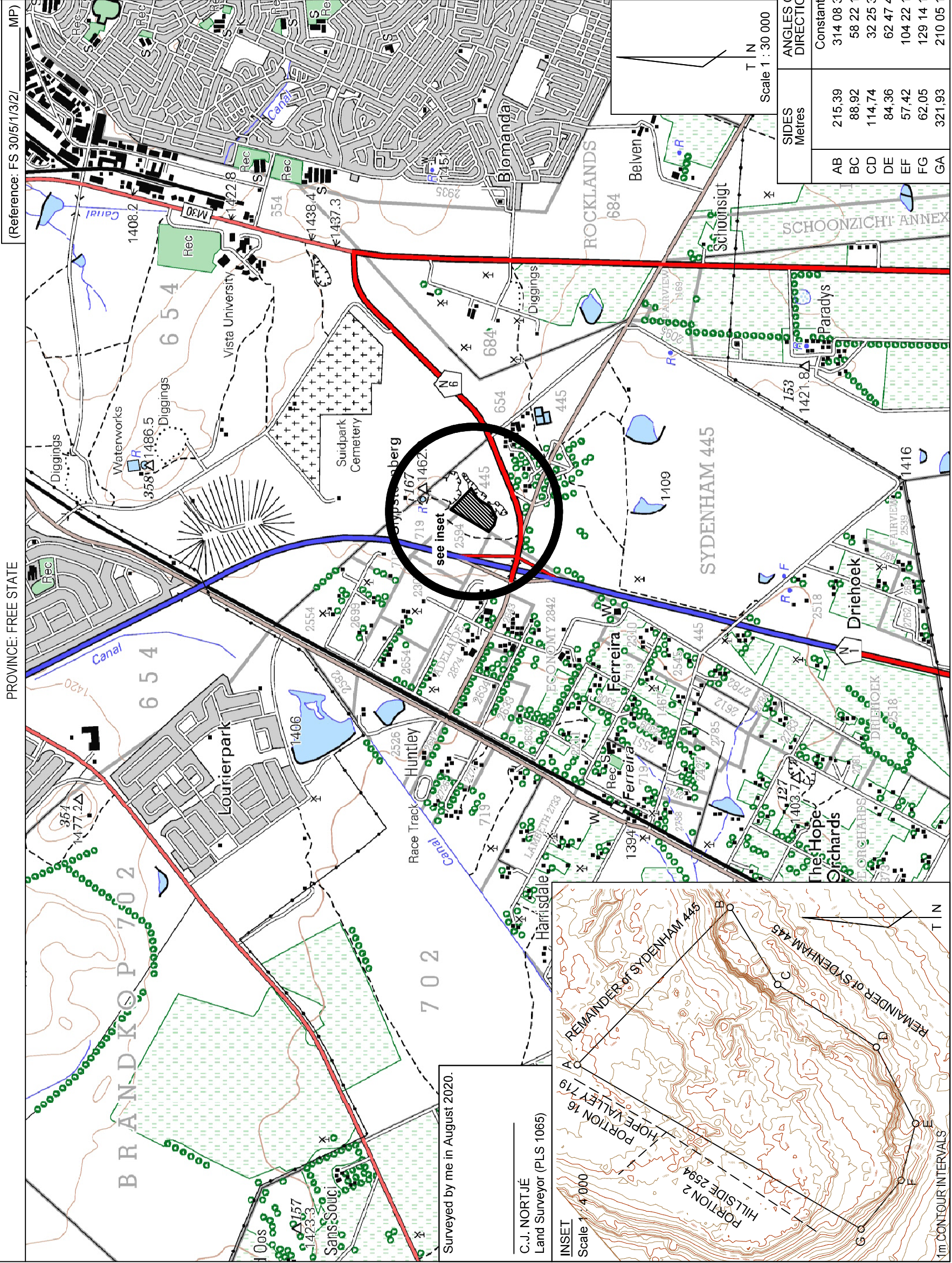

Surveyed by me in August 2020.

C.J. NORTJÉ
Land Surveyor (PLS 1065)

INSET
Scale 1 : 4 000

1m CONTOUR INTERVALS

STRUCTURAL PLAN
NUMBER
FILE NO.
OFFICE BUILDING

The figure : ABCDEFGA
represents a proposed mining permit area in extent 5,000 hectares situated on a portion of the Remaining Extent of the farm Sydenham 445,
Magisterial District Bloemfontein,
Free State Province.

Applicants:
Kenrau (Pty) Ltd
Registration No. 2018/282852/07
Po Box 100701
Kenworth
Bloemfontein
9303

Signature of Applicant
Date:
Dolly Kenney Foundation Trust
Registration No. IT000331/2020(B)
Po Box 100701
Kenworth
Bloemfontein
9303

Signature of Applicant
Date:
The Regional Manager
Department of Mineral & Energy
Private Bag X33
Welkom 9460

Date:
M + N
G E O M A T I C S
Professional Land Surveyors
PO Box 29037
Danhof
9310
Bloemfontein
9301
info@mngo.co.za
Tel. (051) 447-1401 / 447-2089
Fax. (051) 430-5789

SIDES Metres	ANGLES OF DIRECTION		CO-ORDINATES	
	Constant:	System: WG 27° X	Y	X
AB	215,39	314 08 30	0,00	+ 3 200 000,00
BC	88,92	58 22 10	A	+ 78 195,54
CD	114,74	32 25 30	B	+ 78 040,97
DE	84,36	62 47 40	C	+ 78 116,69
EF	57,42	104 22 10	D	+ 78 178,21
FG	62,05	129 14 10	E	+ 78 253,23
GA	321,93	210 05 10	F	+ 78 308,86
			G	+ 78 356,92