

1. All dimensions & levels to be checked on site prior to commencement any work
 2. Any discrepancies to be reported to Architect prior to manufacture or commencement of work
 3. This drawing to be read in conjunction with all relevant Architectural information
 4. The Architect will not be responsible for work manufactured without measurements being taken on site.
 5. Windows + Doors to be manufactured and installed in strict accordance to manufacturer's specification

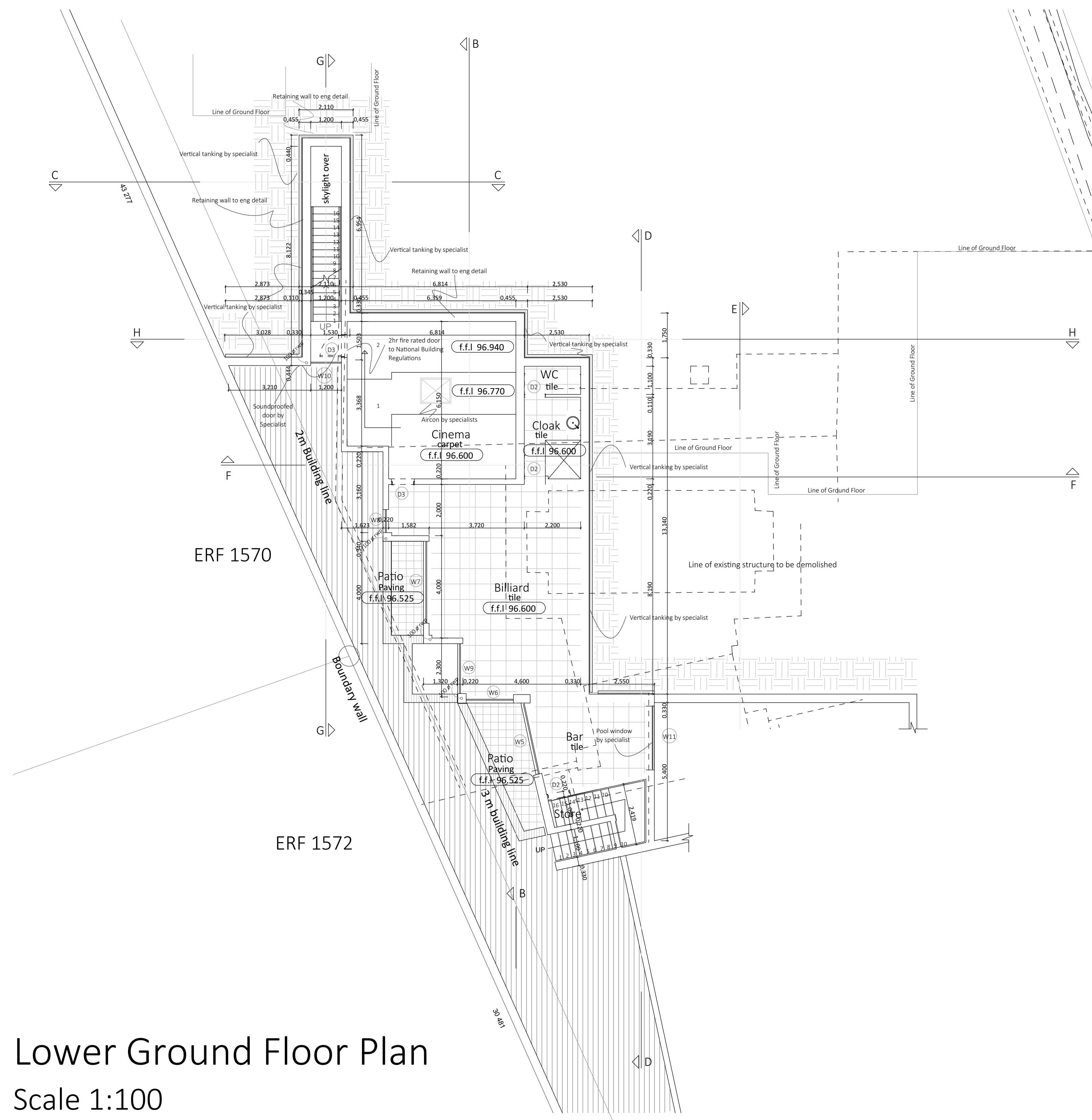

Lower Ground Floor Plan
 Scale 1:100

SCHEDULE OF AREAS	
PERMITTED F.A.R	2608.8 m ²
EXISTING F.A.R	526.10 m ²
PROPOSED F.A.R	742.40 m ²
TOTAL F.A.R	1268.47 m ²
TOTAL F.A.R IN HAND	1340.33 m ²
PERMITTED COVERAGE	1956.6 m ²
EXISTING COVERAGE	347.21 m ²
PROPOSED COVERAGE	361.90 m ²
TOTAL COVERAGE	709.11 m ²
TOTAL IN HAND	1247.50 m ²

Client sign:

Note :-
 This drawing to be read in conjunction with Structural Eng's Drawings



Professional Signature: PSAT 57192376

SACAP no.:
 PROJECT DESCRIPTION:
 PROPOSED ADDITIONS & ALTERATIONS TO EXISTING DWELLING ON ERF 1573 DURBAN NORTH for Mr. & Mrs Zondo ADDRESS: 27 BURLEIGH CRESCENT

DRAWING TITLE
 LOWER GROUND STOREY

DATE	SCALE	DRAWN
MAY 2022	AS SHOWN	KS
DRAWING NO.	REVISION	
127/100	00	
ISSUED FOR APPROVAL		
ISSUED FOR INFORMATION		
ISSUED FOR SUBMISSION		
ISSUED FOR TENDER		
ISSUED FOR CONSTRUCTION		