

6 of 309
PNo 24

PNo 20/22
Rem of
5 of 309

4 of 309
PNo 16

3 of 309
PNo 12

FIRE NOTES

- Occupancy Classification: H1
- No part of any building on the site is to exceed 90m from a fire hydrant TT 35.4. If any building exceeds the 90m distance, then additional fire hydrants as required are to be installed.
- Positions of hydrants and hydrant booster manifold connection as well as internal diameter of feeds must be shown on plan prior to approval.
- Water supply to the fire equipment must comply with TT33 and W6.
- 30m fire hose reels must be provided to afford coverage to the entire building, minimum 1 per 500sqm or part thereof.
- Provide 1 x 25kg DCP (ABC) type fire extinguisher per unit.
- Fire extinguishers are to be wall mounted with the handle at 1.5m above ground level in an easily visible and accessible position.
- Marking and signposting of emergency routes, exits and fire equipment must comply with TT29 and TT32.2.
- Vehicle access to buildings for fire fighting and rescue purposes must comply with TT55 and not be less than 3.5m in width and height respectively if a controlled entranceway is to be installed.
- Partition walls and partitions to comply with TT9.
- provision of escape routes to comply with TT16
- Fire Hose Reels as per TT34
- Fire hydrants to comply with TT35
- Air-conditioning and ventilation as per TT43
- Emergency lighting to comply with T.43
- Smoke detection to comply with T.431

GENERAL NOTES

- All work to comply with Local Authority's regulations, Bylaws and National Building Regulations.
- Use SABS marked products, materials and building systems with approved agreement certificates.
- DO NOT SCALE THIS DRAWING. USE FIGURED DIMENSIONS ONLY.
- ANY DISCREPANCIES TO BE BROUGHT TO THE ATTENTION OF THE ARCHITECT IMMEDIATELY.
- ALL DIMENSIONS TO BE CHECKED ON SITE BEFORE ANY WORK COMMENCES.

STAIRS

All balustrades shall not have any opening that permits the passage of a 100mm dia ball - NBR M3. Flights of steps which contain more than 5 risers shall be provided with at least one continuous handrail extending the full length of the flight. Handrails are to be securely fixed to walls, screens, railings or balustrades.

STRUCTURAL NOTES

The following to comply with NBR codes:
All structural concrete to SABS 0100
All handrails to SABS 0104
All glazing to SABS 0137
All foundations to SABS 0161
All structural timber to SABS 0163
All structural masonry to SABS 0164
Foundation details confirmed by Prof. Engineer
ALL STRUCTURAL DESIGN DONE & CHECKED BY PROFESSIONAL ENGINEER

FIRE NOTES

Occupancy classification: H3
The following to comply with NBR's given:
Fire hose reels - TT34
Fire extinguishers - TT37
Provision for fire fighting equipment - TT32
Fire fighting to water recirculation - TT33
Air-conditioning & Ventilation systems - TT43
Signage - TT29

STAIRS

All balustrades shall not have any opening that permits the passage of a 100mm dia ball - NBR M3. Flights of steps which contain more than 5 risers shall be provided with at least one continuous handrail extending the full length of the flight. Handrails are to be securely fixed to walls, screens, railings or balustrades.

STRUCTURAL NOTES

The following to comply with NBR codes:
All structural concrete to SABS 0100
All handrails to SABS 0104
All glazing to SABS 0137
All foundations to SABS 0161
All structural timber to SABS 0163
All structural masonry to SABS 0164
Foundation details confirmed by Prof. Engineer
ALL STRUCTURAL DESIGN DONE & CHECKED BY PROFESSIONAL ENGINEER

DRAINAGE NOTES

ALL PLUMBING & DRAINAGE TO STRICT CODES & REGULATIONS OF LOCAL AUTHORITY.
Provide I.E.'s at bends & junctions with marked covers at ground level.
All I.E.'s to be accessible at all times.
Provide C.E.'s at every change of direction.
Provide deep seal traps to all fittings.
Provide 150mm high kerb to all showers.
Access to be provided 150mm above Ground Level to feet of all stacks.
Access panels to be provided to all internal service ducts.
All manholes subject to vehicular traffic must have heavy duty cast iron covers.
Drains passing under building to be uPVC rib pipe and not carry any load.
Provide anti-siphon pipes where required.
All plumbing to be concealed where possible.
All waste pipes to be 50mm.
All soil pipes to be min 110mm.
ALL DRAIN PIPE SIZES TO ENGINEER'S DETAIL

PARAPLEGIC REGS.

Building to comply with part 5 of NBR's

GLAZING:
Pane thicknesses designed to SABS 0137.
Pane fixings according to SABS 0137.
Safety Glazing requirements to NBR M2 and M3.
Safety Glazing to all shower cubicles.
Measurements to be taken on site prior to manufacturing and discrepancies to be brought to the architect's attention.
All glazing to comply with SANS 10400
All Aluminium to be designed according to AAAMSA - A2 category (1500Pa)

GENERAL NOTES:
1. All work to comply with Local Authority's regulations, Bylaws and National Building Regulations.
2. Use SABS marked products, materials and building systems with approved agreement certificates.
ARTIFICIAL LIGHTING TO COMPLY WITH SANS10400 PART 06.

MECHANICAL VENTILATION
1) Fresh air supply of 7.5 l/s/pp
2) Even air distribution.
3) Maximum air velocity 0.5m/s.
4) Internal bathrooms - air to be extracted at a rate of 25l/s per bathroom.

DAISY ROAD (1 way traffic)
9,14m wide
incl. sidewalks

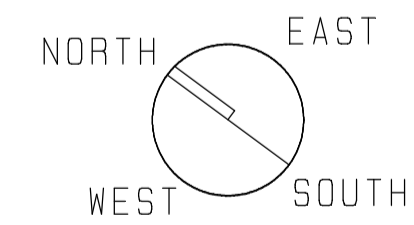
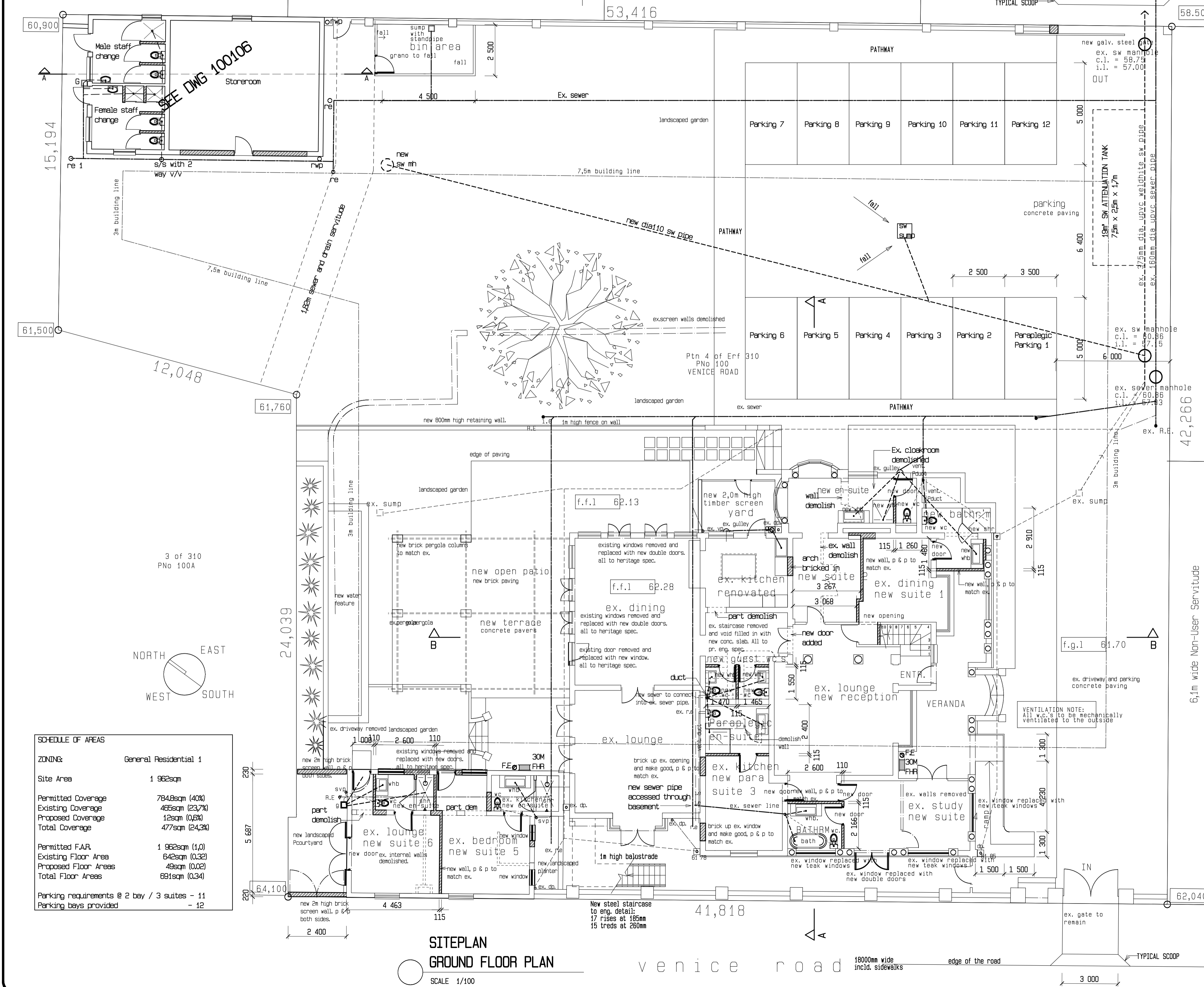

| SCHEDULE OF AREAS | |
|---|-----------------------|
| ZONING: | General Residential 1 |
| Site Area | 1 962sqm |
| Permitted Coverage | 784.8sqm (40%) |
| Existing Coverage | 465sqm (23.7%) |
| Proposed Coverage | 12sqm (0.6%) |
| Total Coverage | 477sqm (24.3%) |
| Permitted F.A.R. | 1 962sqm (1.0) |
| Existing Floor Area | 642sqm (0.32) |
| Proposed Floor Areas | 49sqm (0.02) |
| Total Floor Areas | 691sqm (0.34) |
| Parking requirements @ 2 bay / 3 suites - 11 | |
| Parking bays provided | - 12 |

**SITEPLAN
GROUND FLOOR PLAN**

SCALE 1/100

venice road

FOR CORPORATION USE :

ARCHITECT :

OWNER :

WILLIAMS ASSOCIATE ARCHITECTS
P.O. Box 474
Kloof
3640
KARZULU NATAL
TEL: +2731 - 7674140
FAX: +2731 - 7674145
EMAIL: office@waa.co.za
WEB: www.waa.co.za

Unless the LORD builds the house, its builders labour in vain. Ps 127:1

PROJECT
PROPOSED ALTERATIONS AND CONVERSION OF EX. DWELLING INTO UNLICENSED HOTEL FOR MR & MRS CHAPLIN ON POR 4 OF 310 DURBAN - 100 VENICE ROAD

DRAWING
GROUND FLOOR PLAN

SCALE
1:100

DATE
JANUARY 2013

DRAWN
DW

CHECKED
WH

PROJECT NO.
1184

| DRAWING NO. | SUBMISSION DRG. | WORKING DRG. |
|-------------|-----------------|--------------|
| SKETCHPLAN | | |
| | 100101 | |