

Elevation / Section

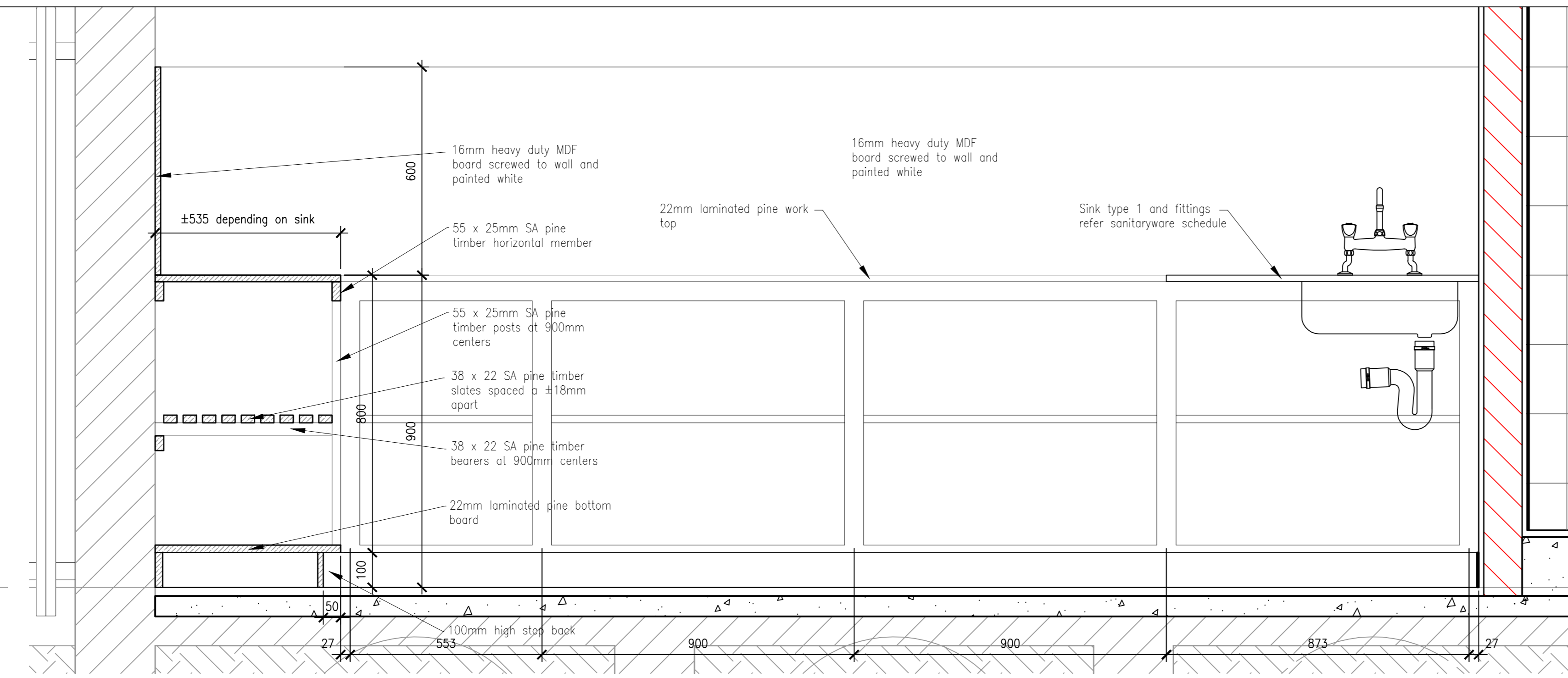

Section / Elevation

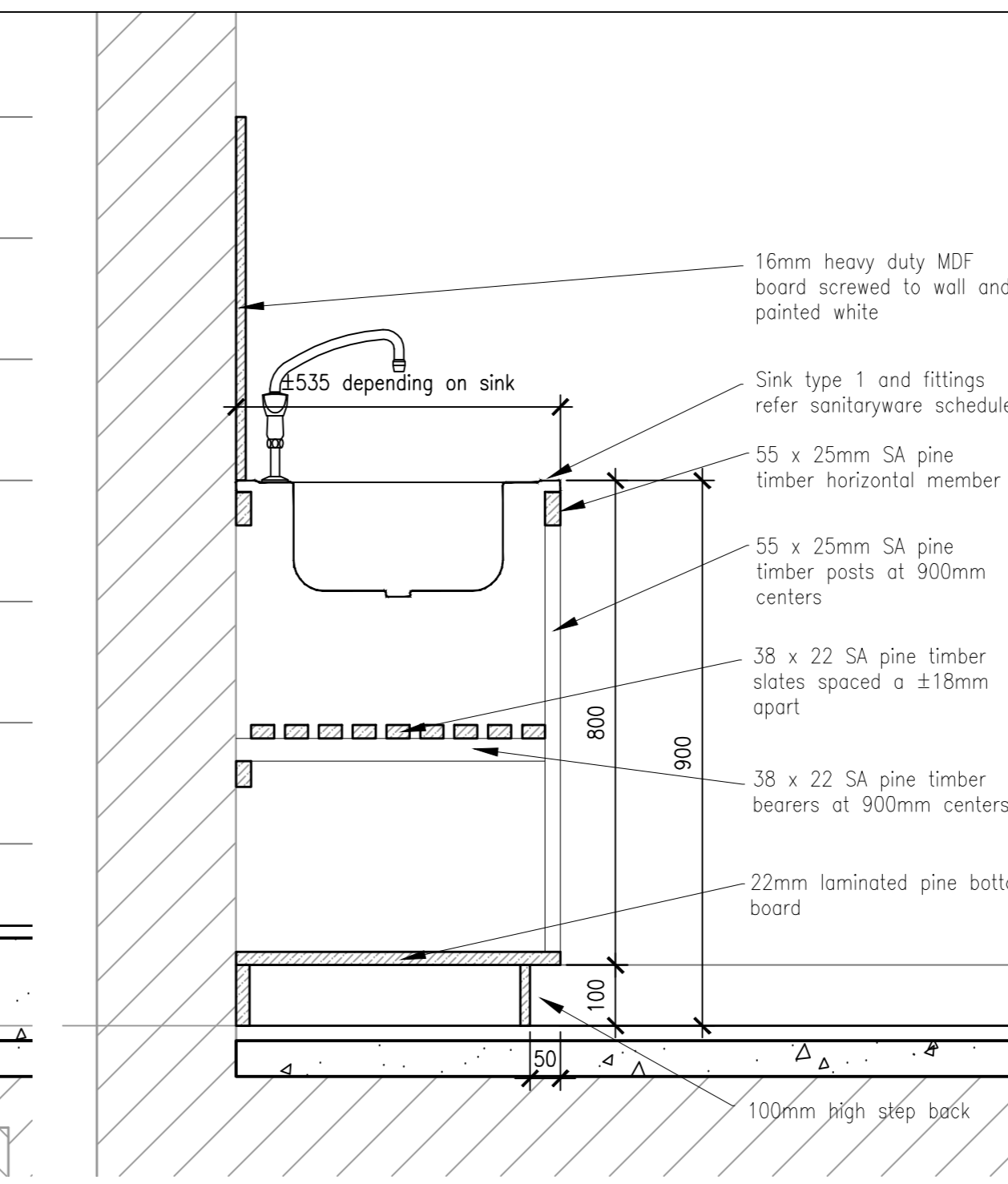

Section

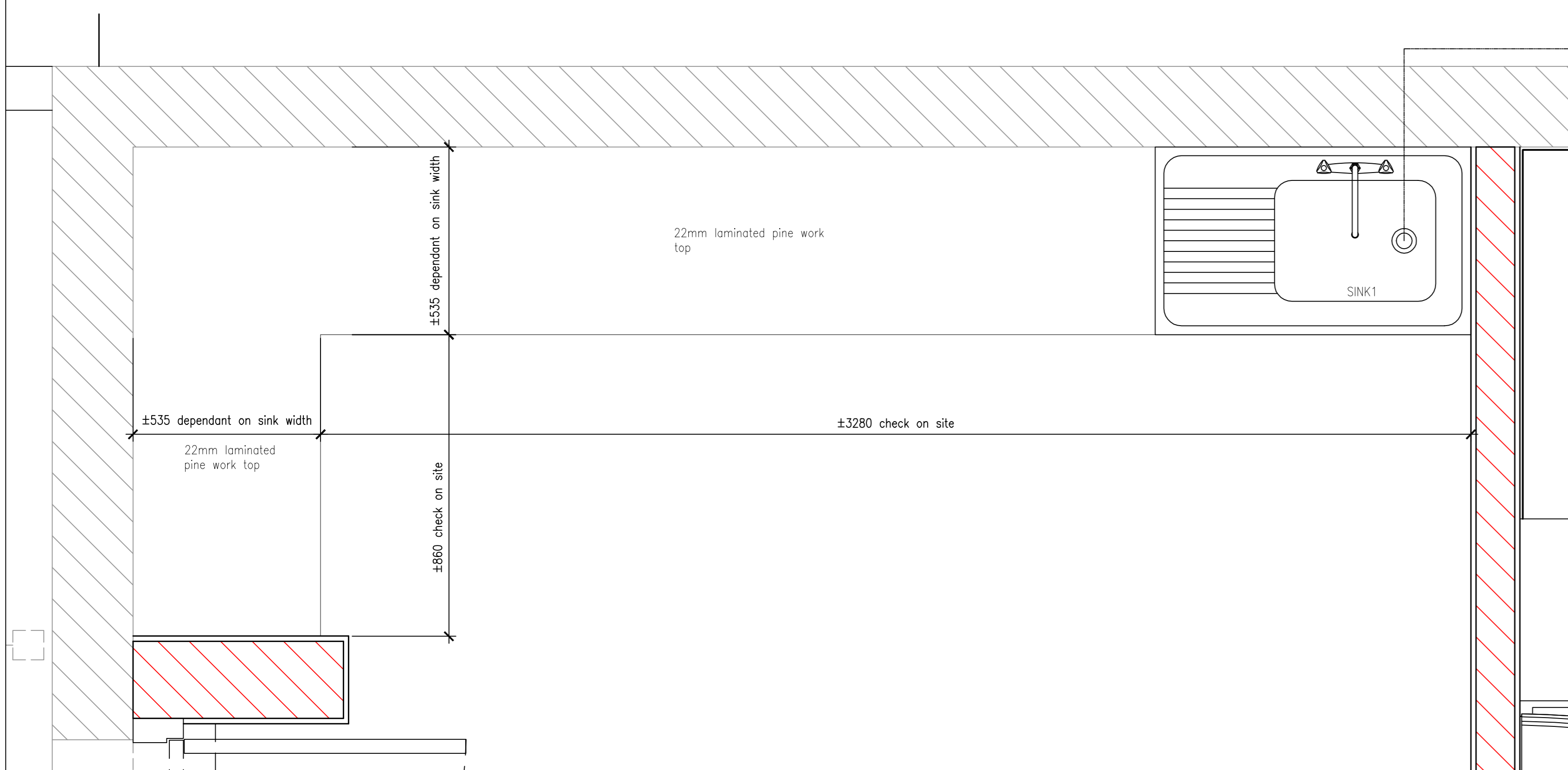

Plan - Work Top and Storage Shelves
G49a General Assistant Rest Room and Work Area scale 1:10

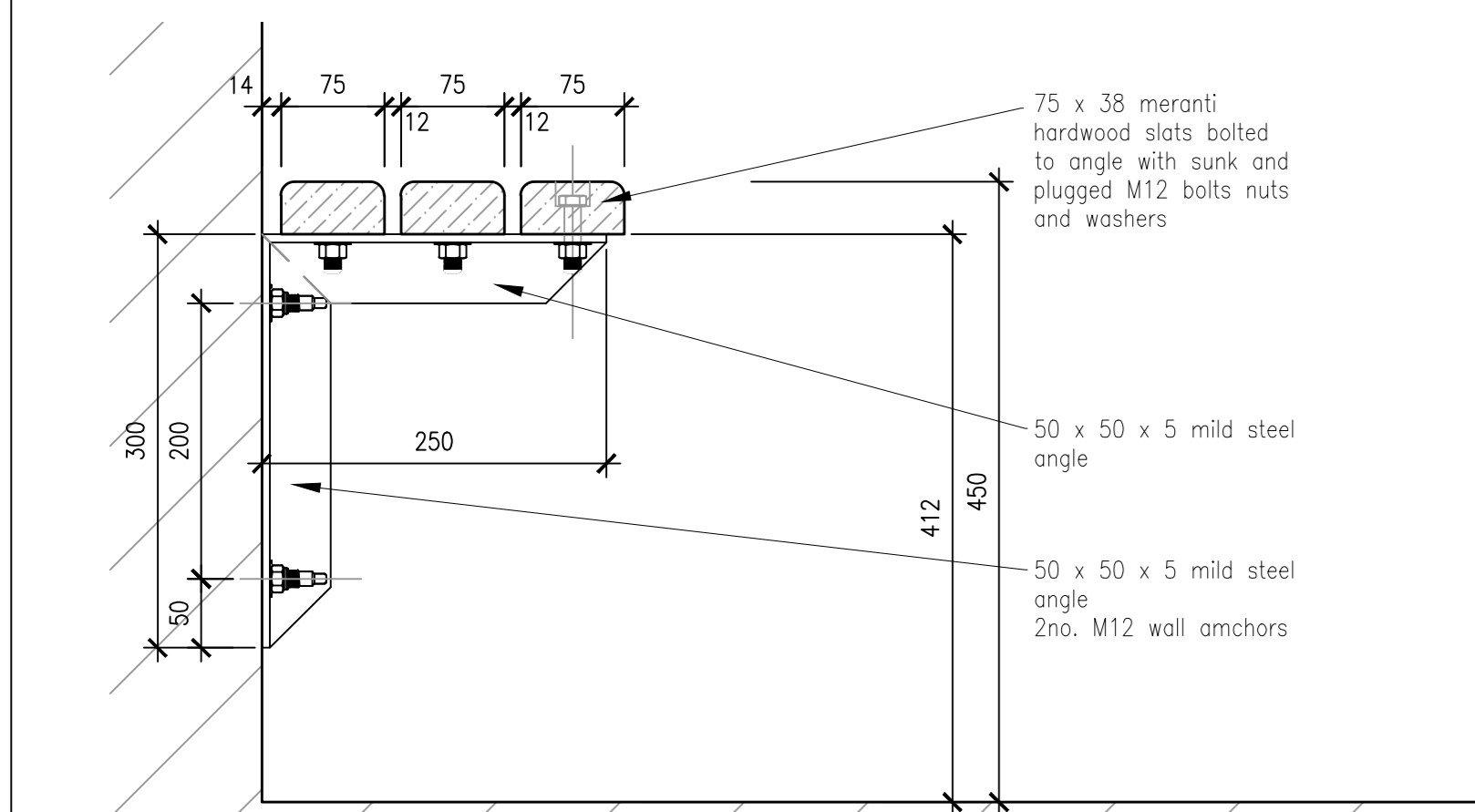

Section Shower Bench

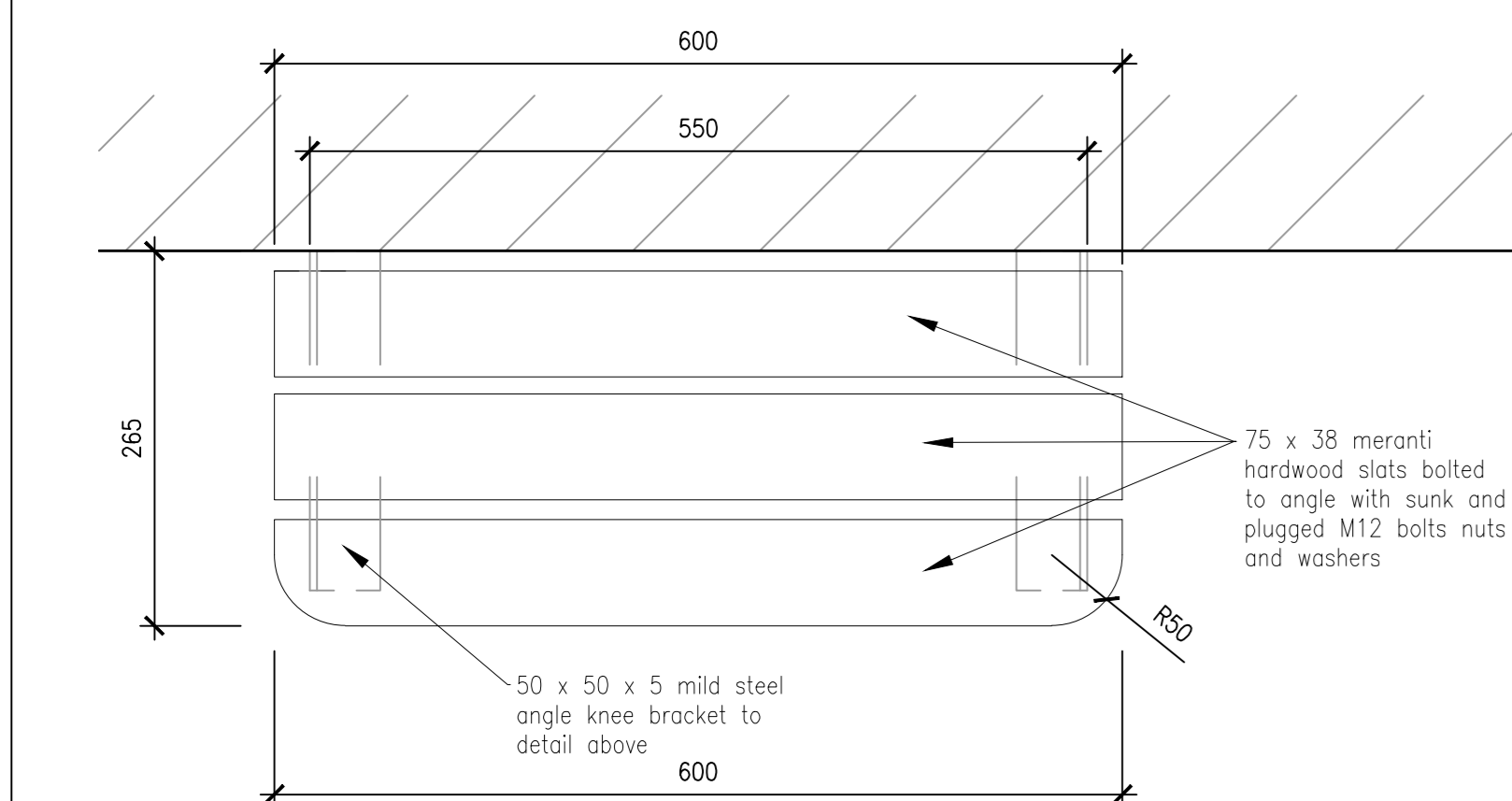

Plan Shower Bench Type 1 scale 1:5

Notes
Steel brackets to be hot dipped galvanized left natural (unpainted)
Fixing of timber slats to be with galvanized nuts, bolts and washers. Head of bolts to be counter sunk into seat slat. Counter sunk hole to be plugged with dowel created from the same wood used to manufacture the slat - care to be taken to align the grain of the plug.
Steel bracket to be fixed to wall with suitable galvanized or cadmium plated wall anchors.
Slats to be sanded smooth with particular attention being paid to all rounded edges. Slats to be painted with a clear polyurethane varnish in accordance with the manufacturers recommendations to obtain a uniform and consistent finish.

Notes
Skirting to units to be 100mm high 50mm set back SA pine timber finished to specification (Skirting around room is a 100mm skirting tile which is not to be used on units)
All fixings are to be concealed or counter sunk and filled with matching wood filler and should not be visible from outside the cupboard.
Cupboard carcass material to be SA pine planed all round timber or SA pine laminated boards.
Refer Sanitaryware Schedule for details of sink, top, etc.
Finished unit to be sanded and painted with a clear polyurethane varnish in accordance with the manufacturers instructions to obtain a consistent and uniform finish.
Carefully and neatly seal all gaps between unit and wall with white silicone sealant.

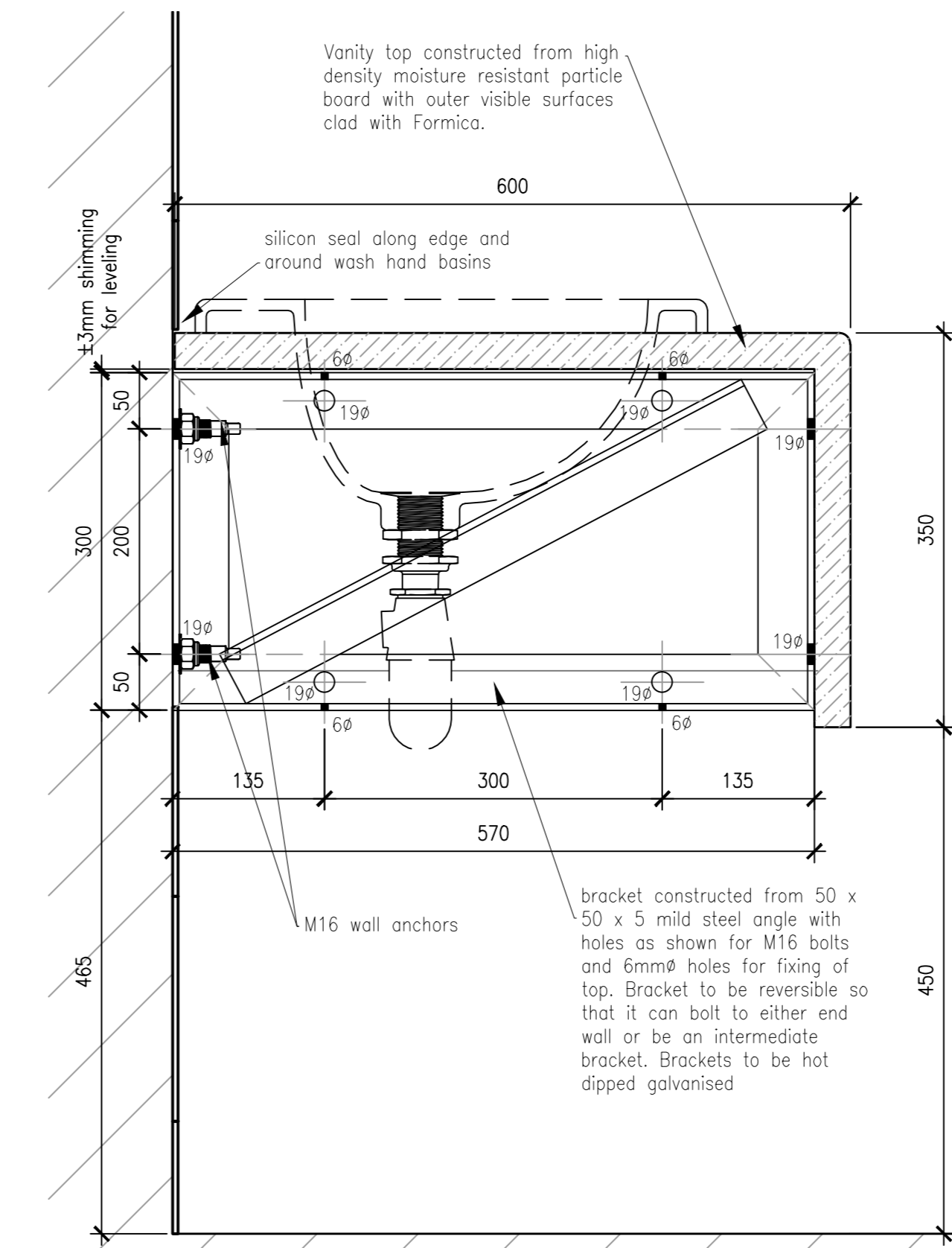

Typical Section thro' Vanity Counter scale 1:5

Notes
Steel brackets to be hot dipped galvanized left natural (unpainted)
Fixing of counter to be with corrosion resistant screws compatible with the galvanized bracket from the underside.
Steel bracket to be fixed to wall with suitable galvanized or cadmium plated wall anchors.
Wash hand basins, taps, etc. to be inserted and fixed in accordance with manufacturers instructions and to be set in and sealed around junction with top with silicon sealant.
Junction between top and tiles and/or wall to be sealed with silicone sealant.

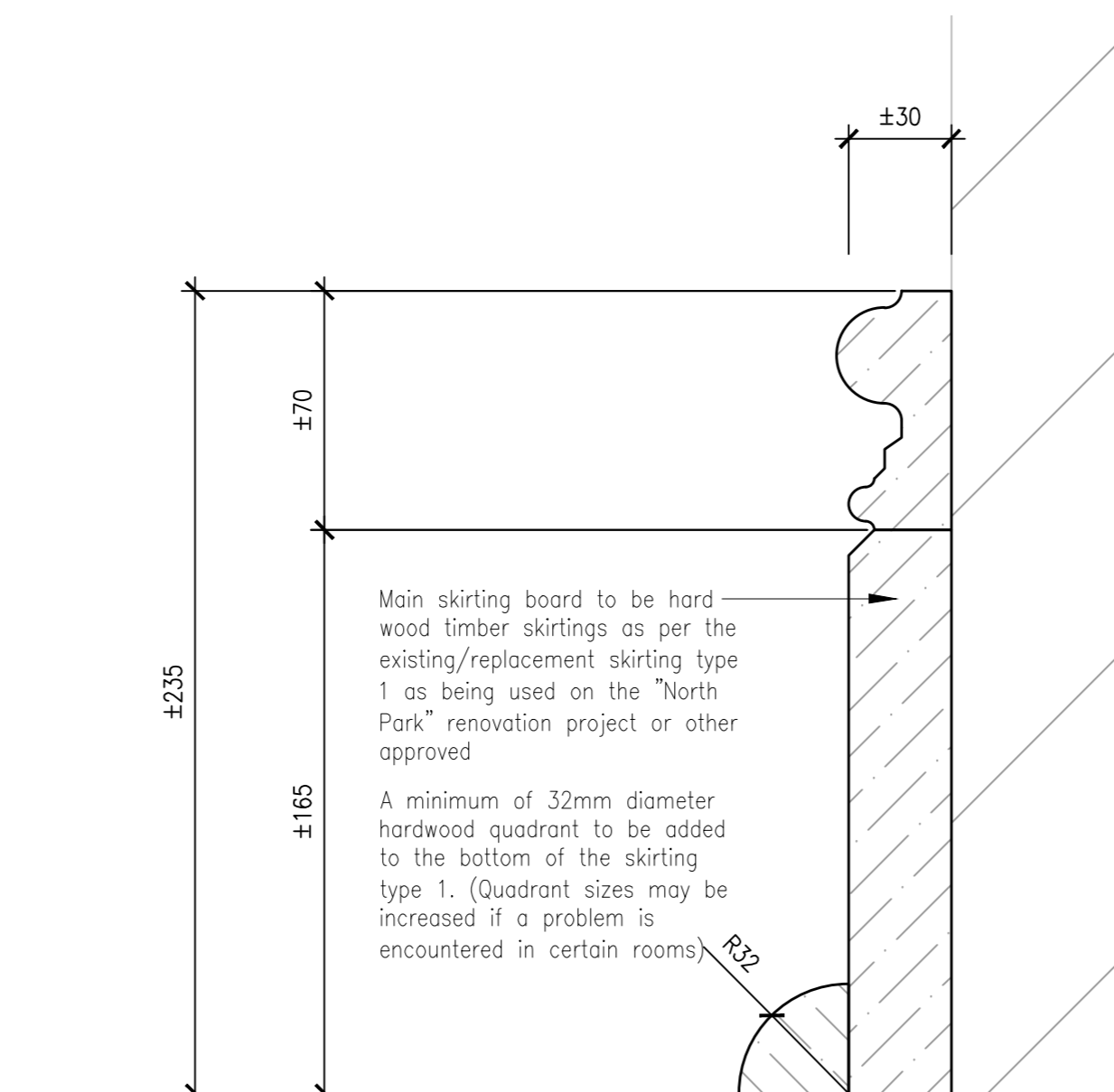

New / Replacement Timber Skirting Type 3 scale 1:2

Notes
Skirting's are to be painted with an under coat all round prior to installation.
Skirting's to be fixed to walls with counter sunk suitable wall fixings or plugs and screws (no nailing directly into walls). Countersinking to be filled with suitable wood filler for painting and sanded smooth.
All gaps between to of skirting and wall is to be filled with wall filler, sanded smooth and painted with wall.
All gaps between bottom of skirting and finished floor to be filled with suitable wood filler, sanded smooth and painted with skirting.
Skirting's are to have all imperfections, countersunk fixings and joints filled with suitable wood filler and sanded smooth. Skirting's to be sanded smooth, prepared, re-primed and painted with enamel paint to manufacturers recommendations to obtain a uniform and consistent finish.

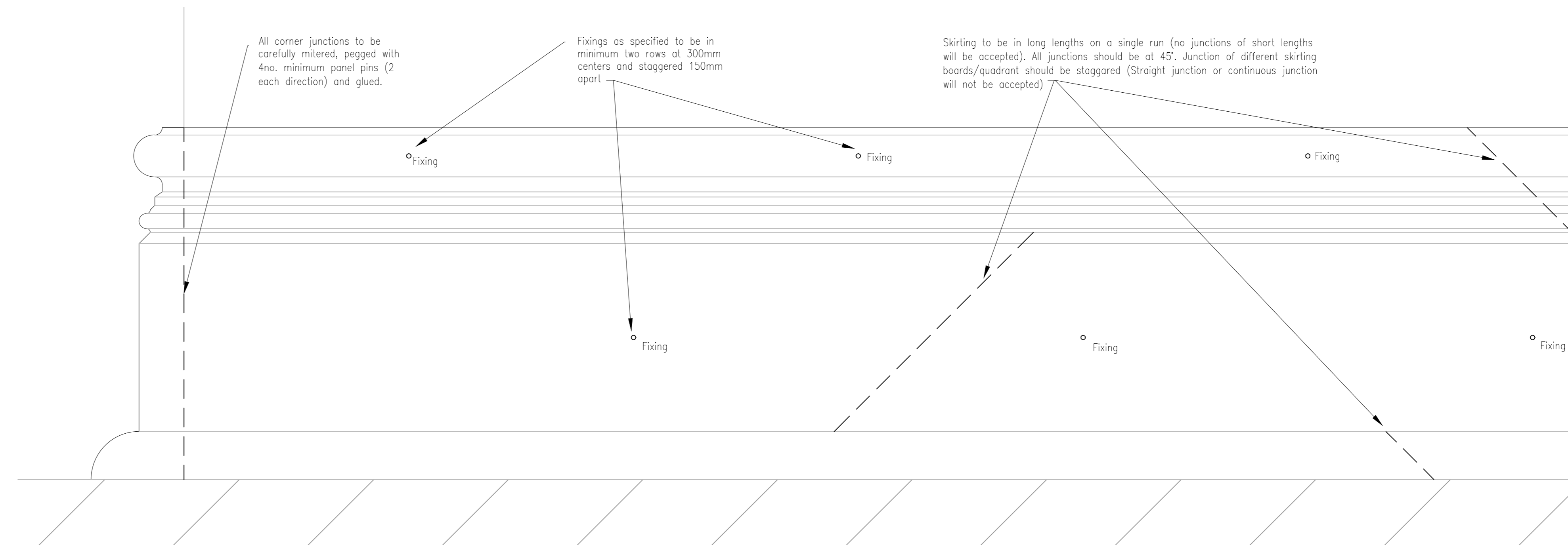

NO.	DATE	AMENDMENTS AND REVISIONS
⚠		AMENDMENTS BEFORE CONTRACT COMMENCES
⚡		REVISIONS AFTER CONTRACT HAS COMMENCED

PROVINCE OF
KWA-ZULU NATAL
DEPARTMENT OF WORKS
PRIVATE BAG X9041
PIETERMARITZBURG
3200



L&R architects
Suite E3 : Block E
Netcare Office Park
95 Umhlanga Rocks Drive
Durban North
4051
Tel : 031 573 1202
Fax: 031 573 1201
eMail: reesh@mweb.co.za

PROJECT
SOUTHERN REGION
PIETERMARITZBURG
DEPARTMENT OF HEALTH
TOWN HILL HOSPITAL
REPLACEMENT AND
RENOVATIONS TO ROOFS

DRAWING DESCRIPTION
OCCUPATIONAL THERAPY
CUPBOARD AND
MISCELLANEOUS DETAILS

DRAWING NO.	REV
044038 - E - 221	.
SCALE	CHECKED
1:10 1:5	.
FILE NO.	CLIENT
WIMS 044038	.
DATE	DRAWN
Nov 2013	J.K.W.

