

Boundary 22,860

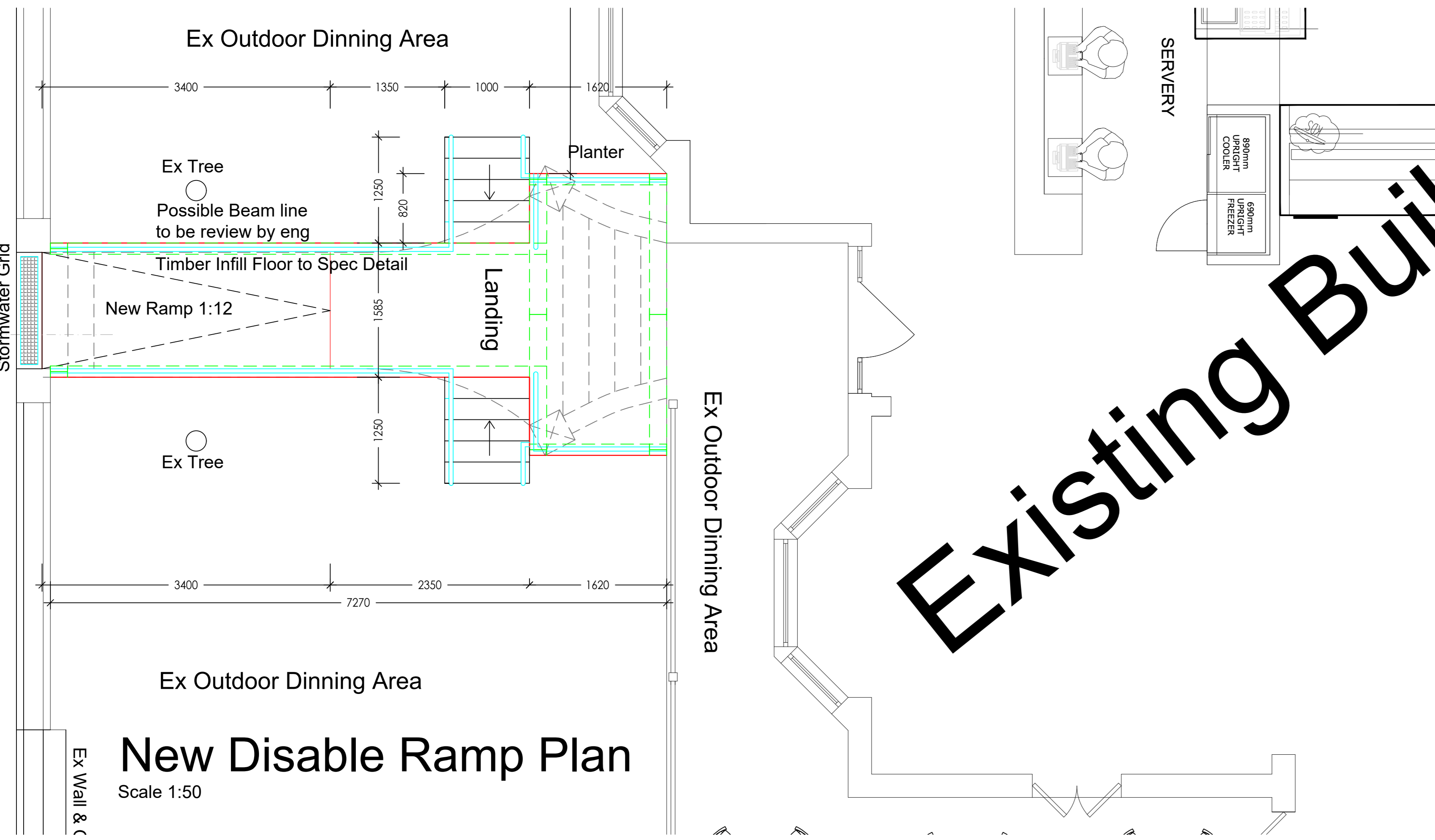

Existing Building

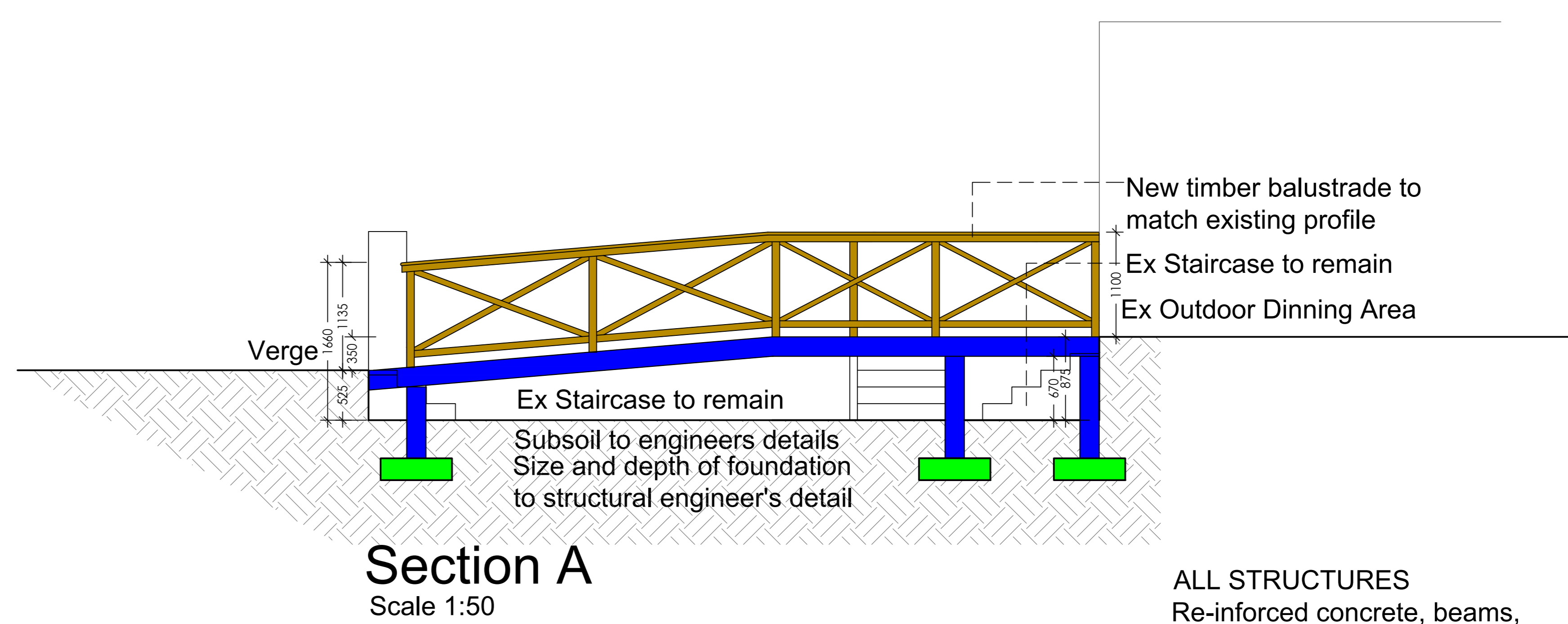

Section A
Scale 1:50

ALL STRUCTURES
Re-inforced concrete, beams,
footings & other structural
elements to structural
engineer's details

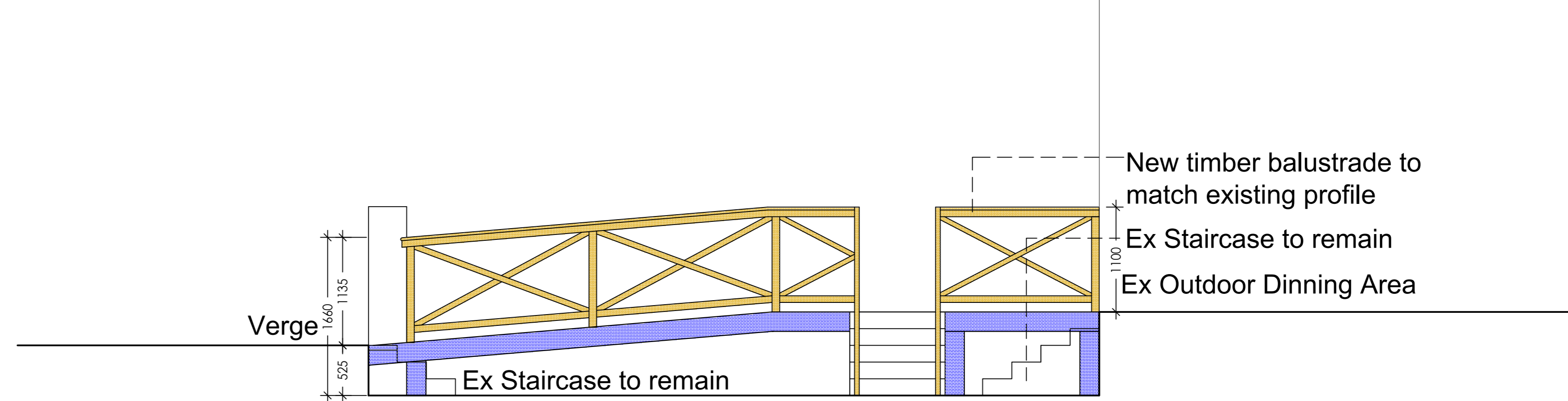

Typical Elevation
Scale 1:50

- 1:12 where the difference in level of the ends of the ramp is more than 400 mm; or
- (ii) 1:10, where such difference in level is not more than 400 mm;
- (b) have a clear trafficable surface not less than 1,1 m wide;
- (c) have a surface constructed of a slip resistant material;
- (d) be provided with a landing for every 1,5 m of vertical rise, and such landing shall be not less than 1,2 min length and have a width of not less than

Boundary 45,690

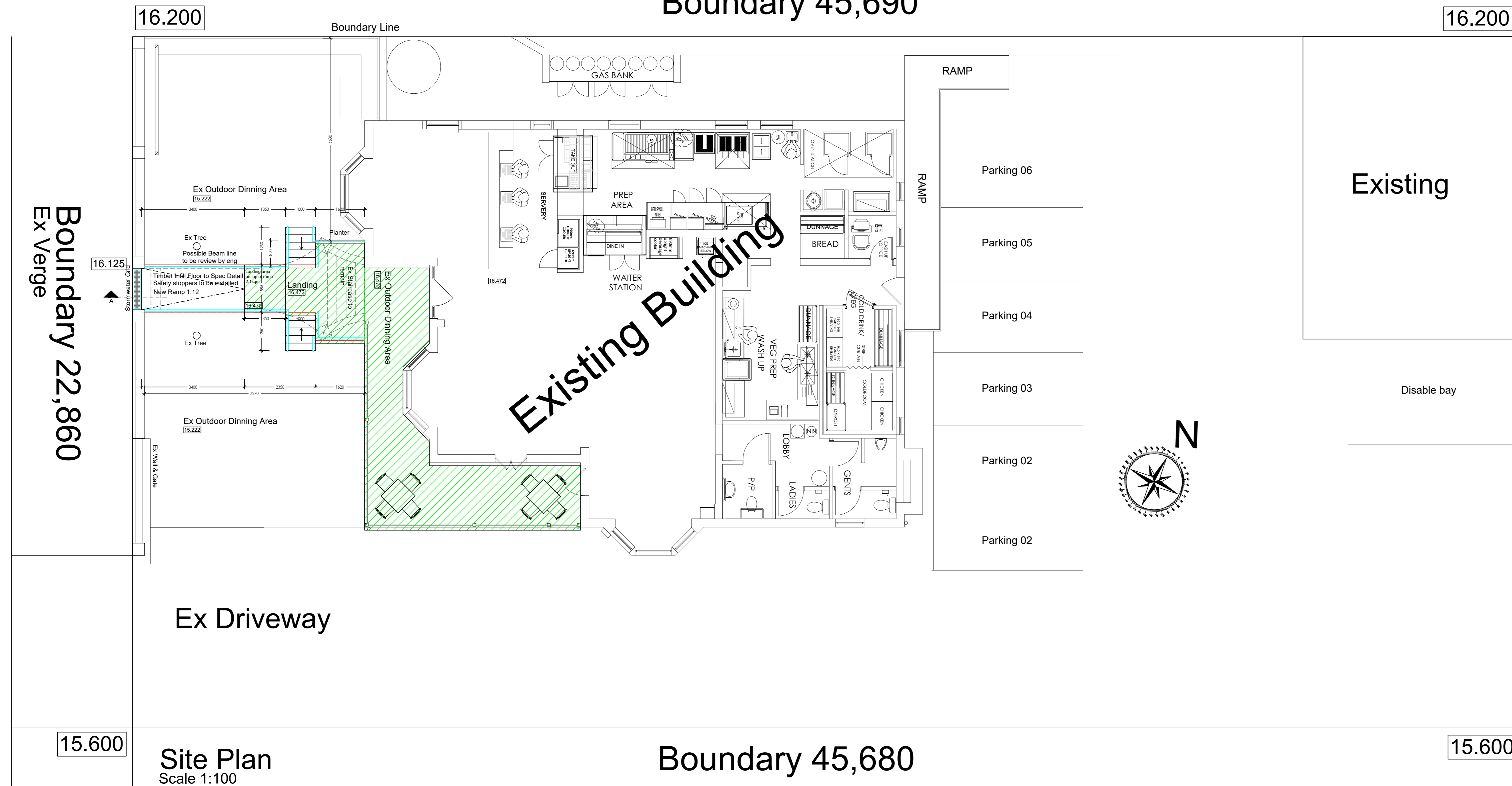

Site Plan
Scale 1:100

SCHEDULE OF AREAS	
SITE AREA	1045 m ²
COVERAGE :	
F. A. R :	
Existing Area	
Main Building	
Out Building	
TOTAL AREA	
COVERAGE :	
F. A. R :	
NO ADDED AREA	

Note:
This drawing is copyright, reserved and remains the property of Zadar Architects
Contractors and subcontractors are to check all site dimensions and levels before commencing work.
Figured dimensions are to be taken in preference to scaled dimensions.
The architects are to be notified of any variations or discrepancies.
Each contractor shall be responsible for ensuring the structural stability of all components of his work and ascertain that the main structure is capable of supporting all loads applied thereto.
All work to be executed in strict accordance with bye laws and regulations of the local authorities.
All SABS applicable codes of practice to be used.
All electrical and plumbing work is to be undertaken by registered artisans.

Zadar
Pty Ltd

48 Somme Road
cell: 071 8771025
zadastudio@gmail.com
www.zadararchitects.co.za

CLIENT
ALF SUDHEIM

PROJECT
PROPOSED DISABLE RAMP

ADDRESS
124 FLORIDA ROAD , ERF 883

PLAN

DRAWN BY T.M	CHECKED K.P	APPROVED
SCALE 1:50	DATE 11/02/2021	
JOB NO	DRAWING NO NARAMP 05	

124 FLORIDA ROAD

Boundary 22,860
Ex Verge

Boundary 22,860

Boundary 45,680

15.600

15.600