

WEST ELEVATION

SOUTH ELEVATION

NORTH ELEVATION

EAST ELEVATION

notes

- ALL LEVELS AND DIMENSIONS TO BE CHECKED ON SITE BY CONTRACTOR BEFORE COMMENCING WORK.
- REINFORCED BRICKWORK WITH SOLID JOINTS IN CEMENT MORTAR IN ALL WALLS AT WINDOW CILL AND ROOF PLATE LEVELS.
- CONC. ROOF TILES ON 38x38 BATTENS ON TYPE 'E' WHITE PLASTIC UNDERLAY, ON 152x38 TRUSSES AT 685 C/C. SOIL TO BE POISONED.
- ALL NEW WATER PIPES TO BE 15/25mm COPPER PIPING.
- ALL NEW WORK TO MATCH EXISTING.
- 100 CONC. SLAB ON BRC MESH ON SABS APPROVED DAMP PROOF MEMBRANE, ON WELL RAMMED SOIL.
- ALL PLUMBING TO COMPLY WITH PART P OF SABS 0400-1990.
- ALL GLAZING TO COMPLY WITH PART N OF SABS 0400-1990.

1,5mx0,5m hw framed window with 4mm tough safety glass, frosted
 1,5mx2m hw framed window with 4mm mon. annealed glass, safety glass, single clear

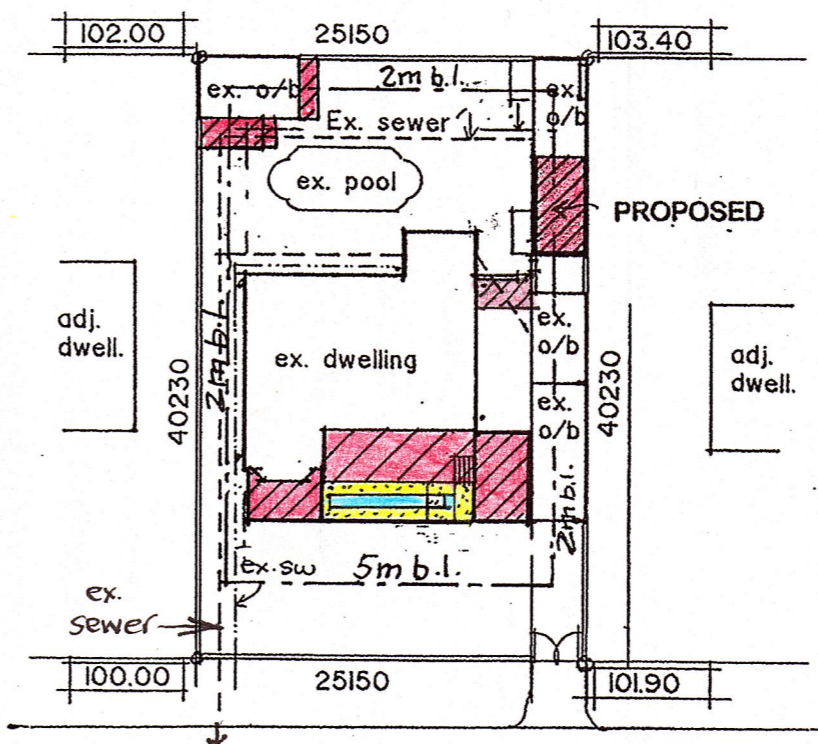
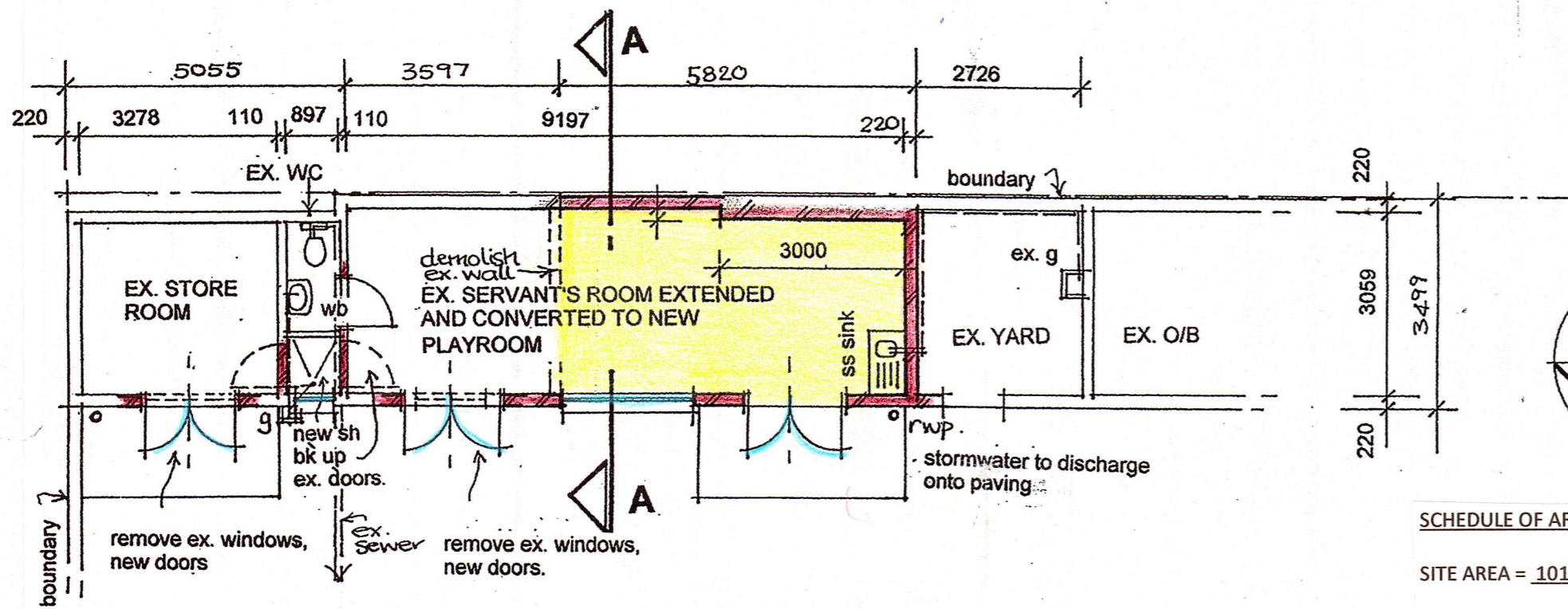

PLAN OF OUTBUILDING 1 : 100

BECKENHAM PLACE

SITE PLAN 1 : 500

SCHEDULE OF AREAS : m2

SITE AREA =	1012 m2
ALLOWABLE COVERAGE	506 (50%)
ALLOWABLE F.A.R.	N/A
EXISTING COVERAGE	318,24
PROPOSED COVERAGE	92,54
NEW TOTAL COVERAGE	410,78
AVAILABLE COVERAGE	95,22
EXISTING F.A.R.	258,74
PROPOSED F.A.R.	27,62
NEW TOTAL F.A.R.	288,36
AVAILABLE F.A.R.	N/A
NEW AREAS:	
NEW CARPORT =	17,92
NEW AWNINGS =	47
NEW PLAYROOM =	20,65
NEW BATHROOM =	6,97
Total =	92,54m2.

Neighbours:

Address:	Name & ID. no.	Phone:	Sign:
10 Beckenham Place	Lisna Kinghorn 7505180002086	0824512165	<i>[Signature]</i>
11 WINDSON DRIVE	DL AA MATHER 6312205256087	0833090233	<i>[Signature]</i>
14 BECKENHAM PLACE	DAVID LAMBER 680624514408	0837753640	<i>[Signature]</i>

DRAWING NO. 022 09 2022

PROPOSED ALTERATIONS AND ADDITIONS TO EXISTING DWELLING AND OUTBUILDING FOR MRS L. METCALFE 12 Beckenham Place Portion 55 of lot 958 DURBAN NORTH

DRAWN BY M. VAN BREEMEN
 DATE APRIL 2022
 SCALES 1 : 100 1 : 500
 SIGNED *[Signature]*

OWNER'S SIGNATURE *[Signature]*
 OWNER'S PHONE NO. 083 368 3401

ARCHITECTURAL PLANS
 13 GAINSFORD PLACE, LA LUCIA 4051
 PH. 073 1735815
 EMAIL - michelle-arch1@outlook.com
 REGISTRATION NO. ST1451
 M. SACAP M. SAIAT