

SHEET 5 of 21 COPY
 ETHERNITY MUNICIPALITY
 NR 1805/076
 APPLICATION NO.

BUILDING APPLICATION
 2018-27
 ZAI CONSULTANTS PTY (LTD)
 35 HIGH STREET, ERF 13872 TONGAAT,
 MEDUNIC VICTORIA HOSPITAL

ZAI CONSULTANTS PTY (LTD)
 35 HIGH STREET, ERF 13872 TONGAAT,
 MEDUNIC VICTORIA HOSPITAL
 35 HIGH STREET, ERF 13872 TONGAAT.
 PROJECT: PROPOSED ALTERATIONS & ADDITIONS
 TO THE FIRST STOREY OF THE
 MEDUNIC VICTORIA HOSPITAL,
 35 HIGH STREET, ERF 13872 TONGAAT.
 DRAWING: SUBMISSION DRAWING
 FIRST STOREY PLAN
 ARCHITECT: ZAI
 ARCHITECT NO: 7721
 CLIENT: MEDICLINIC
 CLIENT NO: 14021/1004/15
 SCALE: 1:100
 DATE: 14/02/2017

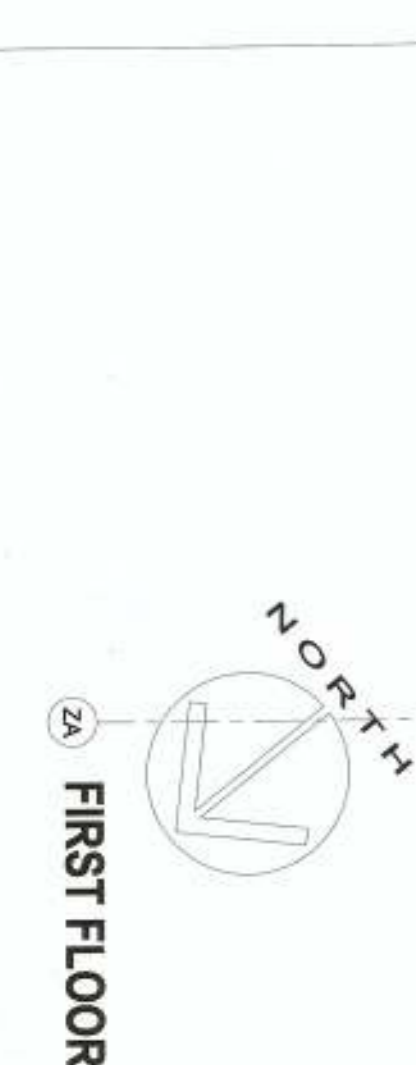
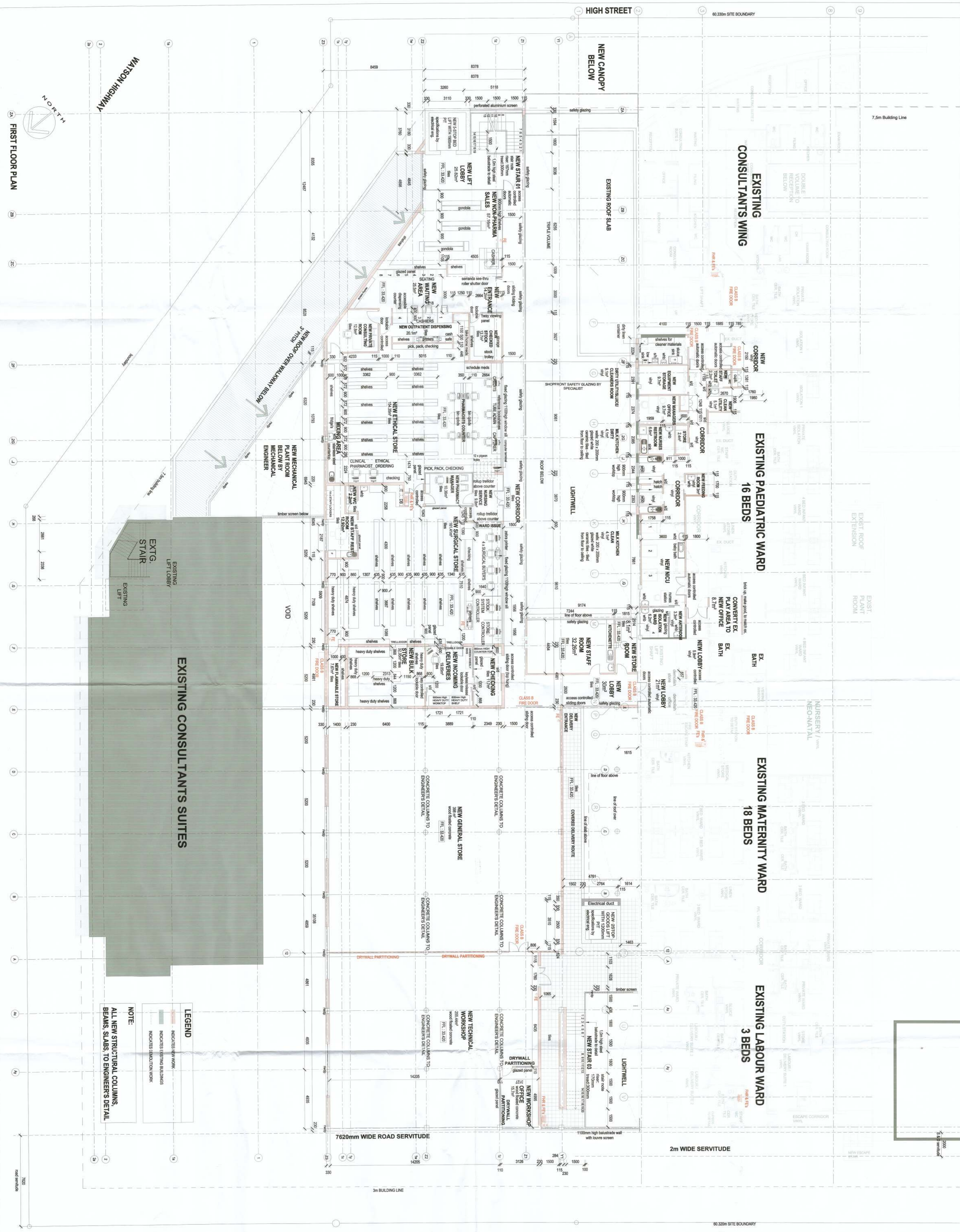

WATSON HIGHWAY
 2A FIRST FLOOR PLAN

7620mm WIDE ROAD SERVIDUTE
 2m WIDE SERVIDUTE
 80.320m SITE BOUNDARY