

ROBBEN ISLAND PLAN VIEW
NTS



LOCALITY MAP
NTS



PROPOSED PV SITE
NTS

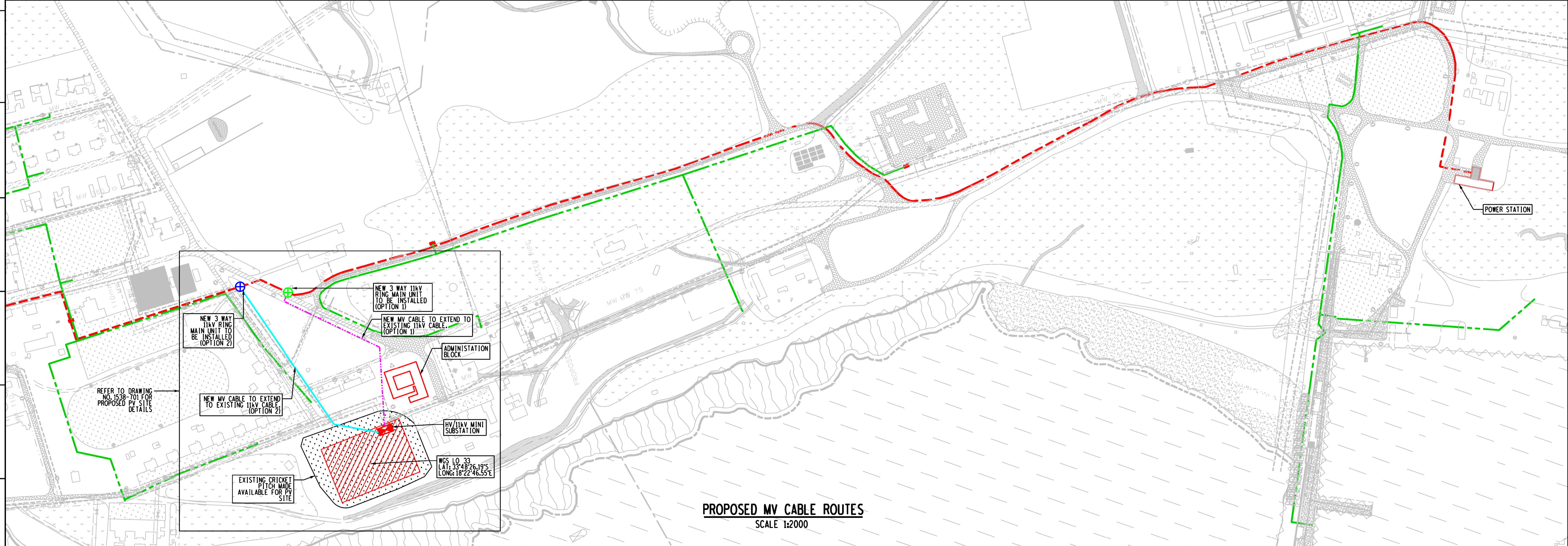

LEGEND

	EXISTING LV CABLE
	EXISTING MV CABLE
	NEW PROPOSED MV CABLE ROUTE - OPTION 1
	NEW PROPOSED MV CABLE ROUTE - OPTION 2

NOTES:

- THIS DRAWING IS THE PROPERTY OF THE MINISTRY OF TOURISM AND HAS BEEN ISSUED SOLELY FOR TENDER PURPOSES. THE BIDDER SHALL NOT DISCLOSE, COPY OR DISTRIBUTE ANY PART OF THIS DRAWING TO ANY PERSON WITHOUT THE APPROVAL OF THE MINISTRY OF TOURISM.
- THIS DRAWING IS ISSUED SOLELY FOR TENDER PURPOSES. IT SHALL NOT BE TAKEN AS A DRAWING APPROVED FOR CONSTRUCTION.
- LAYOUT SHOWS 2 POSSIBLE CABLE ROUTE OPTIONS FROM THE PROPOSED PV SITE.
- DEPENDING ON THE OPTION SELECTED, EXISTING MV CABLE TO BE CUT AND LOOPED INTO AND OUT OF NEW RING MAIN UNIT.

WSP | **PARSONS BRINCKERHOFF**

tourism
Department: Tourism
REPUBLIC OF SOUTH AFRICA

Robben Island MUSEUM

CVG Consulting Engineers (PTY) LTD
Unit 4, Tassica House, 12 Charles Way, Kloof, 3610
P.O. Box 29359, Maytime, 3624
Tel: (031) 7643301 Fax: (031) 7643306 e-mail: cvg@cvg.co.za

01	CABLE ROUTES REVISED AFTER CONSULTATION WITH ROBBEN ISLAND MUSEUM	12/11/2015
00	FIRST ISSUE (FOR TENDER PURPOSES ONLY)	05/11/2015
REV	REVISION DESCRIPTION	DATE
PROJECT CHECKED	TITLE	
K. SAROOP	ROBBEN ISLAND SOLAR PV PROJECT SITE LAYOUT	
DATE 04/11/2015	DATE 04/11/2015	SCALE AS SHOWN
DRAWN BY E. CRONJE	PROJECT APPROVED R. VAN GREUNEN	DRAWING No: 1538 / 700
DATE 04/11/2015	DATE 04/11/2015	REVISION 01