

FIRST FLOOR  
1:100  
199,0sq.m

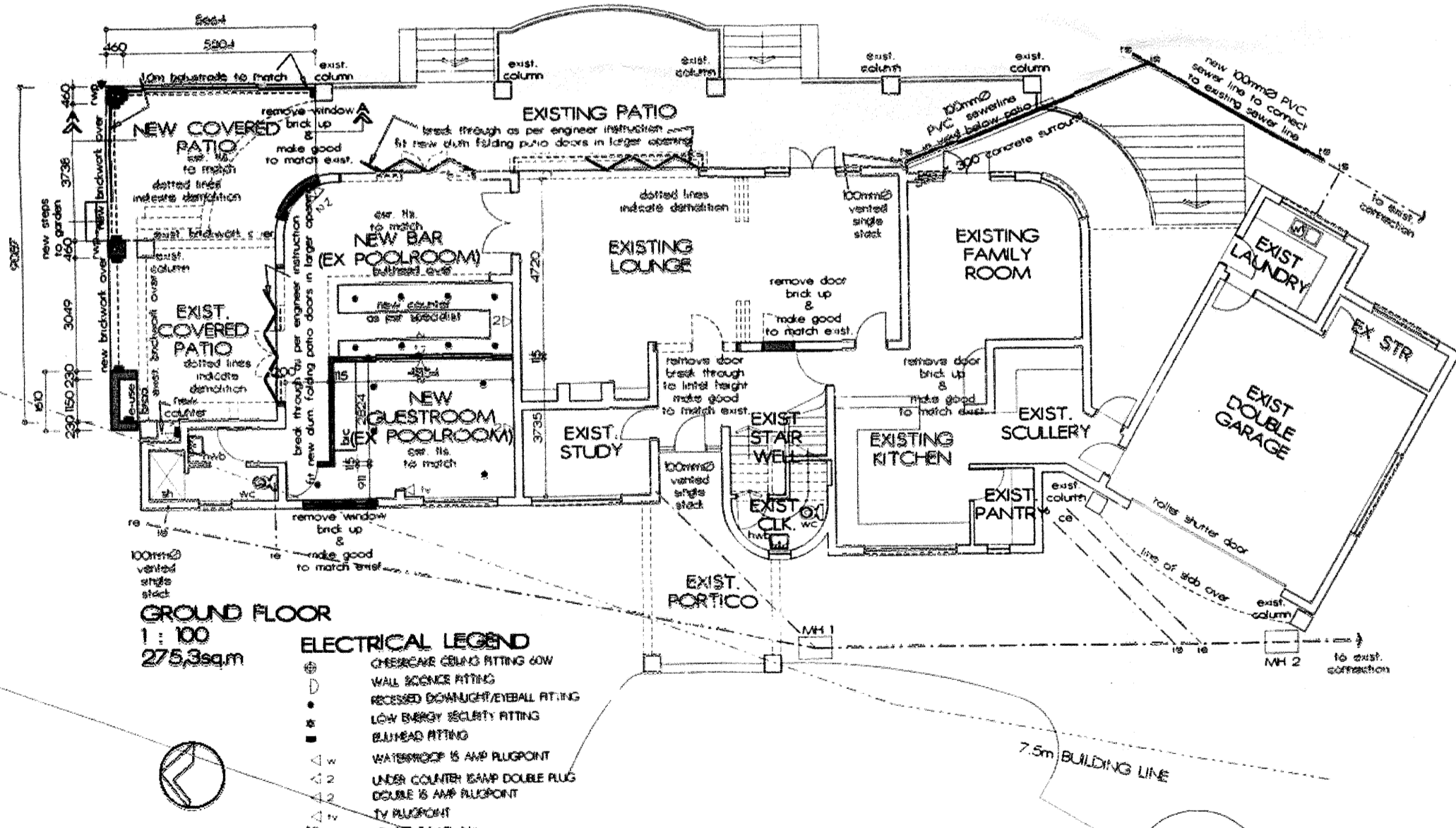

GROUND FLOOR  
1:100  
275,3sq.m

- ELECTRICAL LEGEND**
- ⊕ OVERHEAD CEILING FITTING 60W
  - ⊙ WALL SCIENCE FITTING
  - ⊖ RECESSED DOWNLIGHT/EYEBALL FITTING
  - ⊙ LOW ENERGY SECURITY FITTING
  - ⊙ BULBHEAD FITTING
  - ⊙ WATERPROOF IS AMP RUGPOINT
  - ⊙ UNDER COUNTER ISAMP DOUBLE PLUG
  - ⊙ DOUBLE ISAMP RUGPOINT
  - ⊙ TV RUGPOINT
  - ⊙ HEATED-TOWEL RAIL

HOUSE BILLAN SANS 10406KA 4.2.1 (b)

F.A. FLOOR	R.A. WINDOW	AREA	W.A.	W.A.	%	ORIENT	ROOF OVER
NEW BAR (EX POOLROOM)		32.0	15.1	47		N E	3500
NEW GUEST ROOM (EX POOLROOM)		19.4	18	9		W	01
BATH 2		6.76	0.94	9		E	01
BATH 3		6.76	0.94	9		E	01

SHEET 2/3 COPY  
ETHEKWINI MUNICIPALITY  
277 03 15  
APPLICATION NO.

DATE: 2015/01/01

**BUILDING APPLICATION**  
APPROVED IN TERMS OF 1 of the National Building Regulations and Building Standards Act No. 103/1977  
DATE: 6/6/16

COPYRIGHT RESERVED  
BALU ARCHITECTS  
KOPIEREG VOORBEHOUD  
BAU ARCHITECTE

AMENDMENTS	DATE	NO.	DESCRIPTION	WYSIGINGS	TRP/COPIE

**GENERAL NOTES**  
ALL DIMENSIONS AND LEVELS TO BE CHECKED ON THE SITE BEFORE COMMENCING ANY WORK.  
USE GIVEN DIMENSIONS ONLY - DO NOT SCALE.  
ALL MATERIALS AND PRACTICES TO COMPLY WITH THE NATIONAL BUILDING REGULATIONS AND SABS STANDARDS.  
ALL ELECTRICAL WORK TO COMPLY STRICTLY WITH LOCAL AUTHORITY REGULATIONS.  
FLOOR LEVELS TO BE A MINIMUM OF 85mm ABOVE BEAC LEVEL WITH A SUFFICIENT FALL FOR DRAINING OF WATER.  
ALL DIMENSIONS TO BE READ TOGETHER AND CORRELATED BEFORE WORK COMMENCES.  
ANY PARTS/REFERENCES MUST BE REFERRED TO THE ARCHITECT BEFORE ANY WORK COMMENCES.  
SABS 500 COLORMAN 1 TO BE STANDARD EXPECTED.

**WALL REINFORCING**  
ONE BAR 15mm HIGH TENSILE RODS PER 2 COURSES OF BRICK TO SURFACE LEVEL.  
ONE BAR 15mm HIGH TENSILE RODS PER FIFTH COURSE OF BRICK TO WINDOW UNTIL HEIGHT.  
ONE BAR 15mm HIGH TENSILE RODS PER COURSE OF BRICK ABOVE WINDOW.  
3mm SMOOTH-BAR BEDS AT ALL CORNERS AND JOINTS TO CHANGING ROOM AIRWAYS.  
TYPE ROCS, ANGLES CORNERS.

APPLICATION IN PRINCIPLE

ETHEKWINI MUNICIPALITY  
LAND USE MANAGEMENT - CENTRAL REGIONAL OFFICE  
GRANTED

NAME: \_\_\_\_\_  
SIGNATURE: \_\_\_\_\_  
DATE: \_\_\_\_\_  
This does NOT constitute an approval in terms of the BMR (Act No. 103 of 1977).  
The authority does not exempt the application from compliance with any other statutory requirements or any other applicable laws.

REGISTRATION No. 2002/004520/23 HVA  
**HENNIE COSTHUYSEN**  
Pr. Arch., B.Arch. (H.O.P.S.) M.A.  
50 SHERRARD ST.  
P.O. BOX 1008  
MEYERTON, 1560  
TEL: (016) 369 3881 FAX: (016) 362 3363  
CEL: 072 170 5681 EMAIL: hnc@hnc.co.za

REGISTERED AT THE SOUTH AFRICAN COUNCIL FOR ARCHITECTS  
REGISTERED BY DIE SUID-AFRIKAANSE RAAD VAN ARCHITECTE

NO. 3376

PROJECT  
PROPOSED ALTERATIONS AND ADDITIONS FOR MR. & MRS. GILLAN ON LCT 2741, DUISAN NORTH

PROJ. NO. 16 BEEKERHOUTSEAT

TITLE  
GROUND FLOOR  
FIRST FLOOR

DRAWING NO.	SCALE	DATE	DRAMA
G16/577/01	1:100	2015/02/25	HPO
REVISION NO.	SCALE	DATE	REVISION

*Handwritten signature/initials*