

CITY ENGINEER'S OFFICE  
 RECEIVED  
 26 OCT 1973  
 PLAN No. 1407/73

APPROVED  
 GOFDGEKUR

14 NOV 1973

*[Signature]*  
 CITY ENGINEER  
 PORT ELIZABETH



9400  
 A  
 ELEVATION SCALE 1:50

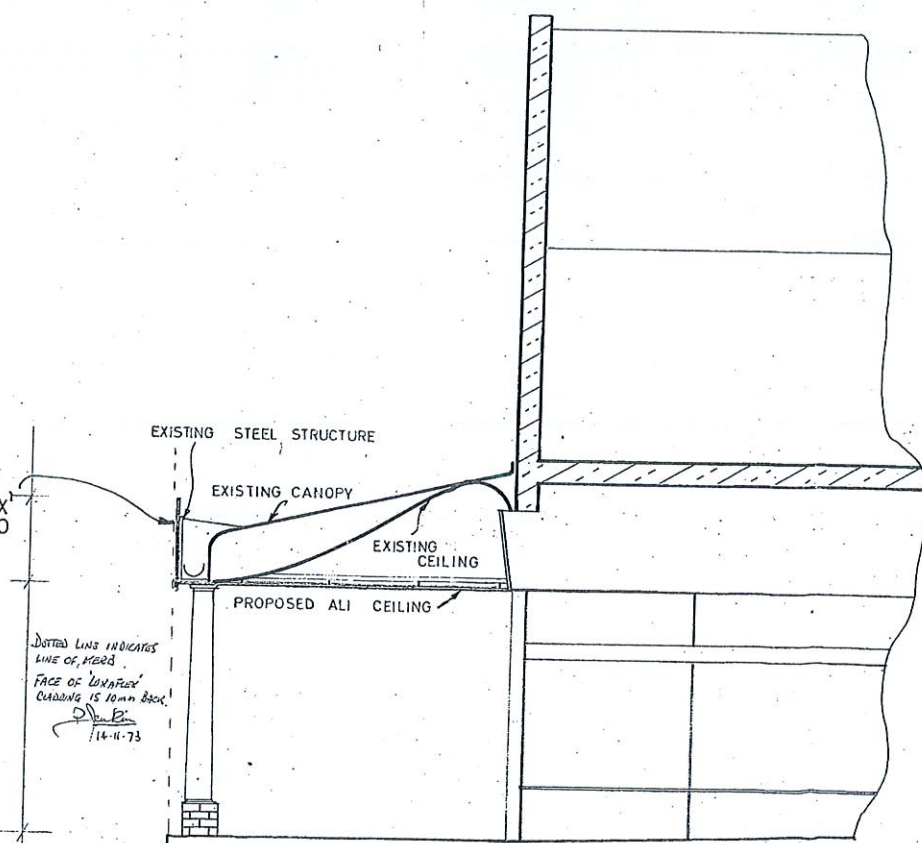

SECTION THRO A-A

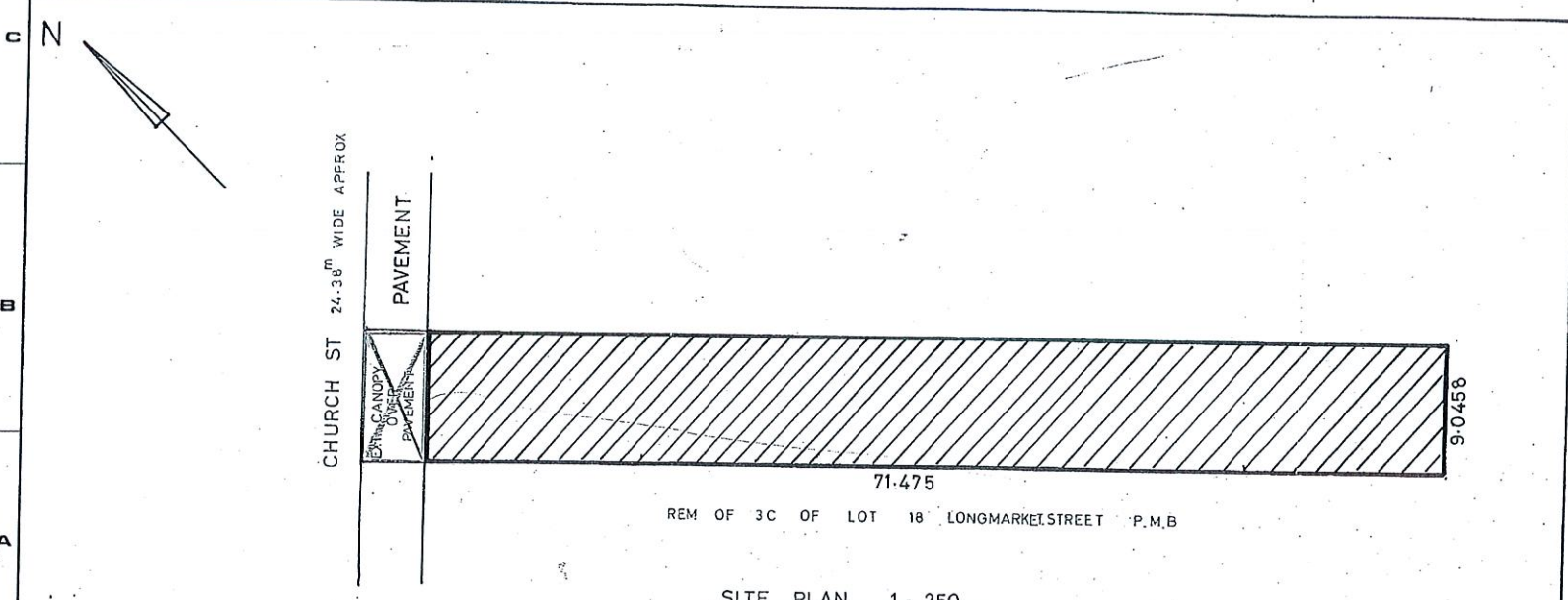

SITE PLAN 1:250

No.	REVISION - DESCRIPTION	DATE	AREA	NAME

DRAWN	J.W.M	DATE	18.10.73	<b>KOOL ALUMINIUM (PTY.) LTD.</b> DURBAN 268 JAN SMITS HIGHWAY, P.O. BOX 1163 TEL. 886361 JOHANNESBURG P.O. BOX 39317 BRAMLEY, TEL. 636-7173 (5 LINES) PORT ELIZABETH P.O. BOX 1622 TEL. 38330 BLOEMFONTEIN P.O. BOX 897 TEL. 78859
CHECKED				
APPROVED				
SCALE	PROPOSED 'LUXAFLEX' FACADE AND CEILING TO 182 CHURCH ST. PIETERMARITZBURG FOR SCOTT SHOE STORE			DRG. NO. 1630