

**NOTE:**  
 WINDOWS TO BE HARDWOOD TIMBER WINDOWS AS PER ORIGINAL DRAWING SPECIFICATIONS.

NEW WINDOWS AND DOORS TO BE FITTED IN-SITU BY CONTRACTOR ON SITE.

ALL WINDOWS AND DOORS TO BE PAINTED AS PER ORIGINAL WINDOWS.

**GENERAL NOTES**

1. CONTRACTOR TO CHECK AND VERIFY ALL LEVELS AND DIMENSIONS BEFORE COMMENCING. (AUTHOR TO BE NOTIFIED IMMEDIATELY OF ANY DISCREPANCY.)
2. ALL CONSTRUCTION WORK TO BE CARRIED OUT STRICTLY IN ACCORDANCE WITH THE N. B. R.
3. DO NOT SCALE ANY DIMENSIONS OFF PLAN.
4. ALL WORK TO COMPLY WITH MUNICIPAL BY-LAWS.
5. CONTRACTOR TO EXPOSE SEWER CONNECTION PRIOR TO ANY WORK COMMENCING.
6. THIS DRAWING SHALL IN NO WAY BE USED AS A BASIS FOR ANY CLAIM WHATSOEVER.
7. THE CONTRACTOR IS TO ENSURE THAT ALL WORK IS CARRIED OUT IN ACCORDANCE TO THE SANS 10400 NBR.
8. THE CONTRACTOR IS RESPONSIBLE FOR ALL LOCAL AUTHORITY NOTICES AND CONNECTIONS.
10. THE CONTRACTOR IS REQUIRED TO OBTAIN ALL NECESSARY CONNECTIONS TO SERVICES.
11. THE CONTRACTOR IS TO INSPECT THE OFFICIAL APPROVED COPY OF THE DRAWING TO ENSURE THAT HE IS AWARE OF THE FULL SCOPE OF WORK AND LOCAL AUTHORITY REQUIREMENTS.
12. THE AUTHOR IS TO BE NOTIFIED, IN WRITING, BY THE REG. OWNER OF ANY INTENDED DEVIATION TO APPROVED PLAN.

**LIST OF DEVIATIONS:**  
 1. SASH WINDOWS TO BE CHANGED TO MOCK SASH WINDOWS

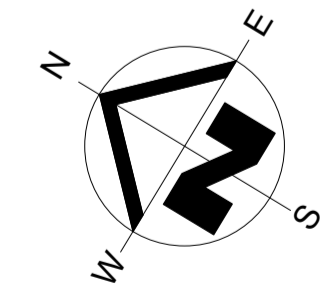
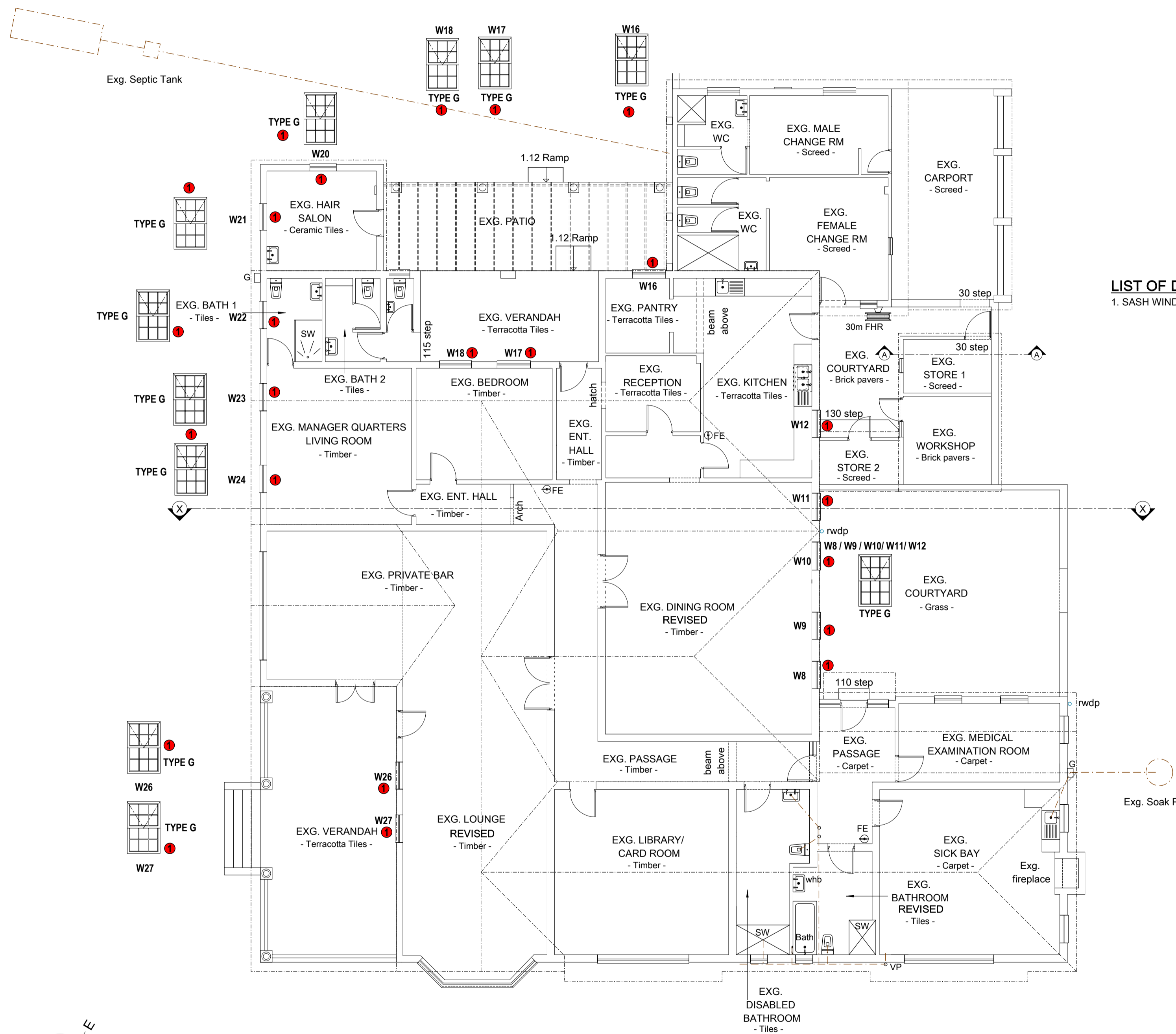

**GROUND FLOOR PLAN**  
 - EXG. COMMUNITY CENTRE -  
 SCALE 1:100

**WINDOW SCHEDULE REFERENCE PLAN**

**NOTE: AMAFA**  
 WINDOW SCHEDULE TO BE READ IN CONJUNCTION WITH PREVIOUSLY APPROVED AMAFA PLAN  
 REFERENCE: SAH22/19580 & 22/210  
 DEVIATION TO WINDOWS.

WINDOW SCHEDULE - SWARTLAND TIMBER	
SCALE 1:100 - EXG. COMMUNITY CENTER -	
WH	1105
FL	969
3100	2500
1750	969
<b>Window No.</b>	<b>W8, W9, W10, W11, W12, W16, W17, W18, W20, W21, W22, W23, W24, W26, W27</b>
Description	Mock Sash Small Cottage Pane
Frame Material	Timber frame
Manufacturer	Swartland - Cape Dutch
Manufacturer Ref.	SMS4CD
Glazing thickness	4mm S.C.M.A.G
Single Clear Monolithic Annealed Glazing - S.C.M.A.G. Each individual pane of safety glazing material must be marked by the installer of the glazing material. Unmarked glazing material shall be regarded as non safety glazing material.	

V. PARNELL  
  
**DO NOT SCALE**

Body corporate signature :  
 Name :  
 Tel.  
 Structural engineer  
 Name : Jeanita Dray  
 Tel no. : 083 414 4388  
 Geotech engineer  
 Name :  
 Tel no. :

Building classification - Retirement Village  
 Site class designation -  
 Proposed Deviation to Amafa Plan No:  
 SAH22/19580 & 22/210 for  
 Existing Community Centre  
 For  
 18 Garden Road, Graceland Estate  
 Hillcrest  
 For  
 Sub 77 (of 6) of the farm Albinia 957  
 For  
 The Body Corporate of Graceland - SS 438/92  
 Cell no. : 082 491 290

36 Inanda Road  
 Hillcrest  
 3610  
**VP ESIGNS**  
  
 Tel : 031 765 8974  
 Cell : 082 498 2192  
 Email : Vic@VPD.co.za  
 www.VPDesigns.co.za

REVISION LIST		
DATE	REVISION NO.	DETAILS
29/08/22	REV 1	Internal Door & Frame Schedule
09/11/22	REV 2	Change Sash windows to Mock Sash

Scale As Shown  
 Date 09 / 11 / 2022  
 Drawn V. Parnell T0809  
 Reg. No. 5186  
 Owners signature:  
  
 Signee Names  
 Authors signature:  
  
 D. W. Smith (PrArch)