

FIRST and SECOND STOREY PLAN (1 : 100)

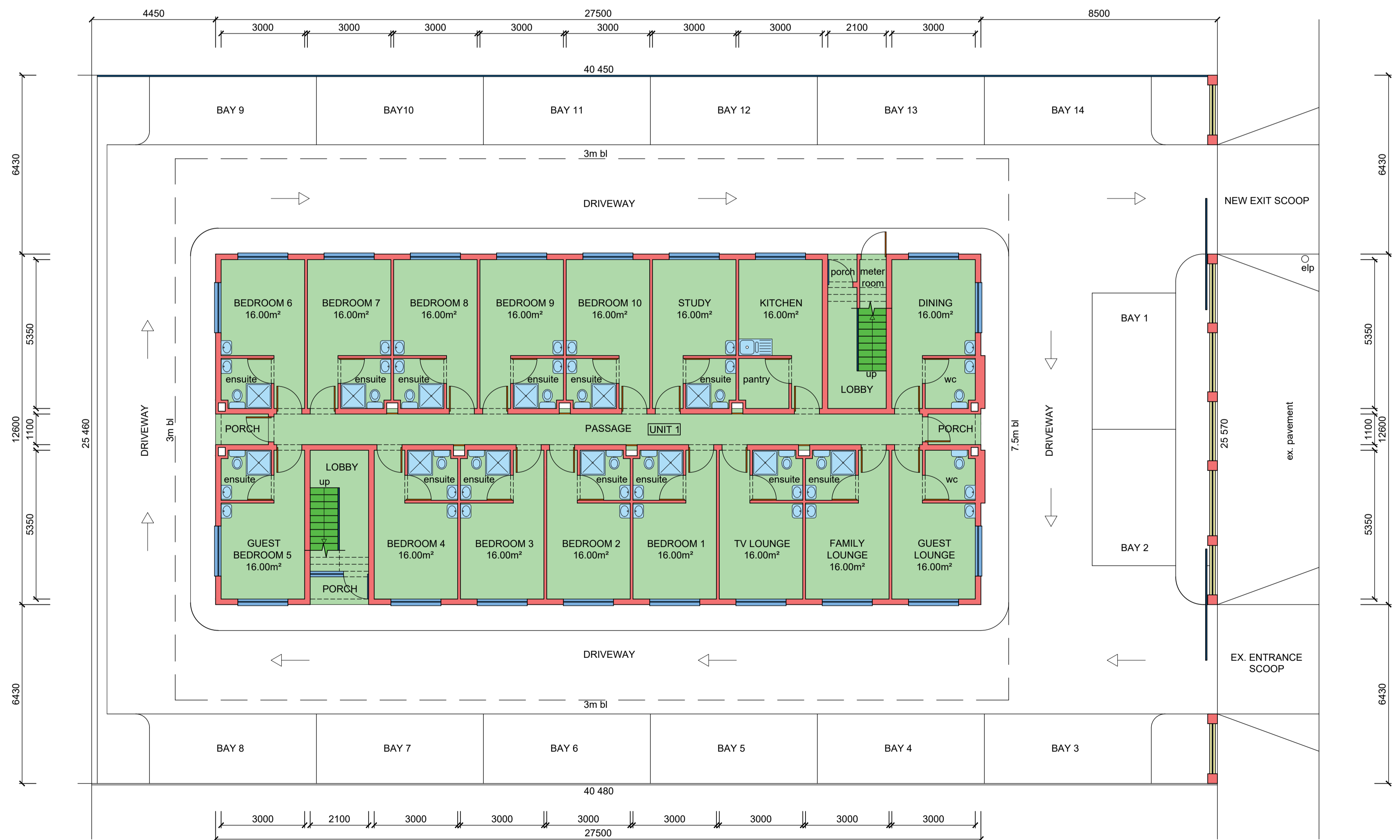

GROUND STOREY PLAN/ SITE PLAN (1 : 100)

Total Area = 1 312.35 m<sup>2</sup>

Client's Signature: *[Signature]* Contact Number: 083 788 4330  
 Rate No.: 1048 9072/ 000

**PROPOSED NEW MULTI-STOREY RESIDENTIAL ACCOMMODATION AT 194 CHE GUEVARA ROAD ON ERF 6362 DURBAN FOR FIRST WATCH PROPERTIES(PTY) LTD**

**GRAHAM BRAUM**  
 ARCHITECTURAL DESIGNER  
 Pr. S. Arch. T  
 Reg. No. ST0010 *[Signature]*  
 13 Helen Joseph Road Durban 4001  
 Tel : 031-2054142 Cell : 082 454 0441  
 Email : gpbdesigners@gmail.com

SCALE : 1 : 100  
 CHECKED : G. P. BRAUM  
 DRAWN/DESIGNED : M. R. AZMUTH  
 DATE : AUGUST 2023  
 SHEET : 1  
**Drawing No. : 6732/ 23**