

SITE PLAN 1" = 40'

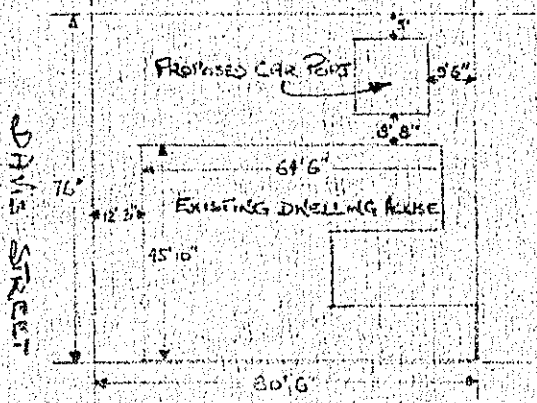

LOT 24 (A SUB OF 23) OF LOT 37 BURGER ST.

APPROVED

5 DEC 1961
J. A. Bruner
 CITY ENGINEER

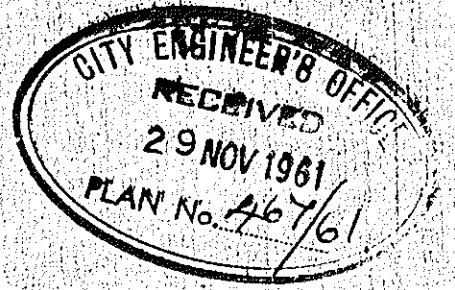

PROPOSED NEW CAR PORT
 for J.A. BRUNER ESQ
 25 DAVIS ST.

PLAN VIEW

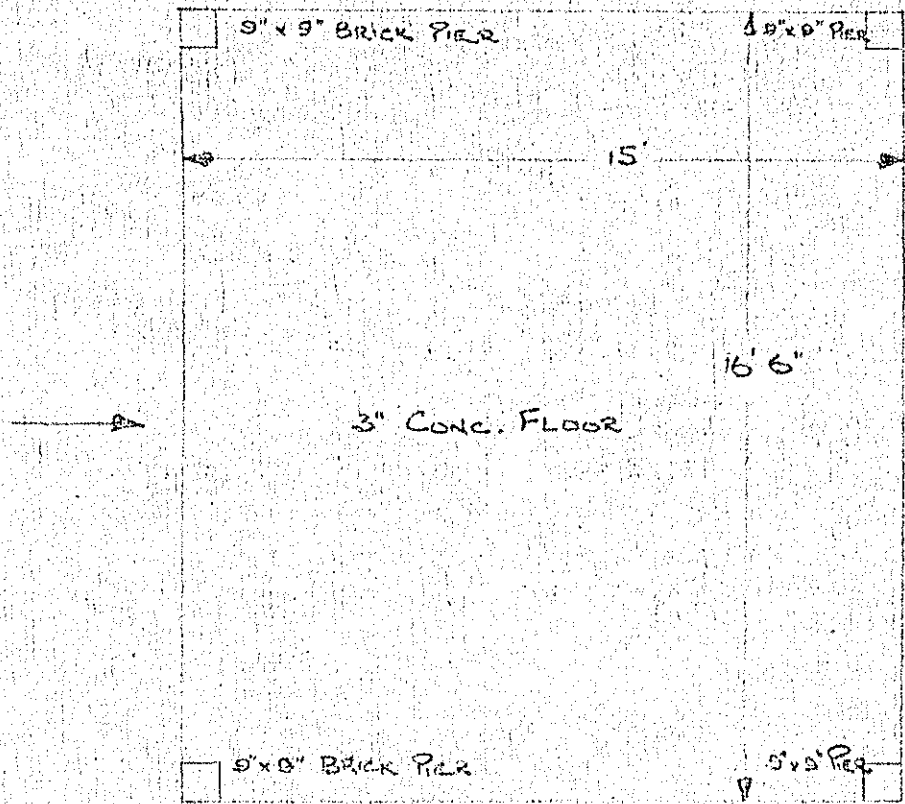

SCALE 1" = 4'

TYPICAL SECTION

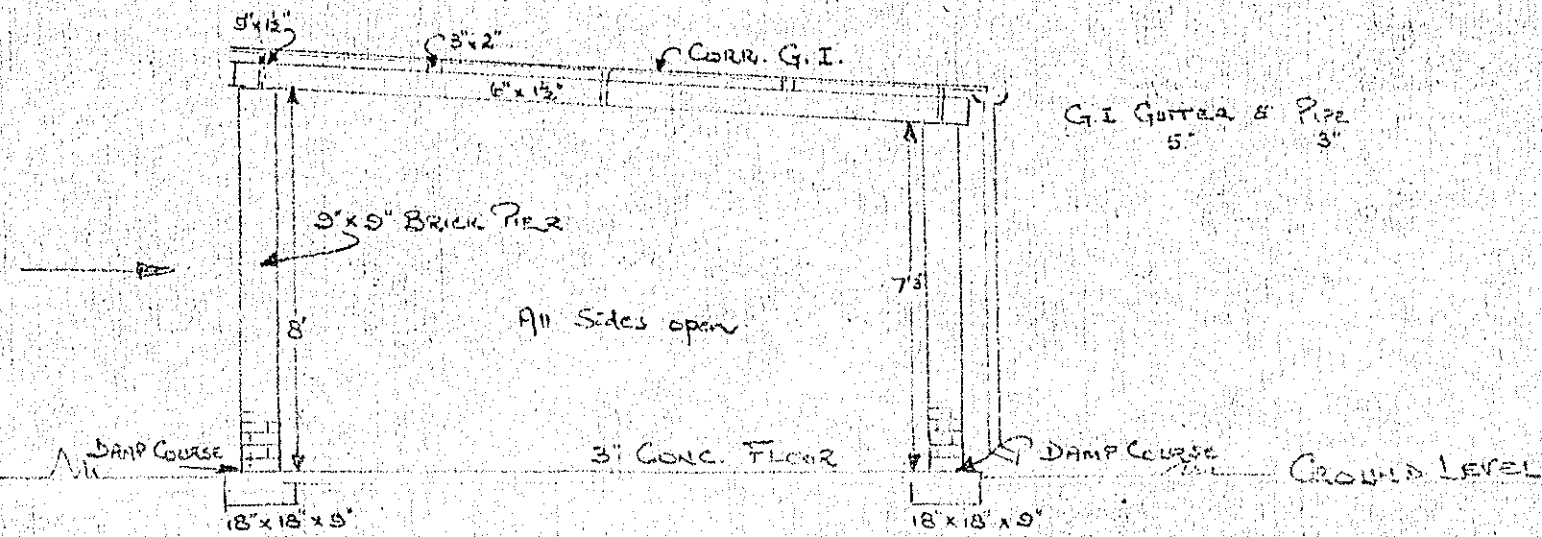

ROOF PLAN

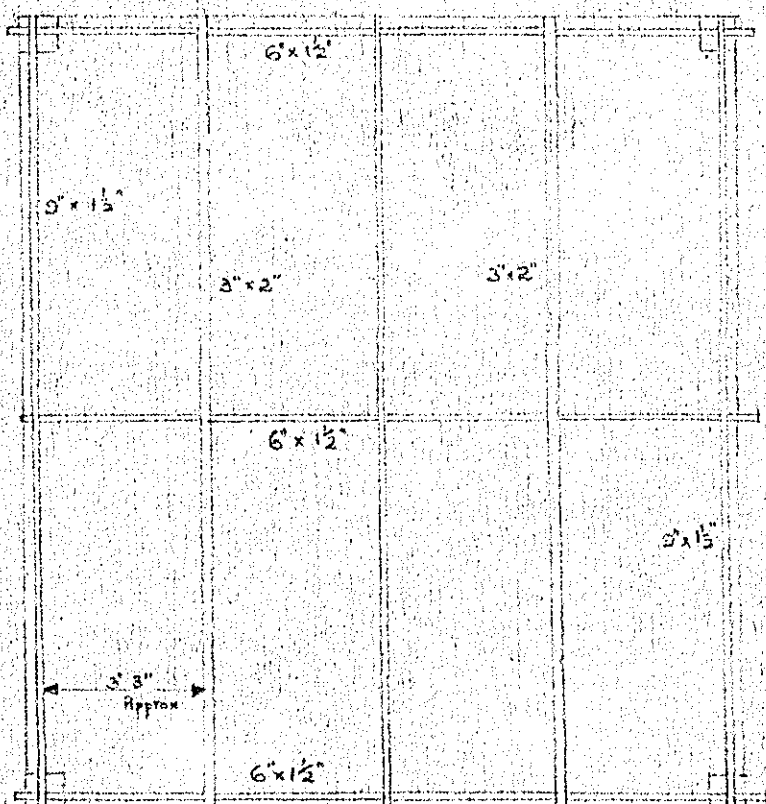

DRAWN BY ERICH VAN ROOYEN
Nov '61

for J.A. Bruner *A. Bruner*