

LOT No. 3542 Pt.

Building Plan No. 78-512

BUILDING PLAN APPROVED

TOWN ENGINEER

JAYE COMPLETED 6-6-79
 COMPLETION CERT No. 8650

Owners/Builders are warned that a building materials or other articles may remain on any street or footpath for a longer time than may be necessary for loading and unloading.

All Electricity and Post Office Cables and other Poles in the street may be present before entrances are constructed. Applications for an electrical connection must be made to the City Electrical Engineer when the building is commenced to avoid delay.

IMPORTANT
ELECTRICITY SERVICES

As the Durban Corporation Electricity Department is responsible for electricity supplies in this area, their records for electricity supplies in this area must be kept at the Area Street Office, Durban. It is essential that details of electricity services that may be affected and to discuss procedures to be followed. BEFORE ANY DEMOLITION WORK IS COMMENCED.

OCCUPATION NOT PERMISSIBLE UNTIL OCCUPATION CERTIFICATE HAS BEEN ISSUED

THE TOWN ENGINEER TO BE NOTIFIED PRIOR TO COMMENCEMENT OF BUILDING OPERATIONS

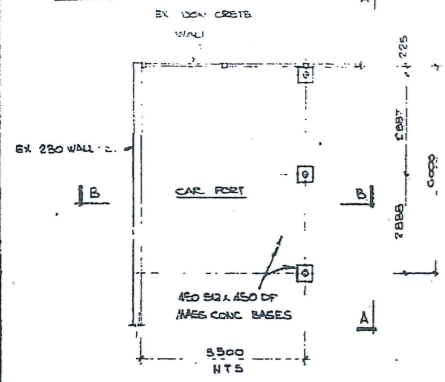

PLAN OF NEW CAR PORT
1:100

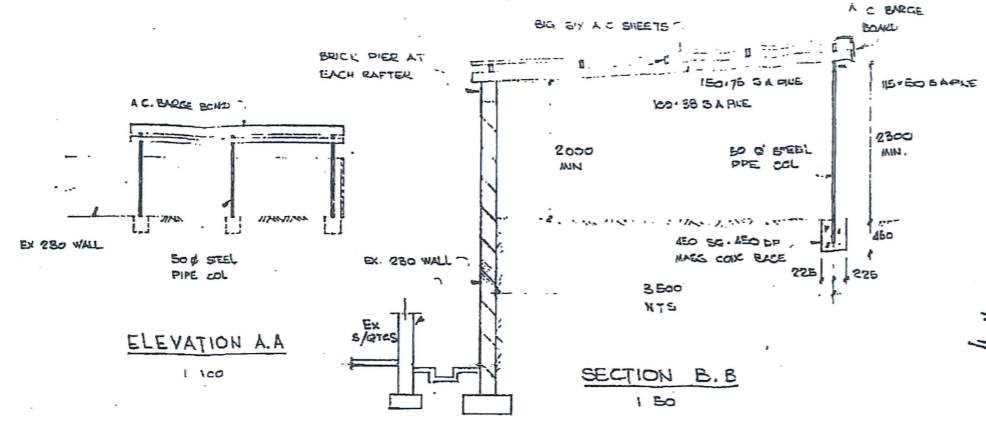

ELEVATION A.A
1:100

SECTION B.B
1:50

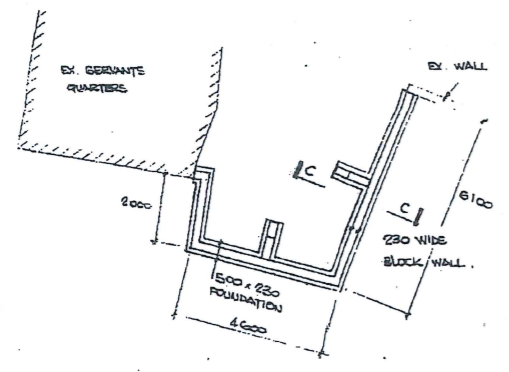

PLAN OF NEW RETAINING WALL
1:100

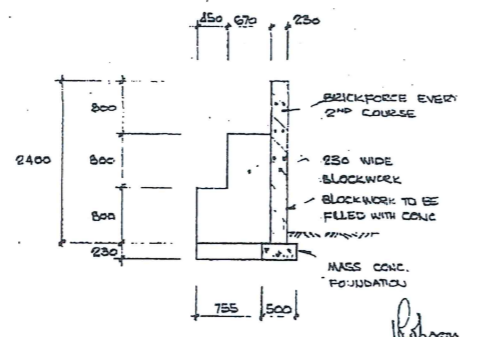

RETAINING WALL TO BE DESIGNED BY STRUCTURAL ENGINEER

SECTION C.C
1:50

Robson P. Eng.
7/11/78

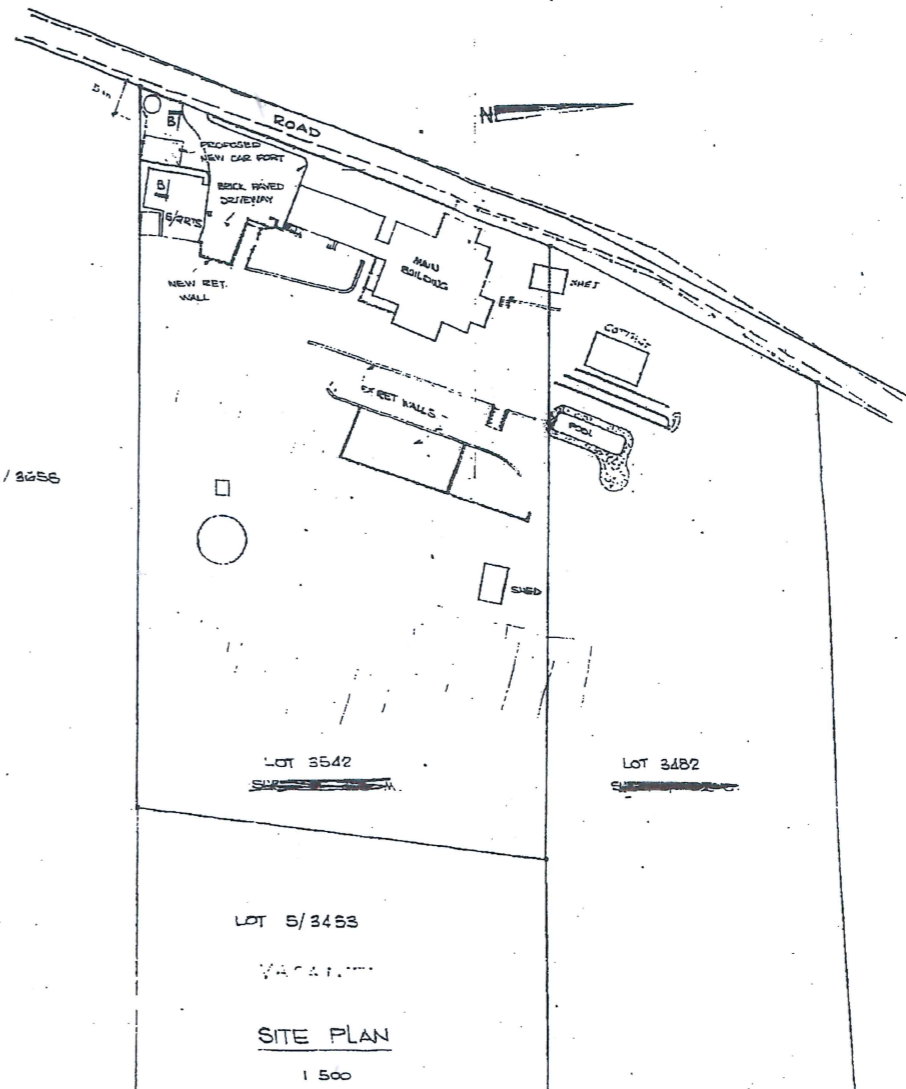

SITE PLAN
1:500

ADDITIONS TO RESIDENCE FOR MRS. M. M. TAYLER.
 42 ROCKHAVEN RD. COMIES HILL. LOT 3542 - SUB 1 OF M.

DRAWN	
DATE	1 OCT 78
DRAWING NO	REV
7857/1	