

SHEET	1/1	COPY	1
CITY OF DURBAN			
PLAN NO. 471/11/80			
APPROVED - 4 FEB 1981			
DATE _____			
E.C. MACLEOD			
CITY ENGINEER PER <i>[Signature]</i>			

**ORIGINAL  
AS BUILT**

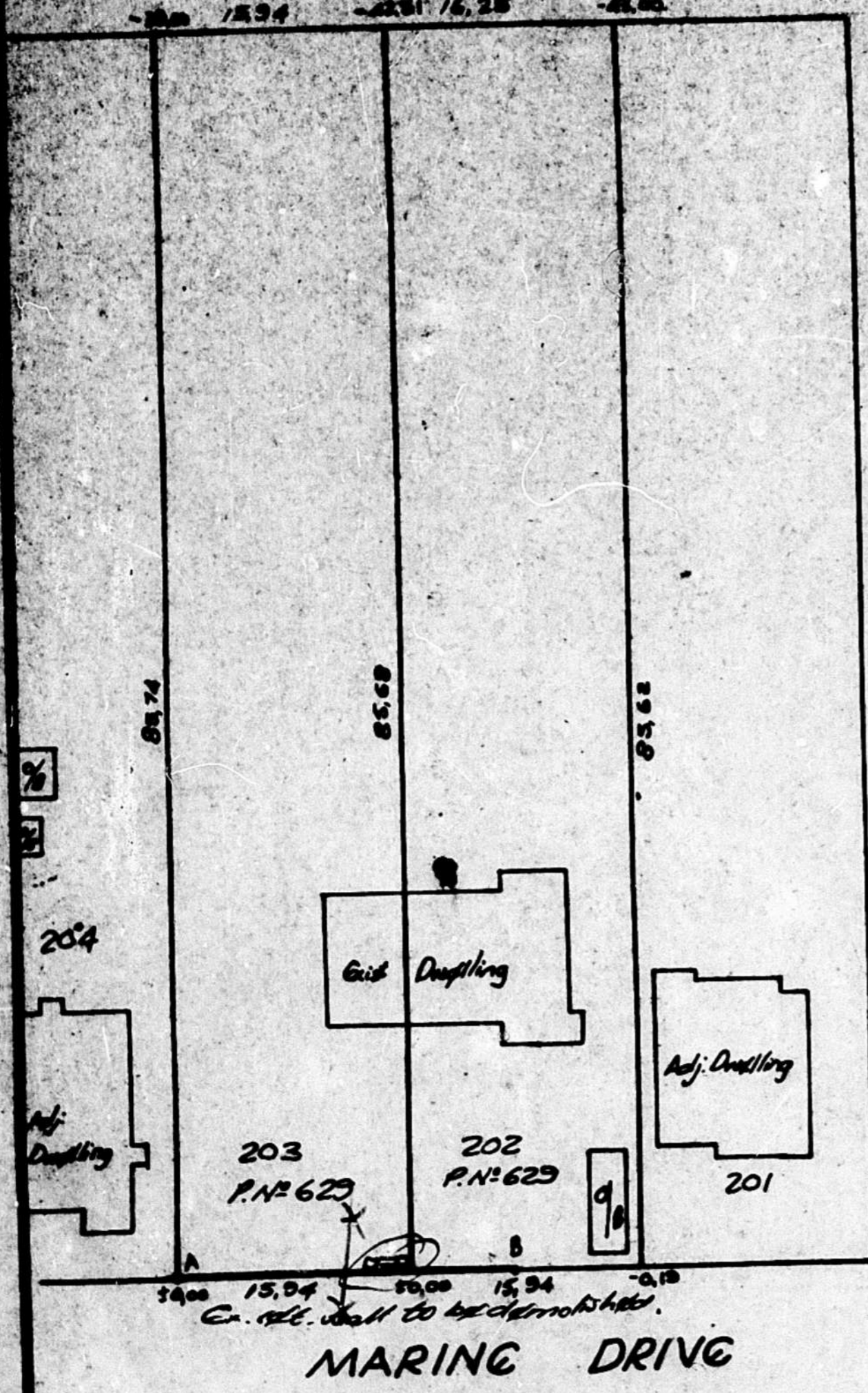

NOTES			
FOUNDATIONS NOT TO ENCROACH OVER BOUNDRIES.			
NOT TO RETAIN MORE THAN 300mm SOIL.			
FAIR FACE TO FACE ROAD.			
WALLING DETAILS			
	HEIGHT	LENGTH	DESIGN
A - B	1,2m	23,1m	Rastic One
B - C			
C - D			
D - E			
E - F			
F - G			
G - H			
H - I			

**PRECAST CONCRETE FENCES ON BOUNDARIES**  
BOUNDARY BEACONS TO BE EXPOSED AND POINTED OUT TO THE DISTRICT BUILDING INSPECTOR BY THE APPLICANT BEFORE ERECTION OF THE FENCE IS COMMENCED. THE BEACONS SHALL REMAIN EXPOSED AFTER COMPLETION OF THE WORK FOR A FINAL INSPECTION.

**DURBAN CONCRETE FENCING**  
P.O. BOX 5543, DURBAN, 4000.  
PHONE 329952.  
DRG. No. 960  
DATE 10 November 1980 *[Signature]* G.N.

SCALE : 1 : 500  
SITE DESCRIPTION: 202 MEREPARK OF WENTWORTH N<sup>o</sup> 860 AND 203 MEREPARK OF WENTWORTH N<sup>o</sup> 860  
**PROPOSED PRECAST WALL FOR MR. G. THERON AT 629 MARINE DRIVE, BLUFF**