

RING BEAM DETAIL 1:20

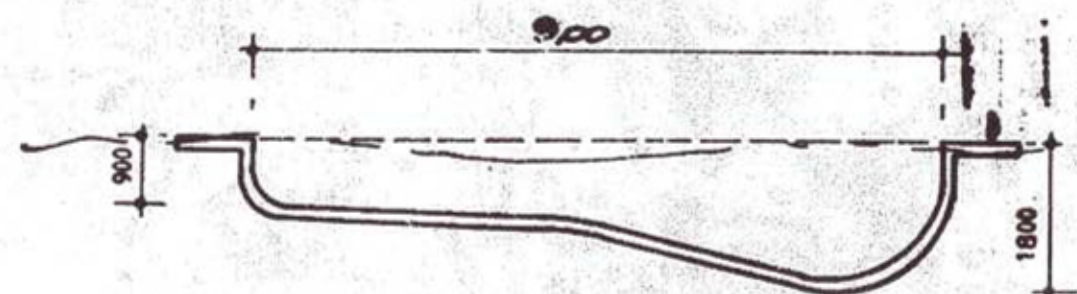

SECTION A A

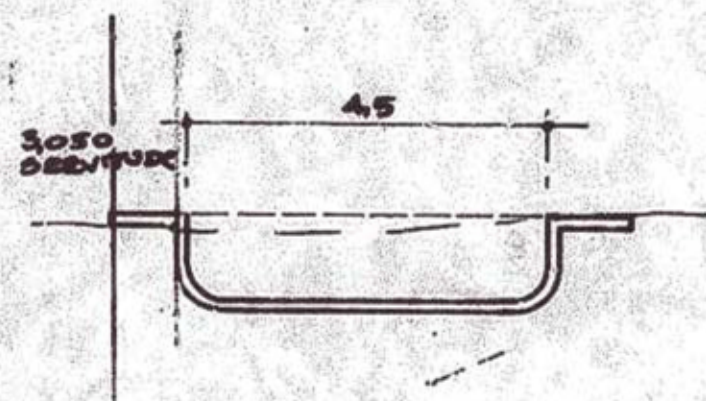

SECTION B B

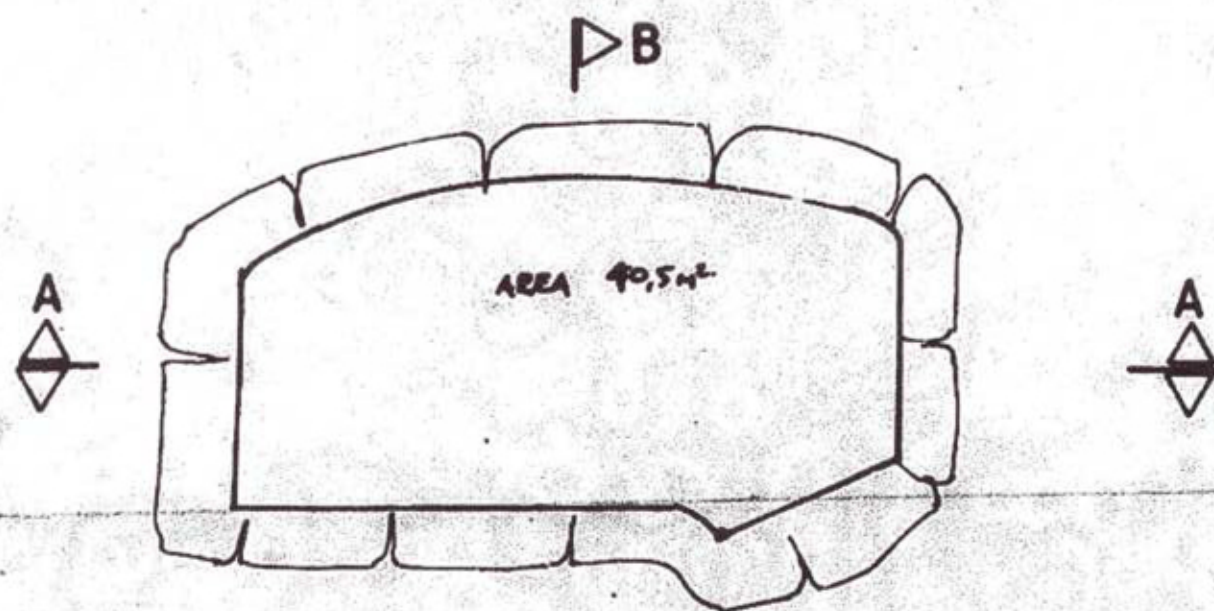

PLAN 1:100

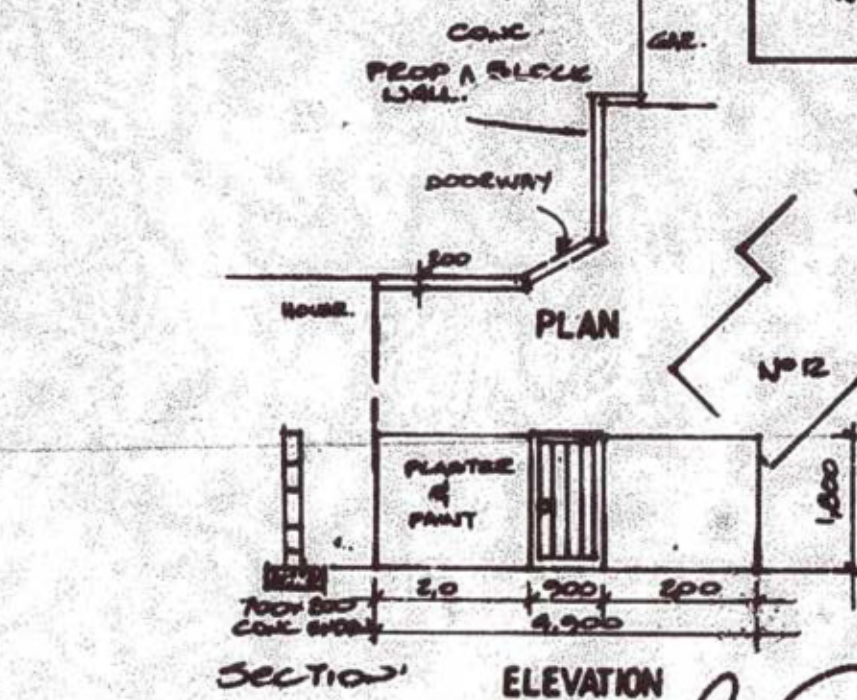

ELEVATION

NOTES

BEAM WALL AND FLOOR REINFORCED WITH 8mm BARS AT 300mm c/c BOTH WAYS. MIN LAP 380mm.

POOL IN GUNNITE MONOLITHICALLY AND PNEUMATICALLY PLACED MIX 1 PART CEMENT TO 4 PARTS RIVER SAND

EARTH LEAKAGE TO BE FITTED TO ELECTRICAL SUPPLY PRECAUTIONS TO BE TAKEN REGARDING CONDENSATE STATE SUNKEN PUMP CHAMBER TO HAVE ADEQUATE DRAINAGE ELECTRICAL APPARATUS TO BE HOUSED PRECAUTIONS TAKEN AGAINST FLOODING, SEEPAGE ETC

BEAM IS NOT INTEGRAL WITH POOL

WASTE WATER TO SEWER VIA BREAK PRESSURE TANK

EXCAVATED SOIL SPREAD OVER SITE

POOL AREA TO BE FENCED IN ACCORDANCE WITH NBS PART D 4 (1.2.5)

The registered owner of property described as _____ hereby acknowledge that any portion of the _____ situated upon the Durban City Council's servitude area on the said property, will remain there of my own risk, and if damaged in the course of any Departmental work carried out within the said servitude area, no liability whatsoever shall attach to the Durban City Council in respect of such damage. This indemnity shall remain applicable notwithstanding any change in the ownership of the said property, and I hereby undertake to ensure that my successor-in-title to this property is made aware hereof, and further, that the said successor-in-title undertakes to ensure that all subsequent successors-in-title are likewise made aware hereof.

Date _____ Signature _____

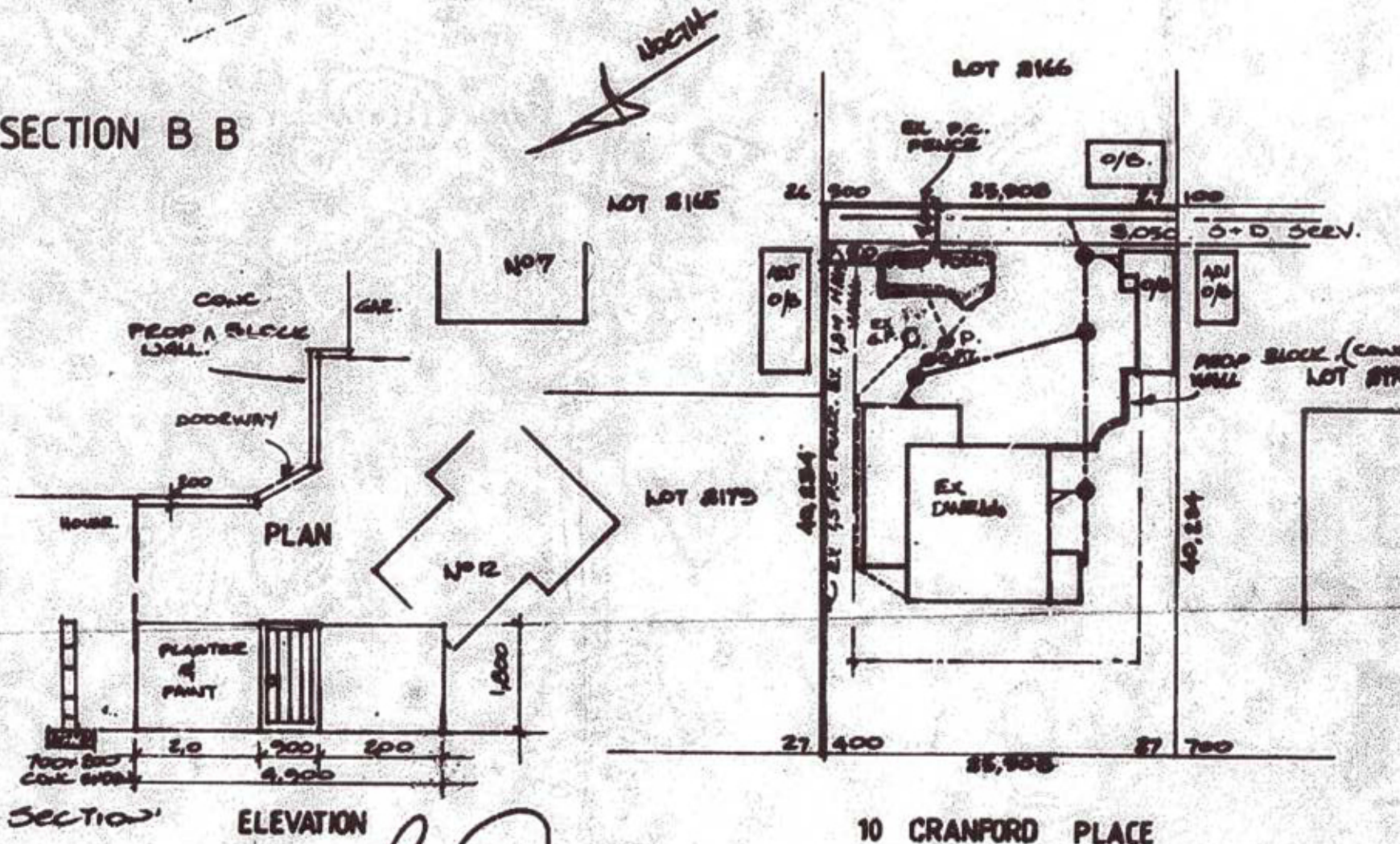

SITE PLAN 1:500

P. E. Watney & Associates
 P. E. Watney & Associates
 Consulting Engineers
 P.O. Box 37083
 Overport 4087
 Telephone: 880883

SHEET 1/1 COPY 3
CITY OF DURBAN
 PLAN NUMBER 0835/10/87/5
 APPROVED: D.C. MACLEOD
 CITY ENGINEER

A. As certified on the Application Form, the author of the plan is responsible for:

(1) showing on the application drawings (a) the correct level of entry into DC service, drains and/or abutments at discharge points; (b) the tops of foundations of any frontage works at a minimum depth of 0,250 metres below frontage level;

(2) showing no encroachment over DC servitudes or DC underground services.

B. Frontage levels are to:

(1) conform to the back of the constructed sidewalk, or

(2) to be calculated by the use of the following formula:

$$FL = E + 0,025m \times D$$

(where FL = frontage level, E = level at edge of hardstand, and D = distance in metres between edge of road hardening and road reserve boundary.)

C. A concrete beam at the correct frontage level is to be provided at each entrance/exit at the same grade as the kerb or road.

D. No change in level over DC servitudes or DC underground services is permitted without the prior written approval of the City Engineer.

Any person undertaking building operations in accordance with this plan is required to ascertain from the City Electrical Engineer the location of underground cables in the vicinity of the proposed works prior to the commencement thereof.

IMPORTANT

THE APPLICANT IS RESPONSIBLE FOR ASCERTAINING THE POSITION OF ALL POST OFFICE CABLES OR OTHER PLANT AND WILL BE LIASLE FOR ANY COST ARISING DUE TO DAMAGE TO OR THE NEED FOR RELOCATION OF SUCH PLANT ARISING OUT OF WORK INDICATED ON THIS APPLICATION.

THE POOL BEING AT ALL TIMES SCREENED FROM THE ROAD TO THE SATISFACTION OF THE CITY ENGINEER. REASON: IN ORDER TO SECURE COMPLIANCE WITH THE PROVISIONS OF THE TOWN PLANNING SCHEME IN COURSE OF PREPARATION.

PROPOSED SWIMMING POOL FOR MR F STEYL LOT 2177 OF 13 OF VICTORIA COUNTY NO 1546

PERRY POOLS (PTY) LTD
 Telephone 454 111

DRAWN: *cb phoon*
 DATE: 20/10/87
 DRG NO: