

P.T.O.

SHEET 1/1 COPY 2

**CITY OF DURBAN**

PLAN NUMBER 0857/03/90/1

APPROVED: **D.C. MACLEOD**  
CITY ENGINEER

DATE 1 APR 1980

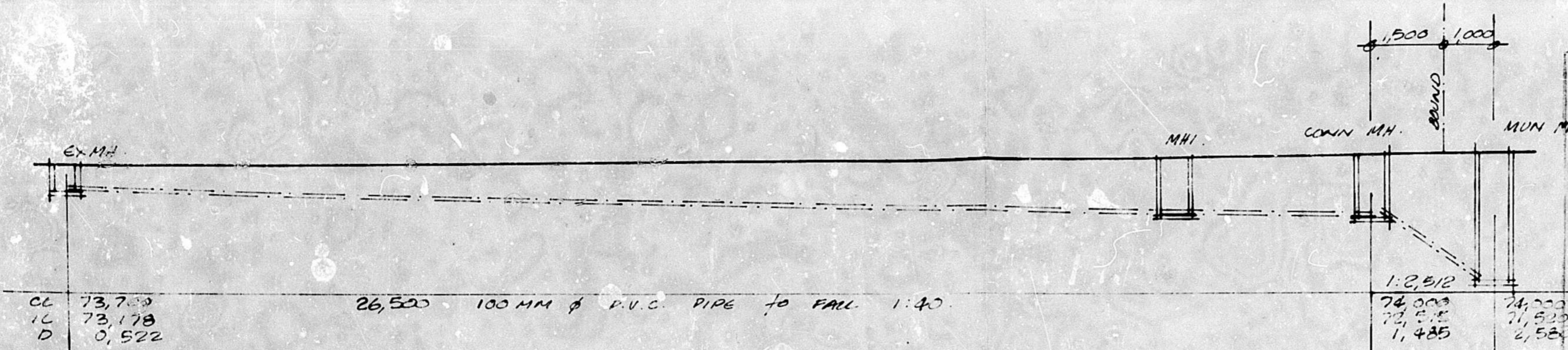

CL 73,700  
IL 73,178  
D 0,522

74,000  
72,515  
1,485

74,200  
71,520  
2,520

**drainage section**  
1/100

MARINE DRIVE 28,000 WIDE

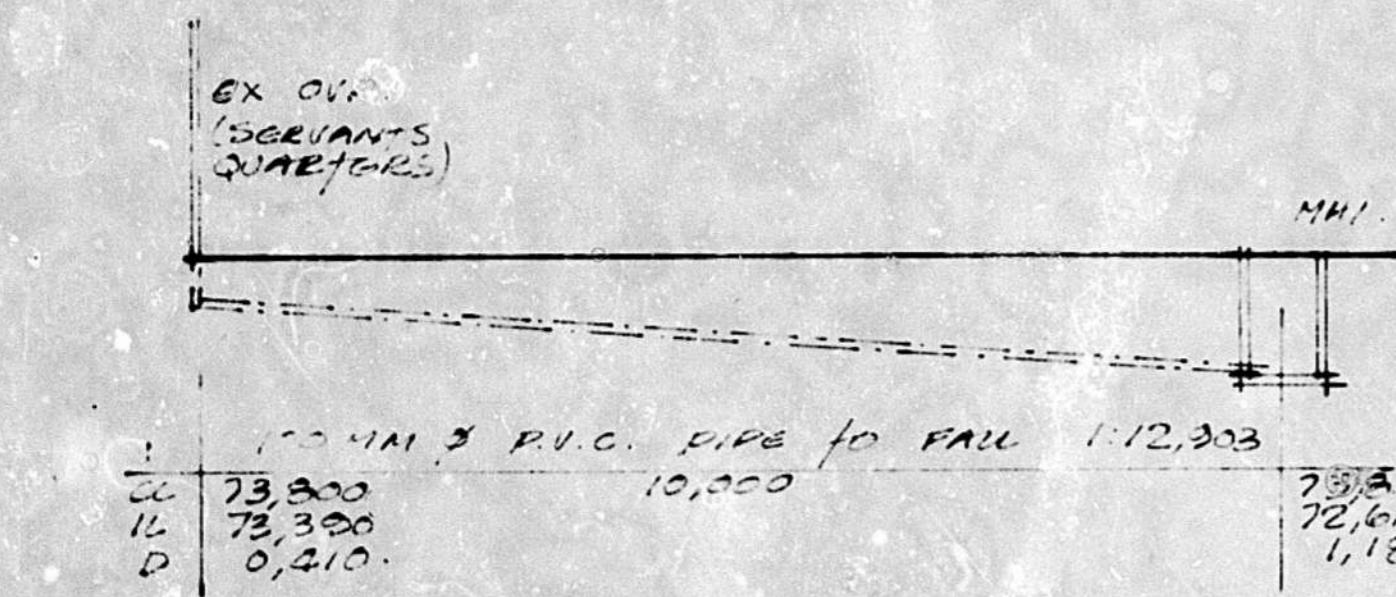

CL 73,300  
IL 73,300  
D 0,410

73,500  
72,615  
1,185

**drainage section**  
1/100

All existing wastes, drains,  
soil & vent pipes to conform  
to current  
National Building Regulations

**notes:**

- EXISTING SEPTIC TANKS TO BE DEMOLISHED FILLED & SEALED.
- ALL SANITARY PIPINGS TO BE CONNECTED TO MAINS.
- ALL IES TO HAVE SURFACE CONCRETE MARKERS.
- PLUMBER TO LOCATE CONNECTION PRICE TO COMMENCEMENT OF WORK.

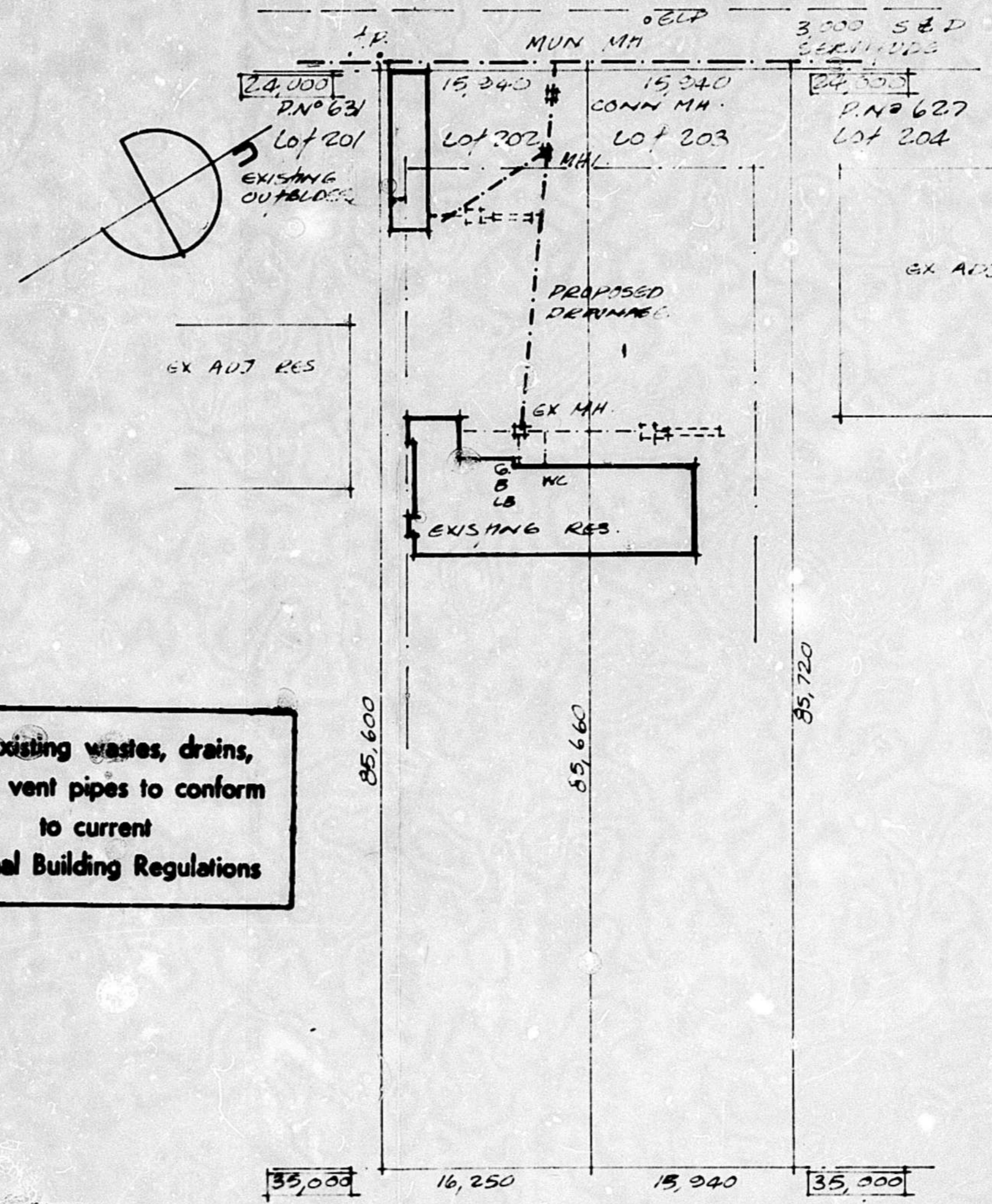

"It should be noted that this plan has been approved on the basis of information thereon."

proposed sewer connection  
on lots 202 & 203  
meremark, bluff  
for g. & e. glading  
629 marine drive  
rate no: 25306075

owner: *Syd Moore*

designer: *Syd Moore*

syd. g moore msaibd  
reg no 0116 architects act (1970)  
p o box 63  
warner beach 4340  
tel 013 903 6239  
013 96 4141

drawn m d g m	scale 1/100	drg no sm 7555
date feb	1/500	
file no f8246		sheet no 1/1

*The Gladys Street Studios*

**site plan**  
1/500

AREA 2733M<sup>2</sup>