

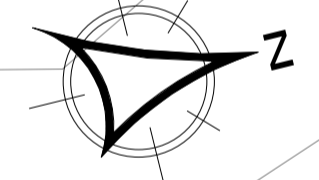

**NEW PROPOSED PRIVATE HOSPITAL
ERF 3229 ESTCOURT,
5.2155Ha**



PLUMBING NOTES:
CE's at max intervals of 25m as per specialist details
Highest point in drainage system to be provided with a 2 Way Vent Valve
Invert level min 450mm
Detailed drainage layout as per wet services engineer

NOTE:
NATURAL VENTILATION TO BE PROVIDED AS PER MECHANICAL ENGINEERS DETAIL AND DESIGN
SMOKE EXTRACTION AS PER MECHANICAL ENGINEERS DETAIL AND DESIGN
DRAINAGE STRICTLY TO ENGINEERS DETAIL AND DESIGN
FINAL DESIGN OF MECHANICAL ENGINEERS DETAIL AND DESIGN
FINAL DESIGN OF FIRE AND DOMESTIC WATER MAINS STRICTLY TO ENGINEERS DETAIL AND DESIGN

51-01-02 Area Schedule (Gross Building) RH			
ZF	Name	Area	
11:01-01	Ground Floor	TABLETS	247.73 m ²
11:01-02	Ground Floor	LABORATORY	148.31 m ²
11:01-03	Ground Floor	CONFERENCE	82.21 m ²
11:01-04	Ground Floor	CASUALTY	366.10 m ²
11:01-05	Ground Floor	CASUALTY	242.87 m ²
11:01-06	Ground Floor	CONFERENCE	146.39 m ²
11:01-07	Ground Floor	CONSULTATION ROOMS	720.79 m ²
11:01-08	Ground Floor	CONSULTATION ROOMS	176.22 m ²
11:01-09	Ground Floor	PHARMACY	138.02 m ²
11:01-10	Ground Floor	RECEPTION	116.11 m ²
11:01-11	Ground Floor	LABORATORY	138.84 m ²
11:01-12	Ground Floor	LABORATORY	138.11 m ²
11:01-13	Ground Floor	MATERNITY	460.00 m ²
11:01-14	Ground Floor	MEDICAL	449.86 m ²
11:01-15	Ground Floor	PHARMACY	260.31 m ²
11:01-16	Ground Floor	PHARMACY	449.86 m ²
11:01-17	Ground Floor	PHARMACY	176.80 m ²
11:01-18	Ground Floor	PHARMACY	176.80 m ²
11:01-19	Ground Floor	RECEPTION	306.01 m ²
11:01-20	Ground Floor	RECEPTION	306.01 m ²
11:01-21	Ground Floor	THEATRE COMPLEX	466.63 m ²
11:01-22	Ground Floor	WASTE AREA	45.59 m ²
11:01-23	Ground Floor	WASTE AREA	75.53 m ²
11:01-24	Ground Floor	WASTE AREA	14.18 m ²
11:01-25	Ground Floor	WASTE AREA	616.04 m ²
11:01-26	Ground Floor	WASTE AREA	616.04 m ²
Grand Total			6166.04 m ²

51-01-01 Area Schedule (Gross Building) COVERAGE			
Floor	Name	Area	
11:01-01	Ground Floor	TABLETS	247.73 m ²
11:01-02	Ground Floor	LABORATORY	148.31 m ²
11:01-03	Ground Floor	LABORATORY	148.31 m ²
11:01-04	Ground Floor	CASUALTY	366.10 m ²
11:01-05	Ground Floor	CASUALTY	242.87 m ²
11:01-06	Ground Floor	CONFERENCE	146.39 m ²
11:01-07	Ground Floor	CONFERENCE	82.21 m ²
11:01-08	Ground Floor	CONSULTATION ROOMS	720.79 m ²
11:01-09	Ground Floor	CONSULTATION ROOMS	176.22 m ²
11:01-10	Ground Floor	PHARMACY	138.02 m ²
11:01-11	Ground Floor	RECEPTION	116.11 m ²
11:01-12	Ground Floor	LABORATORY	138.84 m ²
11:01-13	Ground Floor	LABORATORY	138.11 m ²
11:01-14	Ground Floor	MATERNITY	460.00 m ²
11:01-15	Ground Floor	MEDICAL	449.86 m ²
11:01-16	Ground Floor	PHARMACY	260.31 m ²
11:01-17	Ground Floor	PHARMACY	449.86 m ²
11:01-18	Ground Floor	PHARMACY	176.80 m ²
11:01-19	Ground Floor	PHARMACY	176.80 m ²
11:01-20	Ground Floor	RECEPTION	306.01 m ²
11:01-21	Ground Floor	RECEPTION	306.01 m ²
11:01-22	Ground Floor	THEATRE COMPLEX	466.63 m ²
11:01-23	Ground Floor	WASTE AREA	45.59 m ²
11:01-24	Ground Floor	WASTE AREA	75.53 m ²
11:01-25	Ground Floor	WASTE AREA	14.18 m ²
11:01-26	Ground Floor	WASTE AREA	616.04 m ²
11:01-27	Ground Floor	WASTE AREA	616.04 m ²
Grand Total			6166.04 m ²

Schedule of Rights		
Property Description		
Erffno: ERF 3229 Estcourt, Estcourt 19	Site No: 5.2155Ha (2016)	
Township: Umhlabo Local Municipality Site No: 19		
Zoning Information		
Zone	Abatement Scheme No.	
Planning Scheme	Abatement No.	
Site No	Abatement No.	
Development Control Measures		
Building Height	Max	
A	Height of Building	
%	Coverage	
...	...	
Parking		
Parking Ratio per Use	Zone	Parking Ratio Required
1:1	2:1	2:1
TOTAL PARKING BAYS REQUIRED		188
TOTAL PARKING BAYS PROVIDED		188
Additional No. of Parking Bays		128

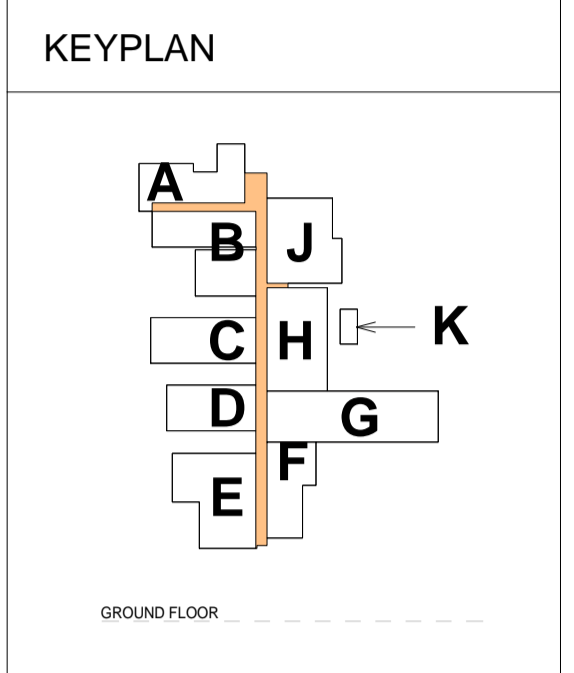

GENERAL NOTES

- Copyright of this drawing and all info therein, is hereby reserved by Origin Architects Pty Ltd. No reproduction or use of any part of this drawing is permitted without the written consent of Origin Architects Pty Ltd.
- Information on this drawing is provided for the client's use only. It is not to be used for any other purpose without the written consent of Origin Architects Pty Ltd.
- Any information on this drawing is provided for the client's use only. It is not to be used for any other purpose without the written consent of Origin Architects Pty Ltd.
- This drawing must be read in conjunction with any other specification or contract documents, drawings, bills of materials, etc.
- In the event of this drawing being issued in conjunction with any specification or contract documents, drawings, bills of materials, etc., the latter shall prevail over these drawings and must be taken as correct and binding.

SANS 10400 PART A - GENERAL PRINCIPAL AND REQUIREMENTS

- All structural work shall comply with SANS 10400 Part A
- All structural members shall comply with SANS 10114
- All structural steel shall comply with SANS 10114
- All structural steel shall comply with SANS 10114
- All structural steel shall comply with SANS 10114

SANS 10400 PART B - DIMENSIONS AND LEVELS

- All dimensions shall comply with SANS 10400 Part B
- All dimensions shall comply with SANS 10400 Part B
- All dimensions shall comply with SANS 10400 Part B
- All dimensions shall comply with SANS 10400 Part B
- All dimensions shall comply with SANS 10400 Part B

SANS 10400 PART C - PUBLIC SAFETY

- All changes in levels, ramps, public entrances and swimming pools, shall comply with SANS 10400 Part C
- All changes in levels, ramps, public entrances and swimming pools, shall comply with SANS 10400 Part C
- All changes in levels, ramps, public entrances and swimming pools, shall comply with SANS 10400 Part C
- All changes in levels, ramps, public entrances and swimming pools, shall comply with SANS 10400 Part C
- All changes in levels, ramps, public entrances and swimming pools, shall comply with SANS 10400 Part C

SANS 10400 PART D - DEMOLITION WORK

- All demolition work shall be carried out in accordance with the OSH Act No 85 of 1993, and SANS 10400 Part D
- All demolition work shall be carried out in accordance with the OSH Act No 85 of 1993, and SANS 10400 Part D
- All demolition work shall be carried out in accordance with the OSH Act No 85 of 1993, and SANS 10400 Part D
- All demolition work shall be carried out in accordance with the OSH Act No 85 of 1993, and SANS 10400 Part D
- All demolition work shall be carried out in accordance with the OSH Act No 85 of 1993, and SANS 10400 Part D

SANS 10400 PART E - ROOFS

- All roofs shall comply with SANS 10400 Part E
- All roofs shall comply with SANS 10400 Part E
- All roofs shall comply with SANS 10400 Part E
- All roofs shall comply with SANS 10400 Part E
- All roofs shall comply with SANS 10400 Part E

SANS 10400 PART F - STAIRWAYS

- All stairways shall comply with SANS 10400 Part F
- All stairways shall comply with SANS 10400 Part F
- All stairways shall comply with SANS 10400 Part F
- All stairways shall comply with SANS 10400 Part F
- All stairways shall comply with SANS 10400 Part F

SANS 10400 PART G - ELEVATORS

- All elevators shall comply with SANS 10400 Part G
- All elevators shall comply with SANS 10400 Part G
- All elevators shall comply with SANS 10400 Part G
- All elevators shall comply with SANS 10400 Part G
- All elevators shall comply with SANS 10400 Part G

SANS 10400 PART H - WALLS

- All walls shall comply with SANS 10400 Part H
- All walls shall comply with SANS 10400 Part H
- All walls shall comply with SANS 10400 Part H
- All walls shall comply with SANS 10400 Part H
- All walls shall comply with SANS 10400 Part H

SANS 10400 PART I - WINDOWS

- All windows shall comply with SANS 10400 Part I
- All windows shall comply with SANS 10400 Part I
- All windows shall comply with SANS 10400 Part I
- All windows shall comply with SANS 10400 Part I
- All windows shall comply with SANS 10400 Part I

SANS 10400 PART J - LIGHTING AND VENTILATION NOTES

- All lighting shall comply with SANS 10400 Part J
- All lighting shall comply with SANS 10400 Part J
- All lighting shall comply with SANS 10400 Part J
- All lighting shall comply with SANS 10400 Part J
- All lighting shall comply with SANS 10400 Part J

SANS 10400 PART K - PLUMBING AND DRAINAGE

- All plumbing and drainage shall comply with SANS 10400 Part K
- All plumbing and drainage shall comply with SANS 10400 Part K
- All plumbing and drainage shall comply with SANS 10400 Part K
- All plumbing and drainage shall comply with SANS 10400 Part K
- All plumbing and drainage shall comply with SANS 10400 Part K

SANS 10400 PART L - ENVIRONMENTAL SUSTAINABILITY

- All environmental sustainability shall comply with SANS 10400 Part L
- All environmental sustainability shall comply with SANS 10400 Part L
- All environmental sustainability shall comply with SANS 10400 Part L
- All environmental sustainability shall comply with SANS 10400 Part L
- All environmental sustainability shall comply with SANS 10400 Part L

SANS 10400 PART M - ENERGY USAGE IN BUILDINGS

- All energy usage in buildings shall comply with SANS 10400 Part M
- All energy usage in buildings shall comply with SANS 10400 Part M
- All energy usage in buildings shall comply with SANS 10400 Part M
- All energy usage in buildings shall comply with SANS 10400 Part M
- All energy usage in buildings shall comply with SANS 10400 Part M

SANS 10400 PART N - COMPLIANCE WITH OTHER RELEVANT SANS 10400 REGULATIONS

- All compliance with other relevant SANS 10400 regulations shall comply with SANS 10400 Part N
- All compliance with other relevant SANS 10400 regulations shall comply with SANS 10400 Part N
- All compliance with other relevant SANS 10400 regulations shall comply with SANS 10400 Part N
- All compliance with other relevant SANS 10400 regulations shall comply with SANS 10400 Part N
- All compliance with other relevant SANS 10400 regulations shall comply with SANS 10400 Part N

EXPANDED JOINTS ON FLOORS

- All expanded joints on floors shall comply with SANS 10400 Part N
- All expanded joints on floors shall comply with SANS 10400 Part N
- All expanded joints on floors shall comply with SANS 10400 Part N
- All expanded joints on floors shall comply with SANS 10400 Part N
- All expanded joints on floors shall comply with SANS 10400 Part N

SANS 10400 PART O - FIRE PROTECTION

- All fire protection shall comply with SANS 10400 Part O
- All fire protection shall comply with SANS 10400 Part O
- All fire protection shall comply with SANS 10400 Part O
- All fire protection shall comply with SANS 10400 Part O
- All fire protection shall comply with SANS 10400 Part O

SANS 10400 PART P - FIRE PROTECTION - REGULATORY

- All fire protection - regulatory shall comply with SANS 10400 Part P
- All fire protection - regulatory shall comply with SANS 10400 Part P
- All fire protection - regulatory shall comply with SANS 10400 Part P
- All fire protection - regulatory shall comply with SANS 10400 Part P
- All fire protection - regulatory shall comply with SANS 10400 Part P

SANS 10400 PART Q - COMPLIANCE WITH OTHER RELEVANT SANS 10400 REGULATIONS

- All compliance with other relevant SANS 10400 regulations shall comply with SANS 10400 Part Q
- All compliance with other relevant SANS 10400 regulations shall comply with SANS 10400 Part Q
- All compliance with other relevant SANS 10400 regulations shall comply with SANS 10400 Part Q
- All compliance with other relevant SANS 10400 regulations shall comply with SANS 10400 Part Q
- All compliance with other relevant SANS 10400 regulations shall comply with SANS 10400 Part Q

SANS 10400 PART R - FIRE INSTALLATION

- All fire installation shall comply with SANS 10400 Part R
- All fire installation shall comply with SANS 10400 Part R
- All fire installation shall comply with SANS 10400 Part R
- All fire installation shall comply with SANS 10400 Part R
- All fire installation shall comply with SANS 10400 Part R

01-01-01 General Site Plan
1:500

ORIGIN
ARCHITECTS BY NATURE

W: www.origin.co.za E: info@origin.co.za T: +27 (0)12 346 4534 F: +27 (0)12 346 2764
A: West End Office Park, Building 8, 11th Floor, 2500 Street, Centurion P.O. Box 30376
Nedburg, Pretoria 0001

SUBMISSION **DOH**

ESTCOURT PRIVATE HOSPITAL
ERF 3229 Estcourt Extension 19
19-0A-004
SITE PLAN
2019-01-01

DATE: 6/13/2019 9:04:41 AM
SCALE: As indicated
DRAWN: AD
CHECKED: JMK/MD
DATE: 18/01/2019