



**SOUTH-EAST ELEVATION**  
Scale 1:100



**NORTH-WEST ELEVATION**  
Scale 1:100



**NORTH-EAST ELEVATION**  
Scale 1:100

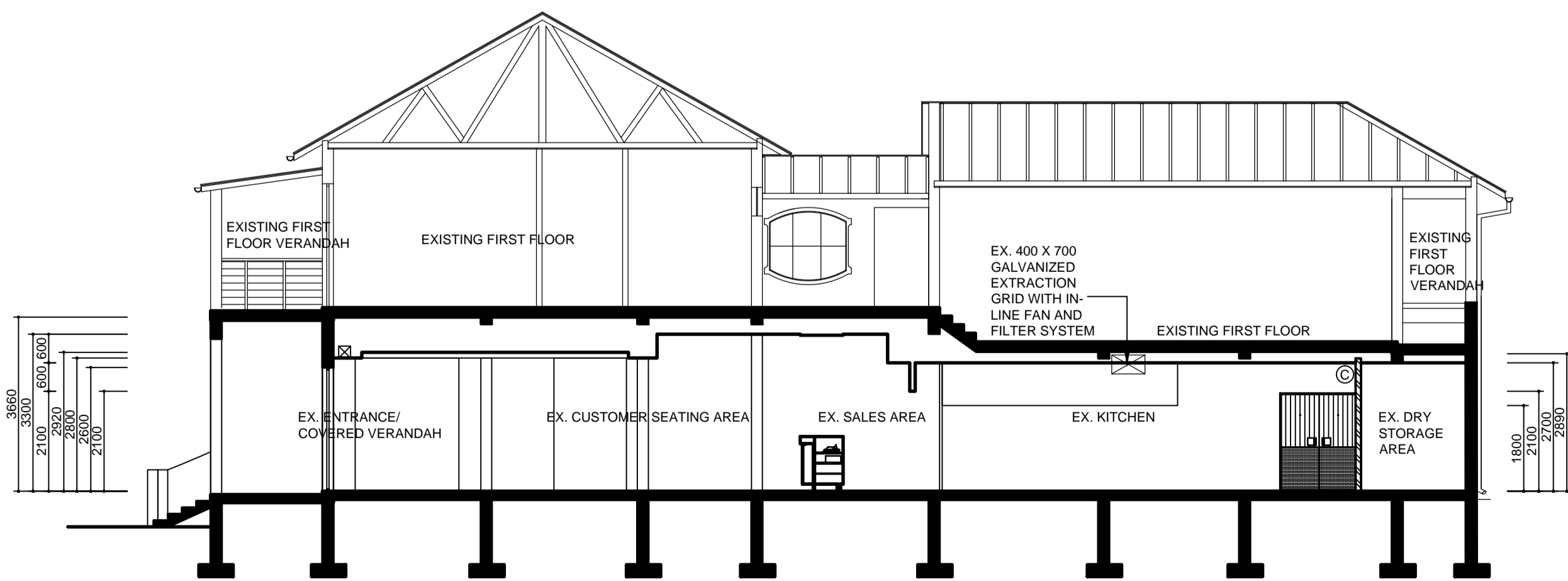

**SECTION A-A**  
Scale 1:100

**FIRE PROTECTION NOTES:**

ALL WORK TO COMPLY WITH SANS 10400.  
OCCUPANCY CLASSIFICATION -A1.  
5x4.5kg CO<sup>2</sup> EXTINGUISHERS TO BE INSTALLED IN ACCORDANCE WITH SABS 0105.  
PORTABLE FIRE EXTINGUISHERS TO BE HUNG ON PURPOSE MADE BOARDS & LOCATED IN SECURE POSITIONS AS INDICATED ON PLAN IN COMPLIANCE WITH TT37.  
ESCAPE DOORS MAY ONLY BE FITTED WITH LOCKING DEVICES AS APPROVED BY THE LOCAL AUTHORITY.  
MARKING & SIGNAGE TO COMPLY WITH SANS 1186-1.  
PICTORIAL SIGNS INDICATING FIRE EQUIPMENT & MEANS OF ESCAPE TO BE IN COMPLIANCE WITH TT32.2, TT29, TT55.4 & TT55.5.  
SUSPENDED CEILINGS & SUPPORTING MEMBERS TO BE NON-COMBUSTABLE & TO COMPLY WITH TT13(1) AND TT13(2).  
ALL EMERGENCY LIGHTING TO COMPLY WITH TT30.  
EMERGENCY LIGHTING TO BE INSTALLED AT MIN 50 LUX FOR A PERIOD OF AT LEAST 60min.  
1x30m ROTARY HOSE REEL AS SHOWN ON PLAN.  
STRUCTURAL ELEMENTS & COMPONENTS TO HAVE MINIMUM STABILITY RATING OF 60min.  
MANUALLY ACTIVATED AUDIBLE ALARM SYSTEM TO BE INSTALLED IN ACCORDANCE WITH SANS 10139 & TT31.

**MECHANICAL VENTILATION:**

FRESH AIR SUPPLY OF 17.5lit PER SEC/PERSON WITH MAXIMUM AIR VELOCITY OF 0.5m/SECOND TO BE PROVIDED TO KITCHEN AND SEATING AREA.

AIR TO INTERNAL TOILETS TO BE EXTRACTED TO EXTERNAL AT THE RATE OF 20lit SEC/FITMENT AND TO OUTSIDE OF BUILDING ENVELOPE.

ARTIFICIAL VENTILATION TO ALWAYS BE UNDER NEGATIVE PRESSURE.

**GENERAL NOTES:**

ALL WORK TO COMPLY WITH NBR/SANS 10400.  
ALL DIMENSIONS & LEVELS TO BE VERIFIED ON SITE.  
OVERALL EXTERNAL DIMENSIONS ARE TO TAKE PRECEDENCE.  
WORK FROM FIGURED DIMENSIONS ONLY-DO NOT SCALE FROM DRAWING.  
WHERE APPLICABLE, SUB-CONTRACTORS TO CHECK ON SITE THE SIZE OF COMPONENTS PRIOR TO MANUFACTURE.  
ALL LIGHTS & VENTILATION TO COMPLY WITH PART 'O' OF NBR/SANS 10400

**NOTE:**

ALL PIPEWORK IN KFC BELOW SURFACE BED TO BE WELDED HDPE

ALL SANITARY FITTINGS, EXCLUDING ROFO DRAINS AND GT700 GREASE TRAP, TO BE SUPPLIED AND FITTED BY TENANT.

ALL PIPE-WORK BELOW SURFACE BED TO BE WELDED HDPE DIA. 110mm AND DIA. 56mm

STUB STACKS TO BE TO DRAINAGE ENGINEER'S DESIGN AND DETAIL

**SCHEDULE OF AREAS:**

PUBLIC ACCESSIBLE AREAS: 94,2sqm  
RESTAURANT AREA: 80,2sqm  
FIRST FLOOR:

TOTAL PUBLIC ACCESSIBLE AREA: 174,4sqm

PARKING REQUIREMENTS ARE 1BAY/10sqm OF P.A.A. THUS 18 PARKING BAYS REQUIRED AND ADD 2 PARKING BAYS FOR EXISTING DWELLING THUS:

TOTAL PARKING REQUIRED: 20 BAYS  
TOTAL PARKING INDICATED: 21 BAYS

| No: | DATE: | DESCRIPTION: | REVISION: |
|-----|-------|--------------|-----------|
|     |       |              |           |

- GENERAL NOTES**
- IF IN DOUBT, ASK.
  - ALL WORK CARRIED OUT TO BE IN ACCORDANCE WITH THE LOCAL AUTHORITY SPECIFICATIONS AND THE NATIONAL BUILDING REGULATIONS.
  - FIGURED DIMENTION TO BE TAKEN IN PREFERENCE WITH SCALING.
  - CHECK ALL DIMENTIONS ON SITE.

OWNERS SIGNATURE: \_\_\_\_\_ DATE: \_\_\_\_\_

**TOWNSCAPE DESIGNS**  
PROJECT MANAGEMENT AND DESIGN

EMAIL: TOWNSCAPE@MZ-ZONE.COM  
TEL: +27(0)31 262 4312  
FAX: +27(0)86 610 1450  
CELL: +27(0)83 631 5373  
3A BEACONSFIELD RD, WESTVILLE 3629  
SAGAP NO.: ST 0315  
SAIAT NO.: 32155

PROJECT: \_\_\_\_\_

**DEVIATIONS TO APPROVED PLAN No: 114/04/13 FOR J. BRAUNS, AT 149 FLORIDA ROAD, ON ERF 911, WINDERMERE, DURBAN**

DRAWING NAME: \_\_\_\_\_  
SUBMISSION: \_\_\_\_\_  
SITE PLAN, FLOOR PLAN AND ELEVATIONS

|                          |                    |
|--------------------------|--------------------|
| DATE: FEB 2014           | SCALE: 1:100       |
| DRAWING No: 2013-16-102D | DRAWN BY: C. HUMAN |