

Annex B - Distribution Environmental Screening Document (DESD)

(Informative)

Reticulation Powerlines and Ancillary Services

Ratified and accepted by

Environmental Practitioner

Environmental Specialist

Head of Engineering Survey

(one signature please)

Accepted by Land Owner/s/Users

I have seen the completed document and accept the

recommendations made

Assessor/s

Form completed by

A. Pretorius

Signature:

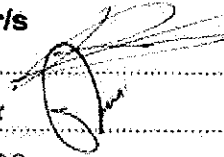

in consultation with:

A.S. Ntuli

Signature: x



CAPACITY (e.g. land owner, specialist):

Technical Manager

DATE COMPLETED:

22 Aug 2013

Instructions

1. Fill the report in as neatly and completely as possible.
2. Where the question / statement is not applicable mark N/A.
3. Indicate sensitive areas on a map and/or spanning plans.
4. When in doubt, consult the Environmental Practitioner in your region.

The purpose of this DESD is to:

- Determine whether or not the project should be subject to R543 -7, published in terms of the National Environmental management Act 107 of 1998.
- Identify and mitigate the negative impact of Eskom's activities to a minimum in line with both Legislation and Eskom's Environmental Policies.
- This report is a guide to Route Selection, Construction and Field Services.

NOTE Complete the report before the survey!!!

This is not an office exercise.

Extra sheets of paper may be added and referenced if insufficient space has been provided.



Annex B
(continued)

1 Project description

Project name/Survey
Request ESKOM WITBANK Area
Project number File number
Rural scheme/
Feeder Voltage
Supply from
(scheme name, pole numbers for tee-off)
Supply to GEMSBOEK FEEDER LINE
(Farm name, etc.)

2 Properties traversed

Farm name ENKELDOORING 217, 651 ENKELDOORING 219
Registration number and Division JR Sub-division R, Z, L
Compilation number Line length (m)
Farm name
Registration number and Division Sub-division
Compilation number Line length/Site area (m²)

3 Brief description of the surrounding area

At GEMSBOEK Substation you can see the existing PL. Our new PL will run next to this existing PL until the end of the houses turn right and along houses crossing HV powerline and continue in road reserve to the crossing. From there between houses until it reaches Muli Village.

Could the proposed project have an impact on or be constrained by any of the following environmental aspects?

Encircle the appropriate aspect, giving a description of the present state as well as an indication of the possible negative impact. Note that mitigating measures for these impacts are to be included in the Environmental Management Programme.

ESKOM COPYRIGHT PROTECTED

PLEASE SIGN HERE: 

Annex B
(continued)

4 Physical environment

4.1 Water: streams rivers dams wetlands springs floodplains OTHER

Present condition: Rivers nearby, Wetlands in area.

Note: No pegs to be placed within 100m of a watercourse (stream, river & dam) or 500m from a wetland. The Environmental Management Officer must be consulted.

Potential impact (e.g. threat of pollution):

No potential impact.

4.2 Soil: sandy rocky clayey OTHER

Present condition: Normal soil, rocky parts as well.

Potential impact (e.g. of erosion) No potential impact.

4.3 Topography mountains ridges hills valleys ravines dongas OTHER

Present condition: Powerline going uphill and downhill.

Potential impact (e.g. of erosion) No potential impact.

Comments/mitigating measures:

Rivers nearby.

Annex B
(continued)

5 Natural environment

5.1 Flora: indigenous protected exotic OTHER

Brief description and conservation status (e.g. rare, etc., mention trees/bush/grass) grass
Tras, (oam trees)

Potential impact (e.g. permit applications) cut & trim

5.2 Fauna: mammals birds OTHER

Brief description and conservation status:
(e.g. rare, protected, etc., mention giraffe, elephants, eagles, vultures, etc., mention migratory paths)
Cattle, goats, dogs, cats, chickens, sheep, birds.

Potential impact (e.g. threat of electrocution, collision, etc.)
No potential impact

Comments/mitigating measures:

Need to cut & trim trees.

6 Social environment

6.1 Restricted areas: nature/game reserves hiking trails tourism routes parks recreational areas
Residential-areas green belts sacred/holy grounds OTHER

Brief description No restricted areas

DOCUMENT CLASSIFICATION: CONTROLLED DISCLOSURE
ENVIRONMENTAL IMPACT ASSESSMENT FOR
DISTRIBUTION ACTIVITIES

Unique Identifier: 34-926
Type: DPC
Revision: DRAFT 0A
Page: 5 of 7

Annex B
(continued)

Potential impact e.g. threat of encroachment, etc. *No potential impact*

6.2 Visual aesthetics: easily seen hidden partially *X*

Brief description *Between houses*

Potential impact *No potential impact*

6.3 Natural heritage: cultural significance archaeological objects monuments palaeontological objects graves meteorites ruins OTHER

Note: Should any natural heritage resource as listed above, or as defined in the National Heritage Resource Act, No 25 of 1999 be identified, the requirements of Act 25 of 1999 shall be followed by notifying the SAHRA. If line or access road length exceeds 300m SAHRA shall be notified.

Potential impact *No natural heritage*

Comments/mitigating measures
No comments or mitigating measures

7 Economic environment

7.1 Land use: crops orchards grazing crop spraying
game farming forestry areas mining OTHER

Brief description *Houses*

Annex B
(continued)

Potential impact No potential impact.

7.1.1 Commercial: factories shops OTHER

Brief description Shops nearby.
Potential impact No potential impact.

7.1.2 Infrastructure: roads railways communications power lines air fields
pipelines sewage OTHER

Brief description: Crossing national roads
Crossing HV & MV Powerlines.

Potential impact No potential impact.

Comments/mitigating measures:
Crossing national roads
Crossing HV & MV Powerlines

PLEASE SIGN HERE

DASHED RED LINE INDICATES POWERLINE ROUTE

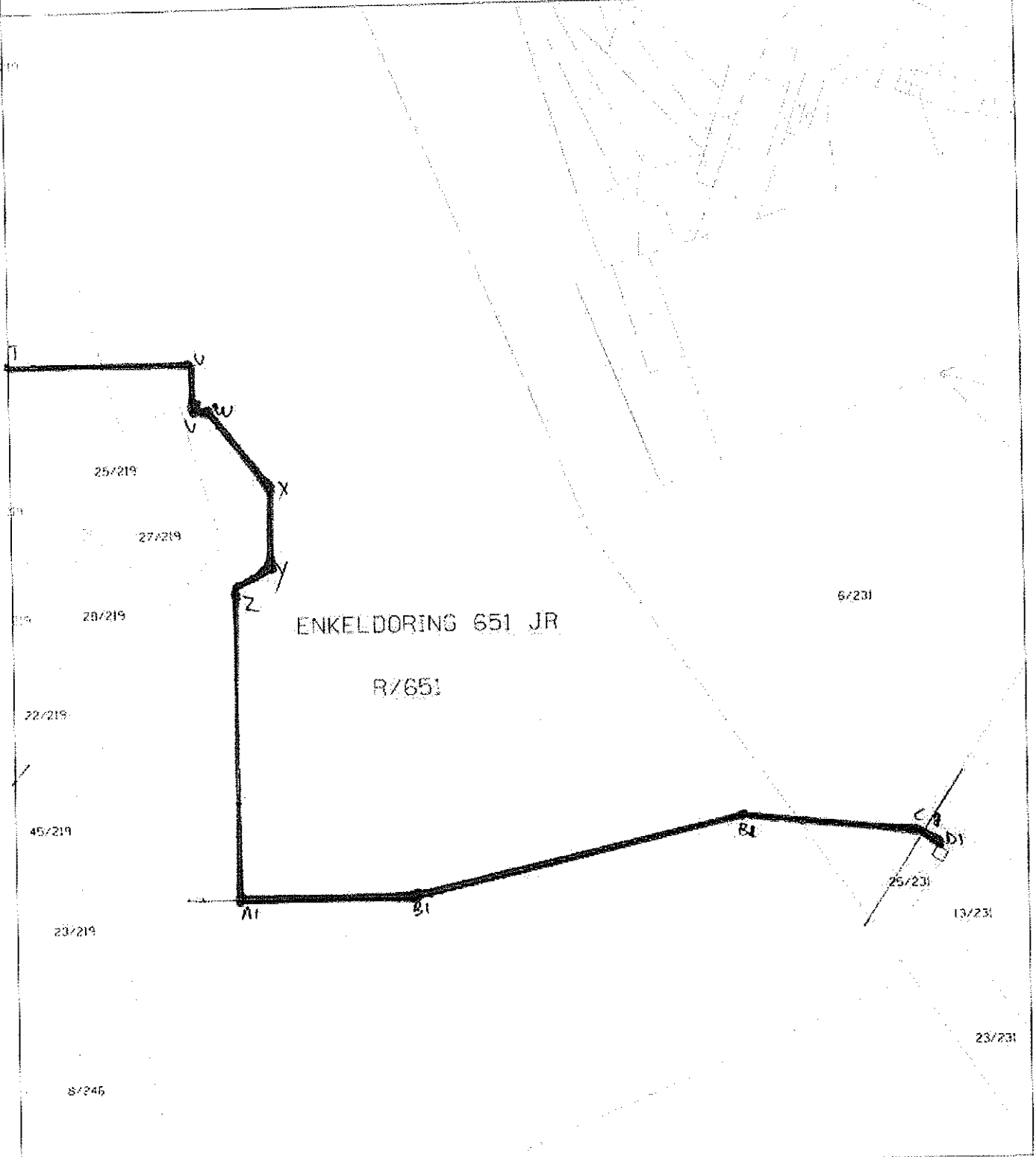

Wayleave
Northern Region

Property description:

Disclaimer:
Eskom and its employees
are not responsible for any errors
in original documents or copies
on this map.

Registered Owner: X 
Witness 1: _____
Witness 2: _____

Eskom: _____
Witness 1: _____
Witness 2: _____

Project No: _____
Date: _____
Portion of map no: _____
Scale: 1:25000

