

CONSOLIDATION DIAGRAM

Ton21/Surpac/Ton21-Consol
BUTTON & O'CONNOR INC: Westville

COMPONENTS:

- 1) The figure bdEF represents Erf 6249 Tongaat, Vide Diagram S.G.No.1531/1990 and Deed of Transfer No. CCT 32028/1997
- 2) The figure aDdb represents Portion 1 of Erf 126 Tongaat, Vide Diagram S.G.No.2762/1958 and Deed of Transfer No.T7980/1962
- 3) The figure ABCa represents the Remainder of Erf 125 Tongaat, Vide Diagram Sub Vol.16 Fol.138 and Deed of Transfer No. T49599/2004

SERVITUDE NOTES:

- a) The figure Aefa represents a Road Servitude 7,62 metre wide Vide Diagram S.G.No.3991/1964 and Deed of Transfer No.
- b) The figure afgb represents a Road Servitude 7,62 metre wide Vide Diagram S.G.No.3992/1964 and Deed of Transfer No.
- c) The figure jnqm represents a Sewer and Drain Servitude 2,00 metre wide Vide diagram S.G.No.2609/1976 and Deed of Transfer No.

S.G. No.

528/2015

Approved



for
**SURVEYOR-
GENERAL**

2015 -06- 10

Act 6 of 2008
COM0001/06/2013N

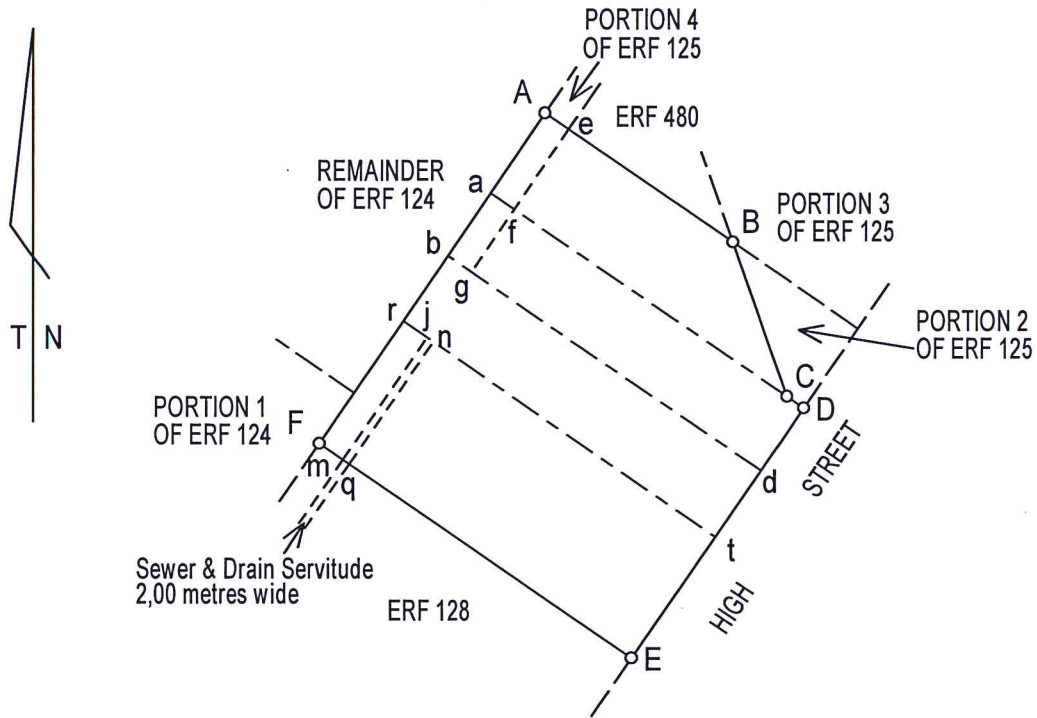

Scale 1:2000

The figure
represents

A B C D E F
1,0079 hectares

of land being

ERF 13872 TONGAAT

(and comprises the Components 1 to 3 quoted above)

Situate in the eThekwin Municipality
Registration Division FU, Province of KwaZulu Natal

Compiled in April 2013 by me

W.I.M.TURNBULL
Professional Land Surveyor
Registration Number PLS 0875

This diagram is
annexed to
No.

Registrar of Deeds

The original diagram is
S.G. No.

Transfer

File Tongaat/140

S.R. Compiled

Comp. FU-5A-13C

**CERTIFIED A TRUE COPY
OF THE ORIGINAL**

2015 -06- 1 0



for SURVEYOR GENERAL KZN

SECTION 34(2) CERTIFICATE

I hereby certify that the conditions of approval for the subdivision or consolidation of land as contemplated in section 26(4) of the Kwazulu-Natal Planning and Development Act, 2008 (Act No.6 of 2008) have been complied with.

PI 
Head - Development Planning, Environment and
Management - Ethekwini Municipality

Date : 6/7/2015.