



Project Reference: 755.23023.00008

File Ref. 2017-02-22_Kathu cemetery revised location_IAPs&Authorities

Date: 22 February 2017

ATTENTION: INTERESTED AND AFFECTED PARTIES

Dear Sir/Madam

NOTICE OF REVISION OF THE POSITION OF THE NEW KATHU CEMETERY

In November 2016, you were notified of the proposed development of the New Kathu Cemetery, in Kathu, Northern Cape. This letter serves to notify you of the revised location of the New Kathu Cemetery.

Following commencement of the public participation process in November 2016, Eskom indicated that they were planning to apply for the construction of a new powerline which would intersect with the New Kathu Cemetery. In order to accommodate the Eskom powerline, the New Kathu Cemetery was moved. The revised location of the New Kathu Cemetery is near the original location, still located on the remaining extent of the farm Lyleveld 545 [land owned by the Sishen Iron Ore Company (Pty) Ltd] and is still 5 ha in extent. A map showing the revised location of the New Kathu Cemetery is included in Appendix 1. The Basic Assessment (BA) will consider the revised location of the New Kathu Cemetery. The BA will be available for public and authority review mid-March 2017; you will be notified of the review dates once finalised.

Synergistics Environmental Services (Pty) Ltd (a SLR Group Company) has been appointed as the independent environmental practitioner responsible for undertaking the necessary environmental work and conducting the public participation process for the project. Should you have any queries please submit your comments/queries to the person listed below.

Yours faithfully

Chiara D'Egidio Kotze
ckotze@slrconsulting.com; Tel: (011) 467-0945; Fax: (011) 467-0978

APPENDIX 1: LOCALITY MAP

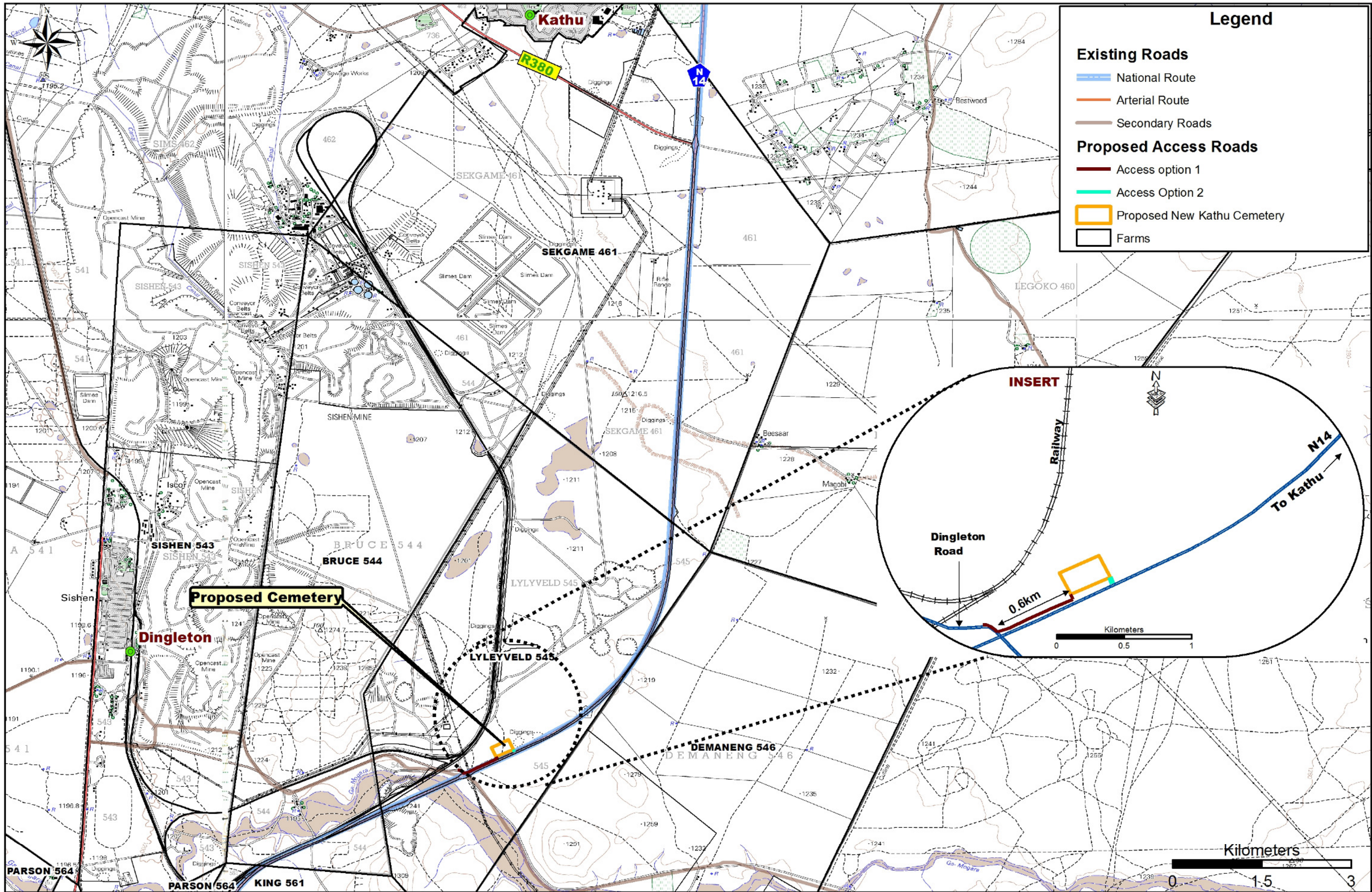

Legend

Existing Roads

- National Route (Blue line)
- Arterial Route (Orange line)
- Secondary Roads (Brown line)

Proposed Access Roads

- Access option 1 (Red line)
- Access Option 2 (Green line)

Proposed New Kathu Cemetery

- Proposed New Kathu Cemetery (Yellow outline)

Farms

- Farms (Black outline)

Locality Map for the Proposed New Kathu Cemetery

SLR 755.23023.00008

Coordinate System
DMS
Spheroid WGS84 Central Meridian LO