

DRAWING NOTES:

All existing members shown in grey. All new members in red.
 Member legend (Refer to Sheet 2)

Member ID	Description	Size
1	Code-Formed Liprod Channel	175x50x3.5
2	Code-Formed Liprod Channel	175x50x3.5
3	Code-Formed Liprod Channel	175x50x3.5
4	Angle Unequal Leg	125x75x10
5	Angle Unequal Leg	125x75x10
6	Angle Equal Leg	75x75x10
7	Code-Formed Liprod Channel	175x50x3.5
8	Formed Flange Channel	P220x75

 * Members shown in red are to be added and bolted to an already existing Code-Formed Liprod Channel

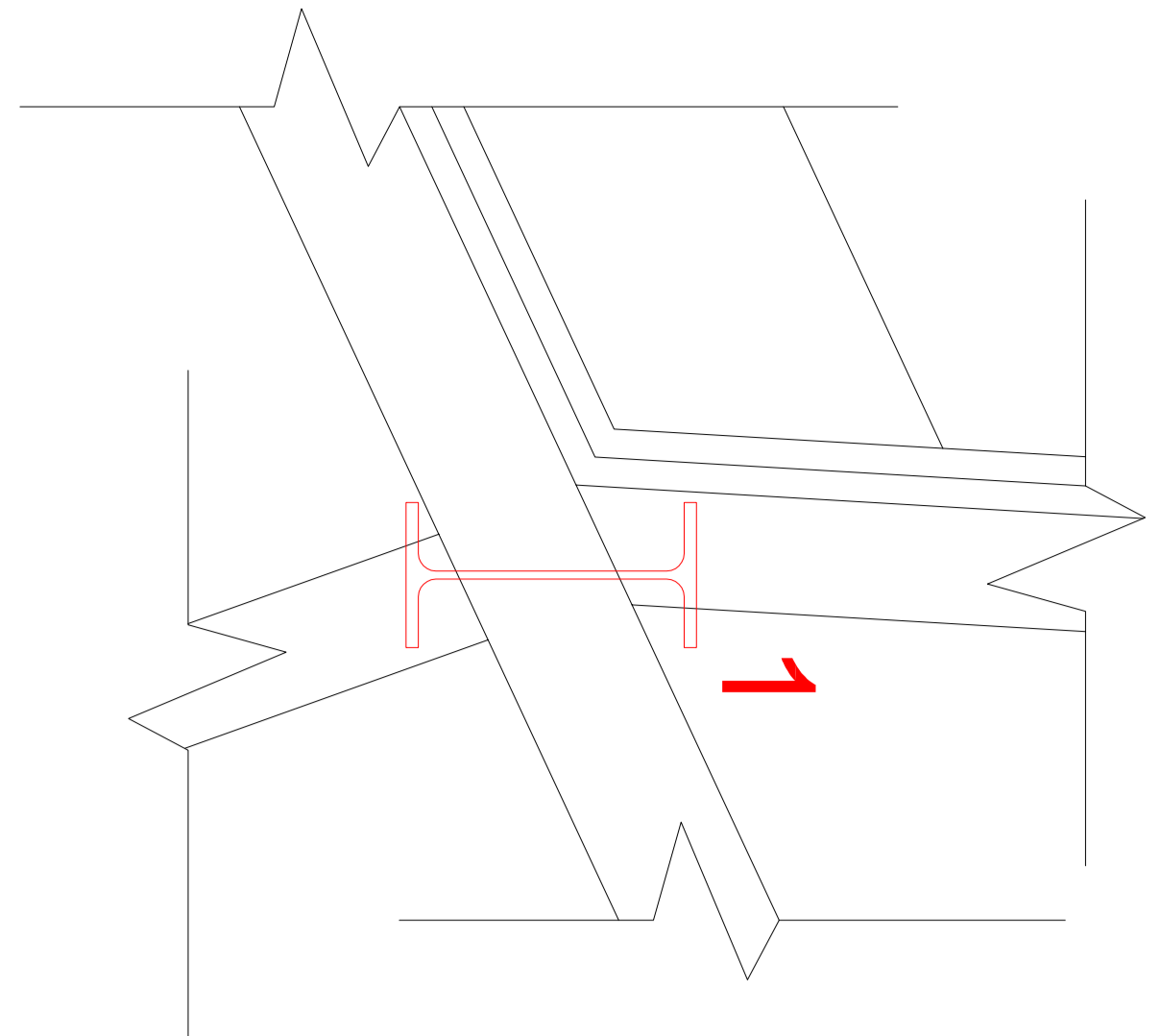

MEMBER 1 DETAIL
1:5 SCALE

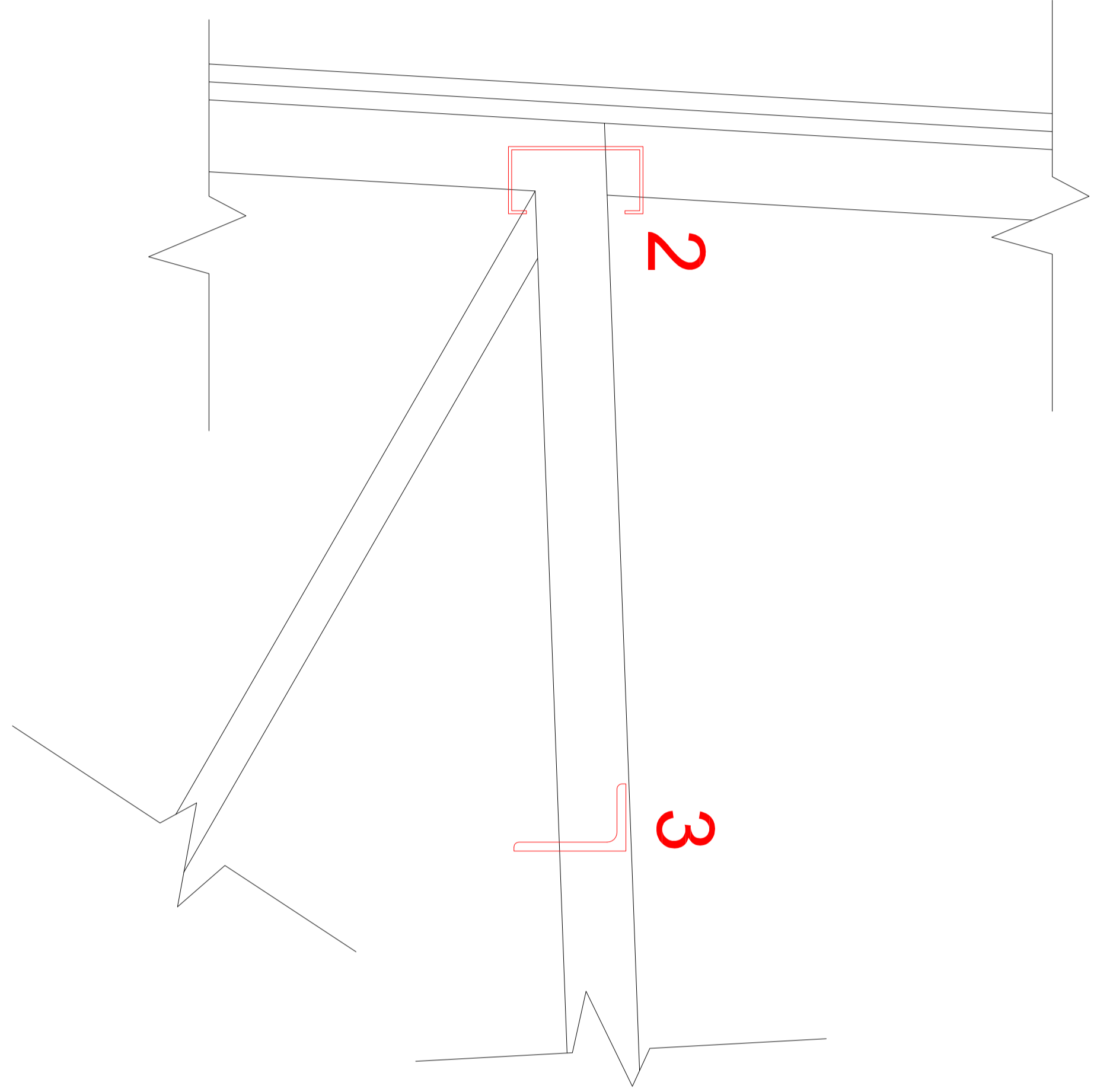

MEMBER 2 AND 3 DETAIL
1:5 SCALE

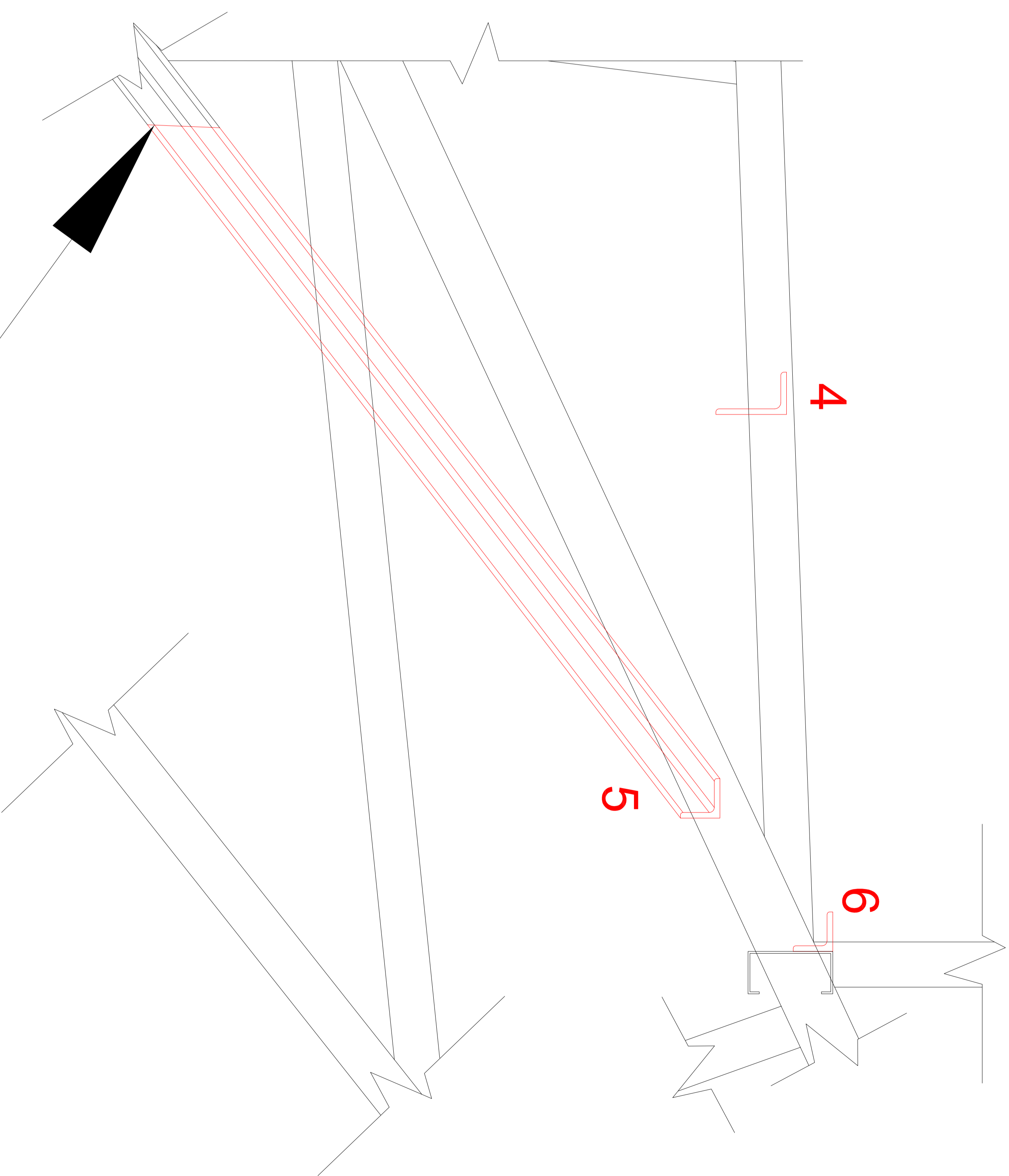

MEMBER 4, 5 AND 6 DETAIL
1:5 SCALE

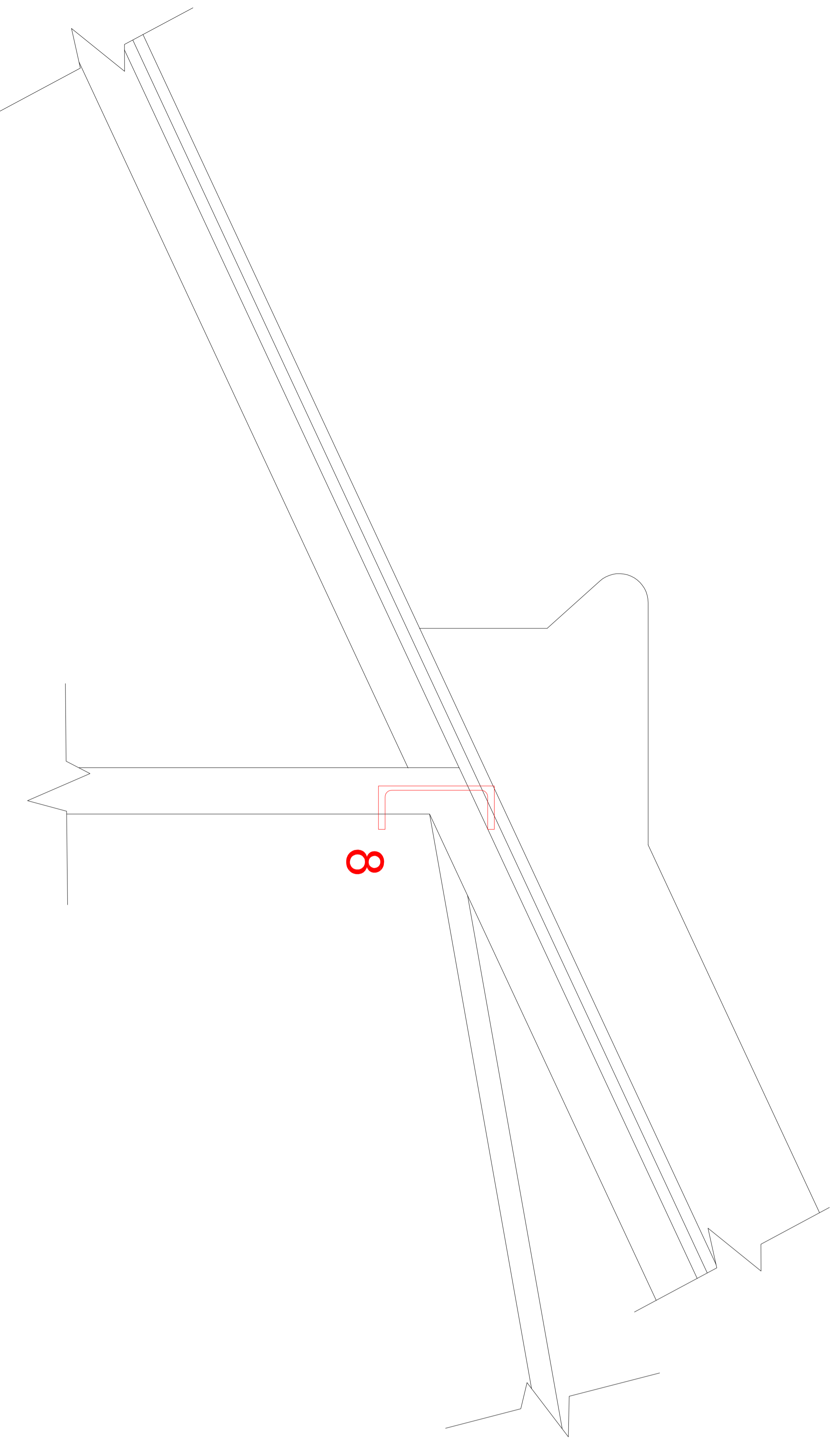

MEMBER 8 DETAIL
1:5 SCALE

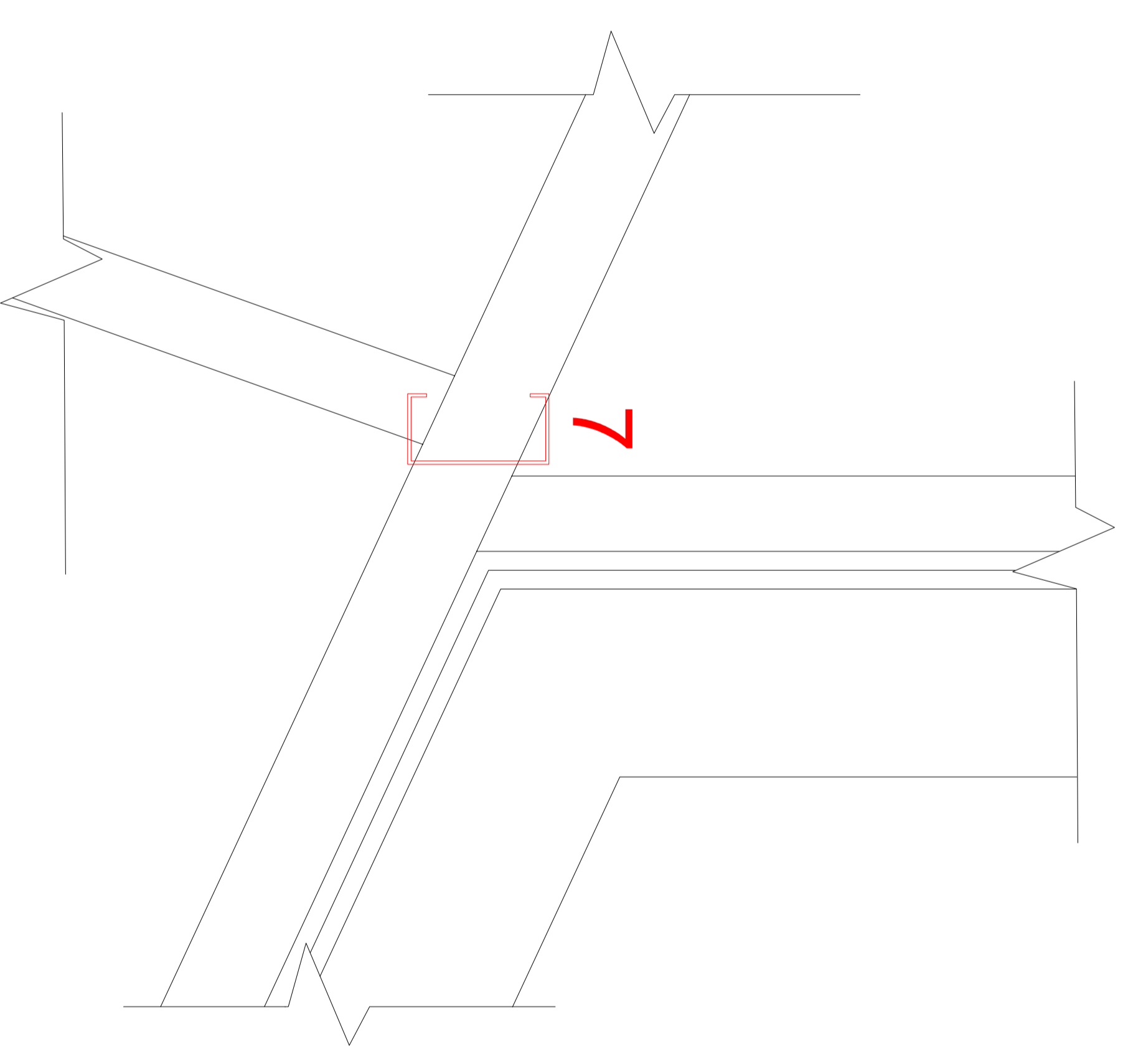

MEMBER 7 DETAIL
1:5 SCALE

ISSUE /REVISION

NO.	DATE	DESCRIPTION	ISS BY
2	13/09/2022	SHEET 2 ADDED FOR DETAILING	TL
1	30/06/2022	ISSUED FOR AS BUILT REQUIREMENTS	TL

DRAWING STATUS

AS BUILT



ARCHITECT
OCEAN ARCHITECTS

CLIENT
FREMAR PROJECTS

PROJECT
DURBAN WORKSHOP MALL

DRAWING CHECKS
 DESIGNED BY: _____
 DRAWN BY: _____
 CHECKED BY: _____
 APPROVED BY: _____
 MNO: _____

DRAWING TITLE
DURBAN WORKSHOP MALL - ROOF AS-BUILT LAYOUT - SHEET 2

SCALE 1:100
2017_0192_001-S-4000-2 **02**