

GENERAL NOTE
 The Contractor is to verify all dimensions & levels on site before commencing work or producing shop drawings. Any discrepancies are to be reported to the Architect immediately.
 COPYRIGHT NOTE
 This drawing is subject to copyright and may not be reproduced, in whole or part, or in any manner whatsoever without written permission from the architect.

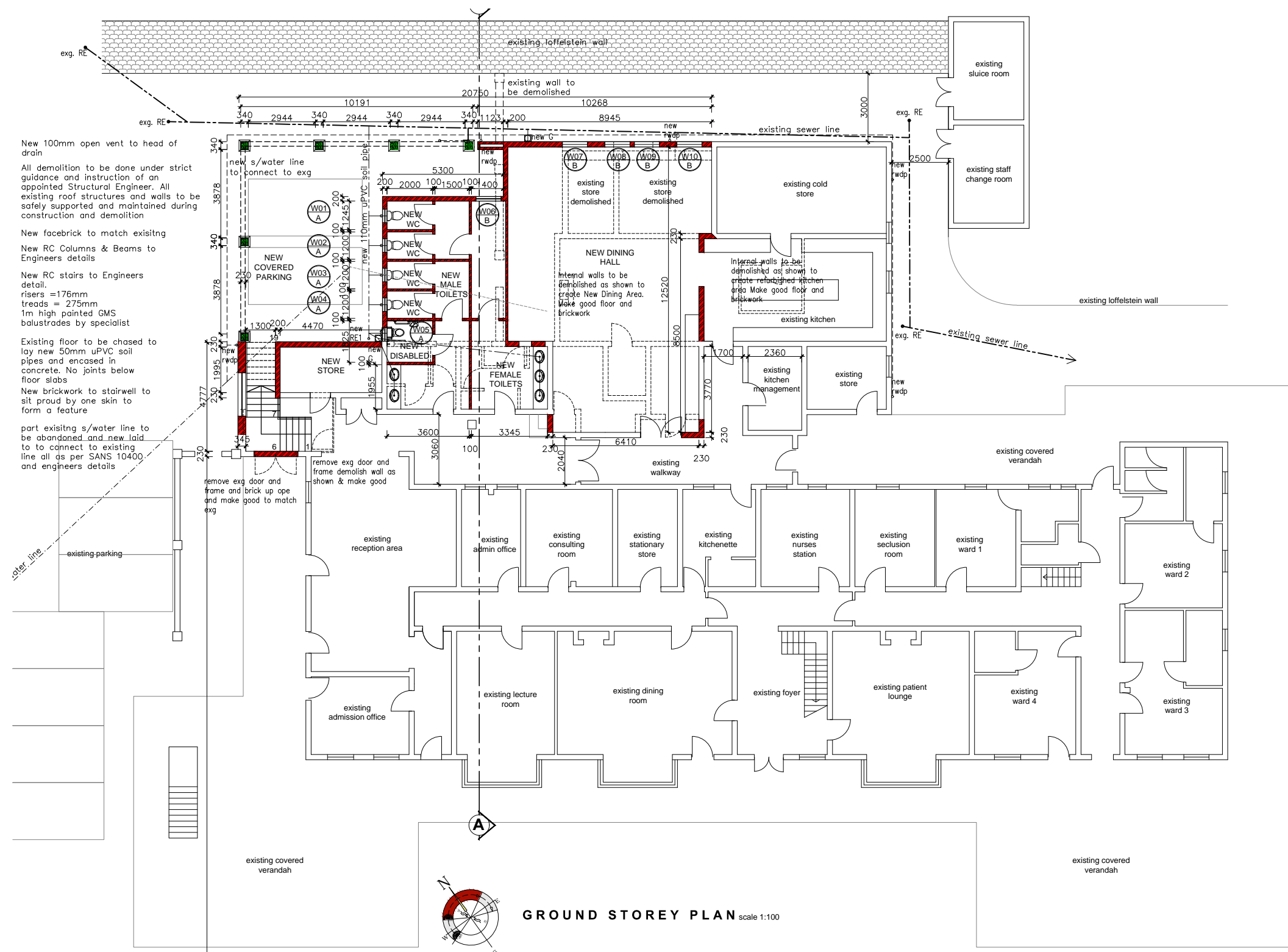

New 100mm open vent to head of drain
 All demolition to be done under strict guidance and instruction of an appointed Structural Engineer. All existing roof structures and walls to be safely supported and maintained during construction and demolition
 New facebrick to match existing
 New RC Columns & Beams to Engineers details
 New RC stairs to Engineers detail.
 risers = 176mm
 treads = 275mm
 1m high painted GMS balustrades by specialist
 Existing floor to be chased to lay new 50mm uPVC soil pipes and encased in concrete. No joints below floor slabs
 New brickwork to stairwell to sit proud by one skin to form a feature
 part existing s/water line to be abandoned and new laid to connect to existing line all as per SANS 10400 and engineers details

GROUND STOREY PLAN scale 1:100

OWNER/CLIENT:
 Dr. SSK Naidoo
 OWNER/CLIENT SIGNATURE:
 Pr.Arch.T SIGNATURE:
 SACAP Practice No: PAT 20664

GIARC
 Designs (Pty) Ltd
 P O Box 28390, Malvern, 4055
 Cell: +27 64 782 4179
 Email: craigmoodley@gmail.com

Project Description
 PROPOSED ADDITIONS & ALTERATIONS TO EXISTING PSYCHIATRIC HOSPITAL
 FOR: HEALING HILLS HOSPITAL (PTY)LTD
 AT : 2 INCHANGA DRIVE
 ON : PORTION 264(OF 6) OF THE FARM DRIFT NUMBER 906, REGISTRATION DIVISION FT. KZN

Date: JAN2018 REV: A Scale: AS_SHOWN
 Drawn: CRAIG_D_MOODLEY

Drawing Description
 GROUND STOREY FLOOR PLAN