

- LEGEND**
- EXISTING STEEL BEAM
 - STRUCTURAL FRAMING
 - WALLS BELOW
 - EXISTING TIMBER

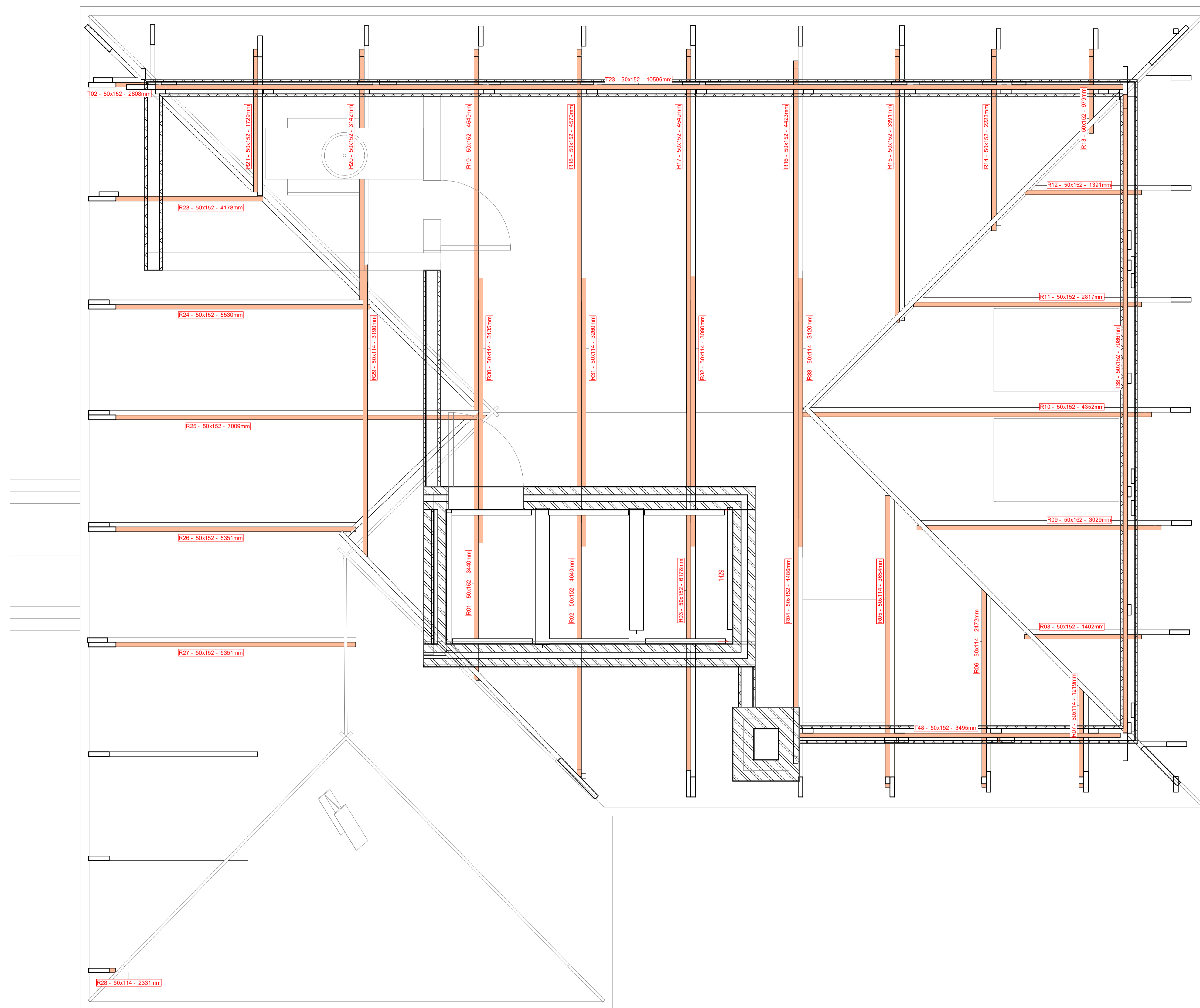

2 LOFT LEVEL - CEILING - RAFTER LAYOUT
 01.12.000 1:25

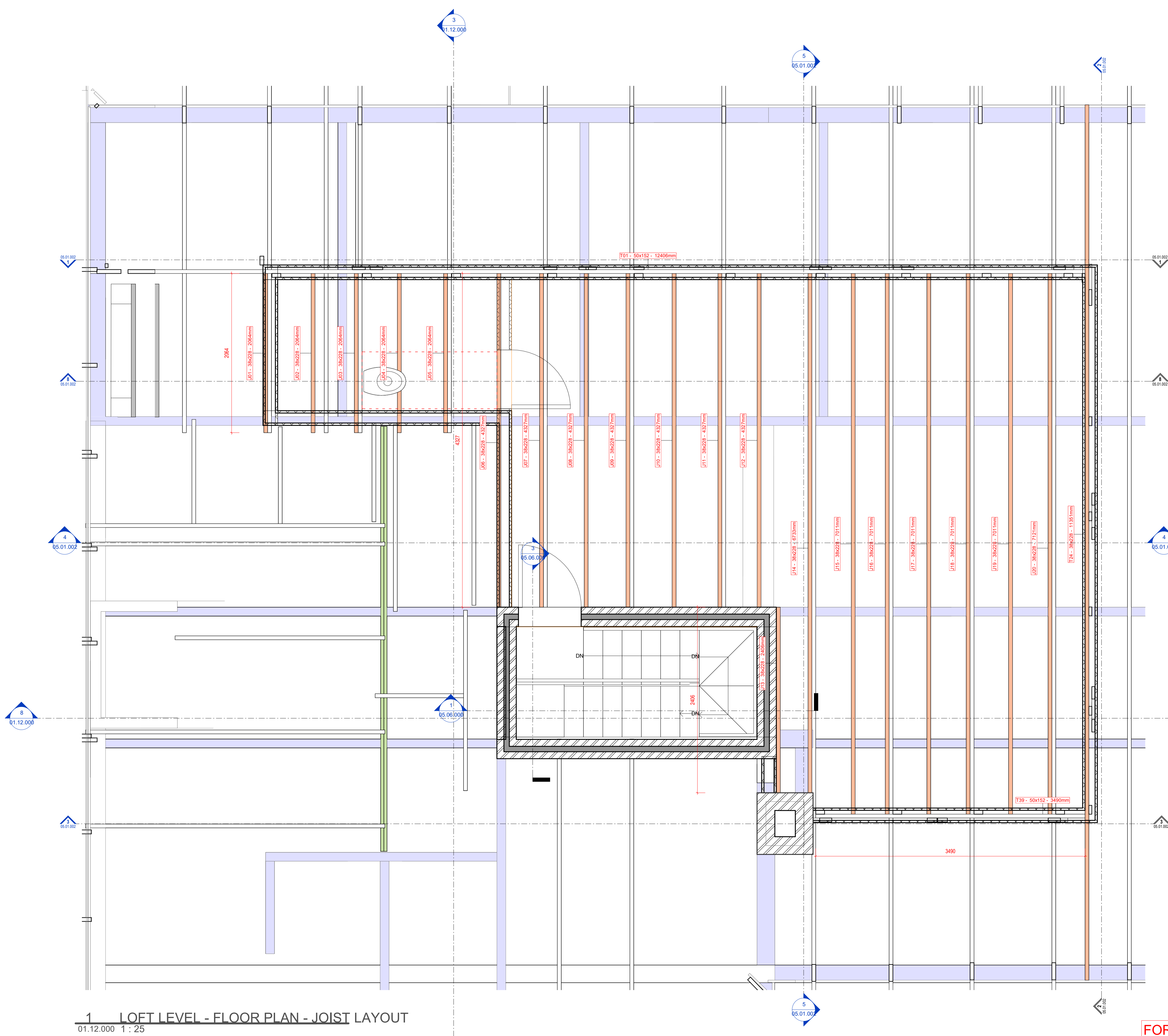

1 LOFT LEVEL - FLOOR PLAN - JOIST LAYOUT
 01.12.000 1:25



EMPLOYER *Ruben Reddy* RUBEN REDDY

ARCHITECT *Ayla Harvey* AYLA HARVEY

FOR AND ON BEHALF OF:
 RUBEN REDDY ARCHITECTS
 (PTY) LTD

ARCH SACAP No. PrArch43540973

ENGINEER *Andrew Scott* Andrew Scott
 Pr Eng 20170220

ruben reddy architects
 Oudon, Lathamweg (Coastal) (Opposite) (Opposite)
**ALTERATIONS TO INNES ROAD
 HOUSE & ADDITION OF STUDY
 LOFT FOR 15 YEAR OLD TRIPLETS**
 260 INNES ROAD, MORNINGSIDE,
 BEREA, DURBAN
 PORTION 1 OF ERF 669

STRUCTURAL TIMBER - 01

TIME STAMP: 18/01/2023 16:11:44 As Indicated @ A0

INFORMATION	LA SUBMISSION	TENDER	CONSTRUCTION
PROJECT NUMBER	ZONE	STAGE	ISSUE DATE
2022_G412	B00	LA	2023-01-18

DRAWING NUMBER 2022_G412-RRR-B00-XX-DR-A-05.01.001 A

FOR APPROVAL

