

Note :-
This drawing to be read in conjunction
with Structural Eng's Drawings

1. All dimensions & levels to be checked on site prior to commencement any work
2. Any discrepancies to be reported to Architect prior to manufacture or commencement of work
3. This drawing to be read in conjunction with all relevant Architectural information
4. The Architect will not be responsible for work manufactured without measurements being taken on site.
5. Windows + Doors to be manufactured and installed in strict accordance to manufacturer's specification

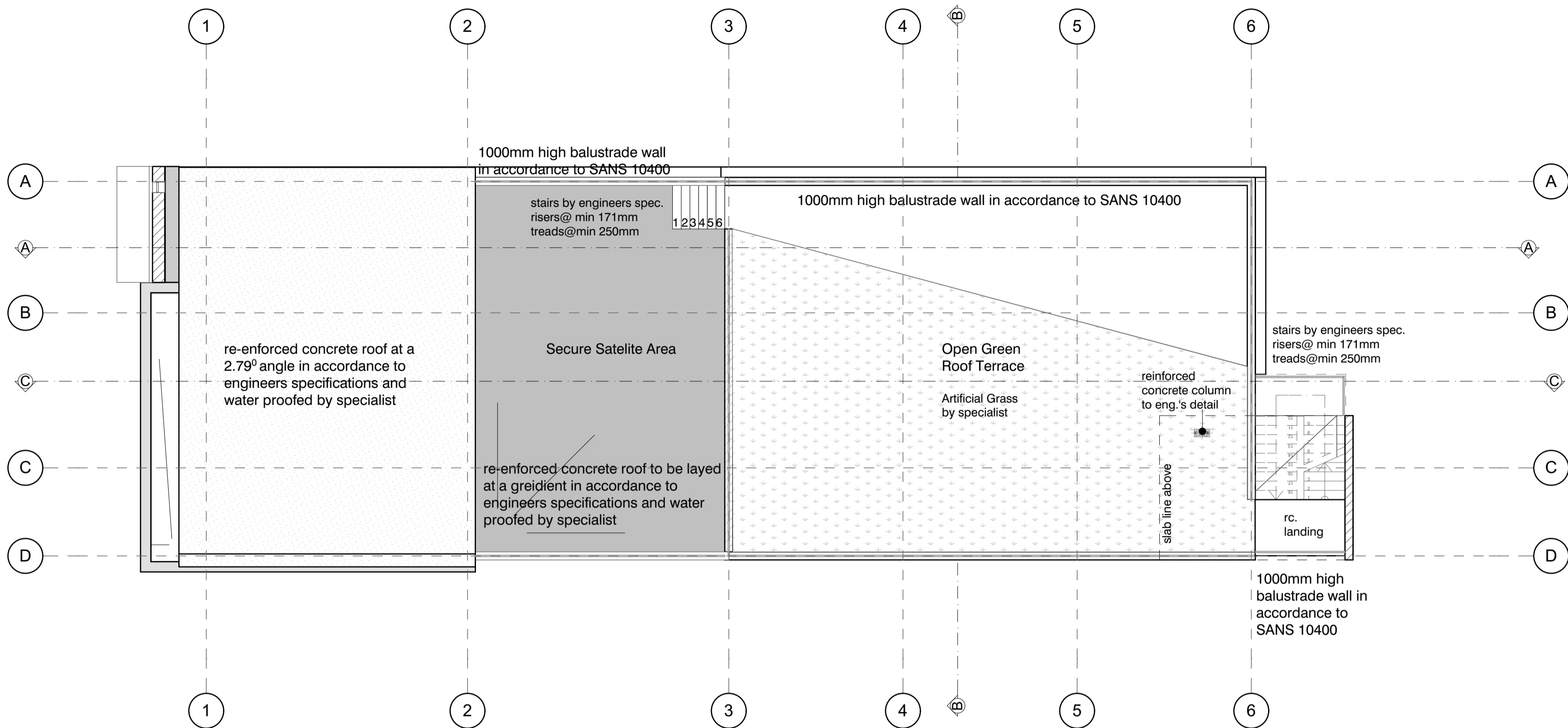

Roof Plan
1:100

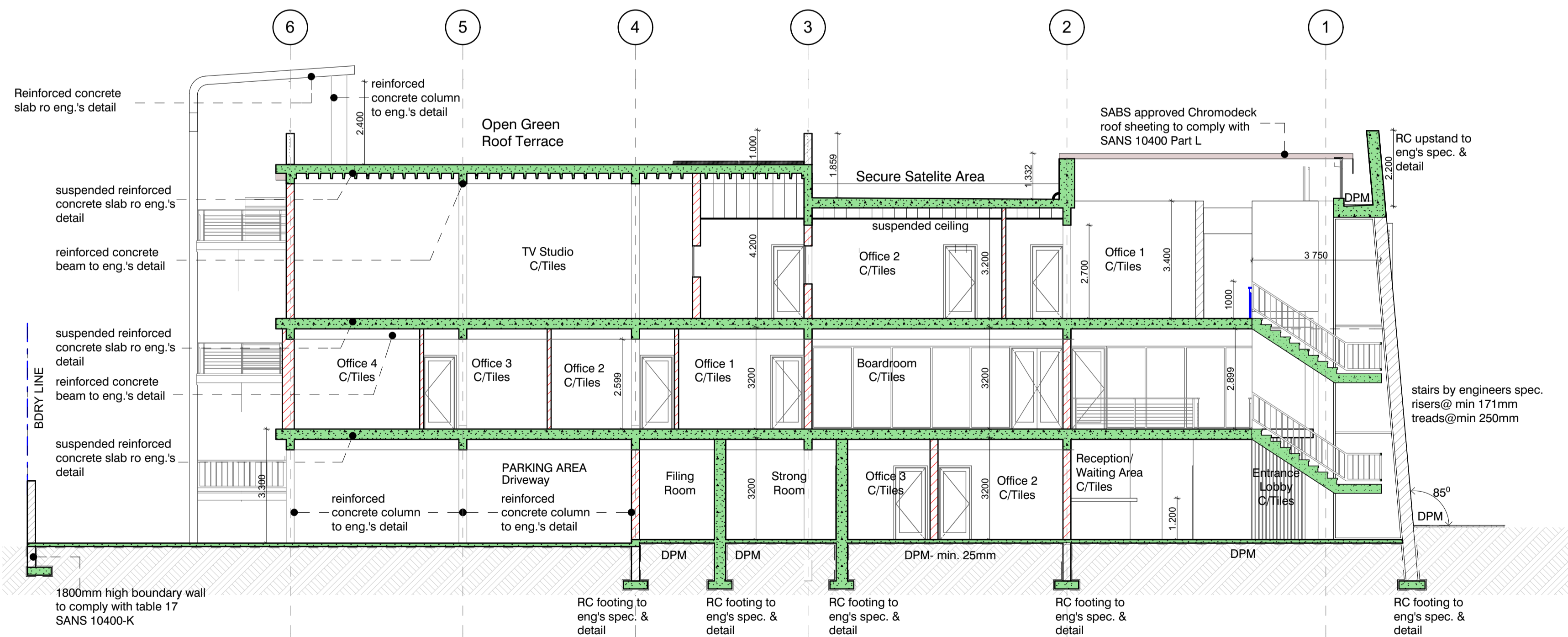

Section A-A
1:100

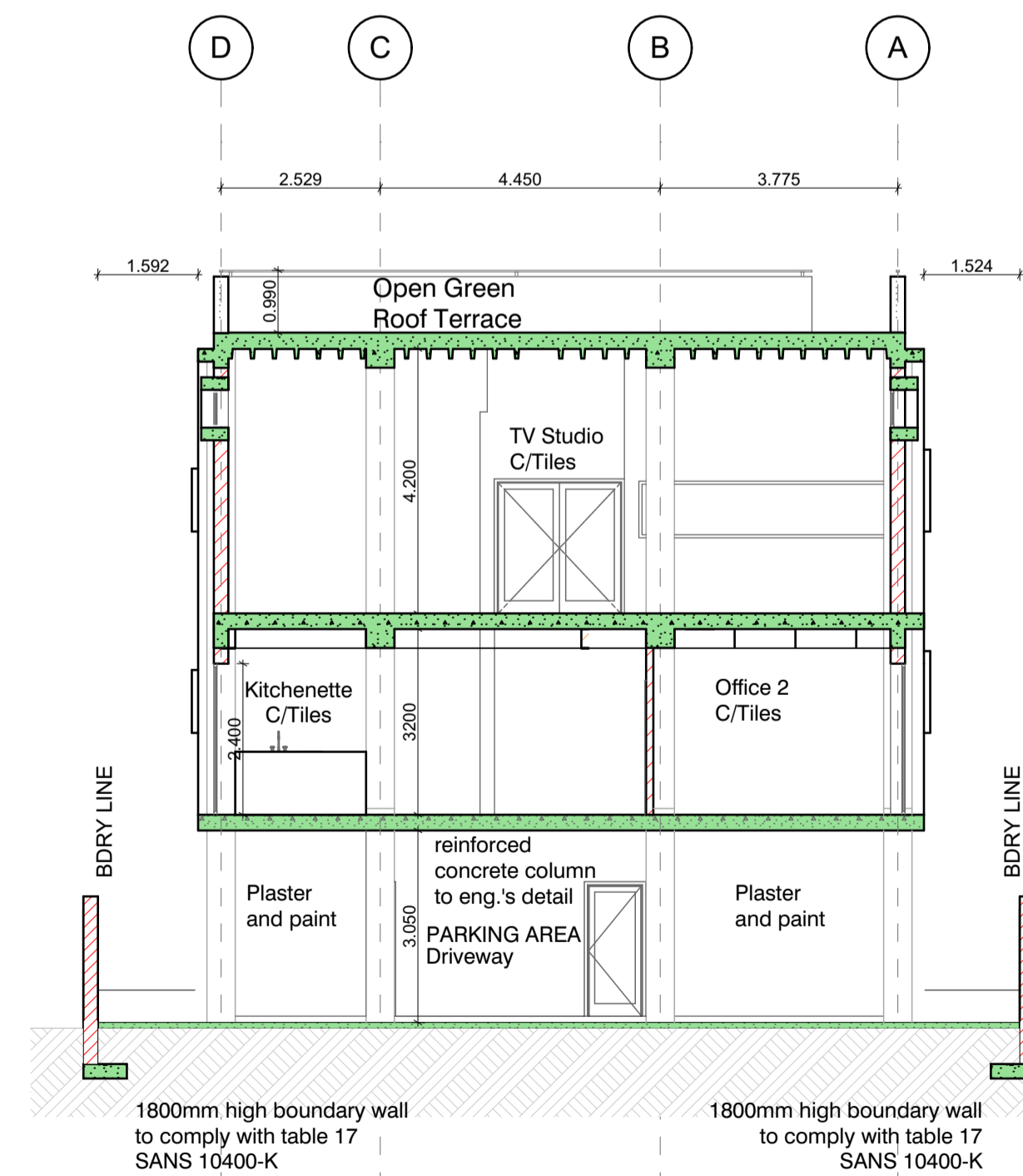

Section B-B
1:100

NEIGHBOURS CONSENT FOR ENCROACHMENT
NAME: PORTION
ADDRESS:
I.D. NO. :
TEL / CELL NO. :
SIGNATURE:

CLIENT INFO:
NAME:
ADDRESS:
TEL / CELL NO. :
E-MAIL ADDRESS:
SIGNATURE : DATE:



MyArchitecture
architects ■ project managers ■ interiors

Our Studios/Address
Suite-06
92 Crompton Street
Pinetown
3600
info.myarchitect.co.za

Contact Details
t: 031 702 5367
f: 086 212 1578
c: 083 737 1639

contemporary & sustainable green architecture

Author's Signature: Date:
Mr. S'boniso Sibisi (Pr. Snr. Arch T 20718) SACAP

PROJECT TITLE:
Proposed Additions and Alterations to Existing Dwelling

SITE DESCRIPTION:
Lot 7 of 91
on 78 Alan Paton Road,
Glenwood

DATE : March 2017
DRAWN BY : K. S

SCALE : As-Shown

DRAWING DISCUSSION:
SECTION A-A; SECTION B-B; ROOF PLAN

JOB NO. 214	DRAWING No. 200	Rev. No. 00
ISSUED FOR APPROVAL		
ISSUED FOR INFORMATION		
ISSUED FOR SUBMISSION		X
ISSUED FOR TENDER		
ISSUED FOR CONSTRUCTION		