

CONSOLIDATION DIAGRAM

PROJECT:
 PROPOSED CONSOLIDATION OF
 PORTION 1 OF ERF R/2224, PORTION
 1 OF ERF R/2958 AND REMAINDER OF
 ERF 8343, HOUT BAY

LOCALITY MAP NOT TO SCALE

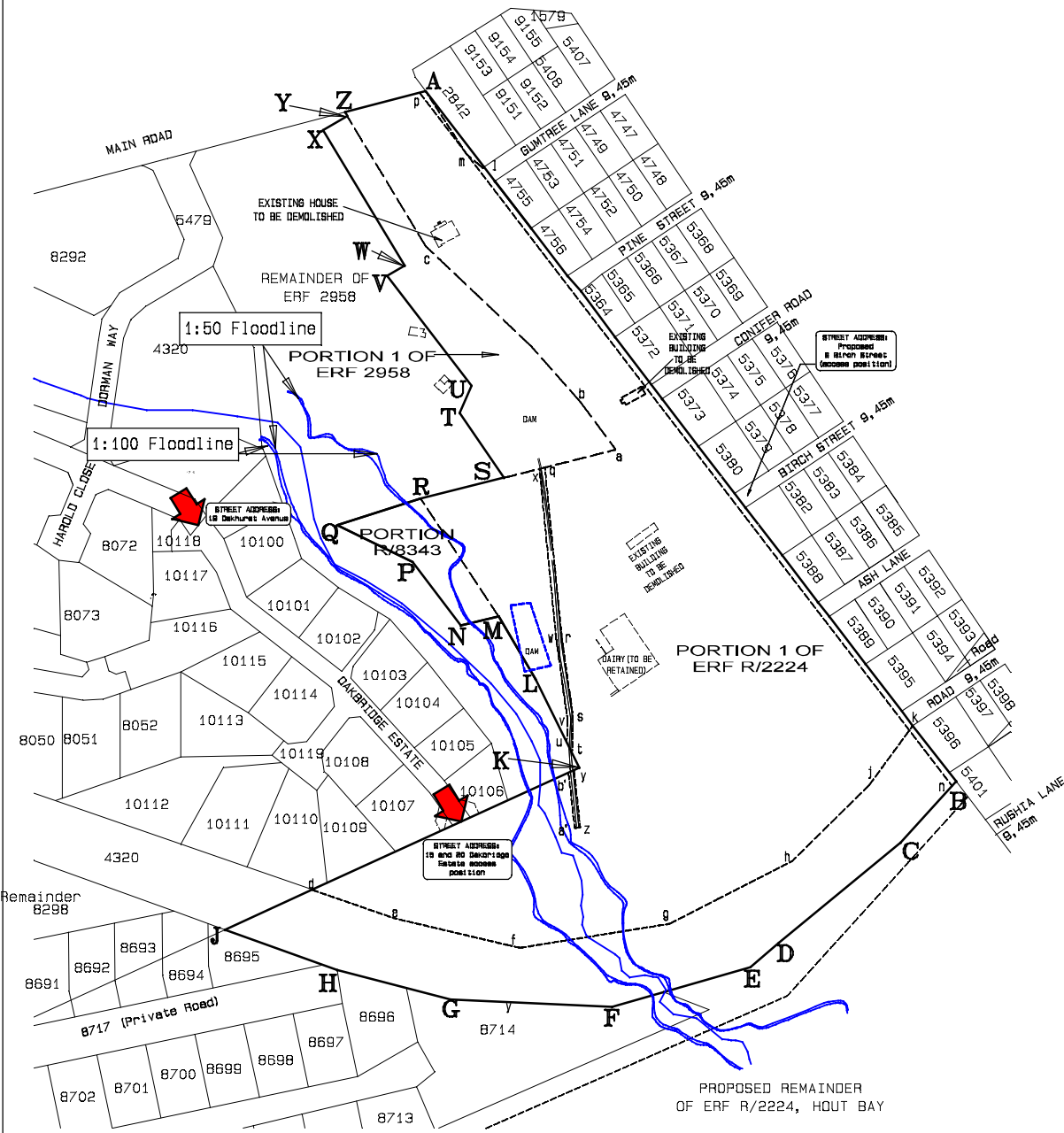
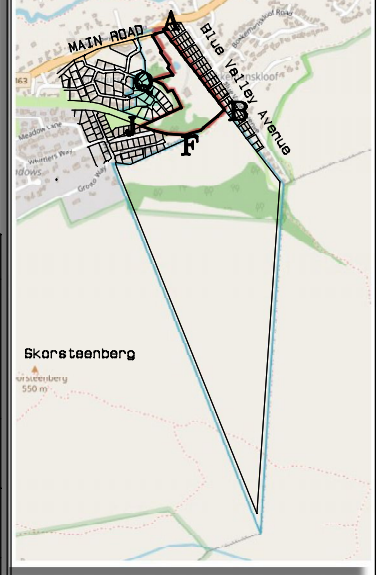

LAND-USE TABLE

KEY ERF NUMBERS	AREA		EXISTING ZONING
	(ha)	(%)	
PORTION 1 OF ERF R/2224	6,7835	88,48	SINGLE RESIDENTIAL ZONING 1: CONVENTIONAL HOUSING (SR1); AND TRANSPORT ZONING 2: PUBLIC ROAD AND PUBLIC PARKING (TR2)
PORTION 1 OF ERF R/2958	0,6833	8,81	SINGLE RESIDENTIAL ZONING 1: CONVENTIONAL HOUSING (SR1)
REMAINDER OF PORTION 8343	0,1980	2,58	SINGLE RESIDENTIAL ZONING 1: CONVENTIONAL HOUSING (SR1)
TOTAL: CONSOLIDATED ERF	7,6658	100,00	

SERVITUDE NOTES

- FIGURE A1a DENOTES A RIGHT-OF-WAY SERVITUDE OVER PORTION 1 OF ERF R/2224 IN FAVOUR OF ERF 2842, HOUT BAY VIDE 55 5488/1988.
- FIGURE A8a DENOTES A 3 METRE WIDE SERVITUDE OVER PORTION 1 OF ERF R/2224 TO PROTECT THE EXISTING BULK SEWER LINE IN FAVOUR OF THE MUNICIPALITY.
- FIGURES qabvwx and yz a' b' DENOTE PART OF THE EXISTING 3 METRE WIDE SERVITUDE OVER PORTION 1 OF ERF R/2224 IN FAVOUR OF PORTION 1 OF ERF R/2958 FOR THE RIGHT TO CONVEY WATER PUMPED FROM THE BOKKEMANSKLOOF RIVER TO LAPSE THROUGH MEMBER.

FLOOD-LINE

I HEREBY CERTIFY THAT THE PROPOSED CONSOLIDATION IS AFFECTED BY THE 1:100 YEAR FLOOD-LINES AS SHOWN ON THIS PLAN IN TERMS OF THE PROVISIONS OF SECTION 144 OF THE NATIONAL WATER ACT, 1998 (ACT 36 OF 1998)

J.P. van Wyk
 PR. ENG. DATE 2022-10-16
 G.A. M. GILL DATE 2022-09-26
 PR. ENG. NAME AND SURNAME REG. No.

GENERAL NOTES

- Approximate areas and measurements shown only, subject to final survey
- Consolidated property boundary: ABCDEFGHJKLMPQRSTUWXYZ
- Portion 1 of Erf R/2224 is denoted by figure ABCDEFGHJKLMPQRSTUWXYZ (approximately 6,7835ha).
- Remainder of Erf 8343 is denoted by figure MNPQR (approximately 0,1980ha).
- Portion 1 of Erf R/2958 is denoted by figure abcxykvwuts (approximately 0,6833ha).
- Figure BCDEFGHJdefghjk denotes future High Level Road alignment.
- Title deed numbers: T27941/1982 for Erf R/2224, T283/2002 for Erf R/8343 and T45059/1982 for Erf R/2958.

CONTROLLING AUTHORITY:	APPLICANT:
CITY OF CAPE TOWN METROPOLITAN MUNICIPALITY PRIVATE BAG X 5 PLUMSTEAD 7801	MESDAMES B I SCHER AND M DERMAN C/O SECOND FLOOR TANNERY PARK 21 BELMONT ROAD RONDEBOSCH CAPE TOWN

J PAUL VAN WYK

URBAN ECONOMISTS
& PLANNERS CC

POSBUS 11522 HATFIELD 0028	P.O. BOX 11522 HATFIELD 0028
TEL : (012) 996-0097 FAXS : (086) 684-1263 SEL : (082) 893-7370 ePOs: airfax@mweb.co.za	TEL : (012) 996-0097 FAX : (086) 684-1263 CELL : (082) 893-7370 eMAIL: airfax@mweb.co.za

DRAWN	UOSM	UOSM	FIGURE.
SCALE	DATE	CAD NO.	6
1:2500 (A3)	2022-10-12	CONSOL-06a	
DESIGN	CONTOUR INT.	PLAN NUMBER	
J. P. van Wyk 1 metre		R/2224+1/2958+R/8343+HAY-CONSOL/02	

