

- GENERAL NOTES:**
1. All work to comply with SANS 10400 and local Municipal By-Laws.
 2. Boundary bearings to be exposed and checked prior to the commencement of work.
 3. Contractors, suppliers and sub-contractors to be held on site before work is put to hand.
 4. Drawings are not to be scaled. Figure dimensions to be used only. All dimensions are, unless otherwise specified, in millimeters.
 5. Drawings are to be read in conjunction with Structural, Civil drawings.
 6. All glazing to comply with NBR SANS 10400-N:2010 3RD Edition.
 7. All safety glazing in accordance with SANS 10400-N.
 8. All balustrading to be minimum one meter high and to comply with the requirements of SANS 10400 - D.
 9. All stairs to comply with SANS 10400-CM.
 10. Soil Piling in to be in accordance with SABS 0124.

STRUCTURAL NOTES:

1. The following to Professional Structural Engineer's Detail:
 - Soil Excavation and Filling, Basins, Basins and Columns.
 - Foundations, Retaining Walls, Slabs, Beams and Columns.
2. Note: Foundations are not to encroach: Setbacks and or Boundaries.
3. pc Joints to all non beam openings.
4. off slitter conc. to be cleaned and rubbed down

all structural work, rc slabs, columns, foundations, pc joints over openings & walls to engineer's design & details foundations & slabs on fill to engineer's details

HEALTH NOTES:
Artificial Lighting & Ventilation to comply with SANS 10400-O
where not ventilated directly to open air, to be mechanically vented with fresh air at a minimum rate of 25 l/s per person, with a velocity not exceeding 0.5 m/s or less than 0.2 m/s artificial lighting to be minimum 350 lux.

SETTING OUT:
THE BUILDING IS TO BE SET OUT BY PROFESSIONAL LAND SURVEYOR USING ELECTRONIC MEDIA

DRAINAGE:
Where drains pass under buildings they are to be protected to the satisfaction of the senior drainage inspector.
existing municipal drain & connection levels to be confirmed prior to commencement of new drainage installation.
rodding eyes to all changes of direction / gradient
inspection eyes at all junctions
all drainage to comply with sams 10400 part P
for stormwater drainage refer to engineers drawings.

- 100 PVC SEWER PIPE @ MIN 1:60 FALL
- 100 PVC STORMWATER PIPE @ MIN 1:60 FALL
- 1000 upvc ribbed pipe laid where any structure passes over sewer line being protected from any loads imposed on the drain

NOTE:
Durban ticket registered plumbing contractor is to perform plumbing installations and comply with municipally watersupply by-laws

Surround Beam Detail

- non-slip coating
- 150
- 175
- 100mm granite
- R9 @ 200 centres both ways
- min. lap 400
- all work and dimensions to be checked on site before work commences
- beam leakage protection to be fitted to identify supply
- electrical equipment to be properly housed
- pump or fan to be properly drained
- inspection of steel and excavation
- 100mm granite monolithically and pneumatically placed to form
- mix 1 part cement to 4 parts washed ungerm sand
- pool not to be filled before safety fence has been inspected
- pool to be constructed in accordance with sabs 0209-1996
- slip line from house foundation to bottom of pool to be min. 45
- pressure tank (BPT)

Pool Section

scale 1:100

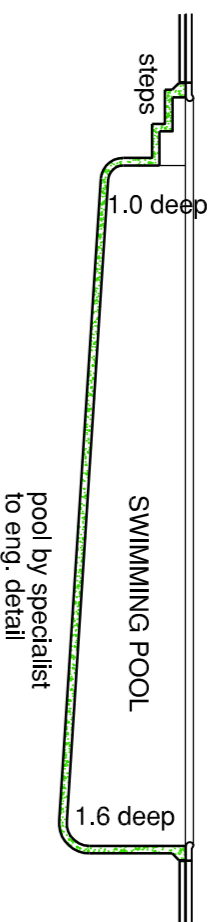

Pool Plan

scale 1:100

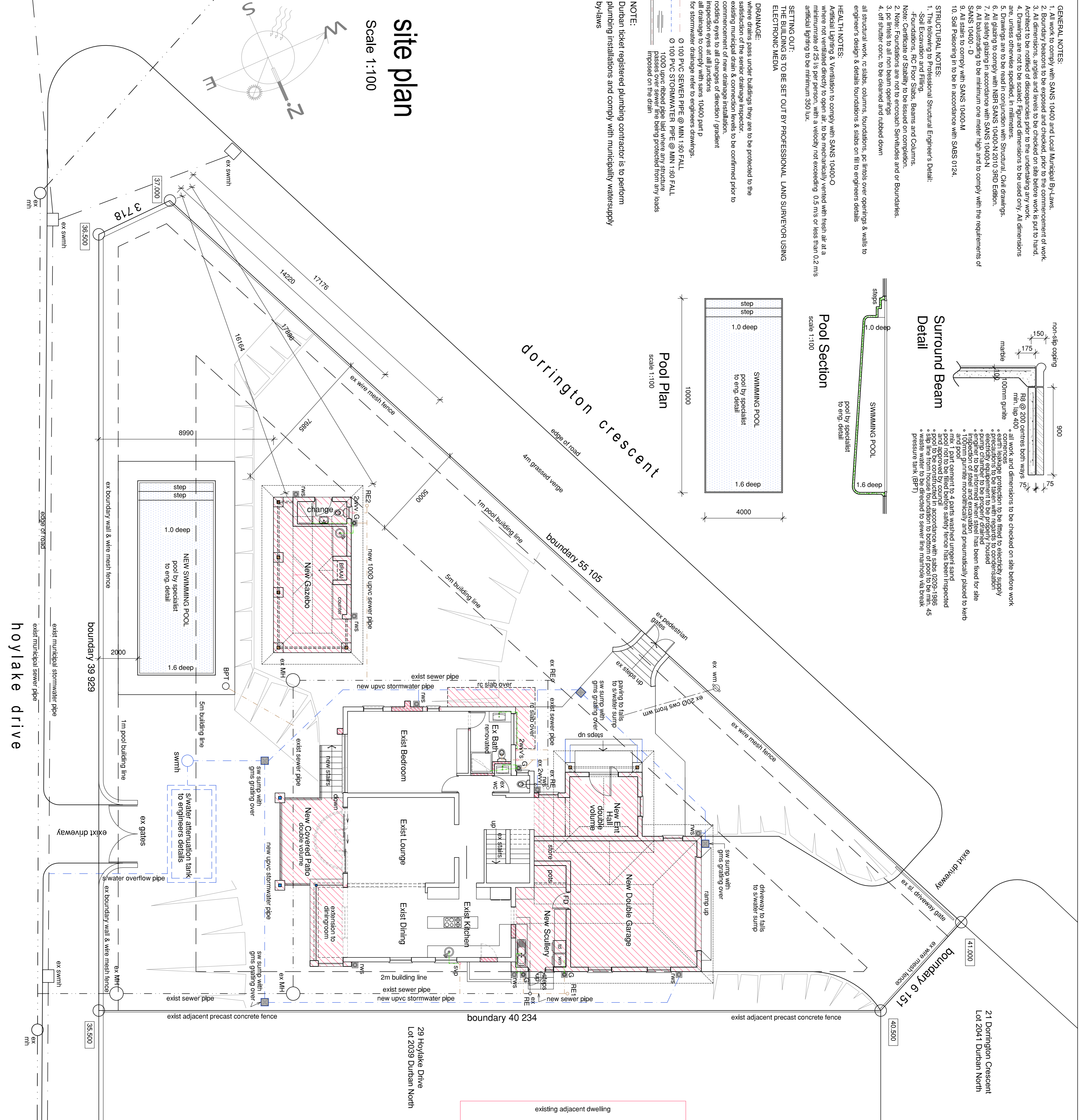
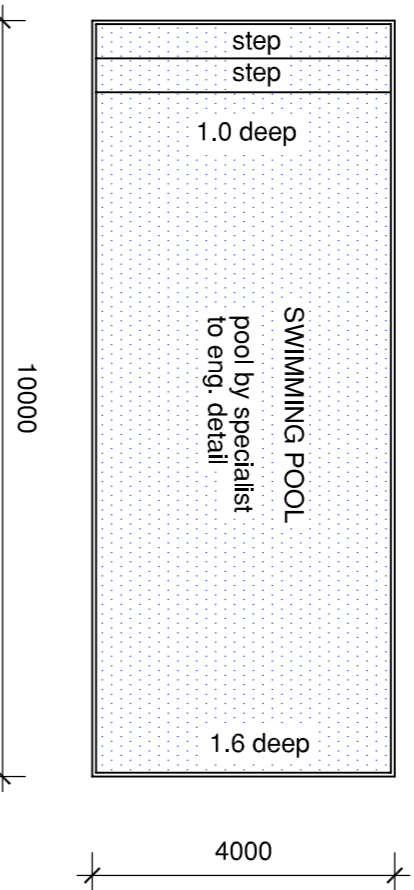

21 Dorrington Crescent
Lot 2041 Durban North

Door Schedule: Aluminium	3400	2400	2400

Powder coated aluminium sliding doors in 3 equal leaves Glazing: 6mm clear toughened safety glass area = 8,16 m ²	No. OFF	1
Location: Lounge		

2315	900	400	1200

Powder coated aluminium slide hung door, attached to top hung sashlights in equal panes Glazing: 6mm clear toughened safety glass area = 0,48 m ²	No. OFF	1
Location: Scullery		

1500	2400	300	2400

Stained hardwood horizontal slatted solid timber pivot entrance door	No. OFF	1
Location: Entrance Hall		

2100	900	2100	900

40mm hardwood timber solid core door (1/2 hour fire rated) with self-closing mechanism 2 coats gloss enamel paint in approved colour 2 coats gloss enamel paint in approved colour	No. OFF	1
Location: Double Garage		

2400 - first floor	900	2400	2100

handwood timber raised & beveled hollow core flush panel door	No. OFF	1
Location: All internal doors		

2400	4800	2400	4800

automated fibreglass slatted double garage door, or similar	No. OFF	1
Location: New Double Garage		

All aluminium windows & doors to be powder coated
All glazing to comply with SANS 10400-N
Where glazing exceeds 1,5sqm to be of safety glass.
Safety glass to be used within 500mm of fill.
All corner windows to be silicone butt glazed.
All windows to be silicone sealed all round.
All glazing to be clear glass unless otherwise stated.
All window sizes to be verified on site prior to fabrication.
Any discrepancies to be brought to the attention of the architect.
No. off's only a guide - contractor to ensure correct no. off
all aluminium doors & windows are to meet the performance criteria of SANS 10400 - n:2010 3rd edition
glazing to comply with nbr sams 10400 - n:2010 3rd edition

Occupancy : H4

CLIENT / OWNER DETAILS:
L. Pillay & S. Soobrathi

CLIENT'S OWNERS SIGNATURE:

PROJECT TITLE:
Proposed Additions & Alterations to Existing Dwelling, Gazebo & Swimming Pool on Lot 2038 Durban North at 23 Dorrington Crescent

ISSUING TITLE:
Submission Drawing

SCALE:
1:100 (A1)

PROJECT NO.: 23.010.04 **ISSUED DATE:** 18-05-2023

CONSULTANT:

HKA
HARON KADUR AFONICOM

studio : 81 ra dalshan street
5th floor 105/07/08
Durban
Tel : 031 4093249
email : haronk@hka.com
www : www.hka.com

PROJECT NO.: 23.010.04 **ISSUED DATE:** 18-05-2023