

ALL GLAZING AND SHOPFRONTS ARE TO COMPLY WITH SABS 0400, NBR's AND AAAMSA STANDARDS AND REGULATIONS. ALL SPECIFICATIONS TO BE CHECKED, VARIFIED BY SPECIALIST IN STRICT ACCORDANCE WITH ABOVE.

REF: W01 FRAME: Aluminium sliding window with fixed side panels by spec. GLASS: 9.5mm Solarvue low 'e' Safety laminate glass as per AAAMSA reg. FINISH: Powder coated - Colour White QUANTITY: 1x off	REF: W02 FRAME: Aluminium sliding door with fixed side panels by spec. GLASS: 9.5mm Solarvue low 'e' Safety laminate glass as per AAAMSA reg. FINISH: Powder coated - Colour White QUANTITY: 1x off	REF: W03 FRAME: Aluminium window with top-hung windows by spec. GLASS: 9.5mm Solarvue low 'e' Safety laminate glass as per AAAMSA reg. FINISH: Powder coated - Colour White QUANTITY: 1x off	REF: W04 FRAME: Aluminium top-hung window by spec. GLASS: 9.5mm Solarvue low 'e' Safety laminate glass as per AAAMSA reg. FINISH: Powder coated - Colour White QUANTITY: 1x off	REF: W05 FRAME: Aluminium sliding door GLASS: 9.5mm Solarvue low 'e' Safety lam. glass as per AAAMSA FINISH: Powder coated - Colour White QUANTITY: 1x off	REF: W06 FRAME: Aluminium top-hung bay-window by spec. GLASS: 9.5mm Solarvue low 'e' Safety lam. glass as per AAAMSA FINISH: Powder coated - Colour White QUANTITY: 2x off
REF: W07 FRAME: Aluminium top-hung window by spec. GLASS: 9.5mm Solarvue low 'e' Safety lam. glass as per AAAMSA FINISH: Powder coated - Colour White QUANTITY: 1x off	REF: W08 FRAME: Aluminium top-hung window by spec. GLASS: 9.5mm Solarvue low 'e' Safety lam. glass as per AAAMSA FINISH: Powder coated - Colour White QUANTITY: 8x off	REF: W09 FRAME: Aluminium top-hung window by spec. GLASS: 9.5mm Solarvue low 'e' Safety lam. glass as per AAAMSA FINISH: Powder coated - Colour White QUANTITY: 1x off	REF: W10 FRAME: Aluminium top-hung window by spec. GLASS: 9.5mm Solarvue low 'e' Safety lam. glass as per AAAMSA FINISH: Powder coated - Colour White QUANTITY: 3x off	REF: W11 FRAME: Aluminium entrance door with fixed side panels by spec. GLASS: 9.5mm Solarvue low 'e' Safety lam. glass as per AAAMSA FINISH: Powder coated - Colour White QUANTITY: 1x off	REF: W12 FRAME: Aluminium top-hung window by spec. GLASS: 9.5mm Solarvue low 'e' Safety lam. glass as per AAAMSA FINISH: Powder coated - Colour White QUANTITY: 4x off
REF: W13 FRAME: Aluminium top-hung window by spec. GLASS: 9.5mm Solarvue low 'e' Safety lam. glass as per AAAMSA FINISH: Powder coated - Colour White QUANTITY: 1x off	REF: W14 FRAME: Aluminium top-hung window by spec. GLASS: 9.5mm Solarvue low 'e' Safety lam. glass as per AAAMSA FINISH: Powder coated - Colour White QUANTITY: 1x off	REF: W15 FRAME: Aluminium top-hung window by spec. GLASS: 9.5mm Solarvue low 'e' Safety lam. glass as per AAAMSA FINISH: Powder coated - Colour White QUANTITY: 1x off	REF: W16 FRAME: Aluminium top-hung window by spec. GLASS: 9.5mm Solarvue low 'e' Safety lam. glass as per AAAMSA FINISH: Powder coated - Colour White QUANTITY: 1x off	REF: W17 FRAME: Aluminium top-hung window by spec. GLASS: 9.5mm Solarvue low 'e' Safety lam. glass as per AAAMSA FINISH: Powder coated - Colour White QUANTITY: 1x off	REF: W18 FRAME: Aluminium sliding window with fixed side panels by spec. GLASS: 9.5mm Solarvue low 'e' Safety laminate glass as per AAAMSA FINISH: Powder coated - Colour White QUANTITY: 1x off
REF: W19 FRAME: Aluminium top-hung window by spec. GLASS: 9.5mm Solarvue low 'e' Safety lam. glass as per AAAMSA FINISH: Powder coated - Colour White QUANTITY: 1x off	REF: W20 FRAME: Aluminium top-hung window by spec. GLASS: 9.5mm Solarvue low 'e' Safety lam. glass as per AAAMSA FINISH: Powder coated - Colour White QUANTITY: 1x off	REF: W21 FRAME: Aluminium top-hung window by spec. GLASS: 9.5mm Solarvue low 'e' Safety lam. glass as per AAAMSA FINISH: Powder coated - Colour White QUANTITY: 1x off	REF: W22 FRAME: Aluminium top-hung window by spec. GLASS: 9.5mm Solarvue low 'e' Safety lam. glass as per AAAMSA FINISH: Powder coated - Colour White QUANTITY: 1x off	REF: W23 FRAME: Aluminium top-hung window by spec. GLASS: 9.5mm Solarvue low 'e' Safety lam. glass as per AAAMSA FINISH: Powder coated - Colour White QUANTITY: 1x off	REF: W24 FRAME: Aluminium top-hung window by spec. GLASS: 9.5mm Solarvue low 'e' Safety lam. glass as per AAAMSA FINISH: Powder coated - Colour White QUANTITY: 1x off

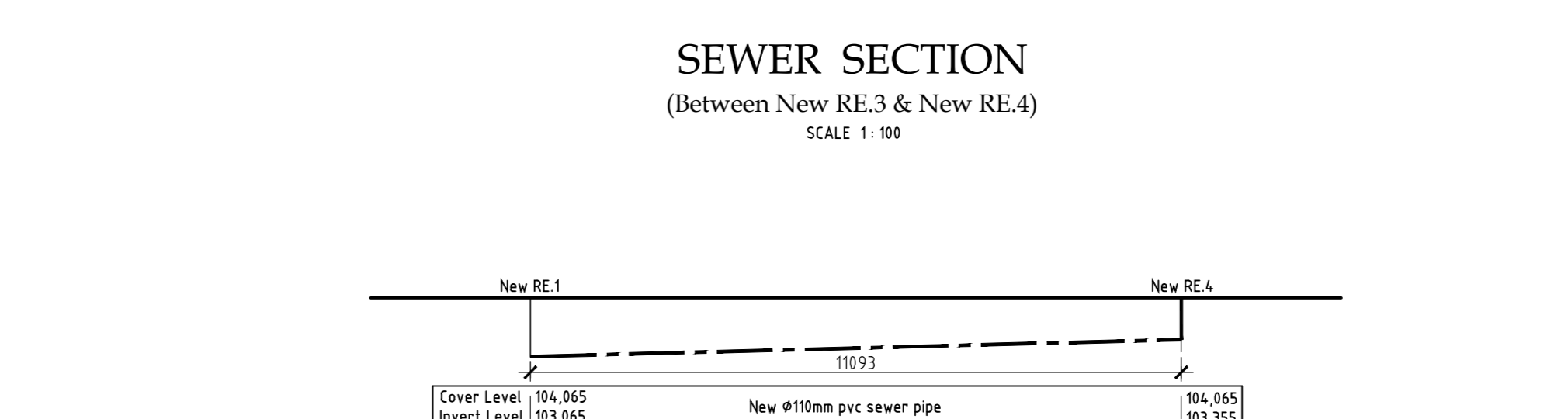
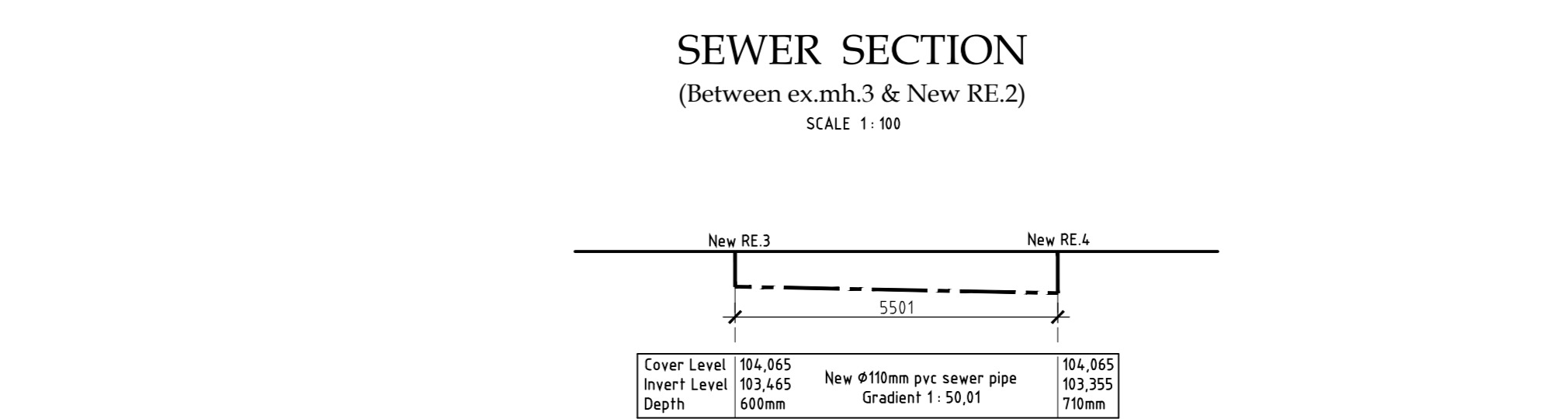
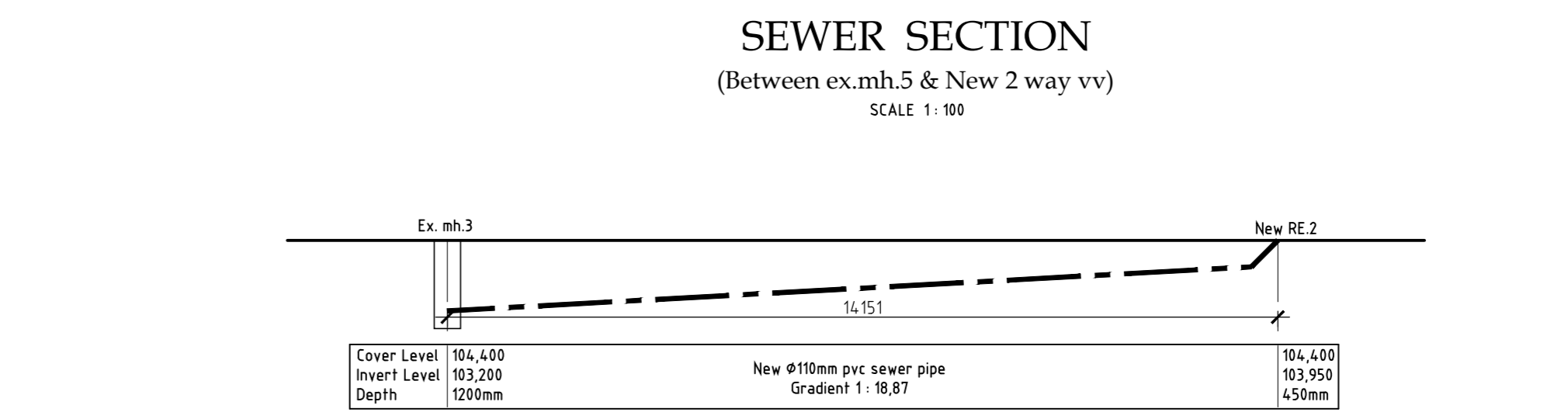
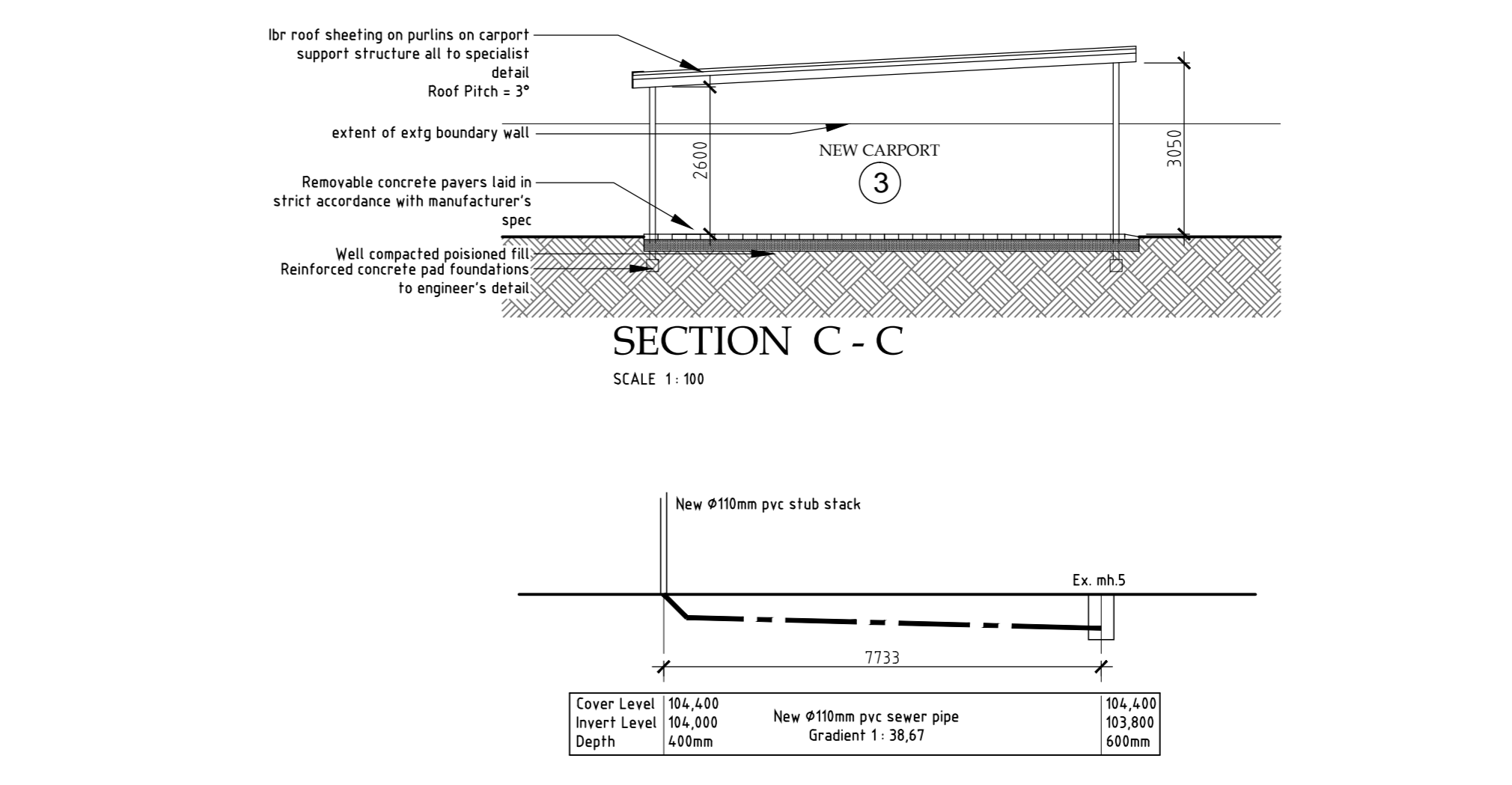
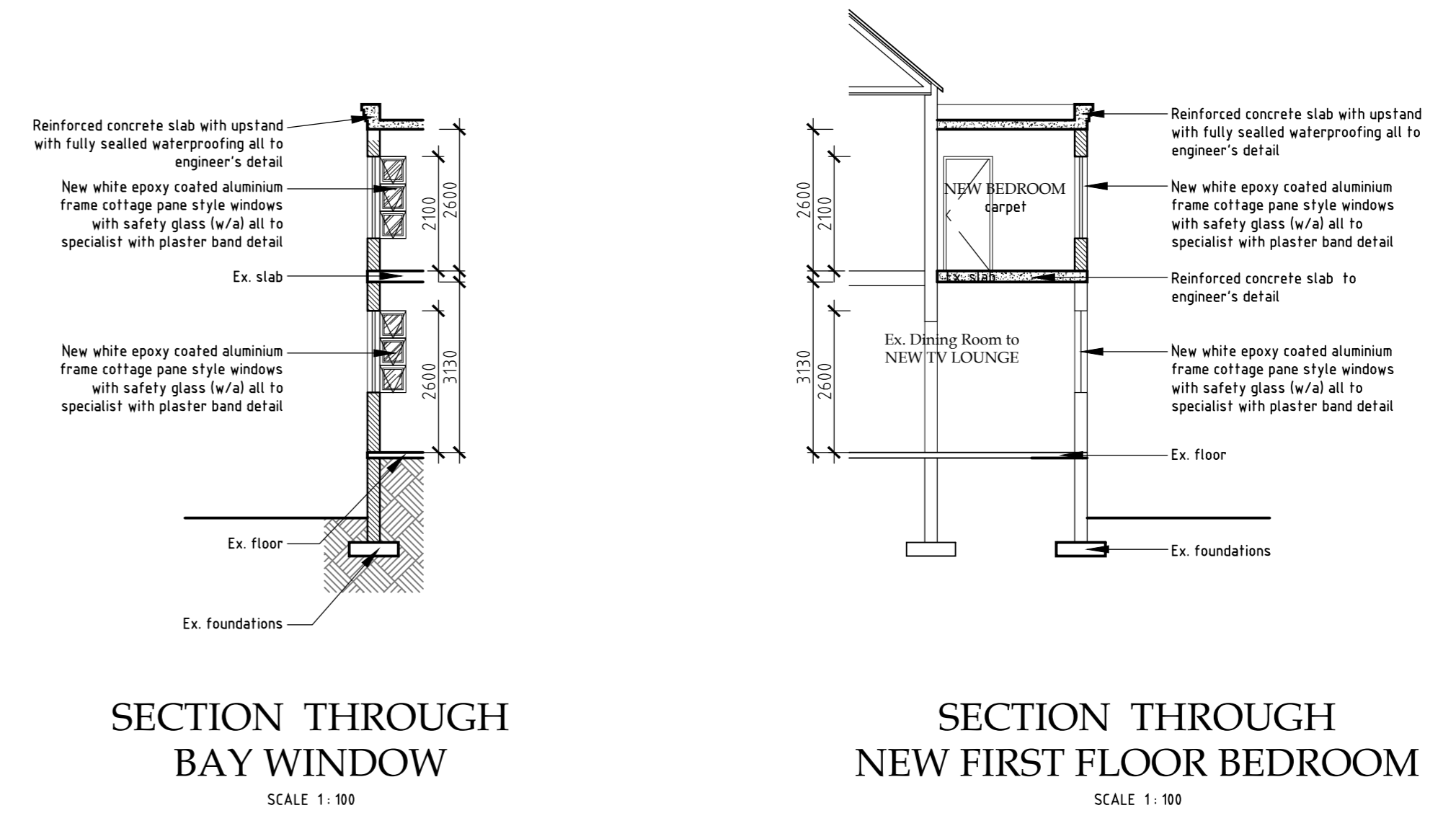

- LIST OF DEVIATIONS**
- 1 Timber deck omitted
 - 2 New screen wall added
 - 3 Carport revised & repositioned
 - 4 Section C-C revised
 - 5 Pool shape revised
 - 6 New jacuzzi added
 - 7 Existing front boundary wall to remain
 - 8 New planter created
 - 9 New boundary wall repositioned
 - 10 New garage division wall added
 - 11 New 2x single garage doors added
 - 12 Ex. wall demolished
 - 13 New covered patio added
 - 14 Driveway revised
 - 15 Windows revised
 - 16 Corner beacon level revised as-built
 - 17 New garden store added
 - 18 New Wc added
 - 19 Entertainment area revised

Subject: SUBMISSION DRAWING
Date: 01 October 2011 Scale/s: As Shown
Proposed: DEVIATIONS TO APPROVED PLAN # 198-02-11
Cadastral Description: ERF 5155 DURBAN
Street Address: 23 WOODLANDS ROAD
Owner/s: Ms. N. PANDAY

NILESH LAKRAJ
pr. enr. arch. arch.
saccap 411564
cell: 084 362 3005
nmlakraj@yahoo.com

Drawing Number: 2011/09/01 SD02 Drawn By: Nilesh Lakraj