

THE BENJAMIN

- EXTERIOR 01 _ EXISTING
- EXTERIOR 01 _ OLD REVISION
- EXTERIOR 01 _ NEW REVISION
- EXTERIOR 02 _ EXISTING
- EXTERIOR 02 _ OLD REVISION
- EXTERIOR 02 _ NEW REVISION
- EXTERIOR 03 _ EXISTING
- EXTERIOR 03 _ OLD REVISION
- EXTERIOR 03 _ NEW REVISION
- BOUNDARY WALL
- COLONNADE TYPOLOGY
- COLUMN HISTORICAL REFERENCE
- DETAIL SENSITIVITY



EXISTING

- EXTERIOR 01 _ EXISTING
- EXTERIOR 01 _ OLD REVISION
- EXTERIOR 01 _ NEW REVISION
- EXTERIOR 02 _ EXISTING
- EXTERIOR 02 _ OLD REVISION
- EXTERIOR 02 _ NEW REVISION
- EXTERIOR 03 _ EXISTING
- EXTERIOR 03 _ OLD REVISION
- EXTERIOR 03 _ NEW REVISION
- BOUNDARY WALL
- COLONNADE TYPOLOGY
- COLUMN HISTORICAL REFERENCE
- DETAIL SENSITIVITY



JUNE - 2022

- EXTERIOR 01 _ EXISTING
- EXTERIOR 01 _ OLD REVISION
- EXTERIOR 01 _ NEW REVISION
- EXTERIOR 02 _ EXISTING
- EXTERIOR 02 _ OLD REVISION
- EXTERIOR 02 _ NEW REVISION
- EXTERIOR 03 _ EXISTING
- EXTERIOR 03 _ OLD REVISION
- EXTERIOR 03 _ NEW REVISION
- BOUNDARY WALL
- COLONNADE TYPOLOGY
- COLUMN HISTORICAL REFERENCE
- DETAIL SENSITIVITY



SEP - 2022

- EXTERIOR 01 _ EXISTING
- EXTERIOR 01 _ OLD REVISION
- EXTERIOR 01 _ NEW REVISION
- EXTERIOR 02 _ EXISTING
- EXTERIOR 02 _ OLD REVISION
- EXTERIOR 02 _ NEW REVISION
- EXTERIOR 03 _ EXISTING
- EXTERIOR 03 _ OLD REVISION
- EXTERIOR 03 _ NEW REVISION
- BOUNDARY WALL
- COLONNADE TYPOLOGY
- COLUMN HISTORICAL REFERENCE
- DETAIL SENSITIVITY



JUNE - 2023

- EXTERIOR 01 _ EXISTING
- EXTERIOR 01 _ OLD REVISION
- EXTERIOR 01 _ NEW REVISION
- EXTERIOR 02 _ EXISTING
- EXTERIOR 02 _ OLD REVISION
- EXTERIOR 02 _ NEW REVISION
- EXTERIOR 03 _ EXISTING
- EXTERIOR 03 _ OLD REVISION
- EXTERIOR 03 _ NEW REVISION
- BOUNDARY WALL
- COLONNADE TYPOLOGY
- COLUMN HISTORICAL REFERENCE
- DETAIL SENSITIVITY



As per AMAFA comment, the entrance canopy between the buildings was pulled back from the front edge to define the separation between 2 adjacent buildings.

Existing boundary wall demolition on hold pending AMAFA review.

CURRENT

- EXTERIOR 01 _ EXISTING
- EXTERIOR 01 _ OLD REVISION
- EXTERIOR 01 _ NEW REVISION
- EXTERIOR 02 _ EXISTING
- EXTERIOR 02 _ OLD REVISION
- EXTERIOR 02 _ NEW REVISION
- EXTERIOR 03 _ EXISTING
- EXTERIOR 03 _ OLD REVISION
- EXTERIOR 03 _ NEW REVISION
- BOUNDARY WALL
- COLONNADE TYPOLOGY
- COLUMN HISTORICAL REFERENCE
- DETAIL SENSITIVITY



- EXTERIOR 01 _ EXISTING
- EXTERIOR 01 _ OLD REVISION
- EXTERIOR 01 _ NEW REVISION
- EXTERIOR 02 _ EXISTING
- EXTERIOR 02 _ OLD REVISION
- EXTERIOR 02 _ NEW REVISION
- EXTERIOR 03 _ EXISTING
- EXTERIOR 03 _ OLD REVISION
- EXTERIOR 03 _ NEW REVISION
- BOUNDARY WALL
- COLONNADE TYPOLOGY
- COLUMN HISTORICAL REFERENCE
- DETAIL SENSITIVITY



JUNE - 2022

- EXTERIOR 01 _ EXISTING
- EXTERIOR 01 _ OLD REVISION
- EXTERIOR 01 _ NEW REVISION
- EXTERIOR 02 _ EXISTING
- EXTERIOR 02 _ OLD REVISION
- EXTERIOR 02 _ NEW REVISION
- EXTERIOR 03 _ EXISTING
- EXTERIOR 03 _ OLD REVISION
- EXTERIOR 03 _ NEW REVISION
- BOUNDARY WALL
- COLONNADE TYPOLOGY
- COLUMN HISTORICAL REFERENCE
- DETAIL SENSITIVITY



SEP - 2022

- EXTERIOR 01 _ EXISTING
- EXTERIOR 01 _ OLD REVISION
- EXTERIOR 01 _ NEW REVISION
- EXTERIOR 02 _ EXISTING
- EXTERIOR 02 _ OLD REVISION
- EXTERIOR 02 _ NEW REVISION
- EXTERIOR 03 _ EXISTING
- EXTERIOR 03 _ OLD REVISION
- EXTERIOR 03 _ NEW REVISION
- BOUNDARY WALL
- COLONNADE TYPOLOGY
- COLUMN HISTORICAL REFERENCE
- DETAIL SENSITIVITY





As per AMAFA comment, the entrance canopy between the buildings was pulled back from the front edge to define the separation between 2 adjacent buildings.

Existing boundary wall demolition on hold pending AMAFA review.

- EXTERIOR 01 _ EXISTING
- EXTERIOR 01 _ OLD REVISION
- EXTERIOR 01 _ NEW REVISION
- EXTERIOR 02 _ EXISTING
- EXTERIOR 02 _ OLD REVISION
- EXTERIOR 02 _ NEW REVISION
- EXTERIOR 03 _ EXISTING
- EXTERIOR 03 _ OLD REVISION
- EXTERIOR 03 _ NEW REVISION
- BOUNDARY WALL
- COLONNADE TYPOLOGY
- COLUMN HISTORICAL REFERENCE
- DETAIL SENSITIVITY

- EXTERIOR 01 _ EXISTING
- EXTERIOR 01 _ OLD REVISION
- EXTERIOR 01 _ NEW REVISION
- EXTERIOR 02 _ EXISTING
- EXTERIOR 02 _ OLD REVISION
- EXTERIOR 02 _ NEW REVISION
- EXTERIOR 03 _ EXISTING
- EXTERIOR 03 _ OLD REVISION
- EXTERIOR 03 _ NEW REVISION
- BOUNDARY WALL
- COLONNADE TYPOLOGY
- COLUMN HISTORICAL REFERENCE
- DETAIL SENSITIVITY



- EXTERIOR 01 _ EXISTING
- EXTERIOR 01 _ OLD REVISION
- EXTERIOR 01 _ NEW REVISION
- EXTERIOR 02 _ EXISTING
- EXTERIOR 02 _ OLD REVISION
- EXTERIOR 02 _ NEW REVISION
- EXTERIOR 03 _ EXISTING
- EXTERIOR 03 _ OLD REVISION
- EXTERIOR 03 _ NEW REVISION
- BOUNDARY WALL
- COLONNADE TYPOLOGY
- COLUMN HISTORICAL REFERENCE
- DETAIL SENSITIVITY



SEP - 2022

- EXTERIOR 01 _ EXISTING
- EXTERIOR 01 _ OLD REVISION
- EXTERIOR 01 _ NEW REVISION
- EXTERIOR 02 _ EXISTING
- EXTERIOR 02 _ OLD REVISION
- EXTERIOR 02 _ NEW REVISION
- EXTERIOR 03 _ EXISTING
- EXTERIOR 03 _ OLD REVISION
- EXTERIOR 03 _ NEW REVISION
- BOUNDARY WALL
- COLONNADE TYPOLOGY
- COLUMN HISTORICAL REFERENCE
- DETAIL SENSITIVITY



- EXTERIOR 01 _ EXISTING
- EXTERIOR 01 _ OLD REVISION
- EXTERIOR 01 _ NEW REVISION
- EXTERIOR 02 _ EXISTING
- EXTERIOR 02 _ OLD REVISION
- EXTERIOR 02 _ NEW REVISION
- EXTERIOR 03 _ EXISTING
- EXTERIOR 03 _ OLD REVISION
- EXTERIOR 03 _ NEW REVISION
- BOUNDARY WALL
- COLONNADE TYPOLOGY
- COLUMN HISTORICAL REFERENCE
- DETAIL SENSITIVITY



PREFERRED DWS OPTION

As per AMAFA comment, the entrance canopy between the buildings was pulled back from the front edge to define the separation between 2 adjacent buildings.

- EXTERIOR 01 _ EXISTING
- EXTERIOR 01 _ OLD REVISION
- EXTERIOR 01 _ NEW REVISION
- EXTERIOR 02 _ EXISTING
- EXTERIOR 02 _ OLD REVISION
- EXTERIOR 02 _ NEW REVISION
- EXTERIOR 03 _ EXISTING
- EXTERIOR 03 _ OLD REVISION
- EXTERIOR 03 _ NEW REVISION
- BOUNDARY WALL
- COLONNADE TYPOLOGY
- COLUMN HISTORICAL REFERENCE
- DETAIL SENSITIVITY





THE BENJAMIN

- outdoor seating on the edge of the street.
- covered verandah opening up on the street edge.
- colonnade on as part of the street edge.
- building connected to street edge through verandah

- EXTERIOR 01 _ EXISTING
- EXTERIOR 01 _ OLD REVISION
- EXTERIOR 01 _ NEW REVISION
- EXTERIOR 02 _ EXISTING
- EXTERIOR 02 _ OLD REVISION
- EXTERIOR 02 _ NEW REVISION
- EXTERIOR 03 _ EXISTING
- EXTERIOR 03 _ OLD REVISION
- EXTERIOR 03 _ NEW REVISION
- BOUNDARY WALL
- COLONNADE TYPOLOGY
- COLUMN HISTORICAL REFERENCE
- DETAIL SENSITIVITY



HISTORICAL COMMERCIAL BUILDING ACROSS THE STREET

- outdoor seating on the edge of the street.
- covered verandah opening up on the street edge.
- colonnade on as part of the street edge.
- building connected to street edge through verandah

- EXTERIOR 01 _ EXISTING
- EXTERIOR 01 _ OLD REVISION
- EXTERIOR 01 _ NEW REVISION
- EXTERIOR 02 _ EXISTING
- EXTERIOR 02 _ OLD REVISION
- EXTERIOR 02 _ NEW REVISION
- EXTERIOR 03 _ EXISTING
- EXTERIOR 03 _ OLD REVISION
- EXTERIOR 03 _ NEW REVISION
- BOUNDARY WALL
- COLONNADE TYPOLOGY
- COLUMN HISTORICAL REFERENCE
- DETAIL SENSITIVITY

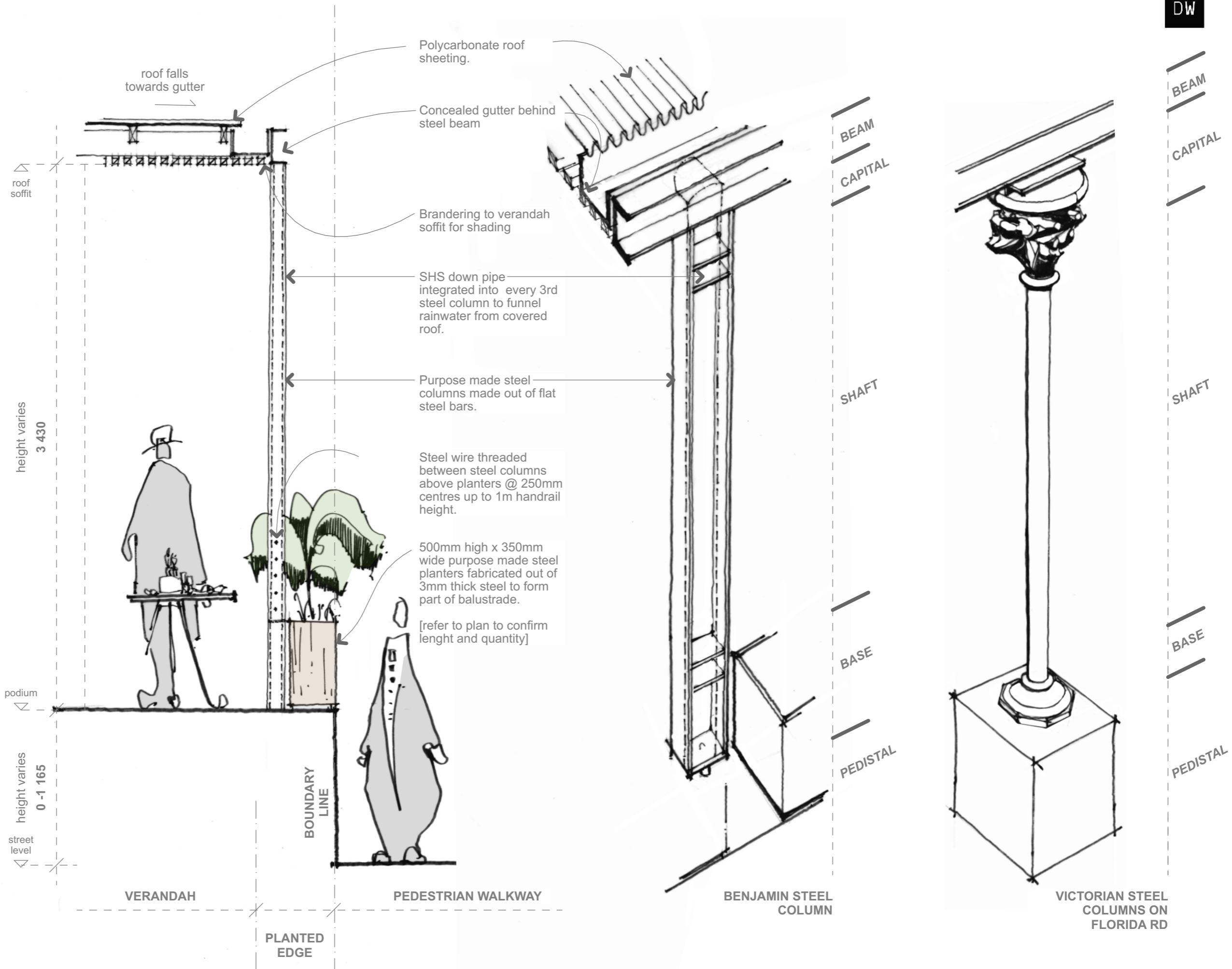

DW

- EXTERIOR 01 _ EXISTING
- EXTERIOR 01 _ OLD REVISION
- EXTERIOR 01 _ NEW REVISION
- EXTERIOR 02 _ EXISTING
- EXTERIOR 02 _ OLD REVISION
- EXTERIOR 02 _ NEW REVISION
- EXTERIOR 03 _ EXISTING
- EXTERIOR 03 _ OLD REVISION
- EXTERIOR 03 _ NEW REVISION
- BOUNDARY WALL
- COLONNADE TYPOLOGY
- COLUMN HISTORICAL REFERENCE
- DETAIL SENSITIVITY

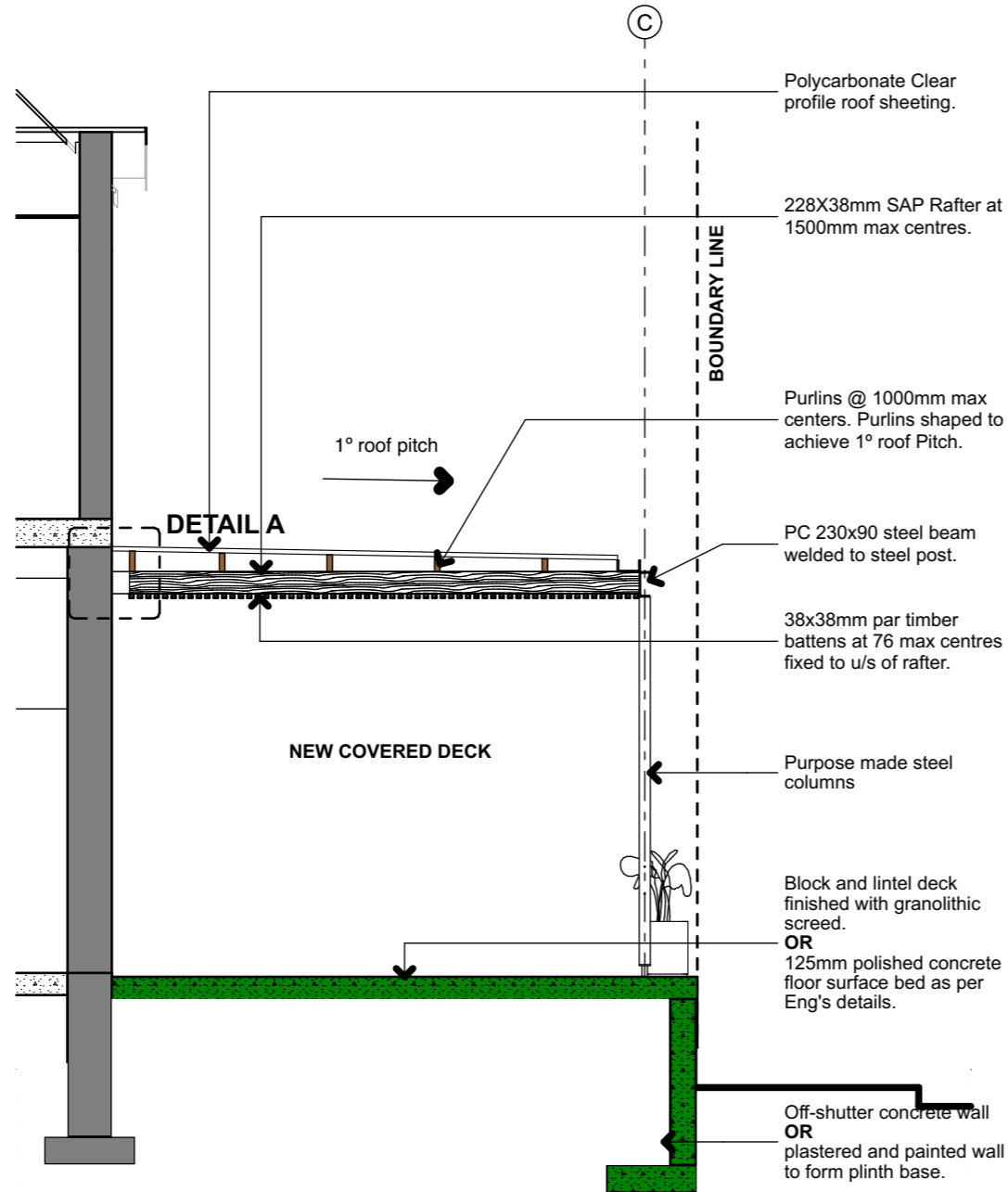

SECTION: D-D
1:50

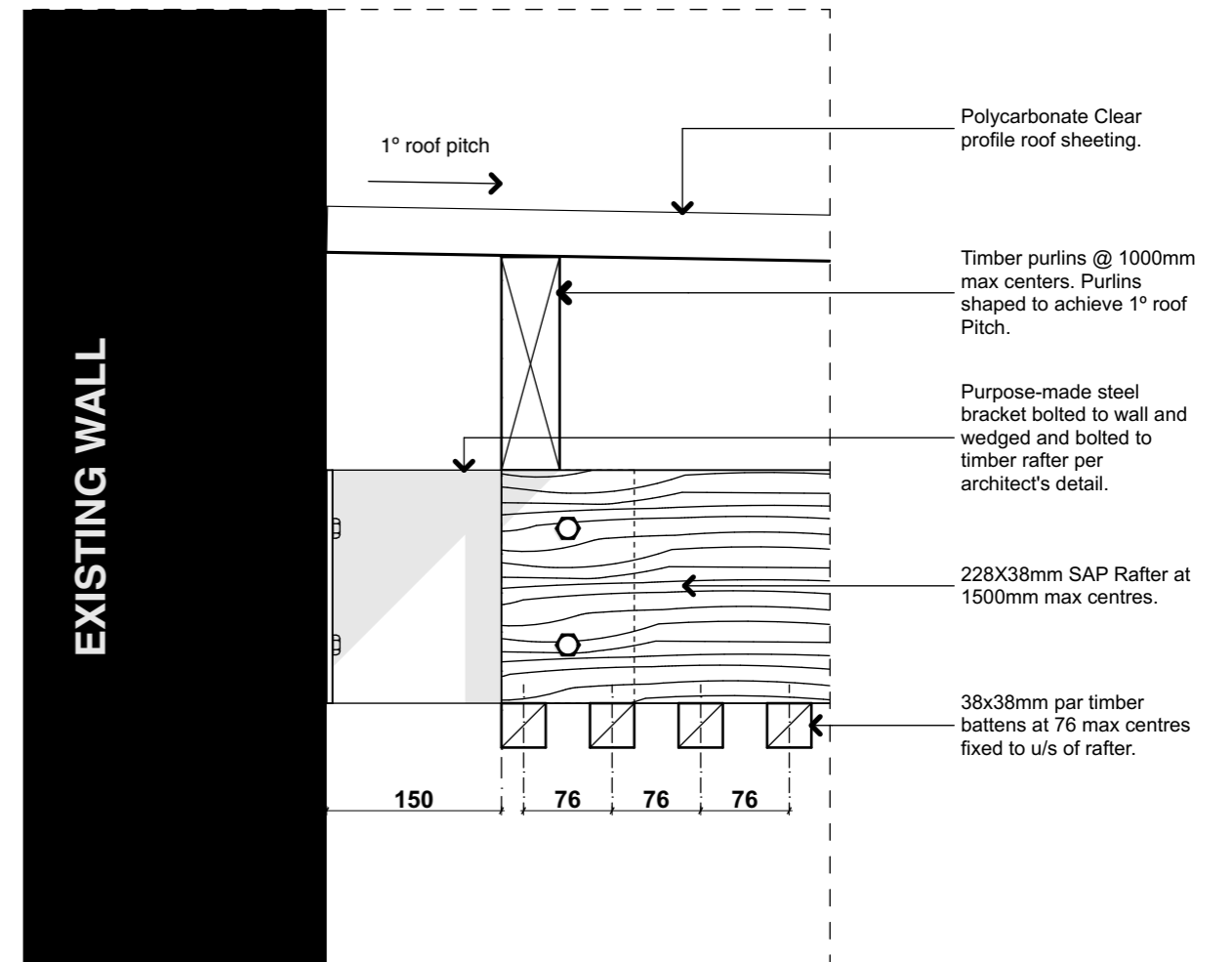

DETAIL A
1:5

ABOUT

Designworkshop is for the curious and the pioneering, for the rational, the free-thinking, and the autonomous, for the modern can-do spirit that drives invention. We embrace a best-of-both-worlds attitude, where learning from the past, respect for the land that raised us, resourcefulness, and simple functional authenticity, create the new, the real and the beautiful.