



**the dme**

Department:  
Minerals and Energy  
**REPUBLIC OF SOUTH AFRICA**

DME 12

Private Bag X6076, Port Elizabeth 6000,  
Tel: (041) 396 3900  
Fax: (041) 396 3946  
Cnr. Diaz and Mount Roads  
Mount Croix  
Port Elizabeth, 6001

Enquiries: D.A. Watkins  
E-mail: deidre.watkins@dme.gov.za

Reference:  
Date:

(EC)30/5/1/1/3/2/1(0135)EM  
13 November 2009

South African Heritage Resources Agency  
P.O. Box 758  
**GRAHAMSTOWN**  
6140

ATTENTION: MR. T. LUNGILE

*Case ID: 2392*

Sir

**CONSULTATION IN TERMS OF SECTION 40 OF THE MPRDA OF 2002:  
ENVIRONMENTAL MANAGEMENT PLAN IN SUPPORT OF PROSPECTING FOR  
LIMESTONE ON THE FARM WICKLOW 117, DIVISION OF PEDDIE, EASTERN  
CAPE**

1. Koleka Mining (Pty) Ltd has applied for a prospecting right on the above-mentioned area.
2. Attached is the EMP for your comment.
3. Please forward any written comments or requirements your department may have on this application, to this office no later than **11 January 2010**. Failure to do so will lead to the assumption that your Department has no objection(s) or comments with regards to the application.
4. Consultation on this application has been initiated with other relevant State Departments.
5. Kindly quote the relevant file reference number in all correspondence.

Sincerely,

**REGIONAL MANAGER  
EASTERN CAPE**





File number:.....

## DEPARTMENT OF MINERALS AND ENERGY

**ENVIRONMENTAL MANAGEMENT PLAN**

Submitted in support of application for a prospecting right or mining permit.  
Section 39 and Regulation 52 of the Minerals and Petroleum Resources Development  
Act, 2002 (Act 28 of 2002)



Application for a:

Prospecting Right	✓
Mining Permit	

Applicant: KOLEKA MINING (PTY) LTD

Farm: REM OF THE FARM WICKLOW 117  
REM OF PORTION 1 OF THE FARM WICKLOW 117  
REM OF PORTION 2 OF THE FARM WICKLOW 117  
PORTION 3 (OF 2) OF THE FARM WICKLOW 117

EC 30/5/1/1/2/0135PR

District: PEDDIE

Mineral: LIMESTONE AND RELATED MINERALS

Date: 10 November 2009



## Contents

### **Section A:**

A.1	Introduction	Page 3
A.2	Scope	Page 3
A.3	Purpose	Page 3
A.4	Use of the document	Page 4
A.5	Legislation/ Regulations	Page 4
A.6	Other relevant legislation	Page 5
A.7	Word definitions	Page 6

### **Section B:**

B.1	Biographical information about the applicant	Page 7
-----	--	--------

### **Section C:**

C 1 - 5	Environmental Impact Assessment/ information about the environment	Page 9
C 6	Specific Regulatory requirements	Page 14

### **Section D:**

D	Scoring of the EIA	Page 23
---	--------------------	---------

### **Section E:**

E	Undertaking by applicant	Page 24
---	--------------------------	---------

### **Section F:**

F	Environmental Management Plan	Page 25
---	-------------------------------	---------

### **Section G:**

G	Specific additional requirements determined by the Regional Manager and agreed to by the Applicant	Page 45
---	--	---------

### **Section H:**

H	Undertaking	Page 46
---	-------------	---------

### **Section J:**

J	Approval	Page 47
---	----------	---------

## A.1 INTRODUCTION

This document aims to provide a simplified national standard for applicants for prospecting rights and mining permits to comply with the relevant legislation and environmental regulations as apply to their respective applications in terms of the Mineral and Petroleum Resources Development Act, 2002 (Act 28 of 2002)(MPRDA).

Applicants in this sector of the mining industry typically disturb smaller surface areas of land, whether drilling boreholes, small trenches, or mining on a small area, less than 1,5 hectares of land, under a mining permit as contemplated in Section 27 of the Mineral and Petroleum Resources Development Act, 2002 (Act 28 of 2002)

## A.2 SCOPE

This document is intended for use by applicants for mining permits and prospecting rights. Typically, operations in this sector of the mining industry:

- Use little or no chemicals to extract mineral from ore,
- Work on portions of land of 1,5 hectares in size or smaller,
- Disturb the topography of an area somewhat but have no significant impact on the geology

## A.3 PURPOSE

This document aims to :

- Provide a national standard for the submission of Environmental Management Plans for the types of applications mentioned above.
- Ensure compliance with Regulation 52 of the MPRDA.
- Assist applicants by providing the information that the Department of Minerals and Energy (DME) requires in a simple language and in a structured, prescribed format, as contemplated in Regulation 52 (2) of the (MPRDA).
- Assist regional offices of the DME to obtain enough information about a proposed prospecting/ reconnaissance or mining permit operation to assess the possible environmental impacts from that operation and to determine corrective action even before such right is granted and the operation commences.

This document aims both to provide the DME regional offices with enough information about applicants for mining permits and applicants with guidance on environmental management matters pertaining to the mitigation of environmental impacts arising from their operations. Given this dual focus and the generic nature of the document, it might not be sufficient for all types of operations under various circumstances.

The document may therefore be altered or added to as the particular circumstances of the application in question may require.

#### A.4 USE OF THE DOCUMENT:

This document is designed for use by non-professionals and newcomers to the environmental management industry and it incorporates a *very simple* Environmental Impact Assessment (EIA). The EIA is contained in Section C of this document and was designed specifically with the target sectors of the mining industry (described in A.2 above) in mind.

The aim is ultimately to (a) gather information from applicants themselves; (b) to assess the impact of the operation based on that information and then (c) to guide the applicant to mitigate environmental impacts to limit damage to the environment.

Section B of the document gathers demographic information about the applicant. Section C gathers the information that will be used in the Environmental Impact Assessment. The applicant must complete the relevant sections of this document, but the regional office of the DME will do the scoring of these for the impact assessment rating in Section D.

Section F (the Environmental Management Plan) of the document is prescriptive and gives guidance to the miner or prospector on how to limit the damage of the operation on the environment. This part may be added to by the regional manager, who has the prerogative to decide whether this Environmental Management Plan will adequately address the environmental impacts expected from the operation or whether additional requirements for proper environmental management need to be set. Where these additional requirements are set, they will appear in Section G of this document. The Environmental Management Plan (Section F) of the document is legally binding once approved and, in the undertaking contained in Section H, the applicant effectively agrees to implement all the measures outlined in this Environmental Management Plan.

#### A.5 LEGISLATION/ REGULATIONS

The relevant sections of Mineral and Petroleum Resources Development Act and its supporting Regulations are *summarised below* for the information of applicants. The onus is on the applicant to familiarise him/herself with the provisions of the full version of the Mineral and Petroleum Resources Development Act and its Regulations.

Section of Act	Legislated Activity/ Instruction/ Responsibility or failure to comply	Penalty in terms of Section 99
5(4)	No person may prospect, mine, or undertake reconnaissance operations or any other activity without an approved EMP, right, permit or permission or without notifying land owner	R 100 000 or two years imprisonment or both
19	Holder of a Prospecting right must: lodge right with Mining Titles Office within 30 days; commence with prospecting within 120 days, comply with terms and conditions of prospecting right, continuously and actively conduct prospecting operations; comply with requirements of approved EMP, pay prospecting fees and royalties	R 100 000 or two years imprisonment or both
20(2)	Holder of prospecting right must obtain Minister's permission to	R 100 000 or two years

Section of Act	Legislated Activity/ Instruction/ Responsibility or failure to comply	Penalty in terms of Section 99
	remove any mineral or bulk samples	imprisonment or both
26(3)	A person who intends to beneficiate any mineral mined in SA outside the borders of SA may only do so after notifying the Minister in writing and after consultation with the Minister.	R 500 000 for each day of contravention
28	Holder of a mining right or permit must keep records of operations and financial records AND must submit to the DG: monthly returns, annual financial report and a report detailing compliance with social & labour plan and charter	R 100 000 or two years imprisonment or both
29	Minister may direct owner of land or holder/applicant of permit/right to submit data or information	R 10 000
38(1)(c)	Holder of permission/permit/right MUST manage environmental impacts according to EMP and as ongoing part of the operations	R 500 000 or ten years imprisonment or both.
42(1)	Residue stockpiles must be managed in prescribed manner on a site demarcated in the EMP	A fine or imprisonment of up to six months or both
42(2)	No person may temporarily or permanently deposit residue on any other site than that demarcated and indicated in the EMP	A fine or imprisonment of up to six months or both
44	When any permit/right/permission lapses, the holder may not remove or demolish buildings, which may not be demolished in terms of any other law, which has been identified by the Minister or which is to be retained by agreement with the landowner.	Penalty that may be imposed by Magistrate's Court for similar offence
92	Authorised persons may enter mining sites and require holder of permit to produce documents/ reports/ or any material deemed necessary for inspection	Penalty as may be imposed for perjury
94	No person may obstruct or hinder an authorised person in the performance of their duties or powers under the Act.	Penalty as may be imposed for perjury
95	Holder of a permit/right may not subject employees to occupational detriment on account of employee disclosing evidence or information to authorised person (official)	Penalty as may be imposed for perjury
All sections	Inaccurate, incorrect or misleading information	A fine or imprisonment of up to six months or both
All sections	Failure to comply with any directive, notice, suspension, order, instruction, or condition issued	A fine or imprisonment of up to six months or both

## A.6 OTHER RELEVANT LEGISLATION

Compliance with the provisions of the Mineral and Petroleum Resources Development Act, 2002 (Act 28 of 2002) and its Regulations does not necessarily guarantee that the applicant is in compliance with other Regulations and legislation. Other legislation that may be immediately applicable includes, but are not limited to:

- National Monuments Act, 1969 (Act 28 of 1969).
- National Parks Act, 1976 (Act 57 of 1976)
- Environmental Conservation Act, 1989 (Act 73 of 1989)
- National Environmental Management Act, 1998 (Act No. 107 of 1998)

- Atmospheric Pollution Prevention Act, 1965 (Act 45 of 1965)
- The National Water Act, 1998 (Act 36 of 1998)
- Mine Safety and Health Act, 1996 (Act 29 of 1996)
- The Conservation of Agricultural Resources Act, 1983 (Act 43 of 1983).

## A.7 WORD DEFINITIONS

In this document, unless otherwise indicated, the following words will have the meanings as indicated here:

<b>Act (The Act)</b>	Mineral and Petroleum Resources Development Act, 2002 (Act 28 of 2002)
<b>Borehole</b>	A hole drilled for the purposes of prospecting i.e. extracting a sample of soil or rock chips by pneumatic, reverse air circulation percussion drilling, or any other type of probe entering the surface of the soil.
<b>CARA</b>	The Conservation of Agricultural Resources Act
<b>EIA</b>	An Environmental Impact Assessment as contemplated in Section 38(1) (b) of the Act
<b>EMP</b>	an Environmental Management Plan as contemplated in Section 39 of the Act
<b>Fauna</b>	All living biological creatures, usually capable of motion, including insects and predominantly of protein-based consistency.
<b>Flora</b>	All living plants, grasses, shrubs, trees, etc., usually incapable of easy natural motion and capable of photosynthesis.
<b>Fence</b>	A physical barrier in the form of posts and barbed wire and/or "Silex" or any other concrete construction, ("palisade"- type fencing included), constructed with the purpose of keeping humans and animals within or out of defined boundaries.
<b>House</b>	any residential dwelling of any type, style or description that is used as a residence by any human being
<b>NDA</b>	National Department of Agriculture
<b>NWA</b>	National Water Act, Act 36 of 1998
<b>Pit</b>	Any open excavation
<b>"Porrel"</b>	The term used for the sludge created at alluvial diamond diggings where the alluvial gravels are washed and the diamonds separated in a water-and-sand medium.
<b>Topsoil</b>	The layer of soil covering the earth which- <ol style="list-style-type: none"> <li>provides a suitable environment for the germination of seed;</li> <li>allows the penetration of water;</li> <li>is a source of micro-organisms, plant nutrients and in some cases seed; and</li> <li>is not of a depth of more than 0,5 metres or such depth as the Minister may prescribe for a specific prospecting or exploration area or mining area.</li> </ol>
<b>Trench</b>	A type of excavation usually made by digging in a line towards a mechanical excavator and not pivoting the boom – a large, U-shaped hole in the ground, with vertical sides and about 6 – 8 metres in length. Also a prospecting trench.
<b>Vegetation</b>	Any and all forms of plants, see also Fauna
<b>DWAF</b>	The Department of Water Affairs and Forestry – both national office and their various regional offices, which are divided across the country on the basis of water catchment areas.
<b>MPRDA</b>	the Mineral and Petroleum Resources Development Act, 2002 (Act 28 of 2002)
<b>EMPlan</b>	An Environmental Management Plan as contemplated in Regulation 52 of the Mineral and Petroleum Resources Development Act, 2002 (Act 28 of 2002) – this document.



## B. BIOGRAPHIC DETAILS OF THE APPLICANT:

<b>B 1.1</b> Full name (and surname) of person or company applying for permit or right	KOLEKA MINING (PTY) LTD
<b>B 1.2</b> ID number of person or company/ CC registration number	2009/014131/07
<b>B 1.3</b> Postal address	PO BOX 966 BEDFORDVIEW 208
<b>B 1.4</b> Physical/ residential address	OFFICE 9 PARADE ON KLOOF OFFICES 132 PARADE STREET ORIEL, 2008 JOHANNESBURG
<b>B 1.5</b> Applicant's telephone number	
<b>B 1.6</b> Applicant's cellular phone number	082 964 4662
<b>B 1.7</b> Alternative contact's name	Mr. S. VELEMPINI
<b>B 1.8</b> Alternative contact's telephone/cell phone numbers	082 318 7217
<b>B 2.1</b> Full name of the property on which <u>prospecting</u> operations will be conducted	FARM WICKLOW 117
<b>B 2.2</b> Name of the subdivision	REM OF THE FARM WICKLOW 117 REM OF PORTION 1 OF THE FARM WICKLOW 117 REM OF PORTION 2 OF THE FARM WICKLOW 117 PORTION 3 (OF 2) OF THE FARM WICKLOW 117

<b>B 2.3</b> Approximate centre of prospecting area:	27 o 20 min 15 sec East
Latitude	-33 o 13 min 15 sec South
Longitude	<b>See attached Drawing, titled "Sketch Plan"</b>
<b>B 2.4</b> Magisterial district	<b>PEDDIE</b>
<b>B 2.5</b> Name of the registered owner of the property	<b>AS PER ATTACHED LIST. SEC. C11.3</b>
<b>B 2.6</b> His/her Telephone number	<b>AS PER SECTION C11.3</b>
<b>B 2.7</b> His/ her Postal address	<b>AS PER SECTION C11.3</b>
<b>B 2.8</b> Current uses of surrounding areas	<b>AGRICULTURAL and SETTLEMENT</b>
<b>B 2.9</b> Are there any other, existing land uses that impact on the environment in the proposed prospecting area? <b>YES</b>	<b>The prospecting area adjoins the settlements and agricultural land found in the Waterford, Kwa Ndaba and Bell.</b>
<b>B 2.10</b> What is the name of the nearest town?	<b>Peddie</b>

## B 3 DESCRIPTION OF PROPOSED PROSPECTING OPERATION

### YEAR 1

#### Prospecting Work

The limestone formation will be mapped from satellite images and target areas identified. Detailed ground mapping to determine mineralized formations will follow to confirm satellite image interpretations. Rock samples will be collected during the detailed mapping and the samples will be analyzed for their CaCo<sub>3</sub> content.

#### Geochemical surveys

The limestone samples collected from rock samples will be analyzed as mentioned in 1 (f) (ii).

#### Geophysical surveys

No geophysical work is planned.

### YEAR 2

#### Prospecting work

Detailed mapping of the mineralized limestone formation will be conducted during year two. Drilling testing will be conducted from targets identified from Year 1. The detailed geology from drilling will be used to map the surface expression of any significant mineralization.

Additional drilling will be conducted on blocks that have potential to host limestone resource. The data will be analyzed by computer with the aim of defining initial resource figures.

#### Geochemical surveys

The same analyses route as for year 1 except that metallurgical tests will be conducted.

#### Geophysical surveys

No geophysical work is planned.

### YEAR 3

#### Prospecting work

Depending on results of year 2 further delineation percussion and core-drilling to establish a potential resource.

#### Geochemical surveys

The laboratory schedule envisaged would be the same as year 2. Bulk samples will be collected subject to a revised EMP. The samples will be submitted to a laboratory to test recoveries and design processing flow sheets.

#### Geophysical surveys

No geophysical work is planned.

### YEAR 4 & 5

#### Prospecting work

A feasibility study will be undertaken together with further metallurgical test work. A revised EMP program would be submitted to cater for this program. This study would also

take into account mine planning which would mean further drilling to establish a reserve in addition to drilling for rock mechanical purposes.

**Geochemical surveys**  
As for years 2 and 3.

**Geophysical surveys**  
No geophysical work is planned.

Should the program be accelerated or terminated due to negative results the department would be consulted and approval for acceleration of program would be requested from the DMR.

## C. ENVIRONMENTAL IMPACT ASSESSMENT:

The information provided in this section will enable officials to determine how serious the impact of the prospecting/mining operation will be.

**DESCRIBE THE ENVIRONMENT THAT WILL BE AFFECTED BY THE PROPOSED PROSPECTING/MINING OPERATIONS UNDER THE FOLLOWING HEADINGS:**

C.1 DESCRIPTION OF THE ENVIRONMENT LIKELY TO BE AFFECTED BY PROPOSED PROSPECTING OPERATIONS: (REGULATION 52(2)(a))			
ENVIRONMENTAL ELEMENT/ IMPACTOR	VALUE	TICK	OFFICE USE
C 1.1 What does the landscape surrounding the proposed operation look like? (Open veld/ valley/ flowing landscape/ steep slopes)			
Steep slopes and flat low-lying areas			
C 1.2 Describe the type of soil found on the surface of the site	The soil classification for the exploration area consists predominantly of reddish-brown sandy soil		
	VALUE	TICK	OFFICE USE
C 1.3 How deep is the topsoil?	0 – 300mm		8
	300 – 600mm		4
	600mm +	✓	2
C 1.4 What <i>plants, trees and grasses</i> grow naturally in the area around the site?			
Grasslands dominate the area and large trees can be encountered along rivers and hill sides.			
C 1.5 What <i>animals</i> naturally occur in the area?			
Due to human settlement, no wild animals naturally occur.			
	VALUE	TICK	OFFICE USE
C 1.6 Are there any <i>protected areas</i> (game parks/nature reserves, monuments, etc) close to the proposed operation?	Yes		4
	No	✓	0

C 1.7 What mineral are you going to prospect for		LIMESTONE AND RELATED MINERALS	
C 1.8 Describe the type of equipment that will be used:			
1. Geological mapping: limited driving and traversing on foot			
2. Diamond drill rig			
C.2 HOW WILL THE PROPOSED OPERATION IMPACT ON THE <i>NATURAL ENVIRONMENT?</i> (REGULATION 52(2)(b))			
ENVIRONMENTAL ELEMENT/ IMPACTOR		VALUE	TICK
			OFFICE USE
C 2.1 What will the ultimate depth of the proposed prospecting operations be ?		0 – 5m	2
		6 – 10m	4
		10 – 25m	8
		25m +	✓ 10
C 2.2 How large will the <i>total</i> area of all excavations be?		NO EXCAVATIONS WILL BE DONE	
			ha
<b>Note: Prospecting will be by means of boreholes. The surface area likely to be disturbed due to drilling and associated activities is likely to be &lt; 50 m<sup>2</sup> per borehole.</b>			
C 2.3 How large will each excavation be before it is filled up?		NO EXCAVATIONS WILL BE DONE	✓ 2
		<20 X 20m	4
		>20 X 20m	8
C 2.4 How many <i>prospecting</i> boreholes or trenches will there be?		YEAR 1 = 2 YEAR 2 = 6	
See Drawing for borehole locations of the first 8 holes. The follow up drill holes will be drilled on a target confirmed by the first phase drilling.			

	VALUE	TICK	OFFICE USE
<b>C 2.5</b> Will employees prepare food on the site and collect firewood?	Yes		4
	No	✓	0
<b>C 2.6</b> Will water be extracted from a river, stream, dam or pan for use by the proposed operation?	Yes		4
	No	✓	2
<b>C 2.7</b> If so, what is the name of this water body?	<b>NO WATER EXTRACTED</b>		
<b>C 2.8</b> If water will not be extracted from an open surface source, where will it be obtained?	<b>Water, when required (&lt;1000 litres per day), will be obtained from existing water sources, from farmers.</b>		
<b>C 2.9</b> How much water per day will the <i>prospecting</i> operation require?	1000 – 10 000 Litres		2
<b>The prospecting operation will require &lt;1000 litres of water per day, for washing drilling equipment. It is estimated that a total of 36000 litres of water will be needed to clean drilling equipment for the 8 boreholes.</b>	20 000 – 40 000 L	✓	3
	40 000 – 60 000 L		5
	60 000 – 100 000L		8
	More		10
<b>C 2.10</b> How far is the proposed operation from open water (dam, river, pan, lake)?	0 – 15m		8
	16 – 30m		6
	31 – 60m		4
	More than 60 metres	✓	2
<b>C 2.11</b> What is the estimate depth of the water table/ borehole?	<b>± 30</b>		metres
<b>C 2.12</b> How much water per day will the proposed operation utilise <i>for employees</i> ?	<b>25</b>		Litres
<b>C 2.13</b> What toilet facilities will be made available to workers?	None		8
	Pit latrine (longdrop)		4
	Chemical toilet	✓	2
<b>C 2.14</b> Would it be necessary to construct roads to access	Yes		4

	VALUE	TICK	OFFICE USE
the proposed operations?			
	No	✓	0
<b>C 2.15</b> How long will these access road(s) be (from a public road to the proposed operations)	0 – 0,5 km		4
	0,6 – 1,5 km		2
	1,6 – 3 km		4
<b>C 2.16</b> Will trees be uprooted to construct these access road(s)?	Yes		4
	No	✓	0
<b>C 2.17</b> Will any foreign material, like crushed stone, limestone, or any material other than the naturally occurring topsoil be placed on the road surface?	Yes		4
	No	✓	0
<b>C.3 TIME FACTOR</b>			
<b>C 3.1</b> For what time period will prospecting/ operations be conducted on this particular site?	0 – 6 months		2
	6 – 12 months		4
	12 – 18 months		6
	18 – 24 months		8
	>24 months	✓	10
Although the drilling of 8 boreholes, as described in this EMP, is scheduled to take place over a 24 month period, the envisaged drilling time for each borehole (including setting up the rig) is estimated to be 2 days.			
<b>C.4 HOW WILL THE PROPOSED OPERATION IMPACT ON THE SOCIO-ECONOMIC ENVIRONMENT? (REGULATION 52(2)(b))</b>			
ELEMENT/ IMPACTOR	VALUE	TICK	OFFICE USE
<b>C 4.1</b> How many people will be employed?	• 6		
<b>C 4.2</b> How many men?	• 6		
<b>C 4.3</b> How many women?	• 0		
<b>C 4.4</b> Where will employees be obtained? (Own or employed from local communities?)	Own	✓	2



	VALUE	TICK	OFFICE USE
	Local	✓	4
<b>C 4.5</b> How many hours per day will employees work?	Sunrise → Sunset		4
	Less	✓	2
	More		8
	VALUE	TICK	OFFICE USE
<b>C 4.6</b> Will operations be conducted within 1 kilometre from a residential area	Yes		6
	No	✓	1
<b>C 4.7</b> How far will the proposed operation be from the nearest fence/windmill/house/dam/built structure?	0 – 50 metres		8
	51 – 100 metres		4
	150 or more metres	✓	2
<b>C 4.8</b> Response of affected parties:			
<b>Consultations were held with affected parties. The consultation letters are attached.</b>			
<b>C.5 HOW WILL THE PROPOSED OPERATION IMPACT ON THE CULTURAL HERITAGE OF THE SURROUNDING ENVIRONMENT? REGULATION 52(2)(b)</b>			
ELEMENT/ IMPACTOR	VALUE	TICK	OFFICE USE
<b>C 5.1</b> Are there any graveyards or old houses or sites of historic significance within 1 kilometre of the area?	Yes		8
	No	✓	0
<b>C 5.2</b> Response of affected parties:			
<b>No graveyards have been observed in the target areas and areas associated with human settlement will be avoided.</b>			

## C.6 SPECIFIC REGULATORY REQUIREMENTS

<p><b>C.6.1 Air quality Management and Control (Regulation 64)</b> Describe how the operation will impact on the quality of the air, taking into account predominant wind direction and other affected parties in the downwind zone:</p>	
<p><b>Impacts on air quality are anticipated to be of no significance. This is due to the following factors:</b></p> <ul style="list-style-type: none"> <li>➤ The number and frequency of vehicles travelling on the gravel roads is expected to be very few (<math>\pm 4</math> trips per day)</li> <li>➤ The duration of activity at any one site during drilling is estimated to be a maximum of 3 day</li> <li>➤ The distance to residential areas and/or farm houses is greater than 1 km.</li> <li>➤ Dust from drilling will occur, but due to the short time frames of drilling, and the distance to sensitive receptors, is considered to be of low environmental significance</li> </ul>	
<p><b>C.6.2 Fire Prevention (Regulation 65)</b> Applicants for permits, rights or permissions involving <u>coal or bituminous rock</u> must:</p> <ul style="list-style-type: none"> <li>• <b>Indicate on a plan</b> where the coal or rock discard dump will be located <i>(If applied for a permit to mine or prospect for coal or bituminous rock, indicate the exact location of the discard dump on the plan and write "EMPlan C6.2" next to it)</i></li> </ul>	
<p><b>No coal discard dumps will be created.</b></p>	
<p><b>C.6.3 Noise control (Regulation 66)</b> Indicate how much noise the operation will generate, and how it will impact on the surrounding environment, who might be influenced by noise from your operation.</p>	
<p><b>Drilling equipment will be inspected for acceptable noise level and mufflers will be installed to control noise. The drilling operation will be located away from dwellings in order to minimise noise impact to residents. The drilling will be confined to time periods when it is not a nuisance to the communities (i.e. working hours when people are at work or school).</b></p>	
<p><b>The distance to residential areas and/or farm houses is greater than 1 km in all but one instance and as such the potential to create a noise nuisance is assessed as being of no significance. In addition, the short duration of prospecting activities at each location renders the noise impact of no significance.</b></p>	
<p><b>C.6.4 Blasting, vibration and shock (Regulation 67)</b> Please indicate whether any blasting operations will be conducted.</p>	
Blasting:	NO.
	How often?
<p><b>No Blasting</b></p>	
<p><b>C.6.5 Disposal of waste material (Regulation 69)</b> <b>Indicate on your plan</b> where waste will be dumped in relation to the beneficiation works/ washing pans Also indicate below how domestic waste material will be managed.</p>	

<p>In cases where difficult drilling conditions are experienced, it may be necessary to stabilise the borehole with drilling foam.</p> <p>Excess drilling fines (i.e. those which are not removed for logging / assaying) will be placed back into the borehole as part of the finishing of the borehole.</p> <p>Any domestic type waste generated will be collected and disposed of at a recognised facility. Bins will be provided for workers to dispose of daily waste (such as plastic wrappers etc.). This will be collected and disposed of at a recognised facility nearby.</p>
<p><b>C.6.6 Soil pollution and erosion control (Regulation 70)</b></p>
<p>6.6.1 Indicate how topsoil will be handled on the area.</p> <p>In general, there will not be a need to remove topsoil.</p> <p>However, in cases where difficult drilling conditions are experienced (as described in C6.5) then a small pit (&lt; 5 m<sup>3</sup>) will need to be excavated, and the topsoil associated with this excavation will be stockpiled and use for rehabilitation. Due to the small quantities of topsoil, there is no special requirement for the height of stockpiles. To prevent erosion (by wind or water), stockpiles are to be covered with plastic sheeting. Special protection measures for preventing erosion from storm water are not required as none of the sites are in close proximity to drainage courses.</p>
<p>6.6.2 Describe how spills of oil, grease, diesel, acid or hydraulic fluid will be dealt with.</p> <p>Drip trays will be installed underneath the drill rig in order to collect any spills. Check all equipment and tools for chips, cracks, loose bolts, loose screws, etc.</p> <p>Spills, should they occur, will be removed and disposed of at a registered hazardous waste facility</p> <p>Drilling fluid (foam) is soap-based, and a maximum of 25 litres will be stored. This foam penetrates soil so there will be no effluent and subsequently no possibility of water contamination.</p>
<p>6.6.3 Briefly describe the storage facilities available for the above fluids:</p> <p>Only small quantities of oil and grease will be kept on site. Hydrocarbons will be sourced from a fuel station in the vicinity. A total of about 5 litres of grease and &lt;20 litres of oil will be needed for the rig in all drilling operations. All re-fuelling will happen at local towns. Drilling foam will be kept in a 25 litre bottle.</p>

<b>C.6.7 If significant impacts on any element of the environment mentioned in Section C 1 to C 6.6 above have been identified, summarise all of them here: (Regulation 52(2)(c))</b>	<b>C.6.8 How will the negative impacts on the environment be mitigated or managed (as described in C 6.11 to the left? (Regulation 57(2)(c))</b>
<b>Example:</b> Section C 6.4 Blasting. I have identified that the people living on the neighbouring property are sensitive to loud noises as they have children that must study during the afternoons	<b>Example:</b> I will mitigate the impact of my blasting operations on the Interested Parties by limiting blasting operations to school hours, when no one in the affected area is at home.
C 2.14 Road access and vegetation trampling	Where off-road driving is necessary, attempts to follow fence lines and animal tracks will be made at every possible opportunity
C 4.8 Community incidents	C 4.8 Consultation with the community will be an on-going activity to ensure harmonious execution of the work programme
C 6.1. Air pollution	Travelling of vehicles will be limited to necessary tasks and short duration of site operations means dust pollution along roads will be limited. Diamond drilling will have low dust production, and is therefore seen to be of low significance.
C 6.2 Fire hazard	C 6.2 Maintain visual awareness of surroundings; smoking only allowed in designated areas; keep a fire extinguisher on Site
C 6.3 Noise disturbance	Drilling times will be minimised and kept to working hours when residents are at work / school (away from sites)
C 6.5 Domestic waste	C 6.5 Waste bins will be located at each site and this waste will be disposed of at a recognized facility in nearby.
C 6.6.2 There is a potential for oil to leak from the drill rig and contaminate soil	C 6.6.2 Drip trays will be inserted under potential leak zones to collect any leaks. An oil absorbent lining will be rolled under the rig to collect minor leaks from the machine
C 6.6 Erosion control	Ground flattened / restored to original slope when boreholes finished / plugged
C 6.6.2 Oil spills from the drill rig	C 6.6.2 A spill kit will be located at each site to deal with any emergency spills
C 6.6.2 Hydrocarbon spills from storages sites	C 6.6.2 Storage of hydrocarbons will be kept to a minimal. The storage envisaged includes grease and hydraulic oil. The hydrocarbons will be stored in drip tray and the site will be bunded to prevent accidental spills.

### C.7 Financial provision: (Regulation 54)

The amount that is necessary for the rehabilitation of damage caused by the operation, both sudden closure during the normal operation of the project and at final, planned closure will be estimated by the regional office of the DME, based on the information supplied in this document. This amount will reflect how much will it cost the Department to rehabilitate the area disturbed in case of liquidation or abscondence.

Enter the amount of financial provision required here: <b>R 15,000</b>
--

**Note: See Appendix 4 for financial calculations of rehabilitation costs.**

What method will be used to furnish DME with this financial provision?

Cash deposit	✓
Bank guarantee	
Trust Fund	
Other: (specify) (Note: other methods must be approved by the Minister)	

The standard formats for each of these types of guarantees are available from your regional office of the DME.

### C.8.1 Monitoring and performance assessment.

Regulation 55 of the Mineral and Petroleum Resources Development Act, 2002 (Act 28 of 2002) clearly describes the process and procedure as well as requirements for monitoring and auditing of the performance of this plan to adequately address environmental impacts from the operation. The following information must be provided:

<b>C.8.2 Please describe how the adequacy of this programme will be assessed and how any inadequacies will be addressed. (Regulations 55(1) and 52(2)(e))</b>
---

*Example: I will, on a bi-monthly basis, check every aspect of my operation against the prescriptions given in Section F of this document and, if I find that certain aspects are not addressed or impacts on the environment are not mitigated properly, I will rectify the identified inadequacies immediately.*

**I will monitor all aspects of the operation on a monthly basis. A project manager will be appointed to monitor the operation on a more regular basis and if impact will be immediately mitigated by the Project Manager.**

**Monitoring is required for the following:**

**During drilling: regular (at least weekly) inspection of the drilling team to ensure that they comply with this EMP, including control of spills, limiting damage to vegetation, and not making fires at the drill sites. An environmental officer will be appointed to monitor compliance.**

**After drilling: Monitoring of rehabilitation will involve regular (monthly) site inspections by a subcontractor from the local community who will be responsible for removing declared weeds and invader plants from each of the sites.**

<b>C.9 Closure and Environmental objectives: (Regulation 52(2)(f))</b>
Clearly state the intended end use for the area prospected after closing of operations
<b>To return each drilling site to its original state, each borehole will be sealed, the ground levels, and vegetation re-instated.</b>
<b>Note that sealing of the borehole will be according to the standards specified by DWAF, which includes a concrete (subsurface) cap, conically shaped to prevent it subsiding into the borehole.</b>
<b>C.9.1 Describe, in brief terms, what the environment will look like after a closure certificate has been obtained.</b>
<b>Due to the nature of the prospecting activity, which is restricted to drilling, the environment will return to its original state after a closure certificate has been issued.</b>

Note: The proposed end-state of your area must be consulted with interested and affected parties in terms of Regulation 52(2)(g). Details of the acceptability of the end-state must appear in the section below.

## **C 10 CLOSURE**

Regulations 56 to 62 outline the entire process of mine closure, and these are copied in Section F of this document, both as a guide to applicants on the process to be followed for mine closure, and also to address the legal responsibility of the applicant with regard to the proper closure of his operation. In terms of Section 37 of the Mineral and Petroleum Resources Development Act, 2002 (Act 28 of 2002), the holder of a permit is liable for any and all environmental damage or degradation emanating from his/her operation, until a closure certificate is issued in terms of Section 43 of the Mineral and Petroleum Resources Development Act, 2002 (Act 28 of 2002).

### **C.11 Public Participation: (Regulation 52(2)(g))**

In terms of the above regulation consultation with interested and affected person or persons must take place prior to the approval of the environmental management plan. This regulation is quoted below for ease of reference.

***"a record of the public participation undertaken and the results thereof"***

**C 11.1** Any comments lodged by an interested and affected person or persons in terms of section 10(1)(b) of the Act, must be in writing and addressed to the relevant Regional Manager.

**C 11.2** Any objections lodged by an interested and affected person or persons against the application for a right or permit in terms of the Act, must set out clearly and concisely the

facts upon which it is based and must be addressed to the relevant Regional Manager in writing.

- C 11.3** The Regional Manager must make known by way of publication in a local newspaper or at the office of the Regional Manager, that an application for a right or permit in terms of the Act has been received.

In the table below, please list the names of people or organisations likely to be influenced by the proposed operations (these might include neighbours, other water users, etc.) Kindly indicate how these people were consulted (eg. By letter or by phone) *and provide proof* of that consultation. What were the main concerns/ objections raised by the interested and affected parties to the proposed operation?

Name of Interested/ affected party	Contact details: Address & telephone number	How did consultation take place?	What were his/her main concerns about the operation?
① Amotole Development and land Reform Remainder of portion 1, portion 2 and portion 3 of 2 of the farm Wicklow 117 RD division of Peddie	BAHLEKIE KEIKELAME, AMOTOLE RURAL Development and Land Reform Office Tel: 043 700 7000	Telephonically and correspondence letters attached	NO OBJECTIONS
② Remainder of the farm Wicklow 117 RD division of Peddie Mr Bomets Sihlwele is late	Mr Sihlwele and Ms Sihlwele Tel: 083 755 5726 and 082 968 3603	Telephonically, Correspondence and on site consultation. Letters attached	NO OBJECTIONS





**rural development  
& land reform**

Department:  
Rural Development & Land Reform  
REPUBLIC OF SOUTH AFRICA

Amatole Rural Development and Land Reform Office, P.O. Box 1958, EAST LONDON, 5200  
Tel: (043) 722 1782 Fax: (043) 722 1788

**The Regional Manager  
Department of Minerals and Energy  
Private Bag X6076  
Port Elizabeth  
6000**

Dear Sir/Madam

**RE: KOLEKA MINING**

The Department of Rural Development and Land Reform acknowledges receipt of your application letter for mining received via fax on the 14 October 2009. Your application has been forwarded to State land Unit Manager, Ms Bahleki Keikelame, she can be contacted at 043 700 7000.

Hope that this is clear.

Regards

  
M. Hlopekazi

Acting District Manager – Eastern Cape Rural Development & Land Reform Office  
Date: 15 October 2009

---

## **KOLEKA MINING (PTY) LTD**

**2009/014131/07**

**P.O. BOX 966 BEDFORDVIEW 2008**

**TEL NO: 0110215897/8 CELL NO: 0829644662 FAXMAIL: 0866480663**

**E-MAIL: siphov@mweb.co.za**

**11 October 2009**

**Mr Bomela Obrey Sihlwele  
(hand delivery)**

**REF: EC30/5/1/1/2/0135 PR**

**Dear Sir**

KOLEKA MINING (Pty) Ltd has applied to the State in terms of Section 16 of the Minerals and Petroleum Resources Development Act, 2002 (Act 28 of 2002) for a prospecting permit on the remainder of the Farm Wicklow 117 RD Division of Peddie

The company intends to prospect for Limestone, Dolomite and Dolomitic Limestone on areas that were identified as prospective. The work would be carried out in co-operation with all affected parties.

In the event of the work returning negative results, it is unlikely that further work will be conducted on the farms. If the results returned are positive, additional work will be conducted in order to test the extent of mineralization. If the mineralization is found to be uneconomic, the farms will be abandoned in accordance with the provisions of the act.

All surface disturbances and boreholes will be rehabilitated. Water bearing boreholes, together with their casings will however be left open at the owners request at no cost to the owner.

Should you have any enquiries or require further information with respect to the application, kindly contact our offices at **0829644662**. Enquiries may also be directed to the Director: Mineral Development – EASTERN CAPE PORT ELIZABETH at the following address:

The Regional Manager  
Department of Minerals and Energy  
Private Bag X6076  
Port Elizabeth  
6000  
Tel: (041) 396 3900

---

This letter serves as part of consultation required for the application process and your response (acceptance or objection) will be reported in a consultation report to be submitted to the Department: Minerals and Energy.

Yours faithfully.

A handwritten signature in black ink, consisting of several overlapping, sweeping lines that form a stylized, cursive representation of the name Thabang Khomo.

**THABANG KHOMO**  
**(EXECUTIVE DIRECTOR)**

---

**KOLEKA MINING (PTY) LTD**

**2009/014131/07**

**P.O. BOX 966 BEDFORDVIEW 2008**

**PHONE NO: 0110215897/8 CELL NO: 0829644662 FAXMAIL: 0866480663**

**E-MAIL: siphov@mweb.co.za**

**September 2009**

**Mr. M. M. Hlophekazi**

**DEPARTMENT OF LAND AFFAIRS**

**P.O. BOX 1958**

**PORT ELIZABETH**

**6000**

**FAX NO: (043) 722 1788**

**REF: EC30/5/1/1/2/0135 PR**

**Dear Sir**

KOLEKA MINING (Pty) Ltd has applied to the State in terms of Section 16 of the Minerals and Petroleum Resources Development Act, 2002 (Act 28 of 2002) for a prospecting permit on the remainder of portion 1, portion 2 and portion 3 of 2 of the Farm Wicklow 117 RD Division of Peddie

The company intends to prospect for Limestone, Dolomite and Dolomitic Limestone on areas that were identified as prospective. The work would be carried out in co-operation with all affected parties.

In the event of the work returning negative results, it is unlikely that further work will be conducted on the farms. If the results returned are positive, additional work will be conducted in order to test the extent of mineralization. If the mineralization is found to be uneconomic, the farms will be abandoned in accordance with the provisions of the act.

All surface disturbances and boreholes will be rehabilitated. Water bearing boreholes, together with their casings will however be left open at the owners request at no cost to the owner.

Should you have any enquiries or require further information with respect to the application, kindly contact our offices at **0829644662**. Enquiries may also be directed to the Director: Mineral Development – EASTERN CAPE PORT ELIZABETH at the following address:

---

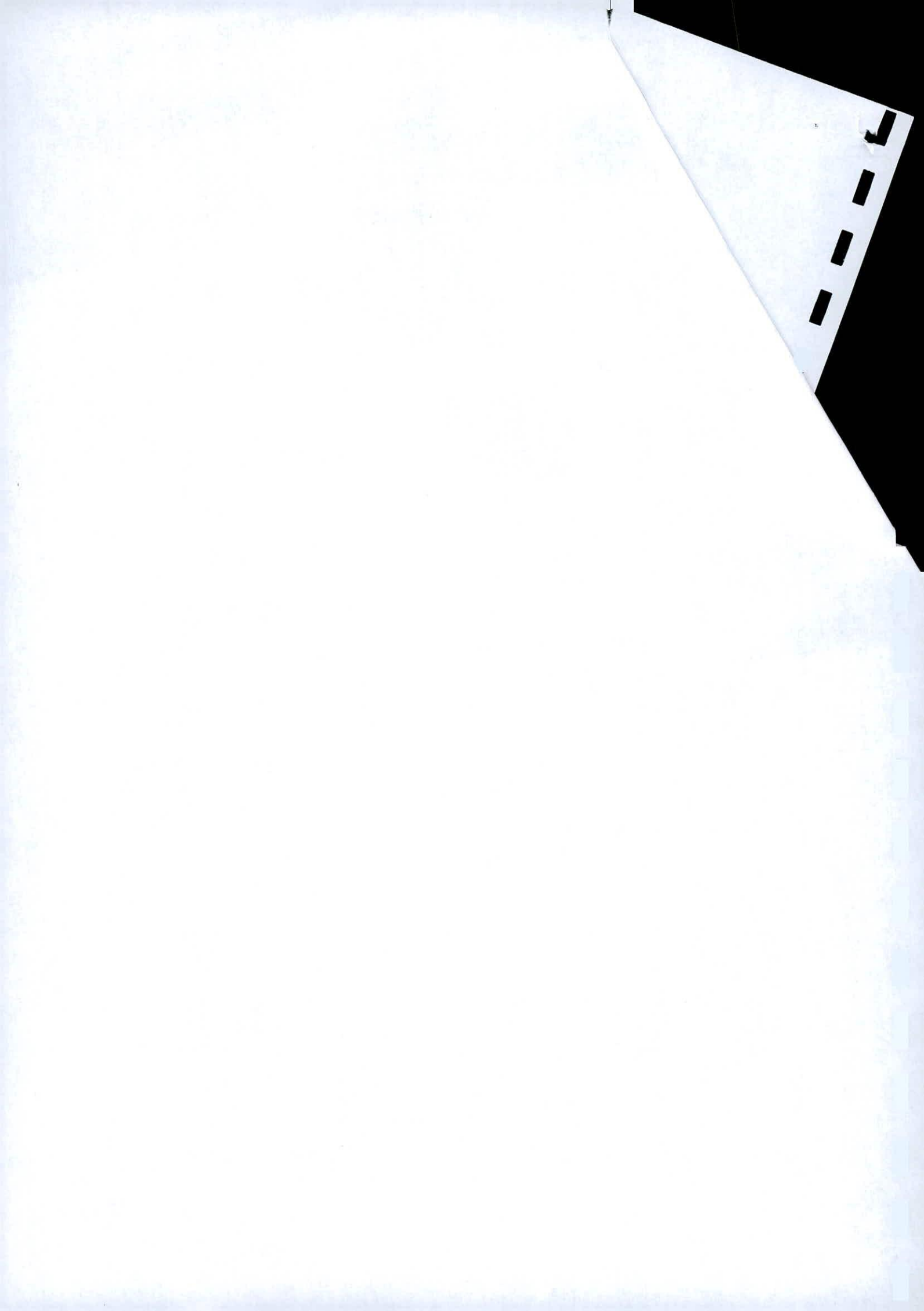

The Regional Manager  
Department of Minerals and Energy  
Private Bag X6076  
Port Elizabeth  
6000  
Tel: (041) 396 3900

This letter serves as part of consultation required for the application process and your response (acceptance or objection) will be reported in a consultation report to be submitted to the Department: Minerals and Energy.

Yours faithfully.

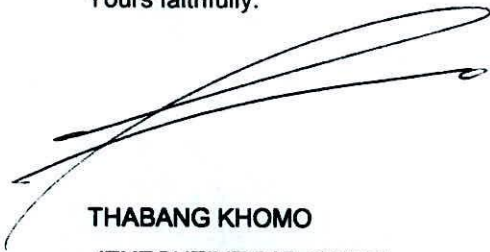
A handwritten signature in black ink, consisting of several overlapping, sweeping lines that form a stylized, elongated shape.

**THABANG KHOMO**  
**(EXECUTIVE DIRECTOR)**

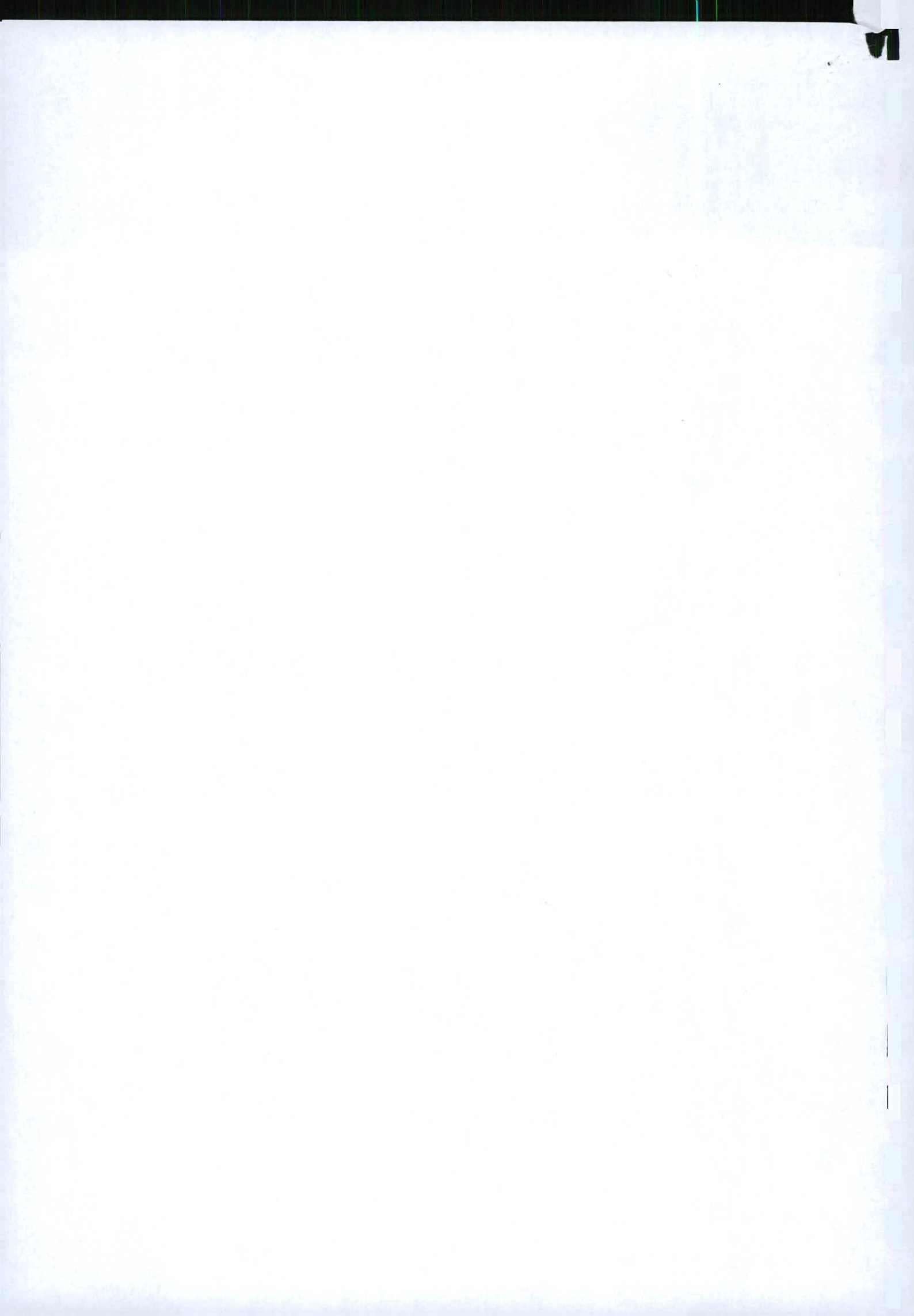

---

**KOLEKA MINING (PTY) LTD**

**2009/014131/07**

**P.O. BOX 966 BEDFORDVIEW 2008**

**TEL NO: 0110215897/8 CELL NO: 0829644662 FAXMAIL: 0866480663**

**E-MAIL: siphov@mweb.co.za**

**11 October 2009**

**Mr Dan Mayekiso**

**TRADITIONAL AFFAIRS**

**P.O. BOX 0025**

**BISHO**

**5608**

**FAX NO: (040) 609 5720**

**REF: EC30/5/1/1/2/0135 PR**

**Dear Sir**

KOLEKA MINING (Pty) Ltd has applied to the State in terms of Section 16 of the Minerals and Petroleum Resources Development Act, 2002 (Act 28 of 2002) for a prospecting permit on the remainder of portion 1, portion 2 and portion 3 of 2 of the Farm Wicklow 117 RD Division of Peddie

The company intends to prospect for Limestone, Dolomite and Dolomitic Limestone on areas that were identified as prospective. The work would be carried out in co-operation with all affected parties.

In the event of the work returning negative results, it is unlikely that further work will be conducted on the farms. If the results returned are positive, additional work will be conducted in order to test the extent of mineralization. If the mineralization is found to be uneconomic, the farms will be abandoned in accordance with the provisions of the act.

All surface disturbances and boreholes will be rehabilitated. Water bearing boreholes, together with their casings will however be left open at the owners request at no cost to the owner.

Should you have any enquiries or require further information with respect to the application, kindly contact our offices at **0829644662**. Enquiries may also be directed to the Director: Mineral Development – EASTERN CAPE PORT ELIZABETH at the following address:

---





The Regional Manager  
Department of Minerals and Energy  
Private Bag X6076  
Port Elizabeth  
6000  
Tel: (041) 396 3900

This letter serves as part of consultation required for the application process and your response (acceptance or objection) will be reported in a consultation report to be submitted to the Department: Minerals and Energy.

Yours faithfully,



**THABANG KHOMO**  
**(EXECUTIVE DIRECTOR)**

## D SCORING OF EIA- FOR OFFICIAL USE ONLY

### Instructions for officials:

In this table, complete the totals of each section indicated below and do the calculation. **Remember to first add all the values of sections C 1,2,4 and 5 and then to multiply it by the time factor in Section C 3**

Note that the value for the time factor element of the impact rating appears in Section C3. This is the total amount of time that the operation is expected to impact on the environment and all other factors are MULTIPLIED by this value. Compare the score (Impact rating) with the table below to help you make a decision on the total impact of the operation and also on the sufficiency of this programme to address all expected impacts from the operation on the environment.

### D 1.1 CALCULATION TABLE

Section <b>C 1</b> Total	+	Section <b>C 2</b> Total	+	Section <b>C 4</b> Total	+	Section <b>C 5</b> Total	=	<u>Subtotal</u>	X	Time Factor Section <b>C 3</b>	=	Score (Impact rating)
	+		+		+		=		X		=	

### D 1.2 IMPACT RATING SCALE

SCORE ATTAINED	IMPACT RATING	REMARKS
46 – 300	Low	No additional objectives needed – this programme is sufficient
301 - 800	Medium	Some specific additional objectives to address focal areas of concern may be set.
801 - 1160	High	Major revision of Environmental Management Plan for adequacy and full revision of objectives.

### Additional Objectives:

Based on the information provided by the applicant and the regional office's assessment thereof, combined with the interpretation of the scoring and impact rating attained for the particular operation above, the Regional Manager of the regional office of the DME may now determine additional objectives /requirements for the mine owner/manager to comply with. *These measures will be specific and will address specific issues of concern that are not adequately covered in the standard version of this document.* These requirements are not listed here, but are specified under

Section G of this document, so as to form part of the legally binding part of this Environmental Management Plan.

**E UNDERTAKING:**

I, **T. Khomo** the applicant for a **PROSPECTING** right hereby declare that the above information is true, complete and correct. I undertake to implement the measures as described in Sections F and G hereof. I understand that this undertaking is legally binding and that failure to give effect hereto will render me liable for prosecution in terms of Section 98 (b) and 99 (1)(g) of the Mineral and Petroleum Resources Development Act, 2002 (Act 28 of 2002). I am also aware that the Regional Manager may, at any time but after consultation with me, make such changes to this plan as he/she may deem necessary.

Signed on this 10th day of **November 2009** at Johannesburg.



.....  
**(Signature of applicant  
Director**

## **F. ENVIRONMENTAL MANAGEMENT PLAN:**

### **INTRODUCTION**

This Environmental Management Plan contains guidelines, operating procedures and rehabilitation/pollution control requirements which will be binding on the holder of the mining permit/ prospecting permission/ reconnaissance permission after approval of the Environmental Management Plan. It is essential that this portion be carefully studied, understood, implemented and adhered to at all times.

### **F 1 GENERAL REQUIREMENTS**

#### **F 1.1 MAPPING AND SETTING OUT**

##### **F 1.1.1 LAYOUT PLAN**

- A copy of the layout plan as provided for in Regulation 2.2 must be available at the prospecting/mining site for scrutiny when required.
- The plan must be updated on a regular basis with regard to the actual progress of the establishment of surface infrastructure, mining operations and rehabilitation (a copy of the updated plan shall be forwarded to the Regional Manager on a regular basis).
- A final layout plan must be submitted at closure of the mine or when operations have ceased.

NOTE: Regulation 2.2 of the regulations promulgated in terms of the Act requires:

*"An application contemplated in sub-regulation (1) must be accompanied by a plan that must contain –*

- (a) *the co-ordinates of the land or area applied for;*
- (b) *the north point;*
- (c) *the scale to which the plan has been drawn;*
- (d) *the name, number and location of the land or area covered by the application;*  
*and*
- (e) *in relation to farm boundaries and surveyed points-*
  - (i) *the size and shape of the proposed area;*
  - (ii) *the boundaries of the land or area comprising the subject of the application concerned;*
  - (iii) *the layout of the proposed reconnaissance, prospecting, exploration, mining or production operations;*
  - (iv) *surface structures and servitudes;*
  - (v) *the topography of the land or area; "*

##### **F 1.1.2 DEMARCATING THE MINING/ PROSPECTING AREA**

- The mining/ prospecting area must be clearly demarcated by means of beacons at its corners, and along its boundaries if there is no visibility between the corner beacons.
- Permanent beacons as indicated on the layout plan or as prescribed by the Regional Manager must be firmly erected and maintained in their correct position throughout the life of the operation.

- Mining/ prospecting and resultant operations shall only take place within this demarcated area.

### **F 1.1.3 DEMARCATING THE RIVER CHANNEL AND RIVERINE ENVIRONMENT**

**The following is applicable if operations are conducted within the riverine environment (See F 3.2):**

- Beacons as indicated on the layout plan or as prescribed by the Regional Manager must be erected and maintained in their correct position throughout the life of the operation.
- These beacons must be of a permanent nature during the operations and must not be easily removable, especially those in a river channel. The beacons must, however, be removed at the end of the operations.
- The mining of and prospecting for any mineral shall only take place within this demarcated mining area.
- If riverine vegetation is present in the form of reeds or wetland vegetation, the presence of these areas must be entered in Part C 1.45 of the EMPlan and indicated on the layout plan.
- The holder of the mining permit/ prospecting right will also be required to permanently demarcate the areas as specified in F 1.1.2.

### **F 1.2 RESTRICTIONS ON MINING/ PROSPECTING**

- On assessment of the application, the Regional Manager may prohibit the conducting of mining or prospecting operations in vegetated areas or over portions of these areas
- In the case of areas that are excluded from mining or prospecting, no operations shall be conducted within 5 m of these areas.

### **F 1.3 RESPONSIBILITY**

- The environment affected by the mining/ prospecting operations shall be rehabilitated by the holder, as far as is practicable, to its natural state or to a predetermined and agreed to standard or land use which conforms with the concept of sustainable development. The affected environment shall be maintained in a stable condition that will not be detrimental to the safety and health of humans and animals and that will not pollute the environment or lead to the degradation thereof.
- It is the responsibility of the holder of the mining permit/ prospecting right to ensure that the manager on the site and the employees are capable of complying with all the statutory requirements which must be met in order to mine, which includes the implementation of this EMP.
- If operations are to be conducted in an area that has already been disturbed, the holder must reach specific agreement with the Regional Manager concerning the responsibilities imposed upon himself/herself pertaining to the rehabilitation of the area and the pollution control measures to be implemented.

## F 2 INFRASTRUCTURAL REQUIREMENTS

### F 2.1 TOPSOIL

- Topsoil shall be removed from all areas where physical disturbance of the surface will occur.
- All available topsoil shall be removed after consultation with the Regional Manager prior to the commencement of any operations.
- The topsoil removed, shall be stored in a bund wall on the high ground side of the mining/prospecting area outside the 1:50 flood level within the boundaries of the mining area/ prospecting.
- Topsoil shall be kept separate from overburden and shall not be used for building or maintenance of access roads.
- The topsoil stored in the bund wall shall be adequately protected from being blown away or being eroded.

### F 2.2 ACCESS TO THE SITE

#### F 2.2.1 Establishing access roads on the site

- The access road to the mining/prospecting area and the camp-site/site office must be established in consultation with the landowner/tenant and existing roads shall be used as far as practicable.
- Should a portion of the access road be newly constructed the following must be adhered to:
  - The route shall be selected that a minimum number of bushes or trees are felled and existing fence lines shall be followed as far as possible.
  - Water courses and steep gradients shall be avoided as far as is practicable.
  - Adequate drainage and erosion protection in the form of cut-off berms or trenches shall be provided where necessary.
- If imported material is used in the construction or upgrading of the access road this must be listed in C 2.17
- The erection of gates in fence lines and the open or closed status of gates in new and existing positions shall be clarified in consultation with the landowner/tenant and maintained throughout the operational period.
- No other routes will be used by vehicles or personnel for the purpose of gaining access to the site.

**NOTE: The design, construction and location of access to provincial roads must be in accordance with the requirements laid down by the Provincial or controlling authority.**

### **F 2.2.2 Maintenance of access roads**

- In the case of dual or multiple use of access roads by other users, arrangements for multiple responsibility must be made with the other users. If not, the maintenance of access roads will be the responsibility of the holder of the mining permit/ prospecting right.
- Newly constructed access roads shall be adequately maintained so as to minimise dust, erosion or undue surface damage.

### **F 2.2.3 Dust control on the access and haul roads**

- The liberation of dust into the surrounding environment shall be effectively controlled by the use of, inter alia, water spraying and/or other dust-allaying agents. The speed of haul trucks and other vehicles must be strictly controlled to avoid dangerous conditions, excessive dust or excessive deterioration of the road being used.

### **F 2.2.4 Rehabilitation of access roads**

- Whenever a mining permit/ prospecting right is suspended, cancelled or abandoned or if it lapses and the holder does not wish to renew the permit or right, any access road or portions thereof, constructed by the holder and which will no longer be required by the landowner/tenant, shall be removed and/or rehabilitated to the satisfaction of the Regional Manager.
- Any gate or fence erected by the holder which is not required by the landowner/tenant, shall be removed and the situation restored to the pre mining/ prospecting situation.
- Roads shall be ripped or ploughed, and if necessary, appropriately fertilised (based on a soil analysis) to ensure the regrowth of vegetation. Imported road construction materials which may hamper regrowth of vegetation must be removed and disposed of in an approved manner prior to rehabilitation.
- If a reasonable assessment indicates that the re-establishment of vegetation is unacceptably slow, the Regional Manager may require that the soil be analysed and any deleterious effects on the soil arising from the mining/prospecting operation, be corrected and the area be seeded with a seed mix to the Regional Manager's specification.

## **F 2.3 OFFICE/CAMP SITES**

### **F 2.3.1 Establishing office / camp sites**

- Office and camp sites shall be established, as far as is practicable, outside the flood plain, above the 1 in 50 flood level mark within the boundaries of the mining/ prospecting area.
- The area chosen for these purposes shall be the minimum reasonably required and which will involve the least disturbance to vegetation. Topsoil shall be handled as described in F 2.1 above



- No camp or office site shall be located closer than 100 metres from a stream, river, spring, dam or pan.
- No trees or shrubs will be felled or damaged for the purpose of obtaining firewood, unless agreed to by the landowner/tenant.
- Fires will only be allowed in facilities or equipment specially constructed for this purpose. If required by applicable legislation, a fire-break shall be cleared around the perimeter of the camp and office sites.
- Lighting and noise disturbance or any other form of disturbance that may have an effect on the landowner/tenant/persons lawfully living in the vicinity shall be kept to a minimum.

### **F 2.3.2 Toilet facilities, waste water and refuse disposal**

- As a minimum requirement, the holder of a mining permit/ prospecting right shall, at least, provide pit latrines for employees and proper hygiene measures shall be established.
- Chemical toilet facilities or other approved toilet facilities such as a septic drain shall preferably be used and sited on the camp site in such a way that they do not cause water or other pollution.
- The use of existing facilities must take place in consultation with the landowner/tenant.
- In cases where facilities are linked to existing sewerage structures, all necessary regulatory requirements concerning construction and maintenance should be adhered to.
- All effluent water from the camp washing facility shall be disposed of in a properly constructed French drain, situated as far as possible, but not less than 200 metres, from any stream, river, pan, dam or borehole.
- Only domestic type wash water shall be allowed to enter this drain and any effluents containing oil, grease or other industrial substances must be collected in a suitable receptacle and removed from the site, either for resale or for appropriate disposal at a recognised facility.
- Spills should be cleaned up immediately to the satisfaction of the Regional Manager by removing the spillage together with the polluted soil and by disposing of them at a recognised facility.
- Non-biodegradable refuse such as glass bottles, plastic bags, metal scrap, etc., shall be stored in a container at a collecting point and collected on a regular basis and disposed of at a recognised disposal facility. Specific precautions shall be taken to prevent refuse from being dumped on or in the vicinity of the camp site.
- Biodegradable refuse generated from the office/camp site, processing areas vehicle yard, storage area or any other area shall either be handled as indicated above or be buried in a pit excavated for that purpose and covered with layers of soil, incorporating a final 0,5 metre thick layer of topsoil (where practicable). Provision should be made for future subsidence of the covering.

### F 2.3.3 Rehabilitation of the office/camp site

- On completion of operations, all buildings, structures or objects on the camp/office site shall be dealt with in accordance with section 44 of the Mineral and Petroleum Resources Development Act, 2002 (Act 28 of 2002), which states:
  - (1) *When a prospecting right, mining right, retention permit or mining permit lapses, is cancelled or is abandoned or when any prospecting or mining operation comes to an end, the holder of any such right or permit may not demolish or remove any building, structure, object -*
    - (a) *which may not be demolished in terms of any other law;*
    - (b) *which has been identified in writing by the Minister for purposes of this section; or*
    - (c) *which is to be retained in terms of an agreement between the holder and the owner or occupier of the land, which agreement has been approved by the Minister in writing.*
  - (2) *The provision of subsection (1) does not apply to bona fide mining equipment which may be removed*
- Where office/camp sites have been rendered devoid of vegetation/grass or where soils have been compacted owing to traffic, the surface shall be scarified or ripped.
- Areas containing French drains shall be compacted and covered with a final layer of topsoil to a height of 10cm above the surrounding ground surface.
- The site shall be seeded with a vegetation seed mix adapted to reflect the local indigenous flora.
- If a reasonable assessment indicates that the re-establishment of vegetation is unacceptably slow, the Regional Manager may require that the soil be analysed and any deleterious effects on the soil arising from the mining/prospecting operation be corrected and the area be seeded with a vegetation seed mix to his or her specification.
- Photographs of the camp and office sites, before and during the mining/prospecting operation and after rehabilitation, shall be taken at selected fixed points and kept on record for the information of the Regional Manager.

## F 2.4 VEHICLE MAINTENANCE YARD AND SECURED STORAGE AREAS

### F 2.4.1 Establishing the vehicle maintenance yard and secured storage areas

- The vehicle maintenance yard and secured storage area will be established as far as is practicable, outside the flood plain, above the 1 in 50 flood level mark within the boundaries of the mining/prospecting area.
- The area chosen for these purposes shall be the minimum reasonably required and involve the least disturbance to tree and plant life. Topsoil shall be handled as described in F 2.1 above.

- The storage area shall be securely fenced and all hazardous substances and stocks such as diesel, oils, detergents, etc., shall be stored therein. Drip pans, a thin concrete slab or a facility with PVC lining, shall be installed in such storage areas with a view to prevent soil and water pollution.
- The location of both the vehicle maintenance yard and the storage areas are to be indicated on the layout plan.
- No vehicle may be extensively repaired in any place other than in the maintenance yard.

#### **F 2.4.2 Maintenance of vehicles and equipment**

- The maintenance of vehicles and equipment used for any purpose during the mining/prospecting operation will take place only in the maintenance yard area.
- Equipment used in the mining/prospecting process must be adequately maintained so that during operations it does not spill oil, diesel, fuel, or hydraulic fluid.
- Machinery or equipment used on the mining/prospecting area must not constitute a pollution hazard in respect of the above substances. The Regional Manager shall order such equipment to be repaired or withdrawn from use if he or she considers the equipment or machinery to be polluting and irreparable.

#### **F 2.4.3 Waste disposal**

- Suitable covered receptacles shall be available at all times and conveniently placed for the disposal of waste.
- All used oils, grease or hydraulic fluids shall be placed therein and these receptacles will be removed from the site on a regular basis for disposal at a registered or licensed disposal facility.
- All spills should be cleaned up immediately to the satisfaction of the Regional Manager by removing the spillage together with the polluted soil and by disposing of them at a recognised facility.

#### **F 2.4.4 Rehabilitation of vehicle maintenance yard and secured storages areas**

- On completion of mining/prospecting operations, the above areas shall be cleared of any contaminated soil, which must be dumped as referred to in section F 2.4.3 above.
- All buildings, structures or objects on the vehicle maintenance yard and secured storage areas shall be dealt with in accordance with section 44 of the Mineral and Petroleum Resources Development Act, 2002.
- The surface shall then be ripped or ploughed to a depth of at least 300mm and the topsoil previously stored adjacent the site, shall be spread evenly to its original depth over the whole area. The area shall then be fertilised if necessary (based on a soil analysis).
- The site shall be seeded with a vegetation seed mix adapted to reflect the local indigenous flora.

- If a reasonable assessment indicates that the re-establishment of vegetation is unacceptably slow, the Regional Manager may require that the soil be analysed and any deleterious effects on the soil arising from the mining/prospecting operation be corrected and the area be seeded with a seed mix to his or her specification.

### **F 3 OPERATING PROCEDURES IN THE MINING AREA**

#### **F 3.1 Limitations on mining/prospecting**

- The mining of or prospecting for precious stones shall take place only within the approved demarcated mining or prospecting area.
- Mining/ prospecting may be limited to the areas indicated by the Regional Manager on assessment of the application.
- The holder of the mining permit/ prospecting right shall ensure that operations take place only in the demarcated areas as described in section F 1.1.2 above.
- Operations will not be conducted closer than one and a half times the height of the bank from the edge of the river channel and in such manner that the stability of the bank of the river is effected.
- Precautions shall also be taken to ensure that the bank of the river is adequately protected from scouring or erosion. Damage to the bank of the river caused by the operations, shall be rehabilitated to a condition acceptable to the Regional Manager at the expense of the holder.
- Restrictions on the disturbance of riverine vegetation in the form of reeds or wetland vegetation must be adhered to. The presence of these areas must be entered in Part of the programme and indicated on the layout plan.

#### **F 3.2 Mining/ prospecting operations within the riverine environment**

**NOTE: The Department of Water Affairs and Forestry may impose additional conditions which must be attached to this EMP. In this regard, please see the Best Practice Guideline for small scale mining developed by DWAF (BPG 2.1)**

(available from <http://www.dwaf.gov.za>)

- The mining of or prospecting for precious stones in the river or the banks of the river will be undertaken only after the Regional Manager has consulted with the Department of Water Affairs and Forestry.
- The canalisation of a river will not be undertaken unless the necessary permission has been obtained from the Department of Water Affairs and Forestry. Over and above the conditions imposed by the said Department, which conditions shall form part of this EMPlan, the following will also apply:
  - ❖ The canalisation of the flow of the river over different parts of the river bed shall be constructed in such a manner that the following are adhered to at all times:

- ◆ The flow of the river may not be impeded in any way and damming upstream may not occur.
  - ◆ The canalisation of the flow may not result in scouring or erosion of the river-bank.
  - ◆ Well points or extraction pumps in use by other riparian users may not be interfered with and canalisation may not impede the extraction of water at these points.
- Access to the riverbed for the purpose of conducting excavations in the river-bed, shall be through the use of only one access at a time. The location of the access to the river channel across the river-bank shall be at a point of the river-bank where the least excavation and damage to vegetation will occur and shall not be wider than is reasonably required. The position of the river access together with all planned future access points, must be indicated on the layout plan.

### **F 3.2.1 Rehabilitation of access to river-bed**

- When rehabilitating the access point, the original profile of the river-bank will be re-established by backfilling the access point with the original material excavated or other suitable material.
- The topsoil shall then be returned over the whole area to its original depth and if necessary fertilised and the vegetation allowed to grow.
- If a reasonable assessment indicates that the re-establishment of vegetation is unacceptably slow, the Regional Manager may require that the soil be analysed and any deleterious effects on the soil arising from the mining/prospecting operation be corrected and the area be seeded with a seed mix to his or her specification.
- In the event of damage from an occurrence where high flood waters scour and erode access points in the process of rehabilitation over the river-bank or an access point currently in use, repair of such damage shall be the sole responsibility of the holder of the mining permit or prospecting right.
- Repair to the river-bank to reinstate its original profile to the satisfaction of the Regional Manager must take place immediately after such event has occurred and the river has subsided to a point where repairs can be undertaken.
- Final acceptance of rehabilitated river access points will be awarded only after the vegetation has re-established to a point where the Regional Manager is satisfied that the river-bank is stable and that the measures installed are of durable nature and able to withstand high river-flow conditions.

### **F 3.2.2 Rehabilitation of mining/prospecting area in the bed of the river**

- The goal of rehabilitation with respect to the area where mining/prospecting has taken place in the river-bed is to leave the area level and even, and in a natural state containing no foreign debris or other materials and to ensure the hydrological integrity of the river by not attenuating or diverting any of the natural flow.
- All scrap and other foreign materials will be removed from the bed of the river and disposed of as in the case of other refuse (see section F 2.3.2 above), whether

these accrue directly from the mining/prospecting operation or are washed on to the site from upstream.

- Removal of these materials shall be done on a continuous basis and not only at the start of rehabilitation.
- Where reeds or other riverine vegetation have been removed from areas, these shall be re-established systematically in the approximate areas where they occurred before mining/prospecting.
- An effective control programme for the eradication of invader species and other exotic plants, shall be instituted on a regular basis over the entire mining/prospecting area under the control of the holder of the mining permit/prospecting right, both during mining/prospecting and at the stage of final rehabilitation.

## 2. THE WATER USE LICENCE

The National Water Act, (Act 36 of 1998), is based on the principles of sustainability, efficiency and equity, meaning that the protection of water resources must be balanced with their development and use.

In addition to being issued with a prospecting right or mining permit a small-scale miner may also need to get a **water use licence** for the proposed water uses that will take place, except in certain cases.

*NOTE: The Department of Water Affairs and Forestry (DWAF) developed specific Best Practice Guideline for small scale mining that relates to stormwater management, erosion and sediment control and waste management. Copies of these guidelines can be obtained from the regional office of DME or DWAF.*

Applications for a water use licence must be made in good time, such that approval can be granted before a water use activity can begin. The appropriate licence forms for each kind of expected water use should be completed together with supporting documentation. The main supporting document required is a technical report. To make the technical report easier, you can refer to sections in this EMPlan, as most of what the technical report requires has already been done in the EMPlan. If you refer to the EMPlan it must be attached to the technical report.

### F 3.3 EXCAVATIONS

#### F 3.3.1 Establishing the excavation areas

- Whenever any excavation is undertaken for the purpose of locating and/or extracting ore bodies of all types of minerals, including precious stone-bearing gravels, the following operating procedures shall be adhered to:
  - ❖ Topsoil shall, in all cases (except when excavations are made in the river-bed), be handled as described in F 2.1 above.
  - ❖ Excavations shall take place only within the approved demarcated mining/prospecting area.
  - ❖ Overburden rocks and coarse material shall be placed concurrently in the excavations or stored adjacent to the

excavation, if practicable, to be used as backfill material once the ore or gravel has been excavated.

- ❖ Trenches shall be backfilled immediately if no ore or precious stone-bearing gravel can be located.

### **F 3.3.2 Rehabilitation of excavation areas**

The following operating procedures shall be adhered to:

- The excavated area must serve as a final depositing area for the placement of tailings during processing.
- Rocks and coarse material removed from the excavation must be dumped into the excavation simultaneously with the tailings.
- Waste, as described in paragraph F 2.3.2 above, will not be permitted to be deposited in the excavations.
- Once excavations have been refilled with overburden, rocks and coarse natural materials and profiled with acceptable contours and erosion control measures, the topsoil previously stored, shall be returned to its original depth over the area.
- The area shall be fertilised if necessary to allow vegetation to establish rapidly. The site shall be seeded with a local or adapted indigenous seed mix in order to propagate the locally or regionally occurring flora.
- If a reasonable assessment indicates that the re-establishment of vegetation is unacceptably slow, the Regional Manager may require that the soil be analysed and any deleterious effects on the soil arising from the mining/ prospecting operation, be corrected and the area be seeded with a vegetation seed mix to his or her specification.

## **F 3.4 PROCESSING AREAS AND WASTE PILES (DUMPS)**

### **F 3.4.1 Establishing processing areas and waste piles**

- Processing areas and waste piles shall not be established within 100 metres of the edge of any river channel or other water bodies.
- Processing areas should be established, as far as practicable, near the edge of excavations to allow the waste, gravel and coarse material to be processed therein.
- The areas chosen for this purpose shall be the minimum reasonably required and involve the least disturbance to vegetation.
- Prior to development of these areas, the topsoil shall be removed and stored as described in paragraph F 2.1 above.
- The location and dimensions of the areas are to be indicated on the layout plan and once established, the processing of ore containing precious stones shall be confined to these areas and no stockpiling or processing will be permitted on areas not correctly prepared.
- Tailings from the extraction process must be so treated and/or deposited that it will in no way prevent or delay the rehabilitation process.

### F 3.4.2 Rehabilitation of processing areas

- Coarse natural material used for the construction of ramps must be removed and dumped into the excavations.
- On completion of mining/prospecting operations, the surface of the processing areas especially if compacted due to hauling and dumping operations, shall be scarified to a depth of at least 300mm and graded to an even surface condition and the previously stored topsoil will be returned to its original depth over the area.
- Prior to replacing the topsoil the material that was removed from the processing area will be replaced in the same order as it originally occurred.
- The area shall then be fertilised if necessary to allow vegetation to establish rapidly. The site shall be seeded with a local, adapted indigenous seed mix.
- If a reasonable assessment indicates that the re-establishment of vegetation is unacceptably slow, the Regional Manager may require that the soil be analysed and any deleterious effects on the soil arising from the mining/prospecting operation be corrected and the area be seeded with a seed mix to his or her specification.

### F 3.5 TAILINGS DAM(S) (SLIMES DAM)

The permission of the Regional Manager must be obtained should a tailings dam be constructed for the purpose of handling the tailings of the mining/prospecting operations. The construction, care and maintenance of tailings dams have been regulated and the relevant regulation is copied herewith, both for your information and as a guideline to the commissioning, management, operation, closing and aftercare of a tailings deposition facility.

### **Regulation 73 promulgated under the Mineral and Petroleum Resources Development Act, 2002 (Act 28 of 2002) requires the following:**

#### **Management of residue stockpiles and deposits**

56. (1) *The assessment of impacts relating to the management of residue stockpiles and deposits, where appropriate, must form part of the environmental impact assessment report and environmental management programme or the environmental management plan.*
- (2) *Residue characterisation*
- (a) *Mine residue must be characterised to identify any potentially significant health and safety hazard and environmental impact that may be associated with the residue when stockpiled or deposited at the site(s) under consideration.*
- (b) *Residue stockpiles and deposits must be characterised in terms of its –*
- (i) *physical characteristics, which may include –*
- (aa) *the size distribution of the principal constituents;*
- (bb) *the permeability of the compacted material;*
- (cc) *void ratios of the compacted material;*
- (dd) *the consolidation or settling characteristics of the material under its own weight and that of any overburden;*
- (ee) *the strength of compacted material;*
- (ff) *the specific gravity of the solid constituents; and*



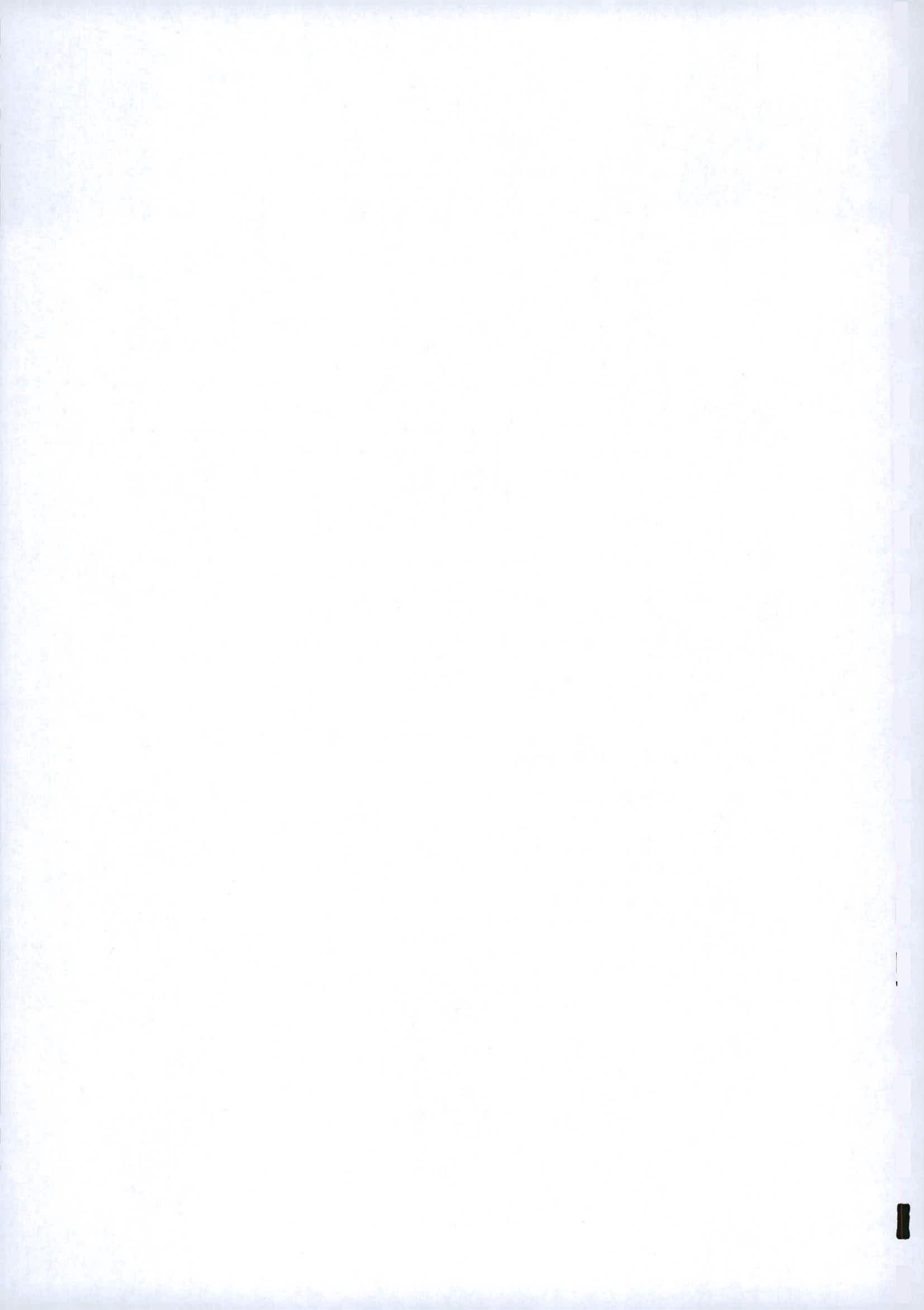

- (gg) *the water content of the material at the time of deposition, after compaction, and at other phases in the life of the deposit.*
- (ii) *chemical characteristics, which may include -*
- (aa) *the toxicity;*
  - (bb) *the propensity to oxidize and /or decompose;*
  - (cc) *the propensity to undergo spontaneous combustion;*
  - (dd) *the pH and chemical composition of the water separated from the solids;*
  - (ee) *stability and reactivity and the rate thereof; and*
  - (ff) *neutralising potential.*
- (iii) *mineral content, which include the specific gravity of the residue particles and its impact on particle segregation and consolidation;*
- (3) *Classification of residue stockpiles and deposits*
- (a) *All residue stockpiles and deposits must be classified into one or a combination of the following categories –*
- (i) *the safety classification to differentiate between residue stockpiles and deposits of high, medium and low hazard on the basis of their potential to cause harm to life or property; and*
  - (ii) *the environmental classification to differentiate between residue stockpiles and deposits with -*
    - (aa) *a potentially significant impact on the environment due to its spatial extent, duration and intensity of potential impacts; or*
    - (bb) *no potentially significant impact on the environment.*
- (b) *All mine residue stockpiles and deposits must be classified by a suitably qualified person(s).*
- (c) *The classification of residue stockpiles and deposits shall determine the –*
- (i) *level of investigation and assessment required;*
  - (ii) *requirements for design, construction, operation, decommissioning, closure and post closure maintenance; and*
  - (iii) *qualifications and expertise required of persons undertaking the investigations, assessments, design, construction thereof.*
- (d) *The safety classification of residue stockpiles and deposits shall be based on the following criteria –*

<i>Number of residents in zone of influence</i>	<i>Number of workers in zone of influence</i>	<i>Value of third party property in zone of influence</i>	<i>Depth to underground mine workings</i>	<i>Classification</i>
<i>0</i>	<i>&lt; 10</i>	<i>0 – R2 m</i>	<i>&gt; 200m</i>	<i>Low hazard</i>
<i>1 – 10</i>	<i>11 – 100</i>	<i>R 2 m – R20 m</i>	<i>50 m – 200 m</i>	<i>Medium hazard</i>
<i>&gt; 10</i>	<i>&gt; 100</i>	<i>&gt; R20 m</i>	<i>&lt; 50 m</i>	<i>High hazard</i>

- (e) *A risk analysis must be carried out and documented on all high hazard residue stockpiles and deposits.*
- (f) *The environmental classification of residue stockpiles and deposits must be undertaken on the basis of –*
- (i) *the characteristics of the residue;*
  - (ii) *the location and dimensions of the deposit (height, surface area);*
  - (iii) *the importance and vulnerability of the environmental components that are at risk; and*
  - (iv) *the spatial extent, duration and intensity of potential impacts.*

- (g) *An assessment of the environmental impacts shall be done on all environmental components which are significantly affected.*
  - (h) *The assessment of impacts and analyses of risks shall form part of the environmental assessment and management programme.*
- (4) *Site selection and investigation:*
- (a) *The process of investigation and selection of a site must entail -*
    - (i) *the identification of a sufficient number of possible candidate sites to ensure adequate consideration of alternative sites;*
    - (ii) *qualitative evaluation and ranking of all alternative sites;*
    - (iii) *qualitative investigation of the top ranking sites to review the ranking done in (ii);*
    - (iv) *a feasibility study to be carried out on the highest ranking site(s), involving -*
      - (aa) *a preliminary safety classification;*
      - (bb) *an environmental classification;*
      - (cc) *geotechnical investigations; and*
      - (dd) *groundwater investigations.*
  - (b) *The geotechnical investigations may include-*
    - (i) *the characterization of the soil profile over the entire area to be covered by the residue facility and associated infrastructure to define the spatial extent and depth of the different soil horizons;*
    - (ii) *the characterization of the relevant engineering properties of foundations soils and the assessment of strength and drainage characteristics.*
  - (c) *The groundwater investigations may include-*
    - (i) *the potential rate of seepage from the residue facility;*
    - (ii) *the quality of such seepage;*
    - (iii) *the geohydrological properties of the strata within the zone that could potentially be affected by the quality of seepage;*
    - (iv) *the vulnerability and existing potential use of the groundwater resource within the zone that could potentially be affected by the residue facility.*
  - (d) *From these investigations, a preferred site must be identified.*
  - (e) *Further investigation on the preferred site, shall include -*
    - (i) *land use;*
    - (ii) *topography and surface drainage;*
    - (iii) *infrastructure and man-made features;*
    - (iv) *climate;*
    - (v) *flora and fauna;*
    - (vi) *soils;*
    - (vii) *ground water morphology, flow, quality and usage; and*
    - (viii) *surface water.*
  - (f) *The investigations, laboratory test work, interpretation of data and recommendations for the identification and selection of the most appropriate and suitable site for the disposal of all residue that have the potential to generate leachate that could have a significant impact on the environment and groundwater must be carried out by a suitably qualified person.*

- (5) *Design of residue stockpile and deposit*
- (a) *The design of the residue stockpile and deposit shall be undertaken by a suitably qualified person.*
- (b) *An assessment of the typical soil profile on the site is required for residue stockpiles and deposits which -*
- (i) *have a low hazard potential; and*
  - (ii) *have no significant impact on the environment.*
- (c) *The design of the residue stockpile and deposit must take into account all phases of the life cycle of the stockpile and deposit, from construction through to closure and must include -*
- (i) *the characteristics of the mine residue;*
  - (ii) *the characteristics of the site and the receiving environment;*
  - (iii) *the general layout of the stockpile or deposit, whether it is a natural valley, ring dyke, impoundment or a combination thereof and its 3-dimensional geometry at appropriate intervals throughout the planned incremental growth of the stockpile or deposit;*
  - (iv) *the type of deposition method used; and*
  - (v) *the rate of rise of the stockpile or deposit.*
- (d) *Other design considerations, as appropriate to the particular type of stockpile and deposit must be incorporated -*
- (i) *the control of storm water on and around the residue stockpile or deposit by making provision for the maximum precipitation to be expected over a period of 24 hours with a frequency of once in a 100 years, in accordance with the regulations made under section 8 of the National Water Act, 1998;*
  - (ii) *the provision, throughout the system, of a freeboard of at least 0.5 m above the expected maximum water level, in accordance with regulations made under the National Water Act, 1998, to prevent overtopping;*
  - (iii) *keeping the pool away from the walls; where there are valid technical reasons for deviating from this, adequate motivation must be provided and the design must be reviewed by a qualified person as required in terms of sections 9(6) or 9(7) of the Mine Health and Safety Act, 1996;*
  - (iv) *the control of decanting of excess water under normal and storm conditions;*
    - (aa) *the retention of polluted water in terms of polluted water in terms of GN R991(9), where measures may be required to prevent water from the residue deposit from leaving the residue management system unless it meets prescribed requirements;*
    - (bb) *the design of the penstock, outfall pipe, under-drainage system and return water dams;*
    - (cc) *the height of the phreatic surface, slope angles and method of construction of the outer walls and their effects on shear stability;*
    - (dd) *the erosion of slopes by wind and water, and its control by (ee)*
    - (ee) *vegetation, berms or catchment paddocks; and*
    - (ee) *the potential for pollution.*
- (e) *A design report and operating manual shall be drawn up for all residue stockpiles and deposits which -*
- (i) *have a medium to high hazard; and*
  - (ii) *have a potentially significant impact on the environment.*
- (f) *Relevant information must be included in the draft environmental management programme or environmental management plan.*

(6) *Construction and operation of residue deposits:*

- (a) *The holder of any right or permit in terms of the Act, must ensure that-*
- (i) *the residue deposits, including any surrounding catchment paddocks, is constructed and operated in accordance with the approved environmental management programme or environmental management plan;*
  - (ii) *the design of the residue deposit is followed implicitly throughout the construction thereof, and that any deviations from the design be approved by the Regional Manager and the environmental management programme and environmental management plan be amended accordingly;*
  - (iii) *as part of the monitoring system, measurements of all residues transported to the site and of all surplus water removed from the site are recorded;*
  - (iv) *the provision for appropriate security measures be implemented to limit unauthorised access to the site and intrusion into the residue deposit;*
  - (v) *specific action be taken in respect of any sign of pollution;*
  - (vi) *adequate measures be implemented to control dust pollution and erosion of the slopes; and*
  - (vii) *details of rehabilitation of the residue deposit be provided in the draft environmental management programme or environmental management plan.*
- (b) *A system of routine maintenance and repair in respect of the residue deposit must be implemented to ensure the ongoing control of pollution, the integrity of rehabilitation and health and safety matters at the site.*

(7) *Monitoring of residue stockpiles and deposits:*

- (a) *A monitoring system for residue stockpiles and deposits with respect to potentially significant impacts as identified in the environmental assessment must be included in the environmental management programme or environmental management plan.*
- (b) *In the design of a monitoring system for a residue stockpile or deposit, consideration must be given to –*
- (i) *baseline and background conditions with regard to air, surface and groundwater quality ;*
  - (ii) *the air, surface and groundwater quality objectives;*
  - (iii) *residue characteristics;*
  - (iv) *the degree and nature of residue containment;*
  - (v) *the receiving environment and specifically the climatic, local geological, hydrogeological and geochemical conditions;*
  - (vi) *potential migration pathways;*
  - (vii) *potential impacts of leachate;*
  - (viii) *the location of monitoring points and the prescribed monitoring protocols; and*
  - (ix) *the reporting frequency and procedures.*

(8) *Decommissioning, closure and after care:*

- (a) *The decommissioning, closure and post closure management of residue deposits must be addressed in the closure plan, which must contain the following -*
- (i) *the environmental classification, including assumptions on which the classification were based;*
  - (ii) *the closure objectives, final land use or capability;*
  - (iii) *conceptual description and details for closure and post closure management;*
  - (iv) *cost estimates and financial provision for closure and post-closure management; and*
  - (v) *residual impacts, monitoring and requirements to obtain mine closure in terms of the Act.*

### F 3.6 FINAL REHABILITATION

- All infrastructure, equipment, plant, temporary housing and other items used during the mining period will be removed from the site (section 44 of the MPRDA)
- Waste material of any description, including receptacles, scrap, rubble and tyres, will be removed entirely from the mining area and disposed of at a recognised landfill facility. It will not be permitted to be buried or burned on the site.
- Final rehabilitation shall be completed within a period specified by the Regional Manager.

### F 4 MONITORING AND REPORTING

#### F 4.1 Inspections and monitoring

- Regular monitoring of all the environmental management measures and components shall be carried out by the holder of the prospecting right, mining permit or reconnaissance permission in order to ensure that the provisions of this programme are adhered to.
- Ongoing and regular reporting of the progress of implementation of this programme will be done.
- Various points of compliance will be identified with regard to the various impacts that the operations will have on the environment.
- Inspections and monitoring shall be carried out on both the implementation of the programme and the impact on plant and animal life.
- Visual inspections on erosion and physical pollution shall be carried out on a regular basis.

**Regulation 55 promulgated in terms of the MPRDA requires the following:**

**Monitoring and performance assessments of environmental management programme or plan**

- (1) *As part of the general terms and conditions for a prospecting right, mining right or mining permit and in order to ensure compliance with the approved environmental management programme or plan and to assess the continued appropriateness and adequacy of the environmental management programme or plan, the holder of such right must-*
  - (a) *conduct monitoring on a continuous basis;*
  - (b) *conduct performance assessments of the environmental management programme or plan as required; and*
  - (c) *compile and submit a performance assessment report to the Minister to demonstrate adherence to sub-regulation (b).*
- (2) *The frequency of performance assessment reporting shall be-*
  - (a) *in accordance with the period specified in the approved environmental management programme or plan, or, if not so specified;*
  - (b) *as agreed to in writing by the Minister; or*
  - (c) *biennially (every two years).*
- (3) *The performance assessment report, shall be in the format provided in guidelines that will from time to time be published by the Department and shall as a minimum contain-*
  - (a) *information regarding the period that applies to the performance assessment;*
  - (b) *the scope of the assessment;*

- (c) *the procedure used for the assessment;*
  - (d) *the interpreted information gained from monitoring the approved environmental management programme or plan;*
  - (e) *the evaluation criteria used during the assessment;*
  - (f) *the results of the assessment; and*
  - (g) *recommendations on how and when deficiencies that are identified and/or aspects of non-compliance will be rectified.*
- (4) *The holder of a prospecting right, mining right or mining permit may appoint an independent qualified person(s) to conduct the performance assessment and compile the performance assessment report provided that no such appointment shall relieve the holder of the responsibilities in terms of these regulations.*
- (5) *Subject to section 30(2) of the Act, the performance assessment report submitted by the holder shall be made available by the Minister to any person on request.*
- (6) *If upon consideration by the Minister, the performance assessment executed by the holder is not satisfactory or the report submitted by the holder is found to be unacceptable, the holder must-*
- (a) *repeat the whole or relevant parts of the performance assessment and revise and resubmit the report; and/or*
  - (b) *submit relevant supporting information; and/or*
  - (c) *appoint an independent competent person(s) to conduct the whole or part of the performance assessment and to compile the report.*
- (7) *If a reasonable assessment indicates that the performance assessment cannot be executed satisfactorily by the holder or a competent person(s) appointed by the holder, the Minister may appoint an independent performance assessment person(s) to conduct such performance assessment. Such appointment and execution shall be for the cost of the holder.*
- (8) *When the holder of a prospecting right, mining right or mining permit intends closing such operation, a final performance assessment shall be conducted and a report submitted to the Minister to ensure that -*
- (a) *the requirements of the relevant legislation have been complied with;*
  - (b) *the closure objectives as described in the environmental management programme or plan have been met; and*
  - (c) *all residual environmental impacts resulting from the holder's operations have been identified and the risks of latent impacts which may occur have been identified, quantified and arrangements for the management thereof have been assessed.*
- (9) *The final performance assessment report shall either precede or accompany the application for a closure certificate in terms of the Act.*

#### **F 4.2 Compliance reporting / submission of information**

- Layout plans will be updated on a regular basis and updated copies will be submitted on a biennial basis to the Regional Manager A
- Reports confirming compliance with various points identified in the environmental management programme will be submitted to the Regional Manager on a regular basis and as decided by the said manager .
- Any emergency or unforeseen impact will be reported as soon as possible.
- An assessment of environmental impacts that were not properly addressed or were unknown when the programme was compiled shall be carried out and added as a corrective action.

## F 5 CLOSURE

When the holder of a prospecting right, mining permit or reconnaissance permission intends closing down his/her operations, an environmental risk report shall accompany the application for closure. The requirements of such a risk report is contained in Regulation 60 of the Regulations promulgated in terms of the Act and is quoted below :

### F 5.1 ENVIRONMENTAL RISK REPORT

*"An application for a closure certificate must be accompanied by an environmental risk report which must include-*

- (a) *the undertaking of a screening level environmental risk assessment where-*
  - (i) *all possible environmental risks are identified, including those which appear to be insignificant;*
  - (ii) *the process is based on the input from existing data;*
  - (iii) *the issues that are considered are qualitatively ranked as –*
    - (aa) *a potential significant risk; and/or*
    - (bb) *a uncertain risk; and/or*
    - (cc) *an insignificant risk.*
- (b) *the undertaking of a second level risk assessment on issues classified as potential significant risks where-*
  - (i) *appropriate sampling, data collection and monitoring be carried out;*
  - (ii) *more realistic assumptions and actual measurements be made; and*
  - (iii) *a more quantitative risk assessment is undertaken, again classifying issues as posing a potential significant risk or insignificant risk.*
- (c) *assessing whether issues classified as posing potential significant risks are acceptable without further mitigation;*
- (d) *issues classified as uncertain risks be re-evaluated and re-classified as either posing potential significant risks or insignificant risks;*
- (e) *documenting the status of insignificant risks and agree with interested and affected persons;*
- (f) *identifying alternative risk prevention or management strategies for potential significant risks which have been identified, quantified and qualified in the second level risk assessment;*
- (g) *agreeing on management measures to be implemented for the potential significant risks which must include-*
  - (i) *a description of the management measures to be applied;*
  - (ii) *a predicted long-term result of the applied management measures;*
  - (iii) *the residual and latent impact after successful implementation of the management measures;*
  - (iv) *time frames and schedule for the implementation of the management measures;*
  - (v) *responsibilities for implementation and long-term maintenance of the management measures;*
  - (vi) *financial provision for long-term maintenance; and*
  - (vii) *monitoring programmes to be implemented."*

### F 5.2 CLOSURE OBJECTIVES

Closure objectives form part of this EMP plan and must-

- (a) identify the key objectives for mine closure to guide the project design, development and management of environmental objectives;
- (b) provide broad future land use objective(s) for the site; and
- (c) provide proposed closure cost



### **F 5.3 CONTENTS OF CLOSURE PLAN**

A closure plan forms part of the EMP and must include the following:

- (a) a description of the closure objectives and how these relate to the prospecting or mine operation and its environmental and social setting;
- (b) a plan contemplated in Regulation 2(2), coordinated according to generally accepted standards, showing the land or area under closure;
- (c) a summary of the regulatory requirements and conditions for closure negotiated and documented in the environmental management programme or plan;
- (d) a summary of the results of the environmental risk report and details of identified residual and latent impacts;
- (e) a summary of the results of progressive rehabilitation undertaken;
- (f) a description of the methods to decommission each prospecting or mining component and the mitigation or management strategy proposed to avoid, minimize and manage residual or latent impacts;
- (g) details of any long-term management and maintenance expected;
- (h) details of financial provision for monitoring, maintenance and post closure management, if required;
- (i) a plan or sketch at an appropriate scale describing the final land use proposal and arrangements for the site;
- (j) a record of interested and affected persons consulted; and
- (k) technical appendices, if any.

### **F 5.4 TRANSFER OF ENVIRONMENTAL LIABILITIES TO A COMPETENT PERSON**

Should the holder of a prospecting right, mining permit or reconnaissance permission wish to transfer any environmental liabilities and responsibilities to another person or persons, the following will pertain:

- (1) An application to transfer environmental liabilities to a competent person in terms of section 48) of the Act, must be completed on Form O as set out in Annexure 1 to the Regulations and be lodged to the Minister for consideration.
- (2) The holder of a prospecting right, mining right or mining permit may transfer liabilities and responsibilities as identified in the environmental management plan and the required closure plan to a competent person as contemplated in Regulation 58.
- (3) When considering the transfer of environmental liabilities and responsibilities in terms of section 48) of the Act, the Minister must consult with any State department which administers any law relating to matters affecting the environment.
- (4) No transfer of environmental liabilities and responsibilities to a competent person may be made unless the Chief Inspector of Mines and the Department of Water Affairs and Forestry have confirmed in writing that the person to whom the liabilities and responsibilities is transferred to, have the necessary qualifications pertaining to health and safety and management of potential pollution of water resources.

## F 5.5 NOTES ON LEGAL PROVISIONS

<b>NOTE:</b>	The holder of a prospecting right, mining permit or reconnaissance permission must also take cognisance of the provisions of other legislation dealing with matters relating to conservation, and which include, <i>inter alia</i> , the following:
*	National Monuments Act, 1969 (Act 28 of 1969).
*	National Parks Act, 1976 (Act 57 of 1976)
*	Environmental Conservation Act, 1989 (Act 73 of 1989)
*	National Environmental Management Act, 1998 (Act No. 107 of 1998)
*	Atmospheric Pollution Prevention Act, 1965 (Act 45 of 1965)
*	The National Water Act, 1998 (Act 36 of 1998)
*	Mine Safety and Health Act, 1996 (Act 29 of 1996)
*	The Conservation of Agricultural Resources Act, 1983 (Act 43 of 1983).

## G. SPECIFIC ADDITIONAL REQUIREMENTS DETERMINED BY THE REGIONAL MANAGER.

Officials in regional offices may use the following matrix to determine the necessity for additional objectives to be included in this Section of the document:

POTENTIAL ENVIRONMENTAL IMPACTS OF MINING										
Activity	Disturbance					Pollution				Visual
	Landform	Soil	Flora	Fauna	Heritage	Land	Water	Air	Noise	
Mining										
Access										
Topsoil removal										
Overburden removal										
Mineral Extraction										
Tailings disposal										
Water Abstraction										
Pipeline route										
Transport										
Accommodation										
Waste Disposal										
Electricity										
Hydrocarbon storage										
Workforce										

Please indicate VL, L, M, H, and VH for Very Low, Low, Medium, high and Very High in each column to determine the main area and severity of impact.



**J. APPROVAL**

Approved in terms of Section 39(4) of the Mineral and Petroleum Resources Development Act, 2002 (Act 29 of 2002)

Signed at.....this.....day of.....20.....

.....  
**REGIONAL MANAGER**

**REGION:**.....

This document has been compiled by the Directorate: Mine Environmental Management of the Department of Minerals and Energy at their Head Office in Pretoria. Any comments, suggestions or inputs will be sincerely appreciated. If you have any comments or suggestions regarding this document or its application, please forward your contribution to:

The Director: Mine Environmental Management  
Private Bag X 59  
PRETORIA  
0001  
E-mail: [dorothy@mepta.pwv.gov.za](mailto:dorothy@mepta.pwv.gov.za)

Tel : 012 317 9288  
Fax: 012 320 6786

**Appendix 1: Drawings**

CO-ORDINATES WGS 27°		
	Y	X
A	-30390.39	3676828.08
B	-30888.67	3677130.70
C	-32464.36	3676716.96
D	-33266.08	3676712.16
E	-33271.26	3678590.28
F	-32079.60	3679945.38
G	-31830.37	3680622.51

The application area is represented by coordinates  
 A B C D E F G middle of Nyulutsi River  
 and is 696,6660 Ha in extent.

The approximate centre point of the application area is  
 27° 21' 25"E 33° 13' 56" S

Property Description	Area (Ha)
Rem of the Farm Wicklow No. 117	449,9848
Rem of Portion 1 of the Farm Wicklow No. 117	188,5391
Rem of Portion 2 of the Farm Wicklow No. 117	58,0141
Portion 3 (of 2) of the Farm Wicklow No. 117	0,1280
<b>TOTAL</b>	<b>696,6660</b>

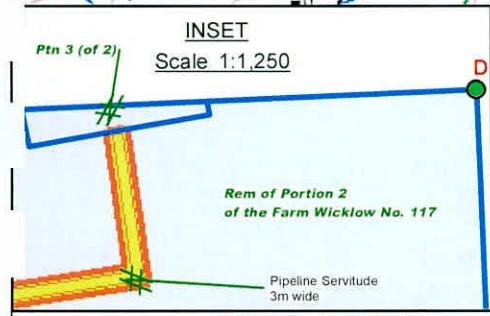
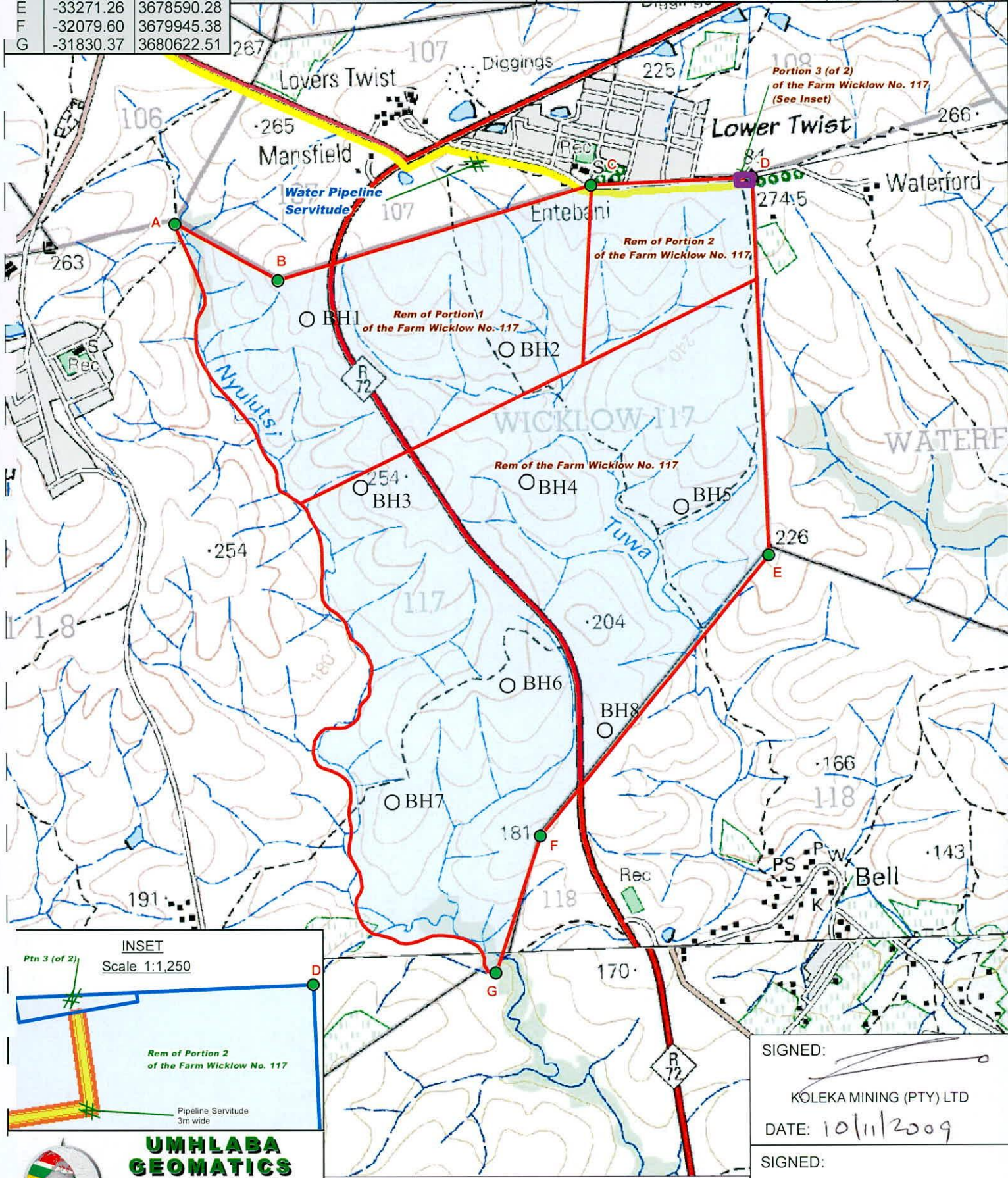

**UMHLABA GEOMATICS**

"Turning DATA into INFORMATION"

E-mail: garren@umhlabageomatics.co.za  
 Tel: (034) 212 3195 • Fax: (034) 218 1886  
 PO Box 56 Dundee • 84 Gladstone St Dundee

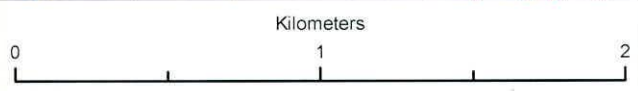

SIGNED: \_\_\_\_\_  
 KOLEKA MINING (PTY) LTD

DATE: 10/11/2009

SIGNED: \_\_\_\_\_

Regional Manager  
 Eastern Cape

DATE: \_\_\_\_\_



Rem of the Farm Wicklow No. 117  
Rem of Portion 1 of the Farm Wicklow No. 117  
Rem of Portion 2 of the Farm Wicklow No. 117  
Portion 3 (of 2) of the Farm Wicklow No. 117



**UHLABA  
GEOMATICS**  
"Turning DATA into INFORMATION"  
• E-mail: garren@uhlaba-geomatics.co.za  
• Tel: (034) 212 3195 • Fax: (034) 218 1866  
• PO Box 56 Dundee • 84 Gladstone St Dundee

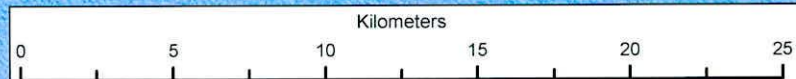

**PROPOSED BOREHOLES  
(YEAR 1 & 2)**

<b>BOREHOLE ID</b>	<b>LATITUDE</b>	<b>LONGITUDE</b>
BH1	33 <sup>0</sup> 13'12"	27 <sup>0</sup> 19'56"
BH2	33 <sup>0</sup> 13'23"	27 <sup>0</sup> 20'35"
BH3	33 <sup>0</sup> 13'51"	27 <sup>0</sup> 20'19"
BH4	33 <sup>0</sup> 13'44"	27 <sup>0</sup> 20'38"
BH5	33 <sup>0</sup> 13'49"	27 <sup>0</sup> 21'07"
BH6	33 <sup>0</sup> 14'15"	27 <sup>0</sup> 20'34"
BH7	33 <sup>0</sup> 14'33"	27 <sup>0</sup> 20'12"
BH8	33 <sup>0</sup> 14'25"	27 <sup>0</sup> 20'53"



## Appendix 2: Environmental Risk Assessment

### 1. Introduction

This risk assessment is based on Koleka Mining's understanding of the proposed prospecting activities, Koleka Mining's knowledge of risks typically associated with drilling, and on knowledge of the area etc.

### 2. Identification of Risks and proposed mitigation measures

#### General prospecting activity risks table

Risk	Cause	Controls / Mitigation Actions
Veld fires	Smoking and discarding matches in the field	Maintain visual awareness of surroundings; smoking only in designated areas; keep a fire extinguisher on Site
Property damage	Reckless driving; driving over bushes and shrubs; driving over pavements	Follow existing roads and / or tracks; maintain visual awareness of surroundings
Damage to field equipment and tools	Vehicles getting stuck in loose sands	Follow existing roads and / or tracks; maintain visual awareness of surroundings
Stock / agricultural produce theft / hunting by employees	Trespassing of employees onto agricultural land	Staff will not live on site, will be supervised at all times
Erosion of site	Trampling by employees and vehicles	Personnel will be restricted to 25 metre radius of each borehole, away from gullies, wetlands and river banks
Damage to vegetation	Off-road driving to borehole sites	Where off-road driving is necessary, attempts to follow fence lines and animal tracks will be made at every possible opportunity
Erosion of existing roads	More frequent use of roads	Speed limits of 40km/h will be maintained at all times by vehicles, dust suppression monthly
Noise disturbance to residents and indigenous fauna	Drilling operations and vehicle traffic	Drilling times will be minimised and kept to working hours when residents are at work / school (away from sites)

**Drilling activity risks table**

<b>Risk</b>	<b>Cause</b>	<b>Controls / Mitigation Actions</b>
Spreading of excavated soil around drill (3m radius)	Nature of percussion drilling	Ground flattened / restored to original slope
Filling up of boreholes from surface material	Open borehole surface	Primary and secondary screens on surface of borehole
Property damage	Reckless driving; driving over bushes and shrubs; driving over pavements	Follow existing roads and / or tracks; maintain visual awareness of surroundings
Contaminating the surrounding soil	Leaking and / spilling oil from drilling equipment and tools; gas escaping from tools	Use drip trays and plastic sheets where necessary; check all equipment and tools for chips, cracks, loose bolts, loose screws, etc.
Veld fires	Smoking and discarding matches in the field	Maintain visual awareness of surroundings; smoking only in designated areas; keep a fire extinguisher on Site
Animals falling into the boreholes	Unattended boreholes not covered or protected	All unattended boreholes must be adequately covered and protected immediately upon completion of drilling
Damage to field equipment and tools	Vehicles getting stuck in loose sands	Follow existing roads and / or tracks; maintain visual awareness of surroundings
Contamination of groundwater	Hydrocarbon leaks or spills	Drip trays and absorbent linings will be placed under the rig during operations at each borehole

### Appendix 3: Notes on Impacts

#### Assessment of impacts table

POTENTIAL ENVIRONMENTAL IMPACTS OF PROSPECTING										
Activity	Disturbance					Pollution				Visual
	Landform	Soil	Flora	Fauna	Heritage	Land	Water	Air	Noise	
Prospecting	N/A	M	L	VL	N/A	VL	VL	VL	M	L
Access	N/A	L	L	L	N/A	VL	N/A	L	L	VL
Topsoil removal	N/A	M	L	L	N/A	L	VL	VL	N/A	L
Transport	N/A	L	M	M	N/A	L	N/A	L	L	L
Waste Disposal	N/A	L	L	L	N/A	L	L	N/A	N/A	L
Hydrocarbon storage	N/A	L	L	VL	N/A	L	VL	N/A	N/A	L
Workforce	N/A	M	L	VL	N/A	N/A	L	L	L	N/A

*Please indicate VL, L, M, H, and VH for Very Low, Low, Medium, high and Very High in each column to determine the main area and severity of impact.*

### Appendix 4: Financial planning for rehabilitation costs

Action	Area/Comment	Quantity	(Units)	Unit Cost	Total Cost
<b>Cost of Ongoing Rehabilitation</b>					
<b>1. Topsoil Collection &amp; Stockpiling</b>					
	8 boreholes, estimated at 3m <sup>2</sup> per borehole, and 300mm depth of topsoil (quantity in m <sup>2</sup> )	24	m <sup>3</sup>	R 100.00	R 2,400.00
<b>2. Closing of Boreholes</b>					
2.1 Backfilling with fines	Fill borehole with excess fines (quantity per day labour, for all 6 boreholes)	8	boreholes	R 100.00	R 800.00
2.2 Concrete cap	Construct (subsurface) concrete cap to seal each borehole	8	caps	R 400.00	R 2,400.00
2.3 Topsoil replacement	Cover with topsoil, level, and water	8	boreholes	R 240.00	R 1,920.00
2.4 Planting	none - rely on seeding, and on encroachment from adjoining vegetation	0	boreholes	R 0.00	R 0.00
2.5 Seeding	Seed with indigenous grass seed mix (primarily cynodon dactylon)	200	m <sup>2</sup>	R 10.00	R 2,000.00
2.6 Irrigation	Initial watering for a period of 4 weeks to encourage germination	4	watering rounds	R 500.00	R 2,000.00
2.7 Monitoring for declared weeds (for a period of 6 months)	Monthly visit to each site and removal of declared weeds	6	monthly monitoring rounds	R 500.00	R 3,000.00
<b>TOTAL COST</b>					<b>R 14,520.00</b>

Notes: All earth moving to be by hand (due to small volumes involved)