

TYPICAL FIRST STOREY PLAN / SECOND STOREY PLAN (1 : 100)

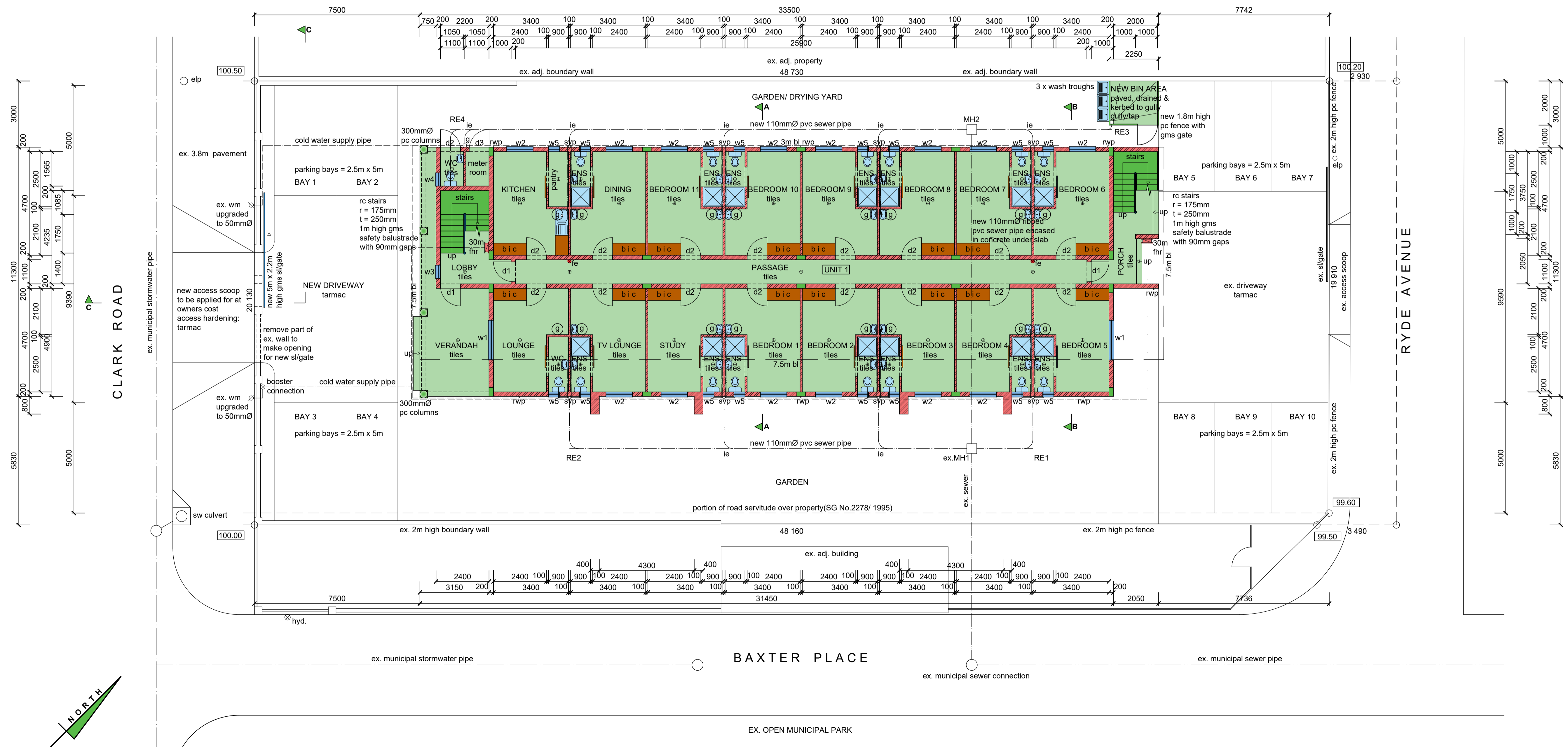

GROUND STOREY PLAN / SITE PLAN (1 : 100)

Total Area = 1 397.50 m²
 Client Signature: *[Signature]* Contact Number: 068 023 2484
 Rate No. 1042 6048 / 000

PROPOSED NEW MULTI-STOREY RESIDENTIAL DEVELOPMENT AT 26-32 CLARK ROAD ON REM OF ERF 6325 DURBAN FOR N. DLAMINI

GRAHAM BRAUM
 ARCHITECTURAL DESIGNER
 Pr. S. Arch. T
 Reg. No. ST0010
 360 Umbilo Road Durban 4001
 Tel.: 031-2054142 Cell: 082 454 0441
 Email: gpbdesigners@gmail.com

SCALE : 1 : 100
 CHECKED : G. P. BRAUM
 DRAWN/DESIGNED : M. R. AZMUTH
 DATE : NOVEMBER 2022
 Drawing No. : 6679/ 22/ 1of4/ rev1