

SUB-DIVISIONAL DIAGRAM
Sect. 24 (b), Act No. 9 of 1927

S.G. No. 1874/4

SIDES. ENGLISH FEET		ANGLES OF DIRECTION:		ADD 10,000,000 TO ALL X's. CO-ORDINATES Y X	
AB	63.00	A	70.49.30		
BC	219.80	B	108.16.30		
CD	87.02	C	41.00.20		
DA	173.92	D	139.53.40		

Approved
A. B. Bunnard
Surveyor General.
- 2 OCT 1941

GENERAL PLAN No. 59x16

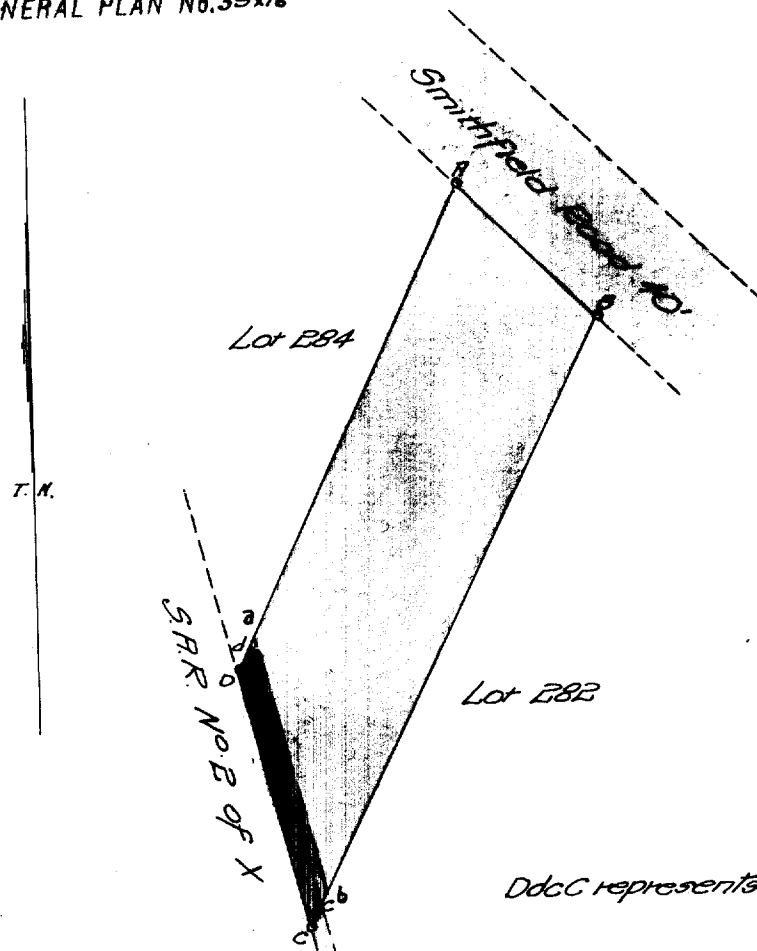

Description of Beacons.

ABCD are 3/4" pipes.

Reg. Div.
FU

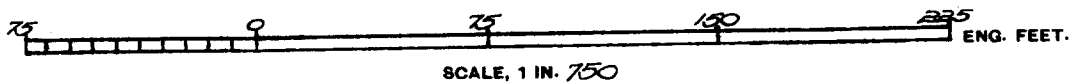

The figure A. B. C. D.

represents

11449 sq. ft.

of land being

Lot E83 Kenville Township Extension No. 1

situate in the ¹¹⁰County of Durban, County of Victoria, Province of Natal.

Surveyed in

I hereby certify that this survey was performed by M. G. E. Maffioni in February 1938 & the positions of the beacons are in agreement with the above data.

A. B. Bunnard
Land Surveyor

This diagram relates to <i>D/T</i> No. <i>834/1942</i> <i>dd. 21.2.42</i> (Sgd.) <i>D. J. v. Aswegen</i> f. Registrar of Deeds.	Original diagram is <i>S.V.</i> No. <i>375/43</i> relating to Deed of <i>Tfr.</i> No. <i>2319/1913</i>	File No. <i>1213/2/6</i> Survey Records <i>SSS</i> Tracing Degree Sheet <i>59.FU:</i> Compilation General Plan <i>59x16</i>
---	---	--

Examination Fee
£ *10s* / d. Paid

CONSECUTIVE NUMBERING ADOPTED
Last number allocated

SG 1874/1941

The S.D. Sect. left a b.c.d.
10' WIDE HAS BEEN LAID DOWN AS SHOWN
S.D. No. DATE *7.2.68*

J. Cundick
S.D. SURVEYOR
05 73/1968