

Approved

M. Boonzein
Surveyor General.
22 NOV 1938

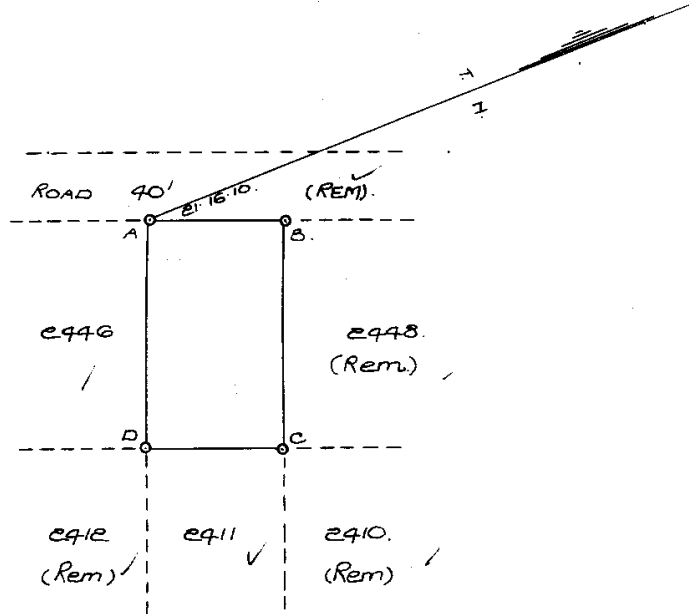

Reg. Div.
FU

Now LOT 1299 DURBAN NORTH

Sides.		Angles.	
AB	80.00	A	90.0.0
BC	137.00	B	90.0.0
CD	80.00	C	90.0.0
DA	137.00	D	90.0.0



SCALE OF FEET

The Figure A. B. C. D. Represents 1 Road Area 0.26 Acres / Perches Square Feet
of land called Lot e947 of Lot 13 N^o 1546.

City of Durban
situate in the County of Victoria,

Province of Natal.

Surveyed in Oct. 1928 / June 1926, by me

Alfred Jorgensen
Land Surveyor

This Diagram is annexed to Deed of Transfer, No. 4280/1940, dated 3/9/1940. (Sigd) R. Walters Registrar of Deeds	Original diagram is annexed to Deed of Grant, No. 1546, dated 27. Aug., 1847. G Sub. Vol. 36 Fol. 26.	File No. 898/1 Survey Records T. 719. Tracing Degree Sheet FU-7A-62-4
--	--	---