

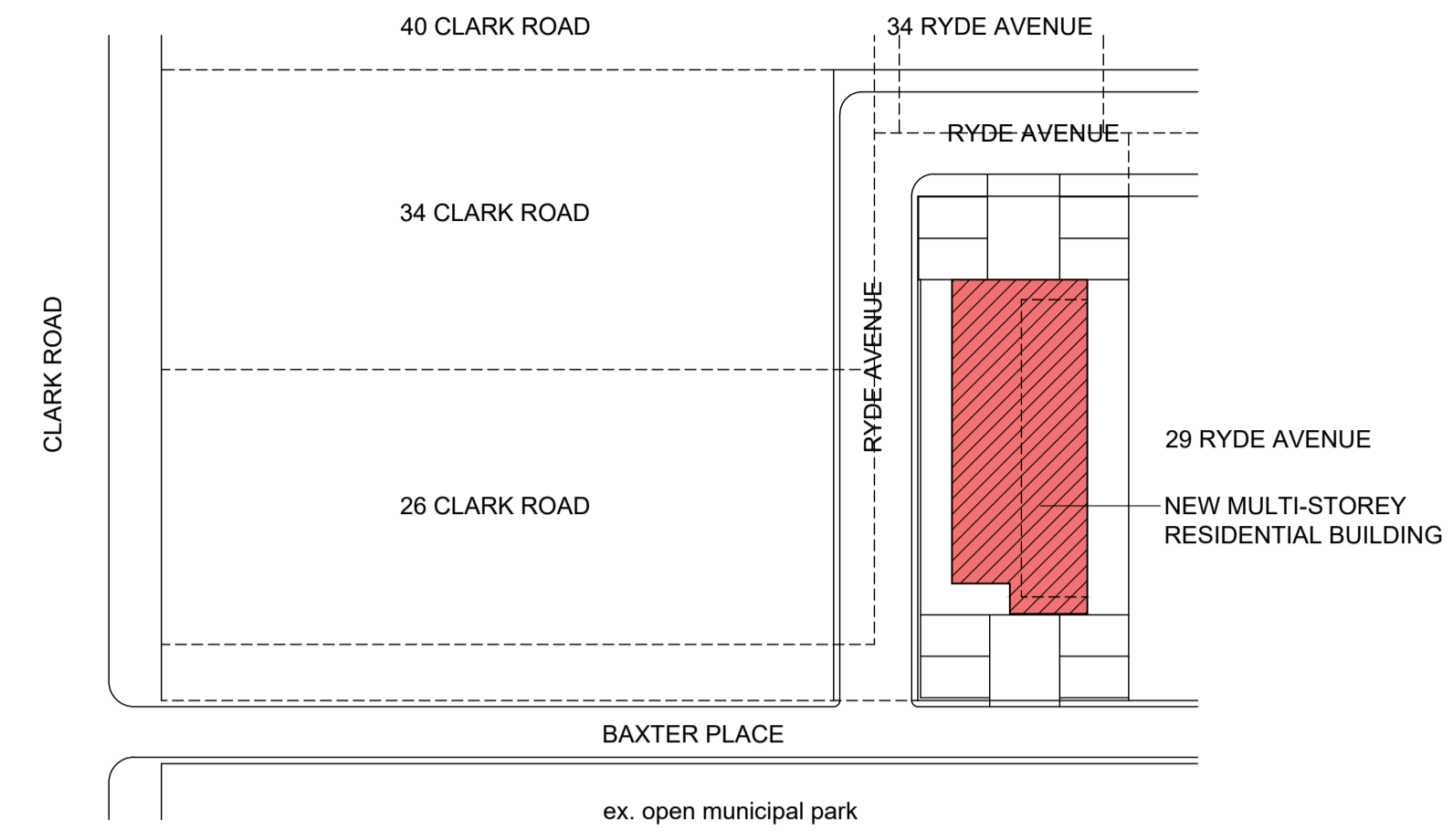

GROUND STOREY PLAN/ SITE PLAN (1 : 100)

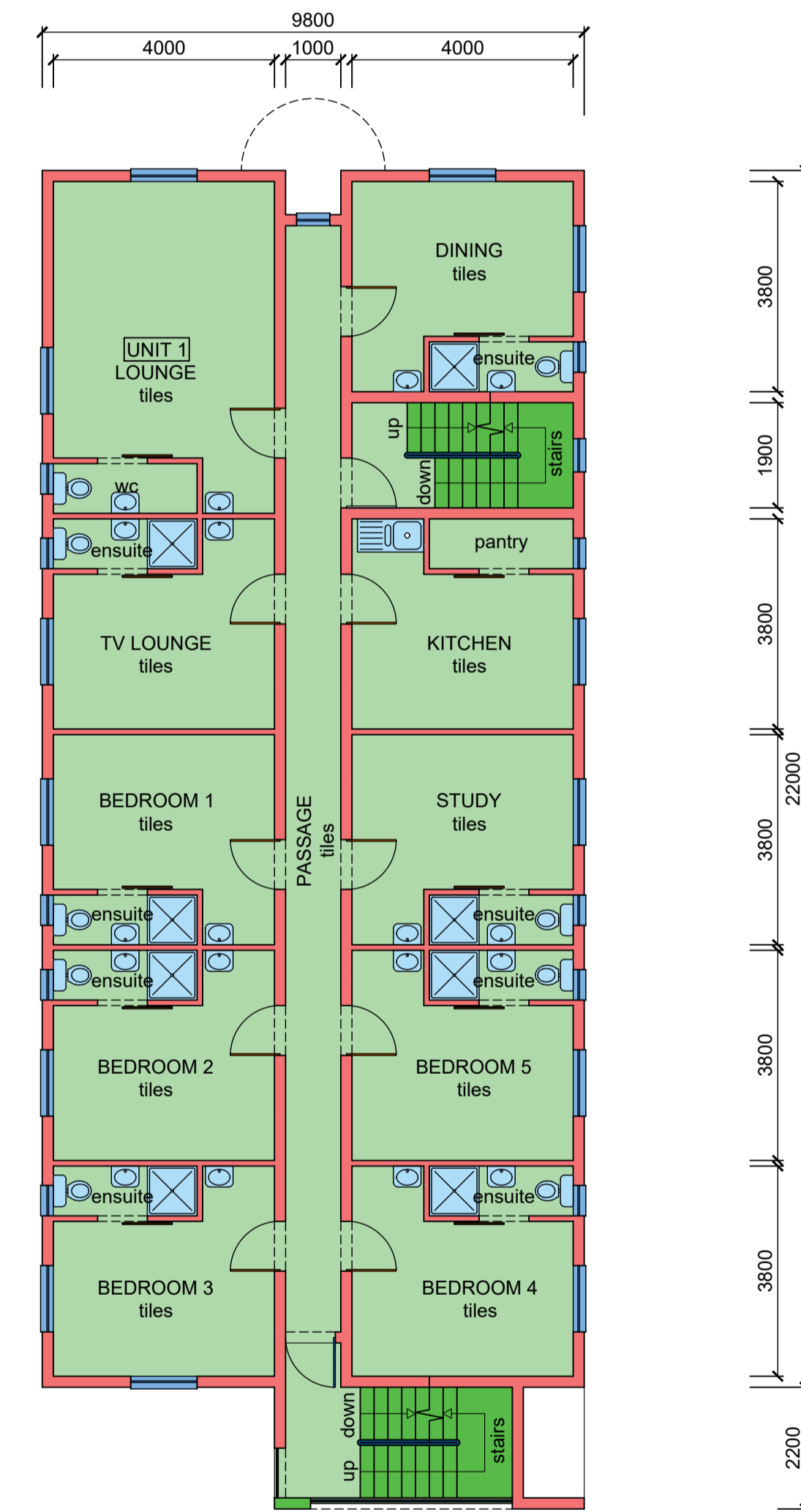

OVERALL SITE PLAN (1 : 500)



TYPICAL FIRST/ SECOND STOREY PLAN (1 : 100)

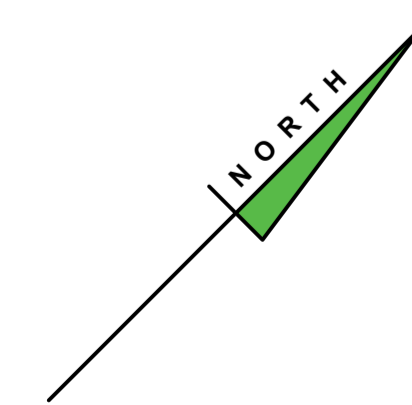

Total Area = 657.52 m²

[Signature] 082 681 6475
Client's Signature Contact Number

Rate No. 1042 5038/ 000

PROPOSED NEW MULTI-STOREY RESIDENTIAL DEVELOPMENT AT 33 RYDE AVENUE ON ERF 6324 DURBAN FOR WIZ INVESTMENTS (PTY) LTD

GRAHAM BRAUM
ARCHITECTURAL DESIGNER
Pr. S. Arch. T
Reg. No. ST0010 *[Signature]*

13 Helen Joseph Road Tel : 031-2054142
Durban Cell : 082 454 0441
4001 Email : gpbdesigners@gmail.com

SCALE : 1 : 100/ 1 : 500
CHECKED : G. P. BRAUM
DRAWN/ DESIGNED : M. R. AZMUTH
DATE : JULY-SEPTEMBER 2023
SHEET : 1

Drawing No. : 6730/ 23 - Rev1