

DOOR TYPE: D-01		SCALE: 1:50
ALL OPENINGS MUST BE MEASURED ON SITE PRIOR TO ORDERING DOORS		
QUANTITIES:	GROUND: 1	
	QUANTITY: 1	
TOTAL:	01	REFER TO PLAN FOR WALL TYPE. CONFIRM THAT YOU ARE IN POSSESSION OF THE LATEST REVISION OF THIS SCHEDULE.
ELEVATION:		
DOOR NUMBER:	1	
DOOR TYPE:	Prepainted Automatic Roller shutter door.	
FRAME:	MATERIAL: 0.9 mm thick galvanized steel FINISH: Powder coat finish COLOUR: prepainted Brown (in accordance with SANS 10400 Part N)	
GLAZING:	TYPE: N/A	
IRONMONGERY:	As per manufacturer specification.	
GLAZED AREA:	0 m ²	OPENABLE AREA: 0m ²
NOTES:		

DOOR TYPE: D-02		SCALE: 1:50
ALL OPENINGS MUST BE MEASURED ON SITE PRIOR TO ORDERING DOORS		
QUANTITIES:	GROUND: 1	
	QUANTITY: 2	
TOTAL:	02	REFER TO PLAN FOR WALL TYPE. CONFIRM THAT YOU ARE IN POSSESSION OF THE LATEST REVISION OF THIS SCHEDULE.
ELEVATION:		
DOOR NUMBER:	2	
DOOR TYPE:	Aluminium sliding door	
FRAME:	MATERIAL: 6063T6 Aluminium Alloy, 2mm minimum thickness at structural portion FINISH: Powder coat finish COLOUR: Brown	
GLAZING:	TYPE: N/A	
IRONMONGERY:	As per manufacturer specification.	
GLAZED AREA:	0 m ²	OPENABLE AREA: 0m ²
NOTES:		

DOOR TYPE: D-03		SCALE: 1:50
ALL OPENINGS MUST BE MEASURED ON SITE PRIOR TO ORDERING DOORS		
QUANTITIES:	GROUND: 1	
	QUANTITY: 1	
TOTAL:	01	REFER TO PLAN FOR WALL TYPE. CONFIRM THAT YOU ARE IN POSSESSION OF THE LATEST REVISION OF THIS SCHEDULE.
ELEVATION:		
DOOR NUMBER:	03	
DOOR TYPE:	Aluminium sliding door	
FRAME:	MATERIAL: 6063T6 Aluminium Alloy, 2mm minimum thickness at structural portion FINISH: Powder coat finish COLOUR: Charcoal or equally approved by architect.	
GLAZING:	TYPE: Single low E Tinted 6.38mm thick laminated thickness to comply to NN2 /safety glazing to comply with NN3 of SANS 10400	
IRONMONGERY:	As per manufacturer specification.	
GLAZED AREA:	3.99m ²	OPENABLE AREA: 1.9278m ²
NOTES:		

DOOR TYPE: D-04		SCALE: 1:50
ALL OPENINGS MUST BE MEASURED ON SITE PRIOR TO ORDERING DOORS		
QUANTITIES:	GROUND: 1	
	QUANTITY: 2	
TOTAL:	02	REFER TO PLAN FOR WALL TYPE. CONFIRM THAT YOU ARE IN POSSESSION OF THE LATEST REVISION OF THIS SCHEDULE.
ELEVATION:		
DOOR NUMBER:	04	
DOOR TYPE:	Aluminium pivot vertical door	
FRAME:	MATERIAL: 6063T6 Aluminium Alloy, 2mm minimum thickness at structural portion FINISH: Powder coat finish COLOUR: Charcoal or equally approved by architect.	
GLAZING:	TYPE: Single low E Tinted 6.38mm thick laminated thickness to comply to NN2 /safety glazing to comply with NN3 of SANS 10400	
IRONMONGERY:	As per manufacturer specification.	
GLAZED AREA:	1.68 m ²	OPENABLE AREA: 1.68m ²
NOTES:		

ELECTRICAL LEGEND:	
	RECESSED DOWN LIGHT
	CEILING LIGHT
	PENDANT LIGHT
	WALL MOUNTED LIGHT 2500 ABOVE FFL OR OTHER TO ARCHITECT
	SINGLE LIGHT SWITCH
	DOUBLE LIGHT SWITCH
	DISTRIBUTION BOARD
	340 FROM UFL - EXACT POSITION BY ARCHITECT
	GEYSER
	STOVE SWITCH
	SINGLE OUTLET 15 AMP WALL SOCKET 200 OR 1000 FROM UFL TO BOTTOM OF PLUG FACE PLATE
	DOUBLE OUTLET 15 AMP WALL SOCKET 200 OR 1000 FROM UFL TO BOTTOM OF PLUG FACE PLATE
	DOUBLE OUTLET 30 AMP WALL SOCKET 200 OR 1000 FROM UFL TO BOTTOM OF PLUG FACE PLATE
	DOUBLE OUTLET 15 AMP ALL-WEATHER WALL SOCKET 200 OR 1000 FROM UFL TO BOTTOM OF PLUG FACE PLATE
ALL POSITIONS OF LIGHT FITTINGS, PLUGS & SWITCHES TO BE CONFIRMED BY ARCHITECT	
	POWER CABLE

Electrical Legend
1 : 12

DOOR TYPE: D-05		SCALE: 1:50
ALL OPENINGS MUST BE MEASURED ON SITE PRIOR TO ORDERING DOORS		
QUANTITIES:	GROUND: 1	
	QUANTITY: 1	
TOTAL:	02	REFER TO PLAN FOR WALL TYPE. CONFIRM THAT YOU ARE IN POSSESSION OF THE LATEST REVISION OF THIS SCHEDULE.
ELEVATION:		
DOOR NUMBER:	1	
DOOR TYPE:	Vertical Pivot solid core timber door to architects and client approval.	
FRAME:	MATERIAL: Timber to be treated, sanded. FINISH: Painted with carbolinium to specialist specs. COLOUR: Brown	
GLAZING:	TYPE: N/A	
IRONMONGERY:	As per manufacturer specification.	
GLAZED AREA:	0m ²	OPENABLE AREA: 0m ²
NOTES:		

DOOR TYPE: D-06		SCALE: 1:50
ALL OPENINGS MUST BE MEASURED ON SITE PRIOR TO ORDERING DOORS		
QUANTITIES:	GROUND: 1	
	QUANTITY: 2	
TOTAL:	02	REFER TO PLAN FOR WALL TYPE. CONFIRM THAT YOU ARE IN POSSESSION OF THE LATEST REVISION OF THIS SCHEDULE.
ELEVATION:		
DOOR NUMBER:	1	
DOOR TYPE:	Vertical Pivot solid core timber door to architects and client approval.	
FRAME:	MATERIAL: Timber to be treated, sanded. FINISH: Painted with carbolinium to specialist specs. COLOUR: Brown	
GLAZING:	TYPE: N/A	
IRONMONGERY:	As per manufacturer specification.	
GLAZED AREA:	0m ²	OPENABLE AREA: 0m ²
NOTES:		

DOOR TYPE: D-07		SCALE: 1:50
ALL OPENINGS MUST BE MEASURED ON SITE PRIOR TO ORDERING DOORS		
QUANTITIES:	GROUND: 1	
	QUANTITY: 1	
TOTAL:	01	REFER TO PLAN FOR WALL TYPE. CONFIRM THAT YOU ARE IN POSSESSION OF THE LATEST REVISION OF THIS SCHEDULE.
ELEVATION:		
DOOR NUMBER:	1	
DOOR TYPE:	Vertical Pivot solid core timber door to architects and client approval.	
FRAME:	MATERIAL: Timber to be treated, sanded. FINISH: Painted with carbolinium to specialist specs. COLOUR: Brown	
GLAZING:	TYPE: N/A	
IRONMONGERY:	As per manufacturer specification.	
GLAZED AREA:	0m ²	OPENABLE AREA: 0 m ²
NOTES:	Sliding door	

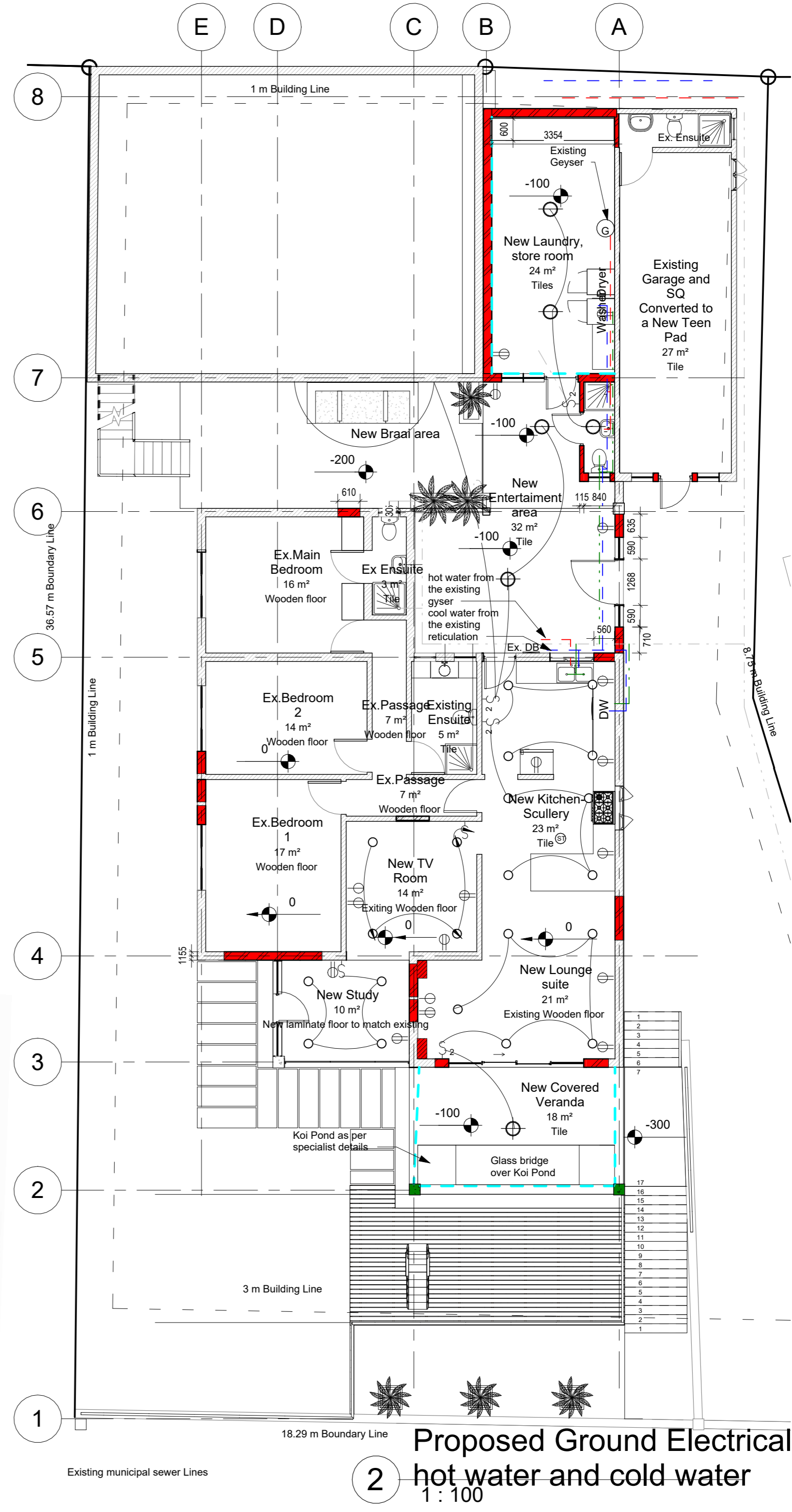

1. All boundaries, dimensions and levels are to be checked on site before construction and any discrepancies are to be reported to the Architect.
2. Partial Service: Any discrepancies with site or other information is to be advised to the Architect and direction or approval is to be sought before the implementation of the detail.
3. Do not scale this drawing.
4. For the purpose of coordination, all relevant parties must check this information prior to implementation and report any discrepancies to the Architect.
5. Any discrepancies MUST be reported to the ARCHITECT immediately prior to any commencement of work. The author will not be responsible for work carried out without the ARCHITECT'S consent as well as deviations from the approved plans.
6. Any plans removed from ARCHITECT'S office without his prior authorization will be deemed unchecked and thereafter invalid.
7. The attention of the owner is drawn to the fact that changes to the plan and/or specifications after official approval are likely to invalidate that approval.
8. The no construction is to be carried out on site prior to approval of submissions from relevant authorities.

Schedule: Door Copy 1

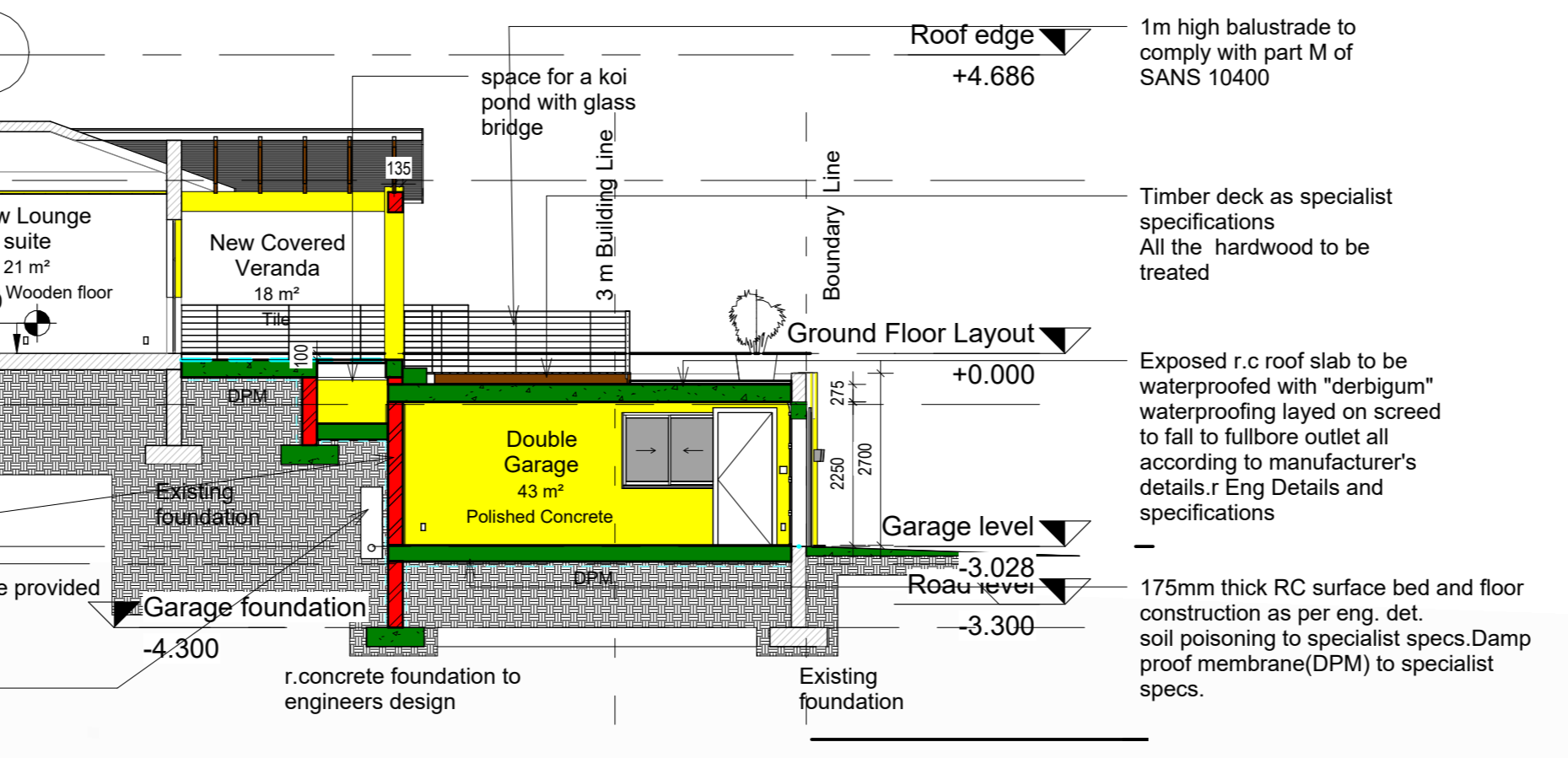
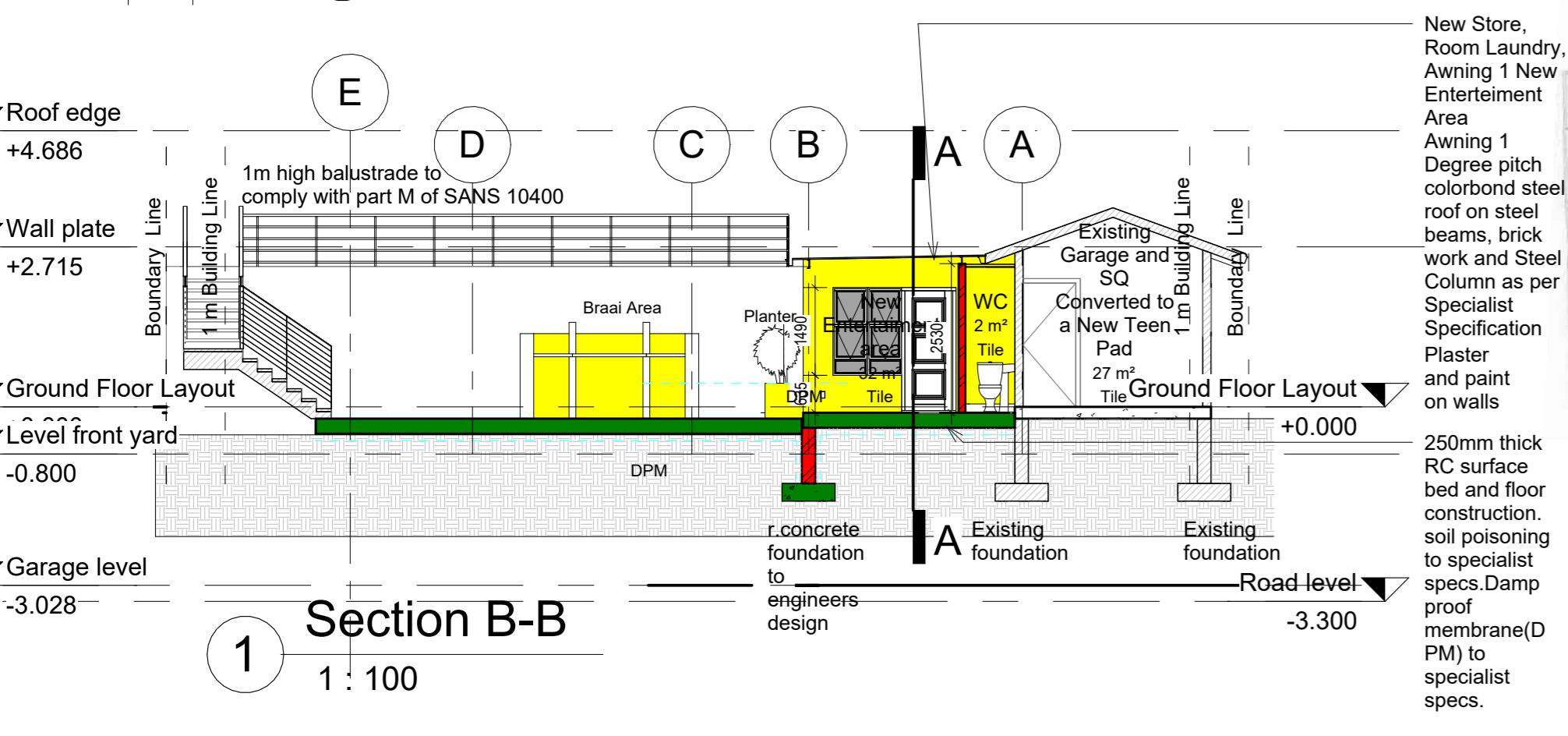
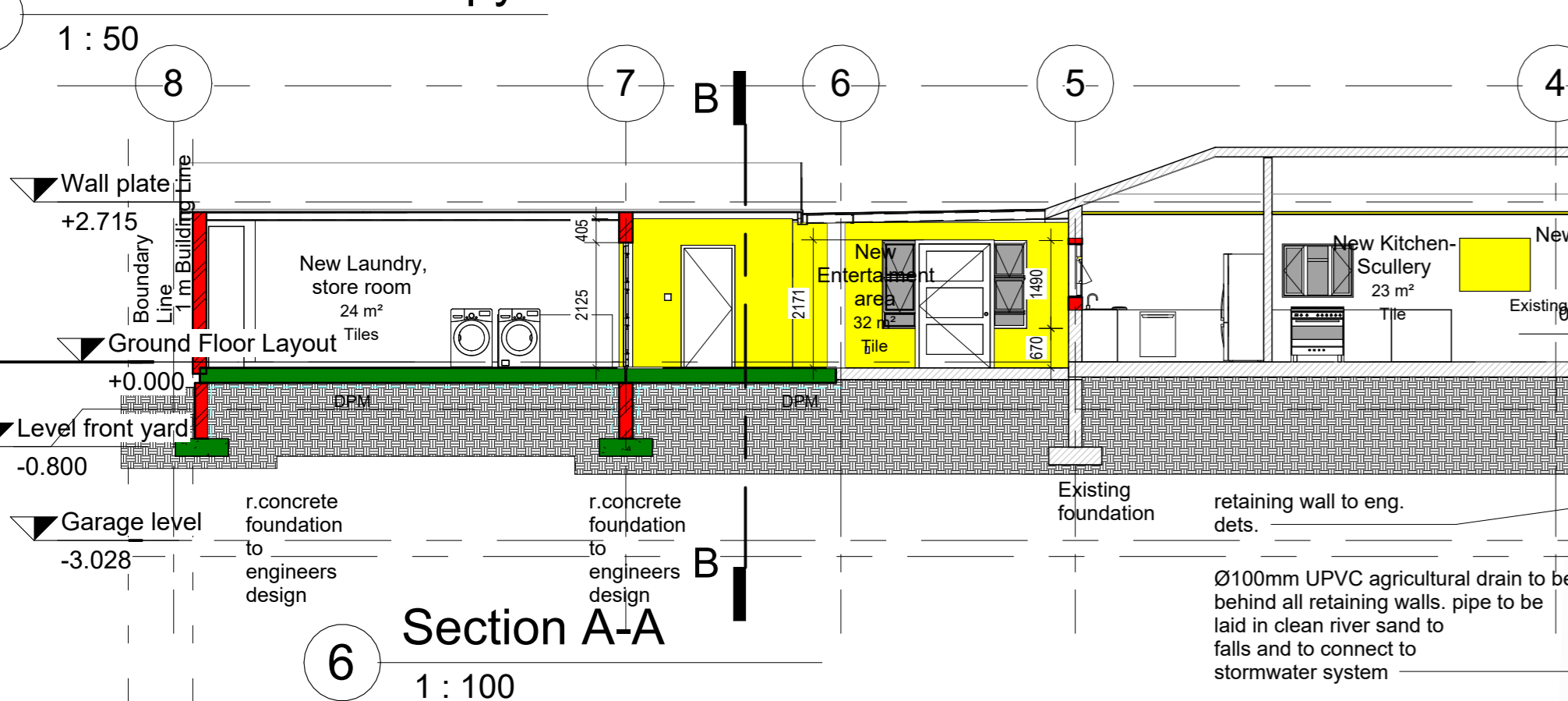

Name	Address	I.D. No.	Tel/Cell	Signature
SHEKHAR AZHAR	36 MOUNTAIN VIEW AVENUE	710719030708	083 657 1447	
JOHANNES CHERRY	40 MOUNTAIN VIEW AVENUE	600281 6002 08 3	083 407 6215	
ZUBAIR A.	51 MOUNTAIN VIEW AVENUE	8201260801	678068 0468	
INDRASEK CHERRY	49 MOUNTAIN VIEW AVENUE	70114 514 084	083 709 2636	
P. MURRAY	47 MOUNTAIN VIEW AVENUE	690265/37087	083 777 4804	

Relaxation of the Front Building line from 3m to 0m

REVISIONS			
NO.	DATE	DESCRIPTION	REV BY.

For: Lance Arthur Joseph Engelbrecht and Family
 Site Description: 38 Mountain View Avenue, Morningside, R/38 of ERF 230, Springfield

Project: Addition and Alteration to Engelbrecht Family's House

Working Drawing: Sections window and door elevation and services

Owner Signature:

Approved By:

Date: 01/08/2022

BUILDING CLASSIFICATION: H-4
 CLIMATIC ZONE: 5
 Paper Size: A1
 SCALE: As indicated

Drawn: YF
 Checked: YF
 DATE: 01/08/2022

PROJECT No: AAD22006
 DRAWING No.: AAD22004-03