



KAI !GARIB MUNICIPALITY

TECHNICAL REPORT

NEW CEMETRY CILLIE

Prepared for:

Kai !Garib Municipality
PO Box 8
Keimoes
8860

Tel no 054-461 6400
Fax no 054-461 6401
E-mail admin@kaigarib.co.za

Prepared by:

Stabilis Development (Pty) Ltd
P.O. Box 861
Kimberley
8300

Tel no 053-833 1654
fax no 053-831 3786
E-mail info@stabilis.co.za

JUNE 2011

CONTENTS		PAGE
1.	Background	2
2.	Introduction	
	2.1 Purpose of Technical report	2
	2.2 Outcomes of Feasibility Study	2
	2.3 Project Objectives	4
	2.3 Project Outcomes	4
3.	Proposed Project	
	3.1 Project name	5
	3.2 Location	5
	3.3 GIS Reference	5
	3.4 Purpose of Project Technical Report	5
4	Project Beneficiaries	
	4.1 Background	5
	4.2 Beneficiaries	6
5.	Scope of the works	
	5.1 Brief description of Project	6
	5.2 Implementing Agent	6
	5.3 Funding plan	6
	5.4 Budget proposal	7
	5.5 Estimated Costs	7
	5.6 Operations and Maintenance	7
	5.7 Training	7
ANNEXURE A	Breakdown of Cost Estimates	
ANNEXURE B	Layout drawings	

1. BACKGROUND

Cillie is located approximately 15 km from Kakamas within the jurisdictional area of Kai !Garib municipality with Kakamas as the main centre of the municipality. The existing three cemeteries at Cillie is located to the north-east of the town. This existing cemeteries is approximately 90% full and is reaching their capacities.

Kai !Garib municipality applied for funding from MIG program to conduct a feasibility study for the development of a new cemetery for Cillie. This application was approved and a service provider was appointed to conduct the feasibility study for a new cemetery at Cillie. The main outcome of this feasibility study was to identify the most suitable and cost-effective cemetery site for use by the residents of Cillie.

2. INTRODUCTION

Kai !Garib municipality appointed Stabilis Development to assist with the compiling of the relevant MIG applications, including the technical reports required by the MIG office and to conduct the feasibility study after registration of the project. The outcome and recommendations of the feasibility study will lead to the application for capital funding by the MIG program to develop a new cemetery for Cillie. Approximately 100 new stands are in planning for this town.

This project was identified as a priority at a ordinary council meeting held on **26 November 2009** to prioritize the MIG projects of Kai !Garib Municipality. The minutes of this meeting and the approved IDP is attached as part of this report as supportive documents to the MIG application.

The IDP number of this project is 65.

2.1 PURPOSE OF TECHNICAL REPORT

This purpose of this technical report is to:

- Briefly describe the outcome of the feasibility study and,
- Scope of the proposed new project, the development of a new cemetery for the community at Cillie.

2.2 OUTCOME OF FEASIBILITY STUDY

The feasibility study mainly entails the following:

- Status Quo of existing cemetery at Cillie,
- Identify new suitable land for a new cemetery
- Determine needs of new cemetery
- Rezoning and sub-division of site for new cemetery-if required
- Conduct Environmental Assessment for new cemetery and submit project registration documents at the local offices of Department of Environmental Affairs and Tourism,
- Determine suitability of soil conditions for new cemetery,
- Estimated capital, operational and maintenance costs for the new cemetery,
- Submit feasibility study to Kai !Garib municipality

- Compile MIG application for funding of the new cemetery project to the MIG office.

The outcomes of the feasibility study are as follows:

- **Status Quo**

There are three existing cemeteries at Cillie and they are located to the north-east the town. The cemetery currently in use is situated on plot 231 and is approximately 8 696m². The plot is owned by Kai !Garib municipality under title deed T1822/2002.

The existing cemetery is also approximately 90 % full and a new cemetery needs to be developed for the community of Cillie.

- **Identification of Land**

Suitable land for the extension of the existing cemetery, the one currently in use, is located to the north-east of the town. Adequate land next to the existing cemetery is available for the extension of this existing cemetery.

The site on this land is currently vacant and belongs to Kai Garib Municipality and is within walking distance from the town of Cillie.

- **Suitability of site**

Profiles from test holes indicated that the soil conditions, although it varies from soft to intermediate in the profile, are suitable for a cemetery and services required at the site are available. Only water is available as Cillie does not have a sewer network.

- **Zoning requirements**

The existing land belongs to Kai !Garib Municipality and therefore a rezoning and sub-division application was required. This rezoning and sub-division application for the site was compiled and submitted to Kai !Garib Municipality in terms of Act 7 of 1997.

- **Environmental Assessment**

In terms of the regulations of NEMA, the land use constitutes a listed activity in terms of the regulations and authorization from the Department of Environmental Affairs and Tourism is required. A Basic Assessment for an Environmental Assessment was compiled and submitted to the office of the said Department for adjudication.

Currently, the decision of this Department is still outstanding. Any further actions regarding the EIA process will depend on the outcome of the project registration at the Department.

➤ Needs Assessment

According to the register kept by the official at the municipal pay-point, the average burials are approximately 34 per annum. The official also indicated that this figure is most probably not correct as many families did not register the burials at the municipality.

The new proposed cemetery can accommodate a total of 404 graves, 294 adult graves and 110 for children. Due to the geological formation at the site, it is recommended that the graves be pre-excavated and backfilled. This will enable the community to do the hand excavation for the graves in a much easier way.

The following infrastructure is required at the new proposed cemetery:

- Water supply to the site by means of a 75 mm diameter line and an approximate length of 180 meters,
- Sanitation can be provided by means of a conservancy tank
- A store room of approximately 16m² for storing hand tools, etc.
- An ablution facility, male/female, of approximately 16m² in total
- A fence on the perimeter of the site as per the requirements of Kai !Garib municipality
- The pre-excavation of the graves
- Gravel roads on the cemetery site, of 5 meter and 2 meter width respectively.
- Pegging of the site by a registered Land Surveyor as soon as the rezoning and sub-division is approved.

The proposed layout of the cemetery is shown on drawing SK 2140/1 and -/2 attached to this report.

2.3 PROJECT OBJECTIVES

The main objectives of this proposed project are the following:

- To develop a new cemetery for the community at Cillie
- The proposed new cemetery to be serviced with the necessary infrastructure to accommodate the needs of the community and to ensure a fully operational cemetery,
- Involve the relevant Community in the implementation of the project.
- Conduct any further actions, if required, by the Department of Environmental Affairs

2.4 PROJECT OUTCOMES

The expected outcomes for the project are the following:

- New proposed cemetery for the community at Cillie developed and in operation.
- The operation of the new cemetery includes the registration of burials as per the register held at Kai !Garib Municipality,
- Maintenance of the infrastructure at the cemetery and the appointment of a caretaker at the cemetery.

3. PROPOSED PROJECT

3.1 PROJECT NAME : **KAI !GARIB: NEW CEMETERY FOR AUGRABIES**

The proposed project mainly entails the development of a new cemetery for Cillie.

3.2 LOCATION

The location of the proposed project is in the Kai !Garib Municipal area at the town of Cillie– see attached map.

3.3 GIS REFERENCE

District: Siyanda
Nearest town: Kakamas

Cillie

Longitude: 28° 44' 13,9"
Latitude: 20° 35' 02"

3.4 PURPOSE OF PROJECT BUSINESS PLAN

The main purpose of this technical report is to support the MIG application for funding of this proposed project and to briefly describe the proposed project and the processes to be followed for implementation.

4. PROJECT BENEFICIARIES

4.1 BACKGROUND

The existing cemetery at Cillie reached its capacity and therefore a new cemetery needs to be developed for the community.

4.2 BENEFICIARIES

The beneficiaries of this project are mainly the residents of Cillie. The new site will also serve the informal settlements in the area. The town of Cillie has a total population of 513 households and a total population of 2 457 with approximately 5 members per household, according to the 2007 household survey- STATSA.

5 SCOPE OF THE WORKS

The proposed project will include the following project elements to ensure that the required outcomes will be met:

5.1 BRIEF DESCRIPTION OF PROJECT.

The proposed project comprise of the following main elements:

- Pegging of site by a registered Land Surveyor as soon as the rezoning and sub-division is approved.
- Detail planning and design of infrastructure and compilation of the necessary drawings and tender documentation
- Appointment of suitable contractor to construct the required infrastructure
- Operation and maintenance of the developed cemetery.

5.2 IMPLEMENTATION AGENT

Kai !Garib Municipality will be the Implementing Agency and the responsible agent.

- Contact person: Mr AJP Wells
Head : Technical Services
- Address: Kai !Garib Municipality
Private Bag X 6
KAKAMAS
8870
- Telephone number: 054- 461 6400
- Fax number 054- 516 9066

5.3 FUNDING PLAN

All funds must be made available to the Municipal Manager, Kai Garib Municipality who will, in accordance with Standard Procedures, take responsibility for the administration of all funds. Application for funding of this project will be submitted to the MIG office, Department of Local Government and Housing, Northern Cape.

5.4 BUDGET PROPOSAL

The preliminary budget for the proposed project in the municipal area is as follows:

5.5 ESTIMATED PROJECT COST:

The estimated project cost is the following as per Annexure A:

a)	Capital Costs -	R 346 278.00
b)	Professional Fees & Expenses	R 111 250.00
	Sub Total A	R 457 528.00
	10% Contingencies	R 45 752.80
	Sub Total B	R 503 280.80
	14 % VAT	R 70 460.00
	TOTAL ESTIMATED PROJECT AMOUNT	R 573 740.80

5.6 OPERATIONS AND MAINTENANCE

The operations and maintenance of the project after completion is the responsibility of Kai !Garib Municipality.

5.7 TRAINING

The training of the officials required for the operation of this facility will be arranged internally and will mainly focus on the registration process of burials and the operation of the facility on the site.

C.J Botha Pr Eng
Stabilis Development (Pty) Ltd

27 June 2011

Municipal Manager
Kai !Garib Municipality

ANNEXURE A

Kai !Garib Municipality : Cemeteries : Estimated Costs Cillie

ITEM	UNIT	RATE	CILLIE	
			QTY	AMOUNT
1. Toilets	m ²	3 000.00	16	48 000.00
2. Store room	m ²	1 800.00	16	28 800.00
3. Sanitation : Conservancy tank & connection	No	50 000.00	1	50 000.00
4. Water supply: Connection to network	No	10 000.00	1	10 000.00
5. Water supply : connector pipe line	m	250.00	180	45 000.00
5. New fencing	m	106.00	245	25 970.00
6. Site clearance	Ha	15 000.00	0.36	5 400.00
7. Gravel roads - 5 meter wide	m ²	60.00	550	33 000.00
8. Gravel roads - 2 meter wide	m ²	60.00	140	8 400.00
9. Excavation abd backfilling of graves	No	227.00	404	91 708.00
Estimated Total : Capital				346 278.00
10. Engineering fees				61 250.00
11. Land surveyor				25 000.00
12. Expenses : Surveys, documentation & travelling				25 000.00
Estimated Total : Indirect Costs				111 250.00
Total Estimated Costs				457 528.00
Contigencies @ 10 %				45 752.80
Estimated total - Excluding VAT				503 280.80
Estimated total - Including VAT				573 740.11

ANNEXURE B
LAYOUT DRAWINGS

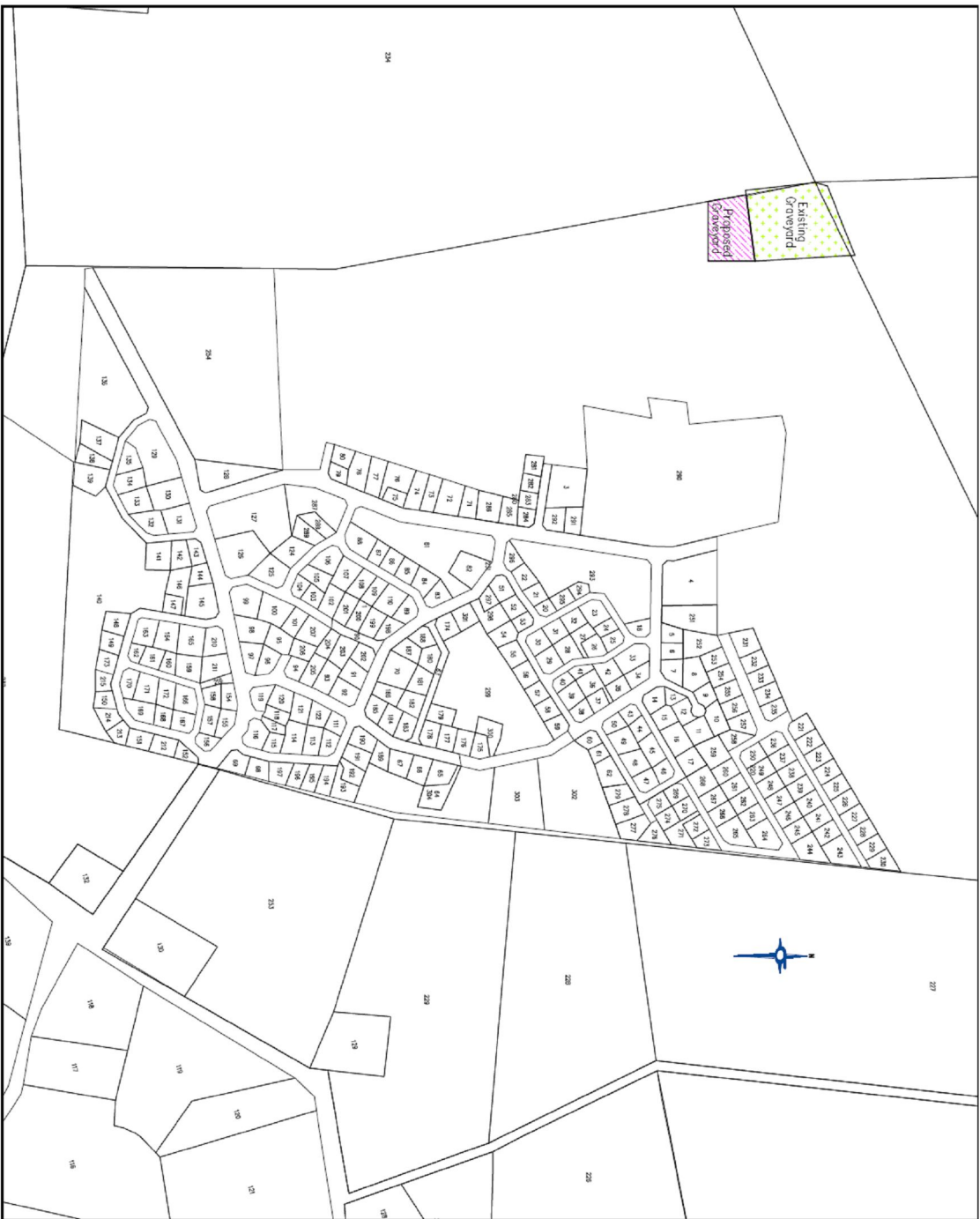

NOTES / NOTES

DATE: 11/11/2011
 TIME: 10:00 AM
 PROJECT: SK2140/1
 DRAWN: C. HALL
 CHECKED: J. HALL
 APPROVED: J. HALL

STABIS
 STABIS CONSULTANTS INC.
 1000 WESTERN AVENUE, SUITE 100
 VANCOUVER, BC V6V 1W1
 TEL: 604-271-1111
 FAX: 604-271-1112
 WWW.STABIS.COM

CLIENT / CLIENT
 KHAM GARIB MUNICPALITY

PROJECT / PROJECT
 CILIE
 NEW GRAVEYARD

TEXT / TITLE
 LOCATION PLAN

TRACING: J. HALL / STABIS CONSULTANTS INC.
 SK2140/1

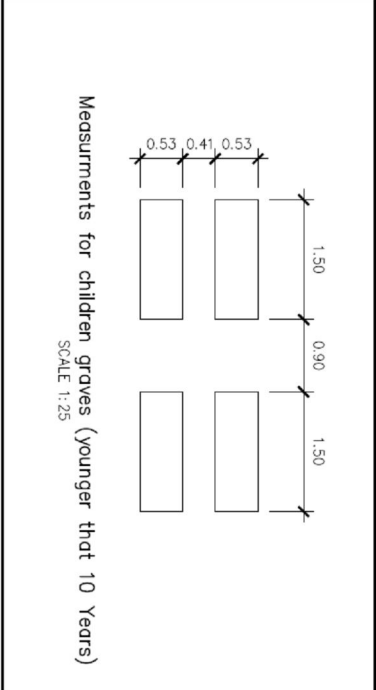
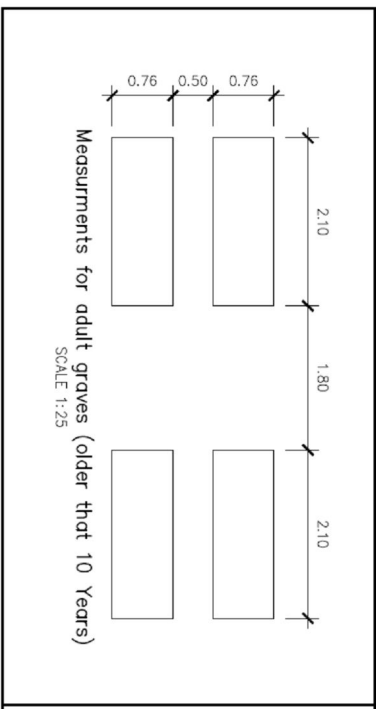
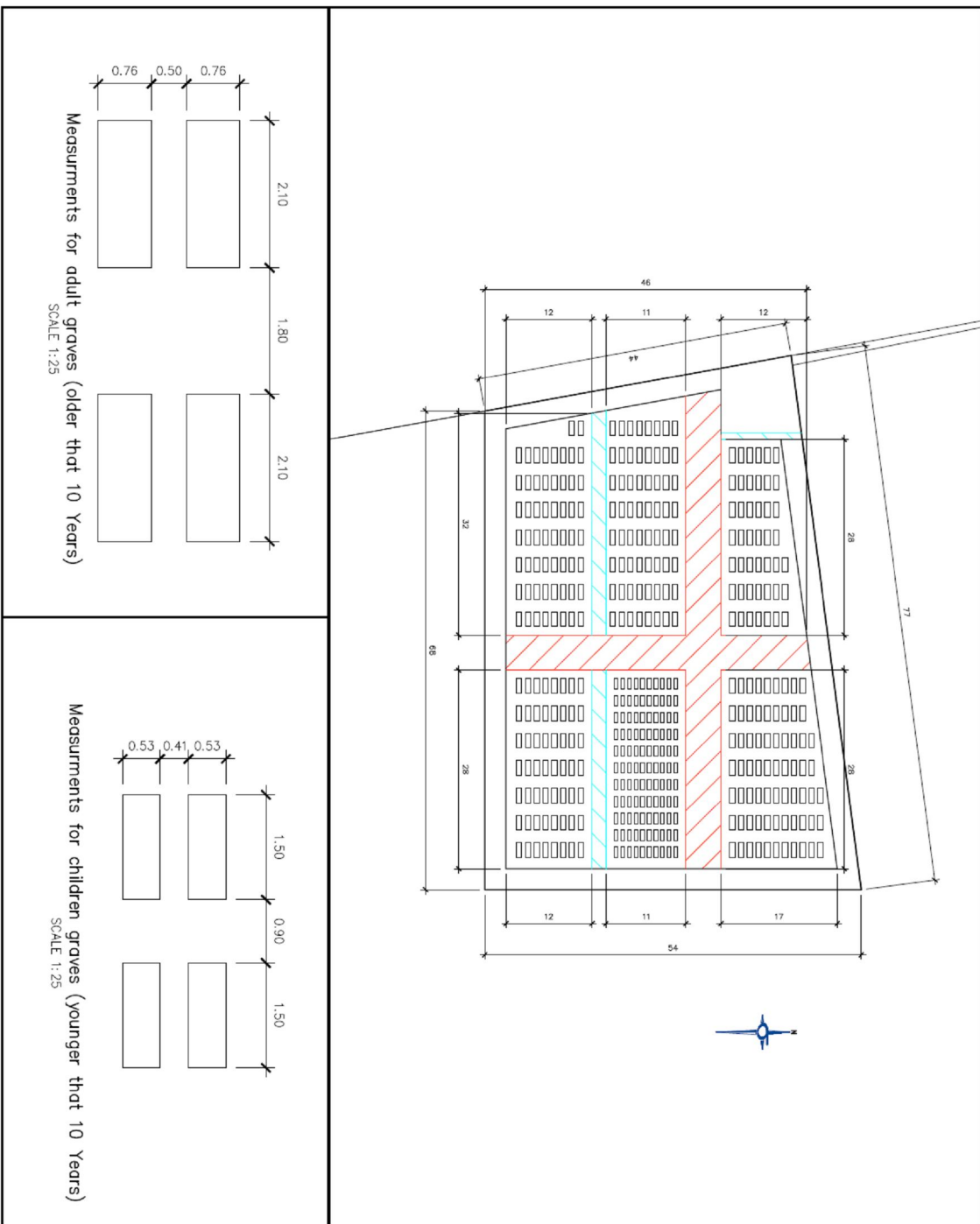

NOTAS / NOTES

NO.	DESCRIPTION	DATE	BY

CLIENT / CLIENT
KAI GARIB MUNICIPALITY



PROJECT / SERVICE
**LENNERSVILLE
NEW GRAVEYARD**

TITLE / TITLE
PLAN LAYOUT

DRAWING NO. / DRAWING NO.
SK2140/2

NO.	DESCRIPTION	DATE	BY

NO.	DESCRIPTION	DATE	BY

