

**GENERAL NOTES**

- The Contractor is responsible for the correct setting out of the buildings and all external and internal walls with particular reference to boundaries, building lines and setting out points.
- The Contractor is to verify all levels before and after construction on the site and to check these against the drawings before putting any work in hand.
- The Contractor is to locate and identify existing services on the site and to protect these from damage throughout the duration of the contract.
- The Contractor is referred to the Standard Guidelines for Quality Control issued by this office for all minimum requirements for workmanship and materials. This document is to be used in conjunction with the drawings.
- Any errors, discrepancies or omissions are to be reported to the Architect immediately.
- Contractor is to build to Approved D.P.C.'s, whether or not these are shown on drawings. In all external walls at each floor, beam or parapet level and to all windows, doors, gables or other openings in external walls. Care is to be taken to ensure that D.P.C.'s are to be installed.
- Any queries arising from all the above must be reported to the Architect for clarification before any work is put in hand.
- Do not scale this drawing refer to figure dimensions only.

COPYRIGHT AND RIGHT OF REPRODUCTION OF THIS DRAWING OR ANY PORTION THEREOF IS RESERVED BY THE ARCHITECTS

**REVISIONS**

REV.	NO.	DATE	DESCRIPTION
1	1	20/07/18	ISSUED FOR PERMIT TO CONSTRUCT
2	1	20/07/18	ISSUED FOR PERMIT TO CONSTRUCT
3	1	20/07/18	ISSUED FOR PERMIT TO CONSTRUCT
4	1	20/07/18	ISSUED FOR PERMIT TO CONSTRUCT
5	1	20/07/18	ISSUED FOR PERMIT TO CONSTRUCT

REV.	NO.	DATE	DESCRIPTION
1	1	20/07/18	ISSUED FOR PERMIT TO CONSTRUCT
2	1	20/07/18	ISSUED FOR PERMIT TO CONSTRUCT
3	1	20/07/18	ISSUED FOR PERMIT TO CONSTRUCT
4	1	20/07/18	ISSUED FOR PERMIT TO CONSTRUCT
5	1	20/07/18	ISSUED FOR PERMIT TO CONSTRUCT

**PROJECT TITLE**  
**THE WORKSHOP**

**PRODUCT DESCRIPTION**  
 MAINTENANCE WORKSHOP, ON LEASE 3, SUB 7 OF A ORDONCE LAND NO. 1885

**DRAWING DESCRIPTION**  
 LOWER LEVEL FLOOR TILING



SCALE	DATE	DRAWN	CHECKED	PROJECT NO.	DRAWING NO.	REVISION
1:125	20/07/18	DUP		4609	11.100	5

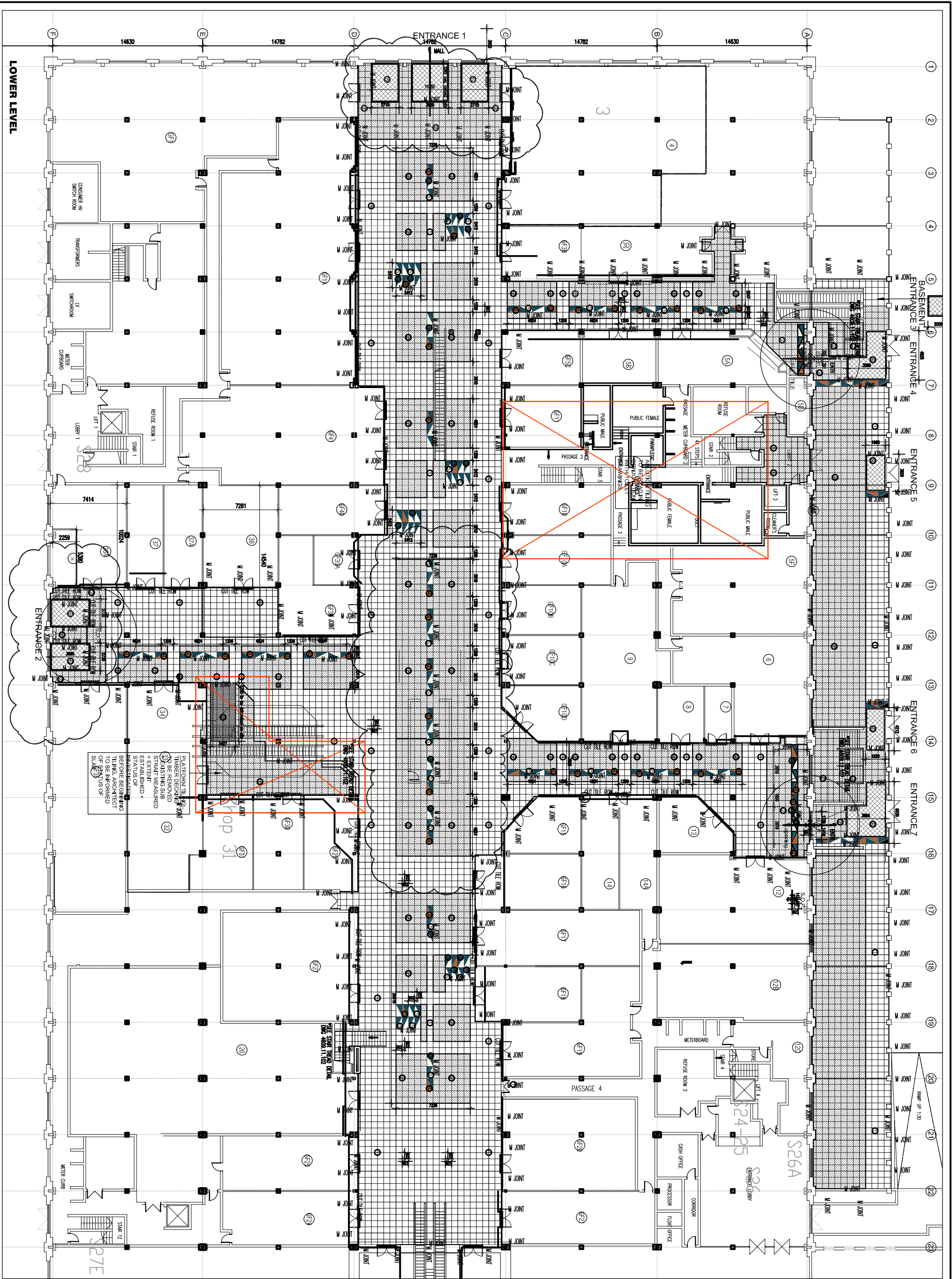

PLATFORM TILE  
 FIBRE REINFORCED  
 CONCRETE  
 150mm THICK  
 STRAIGHT MEASURED  
 + EXTENT  
 ESTABLISHED +  
 STATUS OF  
 STRUCTURE  
 TILING ARCHITECT  
 TO BE INFORMED  
 OF STATUS OF  
 SLAB

**\*NOTE**  
 THIS DRAWING TO BE READ IN CONJUNCTION WITH DWG 4609.11.101

- 1. GENERAL NOTES**
- UNFINISHED - TYPED PORTLAND CEMENT MORTAR TO BE APPLIED TO ALL SURFACES TO BE FINISHED BY MORTAR TO BE SUBMITTED TO ARCHITECT FOR APPROVAL.
  - VERTICAL - HORIZONTAL, UNIFORM JOINTS, APPROXIMATELY 10mm TO 12mm.
  - ALLOWANCE TO BE MADE FOR A BARRIER WITH EXISTING WALLS AND PARTITION WALLS TO INDICATE POSITION OF FINISH SURFACE.
  - 3mm NATURAL ANODISED ALUMINIUM STRAIGHT EDGE TRIM - METRIC 3 SHIPMENT - FINISH TO BE SUBMITTED TO ARCHITECT FOR APPROVAL.
  - OUTLET TRAYS AND COVERS TO BE SUBMITTED TO ARCHITECT FOR APPROVAL.
  - COVERING TO BE SUBMITTED TO ARCHITECT FOR APPROVAL.
  - TOILETS - NATURAL ANODISED ALUMINIUM STRAIGHT EDGE TRIM - METRIC 3 SHIPMENT - FINISH TO BE SUBMITTED TO ARCHITECT FOR APPROVAL.
  - VERTICAL TILE EDGE DETAIL - TO BE SUBMITTED TO ARCHITECT FOR APPROVAL.
  - GENERAL TILE EDGE DETAIL - TO BE SUBMITTED TO ARCHITECT FOR APPROVAL.
  - REFRIGERATION UNIT TO BE SUBMITTED TO ARCHITECT FOR APPROVAL.

KEY	INTERIOR	GENERAL WALL
1	3mm NATURAL ANODISED ALUMINIUM STRAIGHT EDGE TRIM - METRIC 3 SHIPMENT - FINISH TO BE SUBMITTED TO ARCHITECT FOR APPROVAL.	3mm NATURAL ANODISED ALUMINIUM STRAIGHT EDGE TRIM - METRIC 3 SHIPMENT - FINISH TO BE SUBMITTED TO ARCHITECT FOR APPROVAL.
2	OUTLET TRAYS AND COVERS TO BE SUBMITTED TO ARCHITECT FOR APPROVAL.	OUTLET TRAYS AND COVERS TO BE SUBMITTED TO ARCHITECT FOR APPROVAL.
3	COVERING TO BE SUBMITTED TO ARCHITECT FOR APPROVAL.	COVERING TO BE SUBMITTED TO ARCHITECT FOR APPROVAL.
4	TOILETS - NATURAL ANODISED ALUMINIUM STRAIGHT EDGE TRIM - METRIC 3 SHIPMENT - FINISH TO BE SUBMITTED TO ARCHITECT FOR APPROVAL.	TOILETS - NATURAL ANODISED ALUMINIUM STRAIGHT EDGE TRIM - METRIC 3 SHIPMENT - FINISH TO BE SUBMITTED TO ARCHITECT FOR APPROVAL.
5	VERTICAL TILE EDGE DETAIL - TO BE SUBMITTED TO ARCHITECT FOR APPROVAL.	VERTICAL TILE EDGE DETAIL - TO BE SUBMITTED TO ARCHITECT FOR APPROVAL.
6	GENERAL TILE EDGE DETAIL - TO BE SUBMITTED TO ARCHITECT FOR APPROVAL.	GENERAL TILE EDGE DETAIL - TO BE SUBMITTED TO ARCHITECT FOR APPROVAL.
7	REFRIGERATION UNIT TO BE SUBMITTED TO ARCHITECT FOR APPROVAL.	REFRIGERATION UNIT TO BE SUBMITTED TO ARCHITECT FOR APPROVAL.
8	COVERING TO BE SUBMITTED TO ARCHITECT FOR APPROVAL.	COVERING TO BE SUBMITTED TO ARCHITECT FOR APPROVAL.
9	OUTLET TRAYS AND COVERS TO BE SUBMITTED TO ARCHITECT FOR APPROVAL.	OUTLET TRAYS AND COVERS TO BE SUBMITTED TO ARCHITECT FOR APPROVAL.
10	COVERING TO BE SUBMITTED TO ARCHITECT FOR APPROVAL.	COVERING TO BE SUBMITTED TO ARCHITECT FOR APPROVAL.
11	COVERING TO BE SUBMITTED TO ARCHITECT FOR APPROVAL.	COVERING TO BE SUBMITTED TO ARCHITECT FOR APPROVAL.
12	COVERING TO BE SUBMITTED TO ARCHITECT FOR APPROVAL.	COVERING TO BE SUBMITTED TO ARCHITECT FOR APPROVAL.
13	COVERING TO BE SUBMITTED TO ARCHITECT FOR APPROVAL.	COVERING TO BE SUBMITTED TO ARCHITECT FOR APPROVAL.
14	COVERING TO BE SUBMITTED TO ARCHITECT FOR APPROVAL.	COVERING TO BE SUBMITTED TO ARCHITECT FOR APPROVAL.
15	COVERING TO BE SUBMITTED TO ARCHITECT FOR APPROVAL.	COVERING TO BE SUBMITTED TO ARCHITECT FOR APPROVAL.
16	COVERING TO BE SUBMITTED TO ARCHITECT FOR APPROVAL.	COVERING TO BE SUBMITTED TO ARCHITECT FOR APPROVAL.