

BENCH MARKS			
NAME	Y	X	Z
BM 1F	22019.615	3183793.973	1207.180
BM 2F	21669.273	3183782.003	1205.786
BM 3F	21742.767	3184220.334	1204.488
BM 4F	21258.498	3183916.654	1203.795
BM 5F	21409.414	3183439.186	1205.779

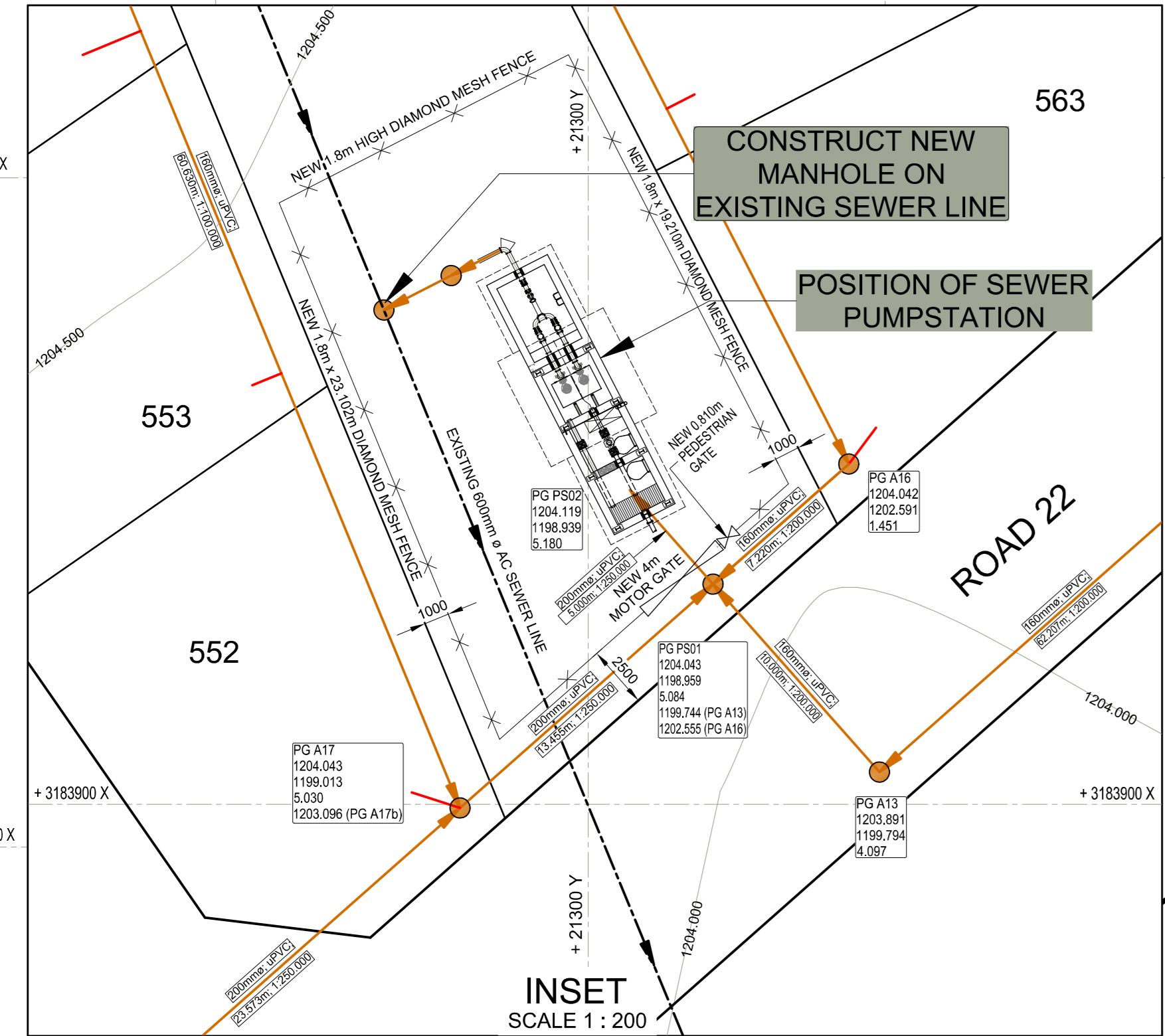
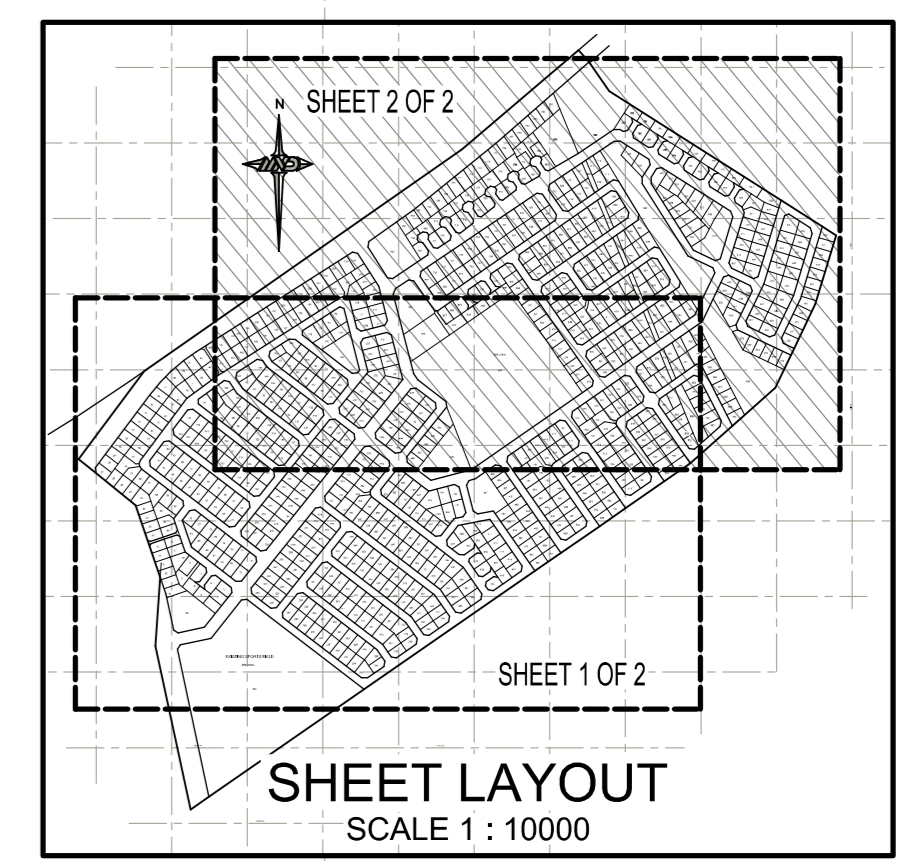

NOTE/NOTA:
 NO DIMENSIONS ARE TO BE SCALED OFF ANY DRAWINGS. ALL DIMENSIONS ARE TO BE RATIFIED ON SITE PRIOR TO ANY CONSTRUCTION.
 GEEN AFMETINGS MAG VAN TEKENINGE GESKAAL WORD NIE. ALLE AFMETINGS MOET OP TERREIN NAGEGAAN WORD VOOR KONSTRUKSIE.

APPROVED FOR CONSTRUCTION

A BEFORE CONTRACT COMMENCES, VOOR KONTRAK IN AANVAANG NIEEM, AFTER CONTRACT HAS COMMENCED, IN TERMS OF THE COPYRIGHT ACT, (ACT 68 OF 1978) Outeursreg is geverig in MID KALAHARI. KRAFTSREK DIE WET OP Outeursreg. (WET 96 VAN 1978)

NO.	DATE	AMENDMENTS
A1	30-01-2014	SEWER SCHEDULE ADDED
A2	Feb 2014	SEWER DESIGNS AMENDED

CLIENT/KLIENT: SOL PLAATJIE MUNICIPALITY
 DRAWING DESCRIPTION/TEKENING BESRYWING: SEWER LAYOUT
 SHEET 2 OF 2

PROJECT/PROEJ: KIMBERLEY : CIVIL SERVICES FOR 892 STANDS, DIAMOND PARK - GREENPOINT
 DESIGN: E. VANDEN BERG, DRAWN: C. LIMBURGH, CHECKED: H. GAGGAY, CLIENT: SOL PLAATJIE MUNICIPALITY, SCALE: 1:750, DATE: JULY 2013

Du Toitweg 18 Du Toitpark Road, Pretoria P.O. Box 580, Kimberley 8300
 Tel: (053) 531 8866, Fax: (053) 533 4491, E-Mail: mvd@mdkalahari.com
MVD Kalahari
 Raadgewende Siviele en Strukturele Ingenieurs,
 Consulting Civil and Structural Engineers.

DRAWING NO./TEKENING NR: 6090/C/FL/002 A2