

GENERAL NOTES:

1. ALL WORK TO COMPLY WITH SANS 10400, AS APPLICABLE.
2. ALL WORK TO ENGINEER'S DETAIL AND APPROVAL.
3. GLAZING TO COMPLY WITH SANS 10400 PART N - TO BE SAFETY GLAZING
4. BALUSTRADE TO COMPLY WITH SANS 10400 PART D & N
5. POSITIONING OF SEWER AND STORMWATER LINES TO BE CONFIRMED
6. STORMWATER: STORMWATER TO EXISTING RETICULATION & SOAKAWAYS:
7. VENTILATION TO COMPLY WITH SANS 10400 PART O

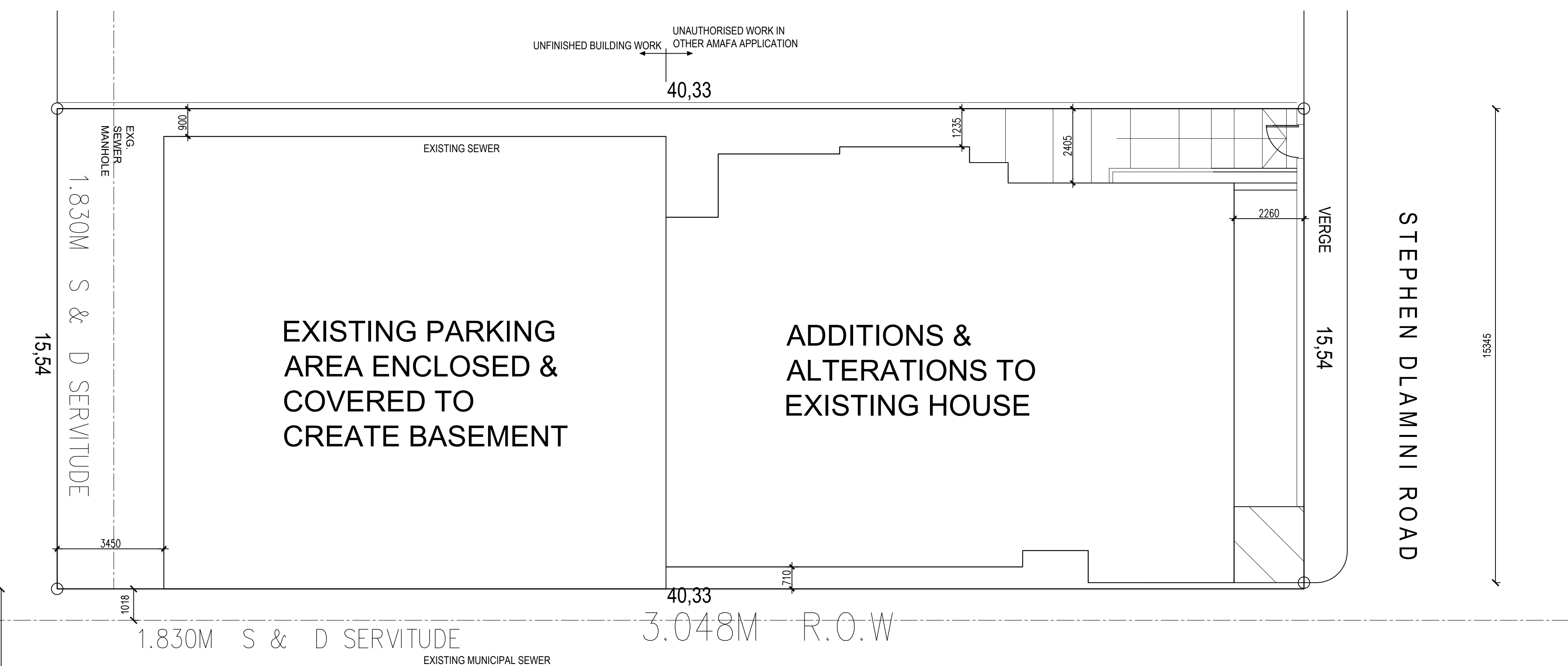
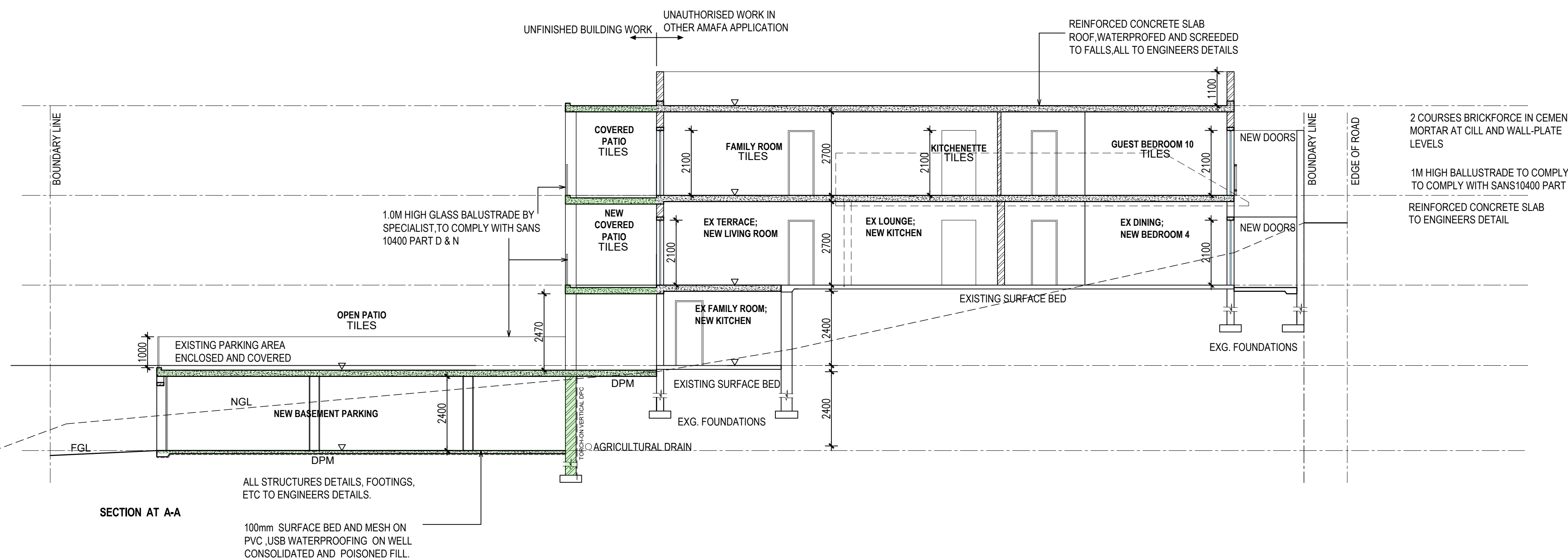

SITE PLAN
 SCALE 1:100
 PORTION 4 (OF 1) OF ERF 3005
 DURBAN

SCHEDULE OF AREAS

SITE AREA 630 M²

FLOOR AREA		
EXISTING	PROPOSED	TOTAL
215.51 M ²	369.00 M ²	584.51 M ²

COVERAGE		
EXISTING	PROPOSED	TOTAL
221.90 M ²	55.21 M ²	277.11 M ²

OWNER :
 Oliver Darnell

REV	DESCRIPTION	By

ADDITIONS & ALTERATIONS TO EXISTING HOUSE AT 626 STEPHEN DLAMINI ROAD FOR MR O DARNELL

SCALE	1:100	Architect
DATE	OCTOBER 2020	
SHT	3/3	
drawing no	626 SDR D01	