

WINDOW NUMBER	W01	W02 (ALTERED WINDOWS)
QUANTITY	2	2
FRAME	ALUMINIUM	TIMBER
MAX PANE SIZE	0.3	0.3
GLASS	6mm TOUGHENED SAFETY GLASS	6mm TOUGHENED SAFETY GLASS

WINDOWS TO COMPLY WITH SANS10400 PART N

Revisions:		
Rev	Description	By Date
A	B Regs for submission	GSD 28.09.09
B	Rev Client name Added landing to escape stairs A Added pedestals to PC columns A Added arch to new entry B	GSD 30.09.09
C	Updated layout	GSD 14.12.09
D	DEVIATIONS	NP 15/07/13

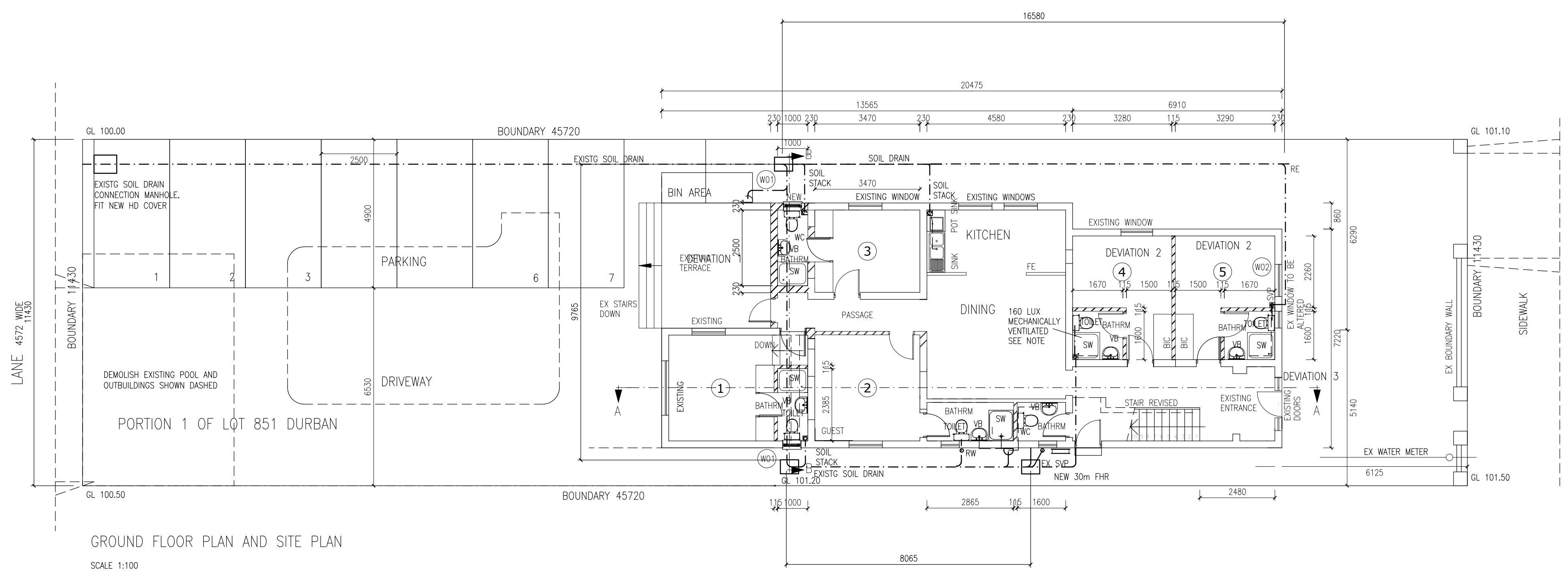
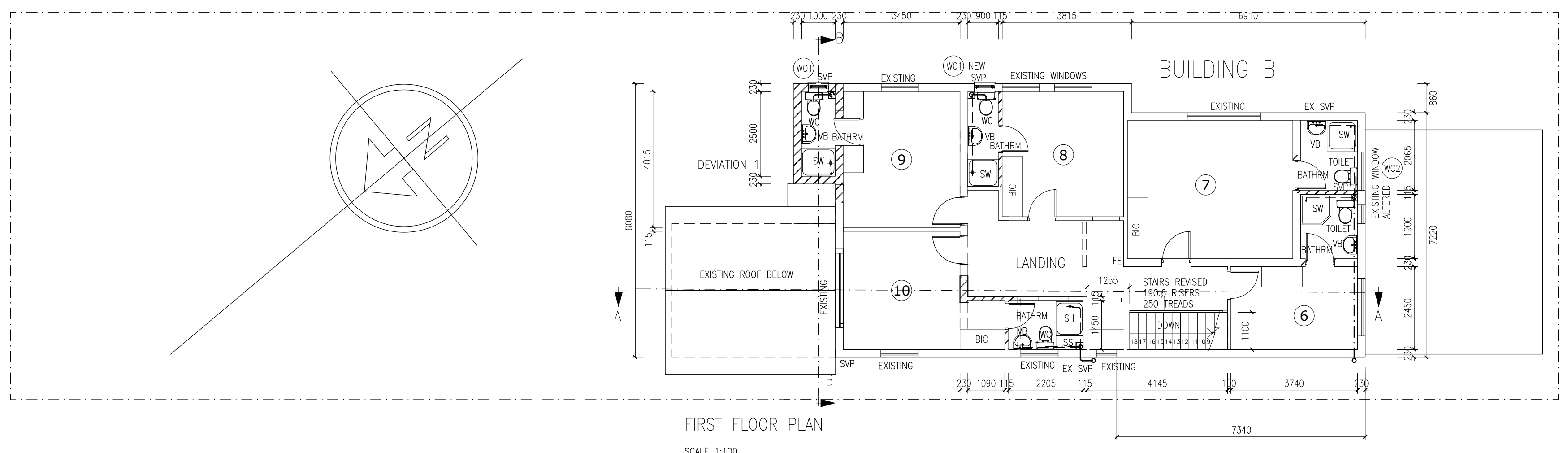

- DEVIATIONS:
 1. ADDITION OF 3 ROOMS OMITTED
 2. GENERAL REVISIONS TO LAYOUT OF ROOMS AND BATHROOMS
 3. EXISTING ENTRANCE RETAINED

FOR NOTES REFER SHEET .02
 BUILDING CLASSIFICATION: H1

WORKING DRAWING

DEVIATION PLAN (TO APPROVED PLAN 215 12 09) OF ALTERATIONS TO HOTEL AT 78 MADLINE ROAD MORNINGSIDE ERF 851 PTN 1 MORNINGSIDE GROUND FLOOR, FIRST FLOOR AND SITE PLAN

Scales	1:100	Architect
New Floor Area		
Rate Number		
Date		
Dwg No	.01	Rev D

howell architects
 P.O.Box 37605, Overport, 4067
 Telephone: 031 309 1515
 Telefax: 031 309 1562
 E-mail: howellarchitects@mwebbiz.co.za
 Reg. No. 5418