

PETER J BYDARWELL
Land Surveyor

SIDES METRES	ANGLES	COORDINATES		S.G. No.
		Y SYSTEM	X	
AB 19,77	A 90 41 00			2039 / 1989 Approved <i>P. J. Bydarell</i> Surveyor-General 1989-08-05
BC 1,81				
CD 14,39	C 180 01 00			
DE 43,93	D 89 19 00			
EF 14,39	E 90 18 00			
FG 1,40	F 179 59 00			
GH 20,17				
HA 43,69	H 89 42 00			

The figure B a b represents a Sewer and Drain Servitude vide diagram S.G.No.1221/1943 and Deed of Transfer No.1709/1945.

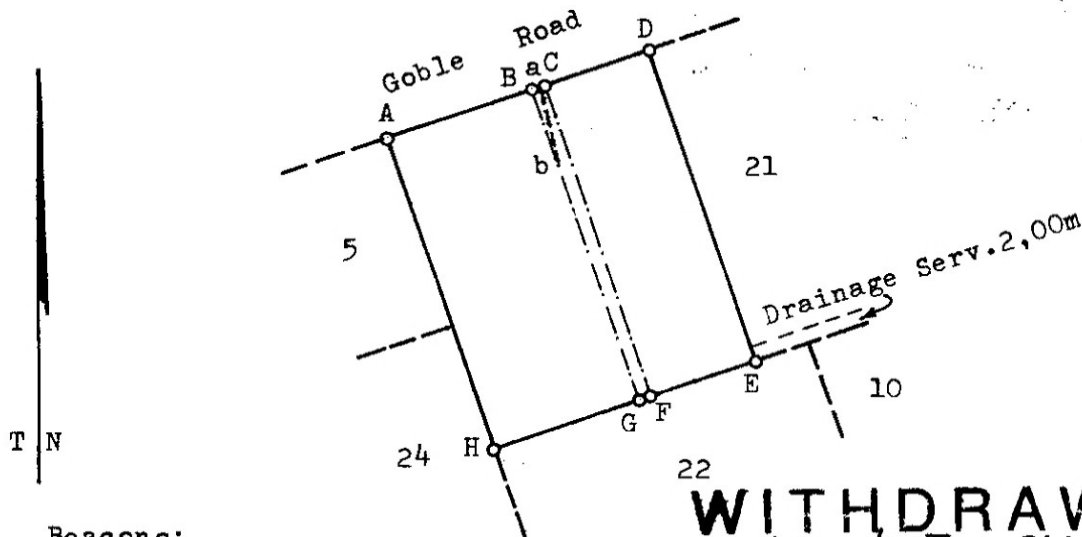

Beacons:

B C F G : 20mm iron pipes

COMPONENTS:

1. The figure A B G H represents the Remainder of Sub 7 of Lot 130 Durban Vide diagram Sub Vol 160 fol 85 and Deed of Transfer No.431/1900.
2. The figure B C F G represents Sub 18 (of 7) of Lot 130 Durban Vide diagram S.G.No.1221/1943 and Deed of Transfer No.1709/1945.
3. The figure C D E F represents Sub 14 (of 9) of Lot 130 Durban Vide diagram Sub Vol 205 fol 30 and Deed of Transfer No.1666/1902.

WITHDRAWN

f. Dbn/3v II p. 264.
SEE SG. 3309/1993: Sub 25 (of 1)

R. A. Stevens

for SURVEYOR-GENERAL 1994.01.03.

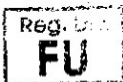

SCALE: 1:1000

The figure A B C D E F G H represents 1 574 Square Metres of land, being SUB 23 OF LOT 130 DURBAN and comprises the properties 1, 2 and 3 quoted above situate in the City of Durban, Administrative District and Province of Natal. surveyed in Compiled in July 1989 by me *Peter Bydarell* Land Surveyor

This diagram relates to	The original diagram is	File No. Durban/13/1 (Vol II)
No.	No.	S.R. No. Compiled
	Transfer/Grant	Comp. Dbn S48
	No.	Degree Sheet 59
Registrar of Deeds.		