

PETER O'REILLY - 0823218277
 S-WN : 507/2929CDS
 CONDUCTOR : 2PH FOX
 LINE LENGTH : 0.631km
 SHEET LENGTH : 631m
 SHEET 1 / 2
 SCALE 1 : 2500

BULWER NB2

UMKELE 18380 FS

FOX 2PH
 424 el 116

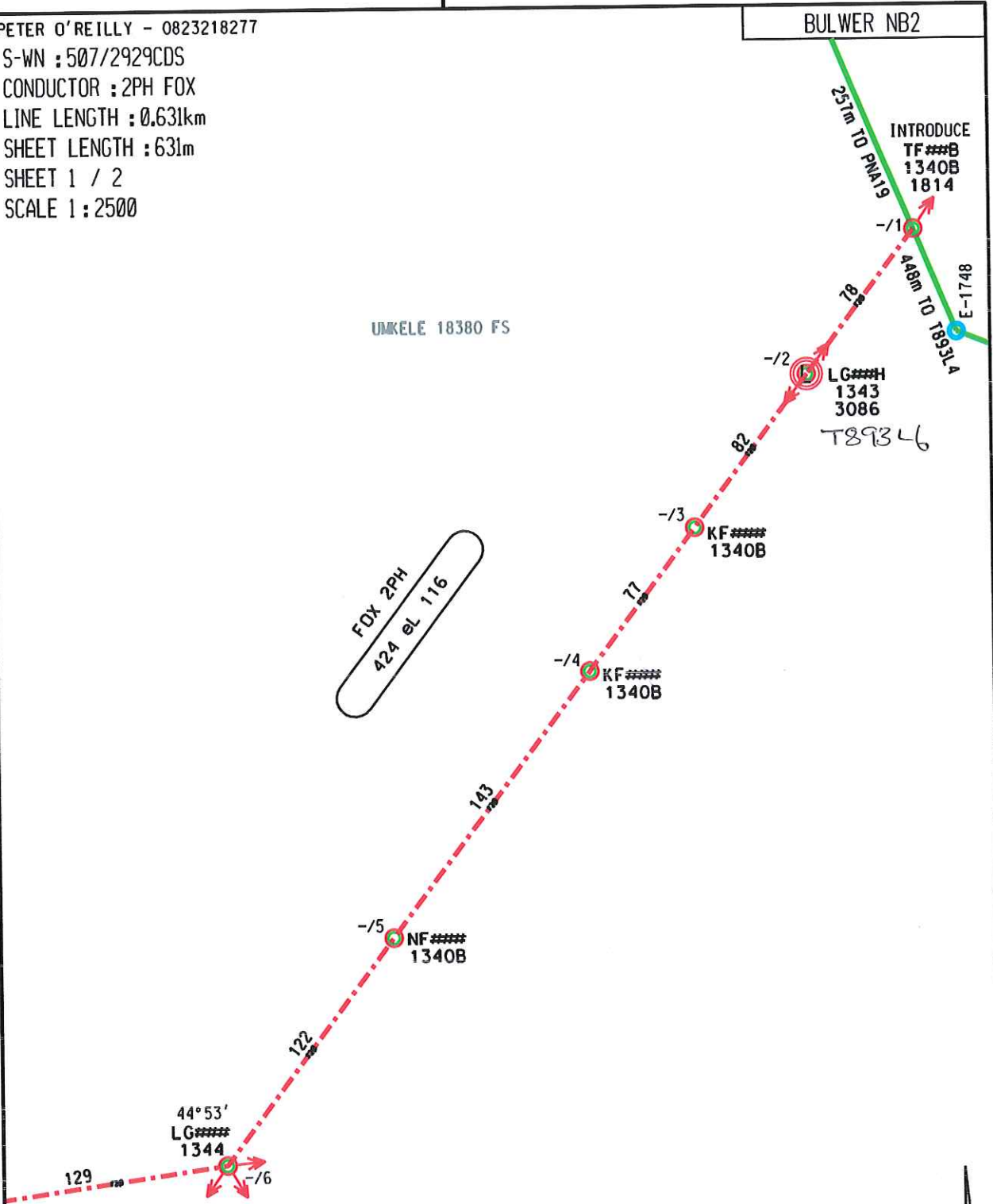

SURVEYOR : M.KHULUSE

 	DRAWN GETEKEN	15	CHKD NAGES	MINDO	AUTH MAS	REV	DATE DATUM	05/10/2015
	BULWER 22KV LINE SUPPLY TO : VODACOM - UBR1050						D : MK/1586 K2 : U145688212 GPS : U145688212	

DRG.TEK
 REGISTR

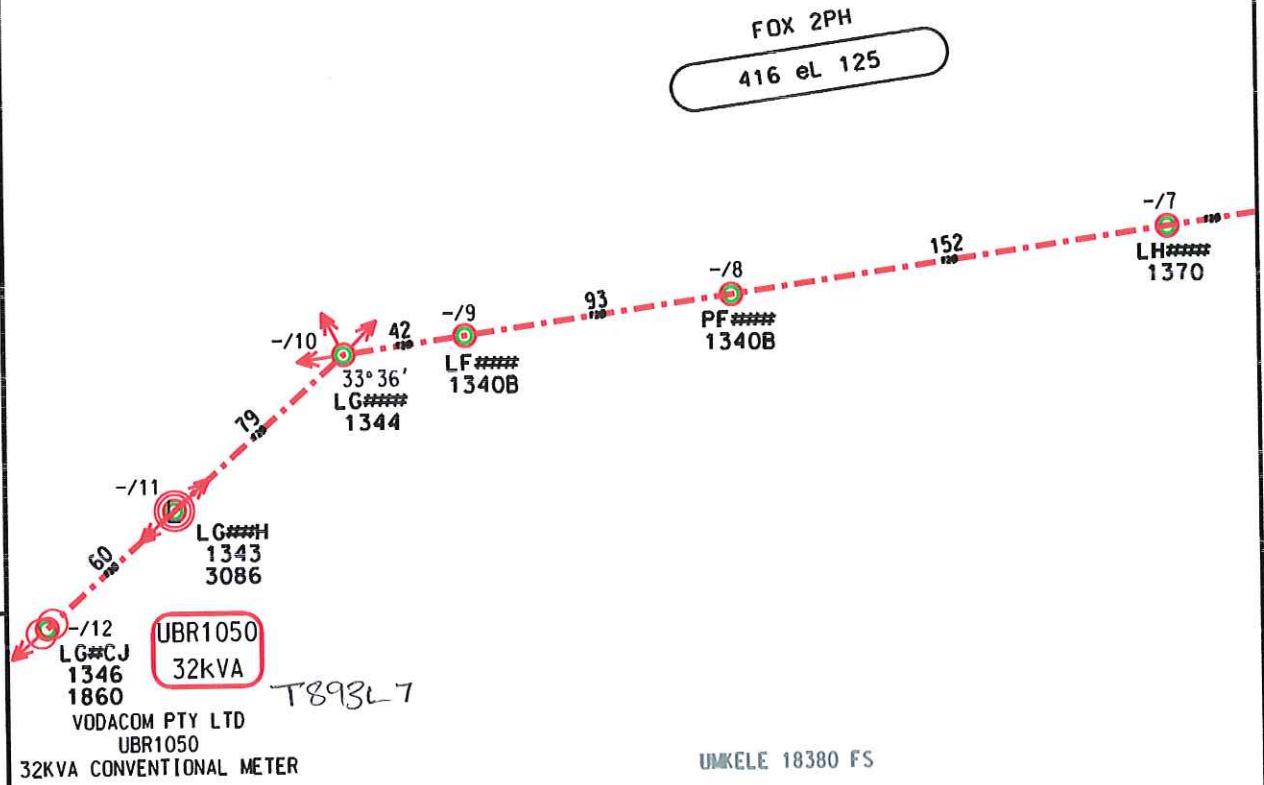

S-WN : 507/2929CDS
 CONDUCTOR : 2PH FOX
 LINE LENGTH : 0.426km
 SHEET LENGTH : 426m
 SHEET 2 / 2
 SCALE 1 : 2500

SURVEYOR : M.KHULUSE

	DRAWN GETEKEN	1s	CHKD NACES	ms/100	AUTH MAS	REV	DATE DATUM	08/10/2013
 	BULWER 22KV LINE SUPPLY TO : VODACOM - UBR1050					D : MK/1586 K2 : U145688212		
							GPS : U145688212	

N1346/1860	-42211.441	3319700.316	1859.518
GL	-42559.165	3319622.947	1744.730
GL	-42525.274	3319630.496	1758.170
GL	-42493.283	3319637.713	1772.138
GL	-42472.569	3319642.253	1777.879
N1340B	-42448.338	3319665.779	1785.994
GL	-42424.856	3319672.252	1792.327
GL	-42397.094	3319679.726	1804.087
GL	-42374.931	3319685.776	1817.407
GL	-42354.412	3319691.475	1832.137
1340B	-42356.588	3319601.066	1837.822
1340B	-42356.473	3319603.434	1837.830
N1340B	-42356.502	3319601.704	1837.819
N1344	-42314.900	3319607.729	1843.933
GL	-42297.155	3319623.555	1846.691
GL	-42278.923	3319639.804	1848.689
N1343/1848	-42255.982	3319660.512	1851.899
GL	-42230.363	3319683.112	1855.813
GL	-42335.104	3319604.820	1841.840
GL	-42401.258	3319595.243	1803.951
N1340B	-42448.640	3319588.550	1788.155
GL	-42473.360	3319585.035	1778.395
GL	-42504.862	3319580.495	1764.433
GL	-42531.750	3319576.722	1751.358
GL	-42586.047	3319568.939	1728.483
N1370	-42598.930	3319567.006	1724.013
GL	-42638.431	3319561.307	1709.388
GL	-42662.657	3319558.021	1698.634
GL	-42697.504	3319552.856	1687.678
N1344	-42726.779	3319548.667	1678.656
EX1748	-43047.632	3319191.215	1611.220
EX1747	-42995.481	3319065.262	1605.315
N1340B/1814-12M POLE	-43029.234	3319146.890	1605.835
GL	-43010.611	3319171.554	1610.599
GL	-43000.483	3319184.950	1613.785
N1343/1848	-42982.442	3319209.128	1620.204
GL	-42967.814	3319228.572	1625.913
GL	-42950.010	3319252.231	1630.570
N1340B	-42932.967	3319274.929	1635.091
GL	-42914.563	3319299.369	1638.935
GL	-42894.342	3319326.412	1645.251
GL	-42878.541	3319347.210	1646.045
GL	-42865.592	3319364.406	1648.128
GL	-42847.052	3319389.077	1653.434
GL	-42818.155	3319427.579	1659.956
GL	-42806.601	3319442.613	1661.977
N1340B	-42800.222	3319451.007	1663.619
GL	-42780.908	3319476.564	1667.460
GL	-42761.421	3319502.605	1669.408
GL	-42748.074	3319520.202	1672.180