

Site Plan i.t.o. Regulation 2(2) of the MPRDA, 2002: Proposed site plan in respect of a new mining permit on the farm Mimosa Glen 885/9, Bloemfontein district

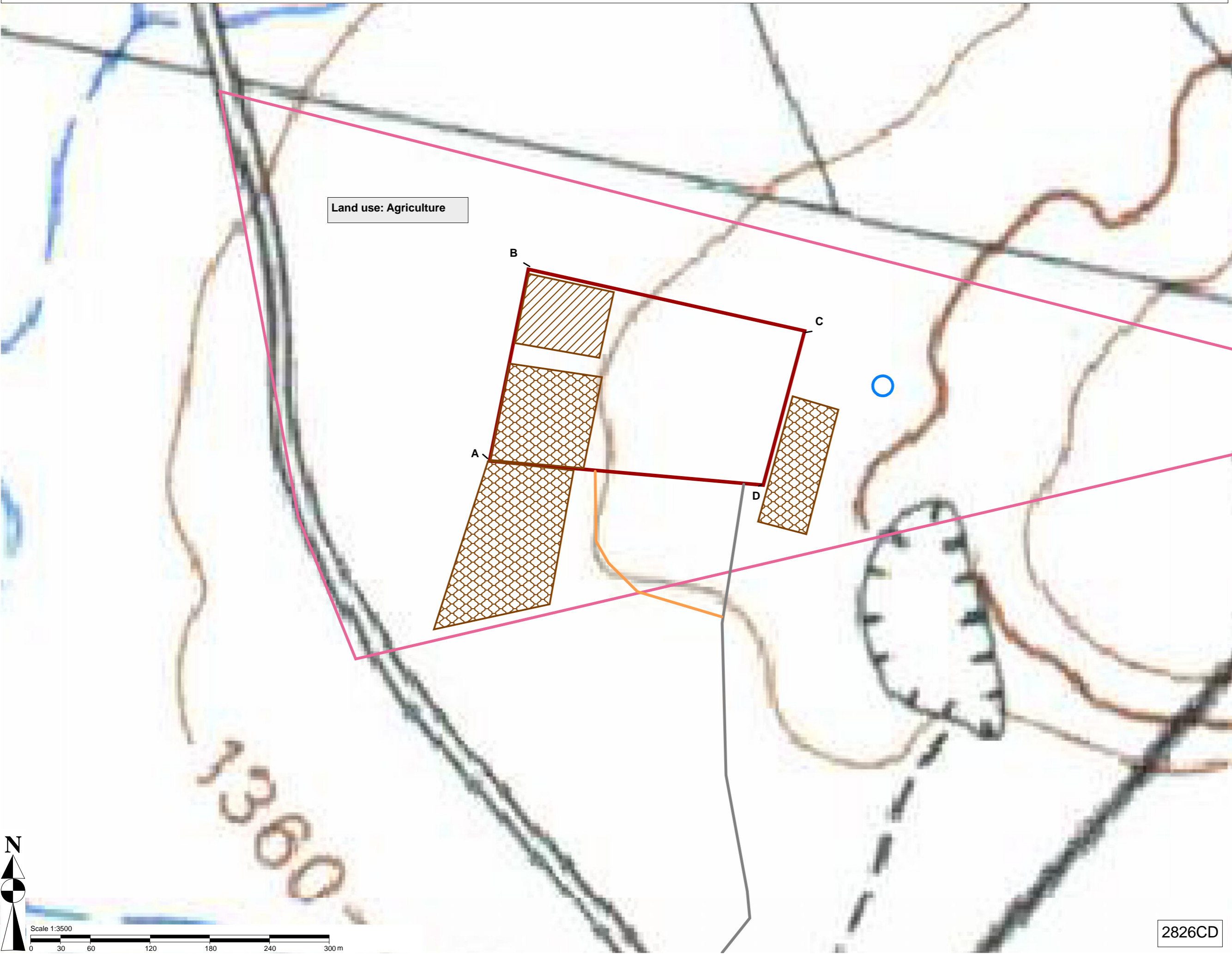

Land use: Agriculture

Legend

Mimosa Glen 885/9
Bloemfontein

- Mimosa Glen 885/9 (of 6)
- Proposed permit area (4.9ha)
- Existing access road
- Proposed access road (225m)

Site layout

- Proposed product, overburden & topsoil stockpiles (3ha)
- Proposed Plant area (0.6ha)
- Proposed reservoir

Applicant:

AMC
MINING & CRUSHING
SOUTH AFRICA

AMC Umsenge Quarry (Pty) Ltd

Contact: Mr. Zane Murray
Tel: 051 451 2604

March 2019

DMR signature & date:

Study area:

Mimosa Glen 885/9
Bloemfontein Magisterial District

Site coordinates:

| | East | South |
|---|-----------|------------|
| A | 26.261199 | -28.987596 |
| B | 26.261599 | -28.985862 |
| C | 26.264444 | -28.986419 |
| D | 26.264018 | -28.987814 |

Consultant:

Lefatse EPS (Pty) Ltd
H van Jaarsveld
hanri@lefatsemail.co.za

LEFATSE
Environmental Planning Services (PTY) Ltd

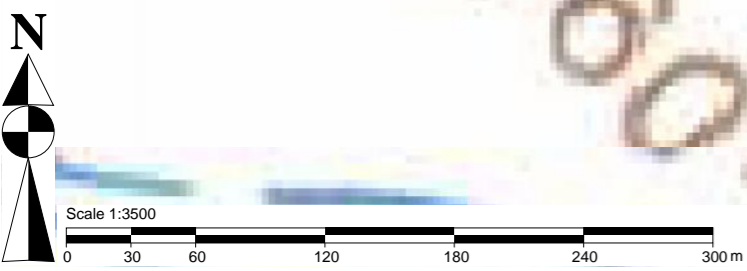

2826CD