

SUB-DIVISIONAL DIAGRAM
 Sect. 24 (b), Act No. 9 of 1927

System Lo. 31°

SIDES ENGLISH FEET		ANGLES OF DIRECTION	CO-ORDINATES Y X	
		Const.		+120,000.0 +10,795,000.0
AB	1828.3	315° 28' 20"	A	+3064.8 + 631.9
BC	2303.9	97 58 0	B	+1782.7 + 1935.3
CA	1402.7	225 24 50	C	+4064.4 + 1616.0
Ca	63.1	225 26 50	a	+4019.4 + 1577.7
ab	2200.3	227 58 0	b	+1840.3 + 1876.8
bB	82.1	315 28 20		

S. G. No. 1701 / 54

Approved

[Signature]
 Surveyor General.

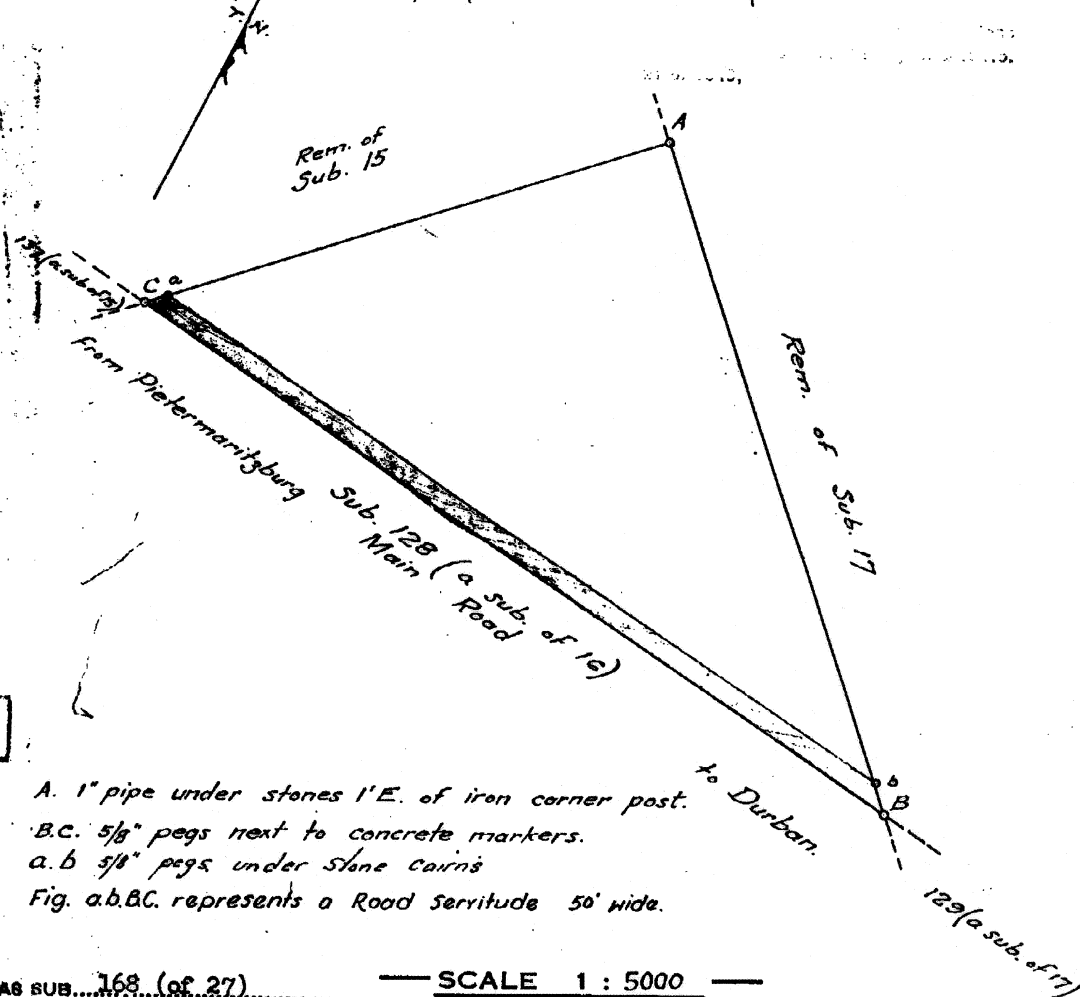

Reg. Div.
FT

A. 1" pipe under stones 1'E. of iron corner post.
 B.C. 5/8" pegs next to concrete markers.
 a. b 5/8" pegs under stone cairns
 Fig. a.b.BC. represents a Road servitude 50' wide.

SCALE 1 : 5000

HOW KNOWN AS SUB. 168 (of 27) OF THE FARM. Uitkomst and Doornrug No. 852

The figure **A. B. C.** represents **29.4375 Acres** of land being

Sub. 168 (a sub. of 16) of the farm **Uitkomst and Doornrug No. 852** situate in the **County of Pietermaritzburg** Province of Natal.

Surveyed in **June 1951**, by me *[Signature]* **September 1954** *[Signature]* Land Surveyor.

This diagram relates to CRT	The original diagram is S.V.	File No. 973
No. 16620/1968	No. 382/81	Survey Records 436/84, 866/51
Registrar of Deeds.	relating to Deed of TF.	Compilation
	No. 3275/1931	Degree Sheet 59FT6C 23
		Tracing
		General Plan