

APPENDIX C

Facility Illustrations

Table of Contents

1. SDP Option 1 (Preferred layout plan)
2. SDP Option 2
3. SDP Option 3
4. SDP Option 4

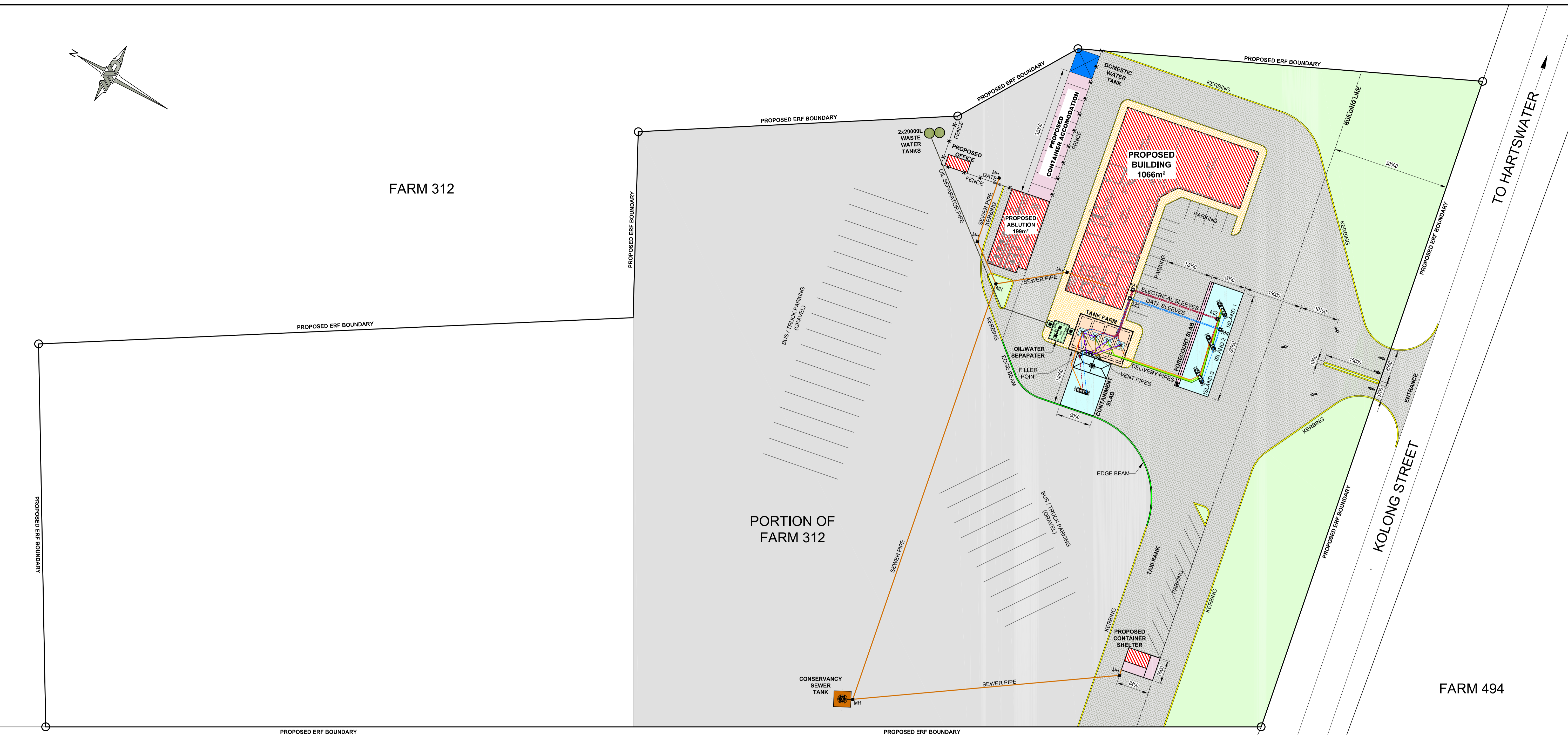
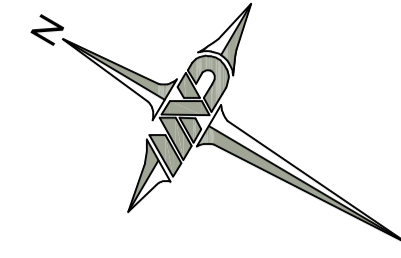

LEGEND	
	GRASSED AREA
	60mm INTERLOCKING PAVING BLOCKS
	50mm INTERLOCKING PAVING BLOCKS
	GRAVEL AREA
	FUEL DELIVERY LINES
	OIL SEPARATOR PIPES
	SEWER PIPES
	VENT PIPES
	FILLER LINES

NOTE/NOTA :
 NO DIMENSIONS ARE TO BE SCALED OFF ANY DRAWINGS. ALL DIMENSIONS ARE TO BE RATIFIED ON SITE PRIOR TO ANY CONSTRUCTION.
 GEEN AFMETINGS MAG VAN TEKENINGE GESKAAL WORD NIE. ALLE AFMETINGS MOET OP TERREIN NAGEGAAN WORD VOOR KONSTRUKSIE.

A BEFORE CONTRACT COMMENCES, VOOR KONTRAK IN AANVANG NEEM.
 AFTER CONTRACT HAS COMMENCED, NA KONTRAK IN AANVANG GENEEM HET.
 COPYRIGHT IS VESTED IN MVD KALAHARI IN TERMS OF THE COPYRIGHT ACT. (ACT 98 OF 1978)
 OUTEURSREG IS GEVESTIG IN MVD KALAHARI. KRAGTENS DIE WET OP OUTEURSREG. (WET 98 VAN 1978)

NO. NR.	DATE DATUM	AMENDMENTS WYSIGINGS

MVD Kalahari
 Consulting Engineers and Town Planning/Raadgewende Ingenieurs en Stadsbeplanning.

Du Totspanweg 166 / Du Totspan Road
 Posbus / P.O. Box 580, Kimberley 8300
 Tel: (053) 831 1889/90

E-Mail admin@mvdkalahari.co.za
 www.mvdkalahari.co.za
 Level 1 B-BBEE Contributor

CESA
 Consulting Engineers South Africa

DESIGN ONTWERP	W. Karsten
DRAWN GETEKEN	X. Magau
CHECKED NAGEGAAN	W. Karsten
CLIENT KLIENT	---
DATE DATUM	June 2022

PROJECT/PROEJ
PAMPIERSTAD PROPOSED FILLING STATION

CLIENT/KLIENT	G.P OLIVIER		
DRAWING DESCRIPTION/TEKENING BESKRYWING	SITE DEVELOPMENT PLAN		
PAPER SIZE/PAPIER GROOTTE	SCALE/SKAAL	DRAWING No./TEKENING Nr.	REV No.
A1	1:500	10963/C/M/L/001	--

DRAFT

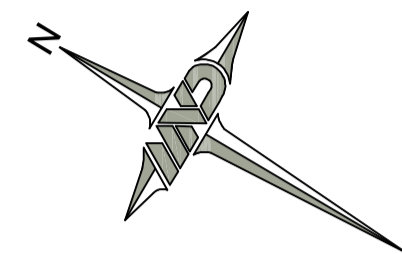

FARM 312

PORTION OF FARM 312

FARM 513

FARM 494

TO HARTSWATER

KOLONG STREET

RSTAD

LEGEND	
	GRASSED AREA
	60mm INTERLOCKING PAVING BLOCKS
	50mm INTERLOCKING PAVING BLOCKS
	GRAVEL AREA
	FUEL DELIVERY LINES
	OIL SEPARATOR PIPES
	SEWER PIPES
	VENT PIPES
	FILLER LINES

NOTE/NOTA :
NO DIMENSIONS ARE TO BE SCALED OFF ANY DRAWINGS. ALL DIMENSIONS ARE TO BE RATIFIED ON SITE PRIOR TO ANY CONSTRUCTION.

A BEFORE CONTRACT COMMENCES, VOOR KONTRAK IN AANVANG NEEM.
A1 AFTER CONTRACT HAS COMMENCED, NA KONTRAK IN AANVANG GENEEM HET.

COPYRIGHT IS VESTED IN MVD KALAHARI IN TERMS OF THE COPYRIGHT ACT. (ACT 98 OF 1978)
Outeursreg is gevestig in MVD KALAHARI. KRAGTENS DIE WET OP OuteursREG. (WET 98 VAN 1978)

NO. NR.	DATE DATUM	AMENDMENTS WYSIGINGS

MVD Kalahari
Consulting Engineers and Town Planning/Raadgewende Ingenieurs en Stadsbeplanning.

Du Totspanweg 166 / Du Totspan Road
Posbus / P.O. Box 580, Kimberley 8300
Tel: (053) 831 1889/90

E-Mail admin@mvdkalahari.co.za
www.mvdkalahari.co.za
Level 1 B-BBEE Contributor

CESA
Consulting Engineers South Africa

DESIGN ONTWERP	W. Karsten
DRAWN GETEKEN	X. Magau
CHECKED NAGEGAAN	W. Karsten
CLIENT KLIJNT	---
DATE DATUM	June 2022

PROJECT/PROEJ
PAMPIERSTAD PROPOSED FILLING STATION

CLIENT/KLIJNT G.P OLIVIER			
DRAWING DESCRIPTION/TEKENING BESKRYWING SITE DEVELOPMENT PLAN			
PAPER SIZE/PAPIER GROOTTE A1	SCALE/SKAAL 1:500	DRAWING No./TEKENING Nr. 10963/C/M/L/001	REV No. --

DRAFT

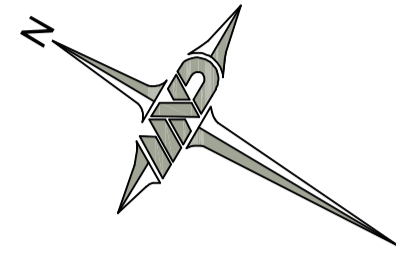

FARM 312

PORTION OF FARM 312

FARM 494

FARM 513

LEGEND	
	GRASSED AREA
	60mm INTERLOCKING PAVING BLOCKS
	50mm INTERLOCKING PAVING BLOCKS
	GRAVEL AREA
	FUEL DELIVERY LINES
	OIL SEPARATOR PIPES
	SEWER PIPES
	VENT PIPES
	FILLER LINES



NOTE/NOTA :
 NO DIMENSIONS ARE TO BE SCALED OFF ANY DRAWINGS. ALL DIMENSIONS ARE TO BE RATIFIED ON SITE PRIOR TO ANY CONSTRUCTION.
 GEEN AFMETINGS MAG VAN TEKENINGE GESKAAL WORD NIE. ALLE AFMETINGS MOET OP TERREIN NAGEGAAN WORD VOOR KONSTRUKSIE.

A BEFORE CONTRACT COMMENCES. VOOR KONTRAK IN AANVANG NIEEM.
 A1 AFTER CONTRACT HAS COMMENCED. NA KONTRAK IN AANVANG GENEEM HET.
 COPYRIGHT IS VESTED IN MVD KALAHARI IN TERMS OF THE COPYRIGHT ACT. (ACT 98 OF 1978)
 Outeursreg is gevestig in MVD KALAHARI. KRAGTENS DIE WET OP OuteursREG. (WET 98 VAN 1978)

NO. NR.	DATE DATUM	AMENDMENTS WYSIGINGS

MVD Kalahari
 Consulting Engineers and Town Planning/Raadgewende Ingenieurs en Stadsbeplanning.

Du Tollspanweg 186 / Du Tollspan Road
 Postbus / P.O. Box 580, Kimberley 8300
 Tel: (053) 831 1889/90

E-Mail: adm@mvdkalahari.co.za
 www.mvdkalahari.co.za
 Level 1 B-BBEE Contributor

CESA
 Consulting Engineers South Africa

DESIGN ONTWERP	W. Karsten
DRAWN GETEKEN	X. Magau
CHECKED NAGEGAAN	W. Karsten
CLIENT KLIJNT	----
DATE DATUM	June 2022

PROJECT/PROJEK
PAMPIERSTAD PROPOSED FILLING STATION

CLIENT/KLIJNT	G.P OLIVIER		
DRAWING DESCRIPTION/TEKENING BESKRYWING	SITE DEVELOPMENT PLAN OPTION 3		
PAPER SIZE/PAPIER GROOTTE	SCALE/SKAAL	DRAWING No./TEKENING Nr.	REV No.
A1	1:500	10963/C/M/L/001	--

DRAFT

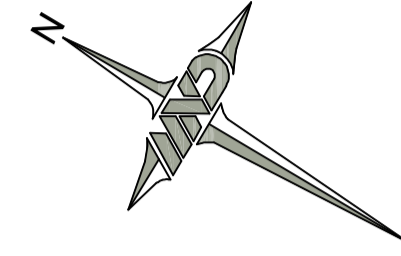

FARM 312

PORTION OF FARM 312

FARM 494

FARM 513

LEGEND	
	GRASSED AREA
	60mm INTERLOCKING PAVING BLOCKS
	50mm INTERLOCKING PAVING BLOCKS
	GRAVEL AREA
	FUEL DELIVERY LINES
	OIL SEPARATOR PIPES
	SEWER PIPES
	VENT PIPES
	FILLER LINES



NOTE/NOTA :
 NO DIMENSIONS ARE TO BE SCALED OFF ANY DRAWINGS. ALL DIMENSIONS ARE TO BE RATIFIED ON SITE PRIOR TO ANY CONSTRUCTION.
 GEEN AFMETINGS MAG VAN TEKENINGE GESKAAL WORD NIE. ALLE AFMETINGS MOET OP TERREIN NAGEGAAN WORD VOOR KONSTRUKSIE.

A BEFORE CONTRACT COMMENCES, VOOR KONTRAK IN AANVANG NEEM.
 A1 AFTER CONTRACT HAS COMMENCED, NA KONTRAK IN AANVANG GENEEM HET.
 COPYRIGHT IS VESTIG IN MVD KALAHARI IN TERMS OF THE COPYRIGHT ACT. (ACT 98 OF 1978)
 Outeursreg is gevestig in MVD KALAHARI, KRAGTENS DIE WET OP OuteursREG. (WET 98 VAN 1978)

NO. NR.	DATE DATUM	AMENDMENTS WYSIGINGS

MVD Kalahari
 Consulting Engineers and Town Planning/Raadgewende Ingenieurs en Stadsbeplanning.

Du Totspanweg 166 / Du Totspan Road
 Posbus / P.O. Box 580, Kimberley 8300
 Tel. (053) 831 1889/90

E-Mail admin@mvdkalahari.co.za
www.mvdkalahari.co.za
 Level 1 B-BBEE Contributor

CESA
 Consulting Engineers South Africa

DESIGN ONTWERP	W. Karsten
DRAWN GETEKEN	X. Magau
CHECKED NAGEGAAN	W. Karsten
CLIENT KLIJNT	---
DATE DATUM	June 2022

PROJECT/PROEJ
PAMPIERSTAD PROPOSED FILLING STATION

CLIENT/KLIJNT	G.P OLIVIER		
DRAWING DESCRIPTION/TEKENING BESKRYWING	SITE DEVELOPMENT PLAN OPTION 4		
PAPER SIZE/PAPIER GROOTTE	SCALE/SKAAL	DRAWING No./TEKENING Nr.	REV No.
A1	1:500	10963/C/M/L/001	--

DRAFT